

74688

GENERAL MAPPING AUTHORITY
Department of Lands

Trigonometrical Survey of N.S.W.
RECONNAISSANCE and MAINTENANCE REPORT

STATION **THERESA T.S. 4346**

Co: **ROMS** Ph: **DYRABABA**
Map Sheet: **BONALBO** No: **9440-S**
Inspected by: **J. SHERWIN** Date: **3/5/75**
Authority: **CMA 72/73** Field Book: **01438-**

Beacon Diagram
as before
Not to Scale

This Trig. Station has been: Note: Cross out word or words which do not apply

1. Completely cleared to permit 360° vision to surrounding Trigs.
2. ~~Cleared by Vanes-bearing~~ from ~~Trig-Mast~~
3. Trig. Mast & Vanes have been painted white & black respectively. Original Mast Mark ~~.....~~
4. The Trig. ~~was unupiled~~/not unupiled, dimensions now being: should be explicit, e.g. Steel plug, Brass plug, Bolt, G.I. Pipe

Description of mark..... m above rock/concrete m above G.I.
below
Height of mark..... m
Height of Top Vanes to Top Mark **3.807** m. **adopted** Diameter of Vanes (vertical)..... m.
Height of Cairn..... m. Diameter of Cairn..... m.

Length of Mast..... m. (approximate if not unupiled)

5. A. **55M**..... set in conc ~~4~~ ^{found} ~~4~~ ⁵⁵⁰ m. bearing **357**°M from Trig. Mast
6. A. **5.1 Pipe**..... set in conc ~~4~~ ^{found} ~~4~~ ⁵⁵⁰ m. bearing **77**°M from Trig. Mast
7. A..... set in conc/soil has been placed..... m. bearing.....°M from Trig. Mast
8. A..... set in conc/rock has been placed..... m. bearing.....°M from Trig. Mast

9. Connection **55M to 5.1 Pipe** : **5.250** m. bearing **128**°M

10. Connection..... to..... m. bearing.....°M

11. Connection..... to..... m. bearing.....°M

12. Connection..... to..... m. bearing.....°M

13. Diff. Ht. **55M to Conc**..... is **1.402** m. ^{above} ~~below~~ **9.1 Pipe in Conc**

14. Diff. Ht. **55M to Conc**..... is **3.600** m. ^{above} ~~below~~ **Top of Vanes**

15. Diff. Ht. is..... m. ^{above} ~~below~~

16. Diff. Ht. is..... m. ^{above} ~~below~~

Date	Record of Station

Prepared by: **Pk Bamela 12/19/75** Checked: **W. Baker** Noted on U.T.M. Card

Checked

STATION **THERESA. T.S. 4346** ✓

Owners Name.....
 Current Occupant.....
 Address.....
 Address.....

Access **AS BEFORE**

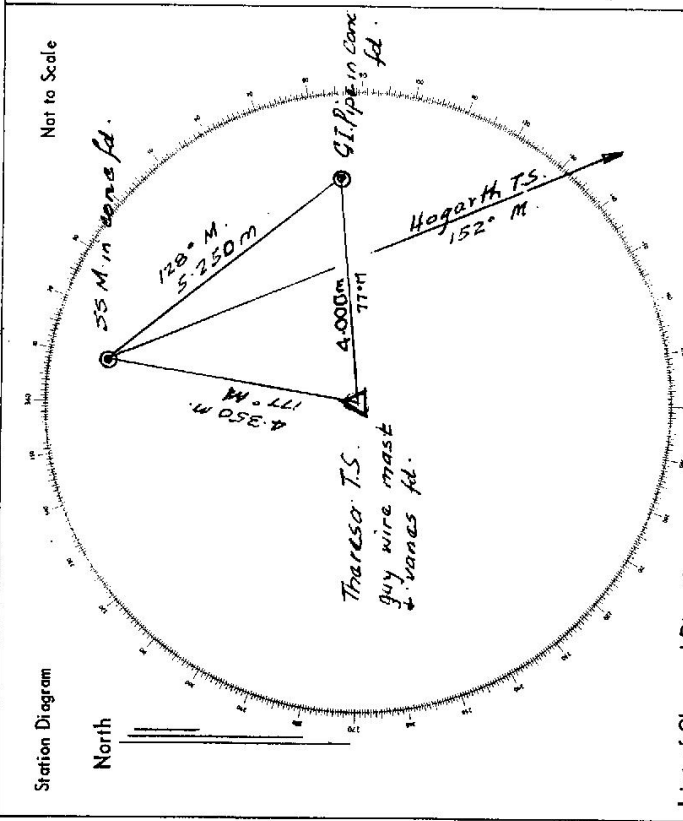

List of Observed Directions:-

Standpoint: 55M in Conc.		Standpoint:	
Station	Direction	Station	Direction
Hogarth T.S.	0° 00' 00"		
Mast Theresa T.S.	25° 16'		
G.P. in Conc. ft.	337° 23' 00" ✓		
PKYABA T.S.	160° 01' 05"		
Station	Direction	Station	Direction

6/3

CENTRAL MAPPING AUTHORITY

GEODETIC SURVEY OF N.S.W.

GEODETIC STATION RECONNAISSANCE and MAINTENANCE REPORT

STATION: **THERESA** No.: 4346

MAP SHEET SCALE 1:250 000 **Warwick** (MUMMULGUM 1:25,000)

INSPECTED BY: **A. Sivertsen** DATE: **31-7-80**

AUTHORITY: **CMA** FIELD BOOK: **1848**

Description: *Note: Cross out word or words which do not apply*

1. Cleared by lanes bearing..... **Suckered 360°**..... **day clearing**..... from Trig. Mast

2. Mast & Vanes have been painted **white & black** respectively.....

3. The station/pillar was **unpiled**/not unpiled/constructed on..... 19....., dimensions now being:

Description of mark..... should be explicit, e.g. S/Steel Pillar Plate, Steel plug, Brass plug, Bolt, G.I. Pipe

Height of mark..... m..... above rock/concrete; Mark is..... m....., below G.L.

Height of Top Vanes to Top Mark/Pillar plate..... m..... Diameter of Vanes (vertical)..... m.....

Height of Cairn..... m..... Diameter of Cairn..... m..... Name Plate found/not found/placed,

Length of Mast..... m..... (approximate if not unpiled) Mast held by guy wires

4. A..... **G.I. Pipe**..... set in conc/rock has been **placed**/found, bearing..... **7.7°**..... M from Mast/Plug/Pillar at 4 m

5. A..... **S.S.M**..... set in conc/rock has been **placed**/found, bearing..... **35.7°**..... M from Mast/Plug/Pillar at 4.3 m

6. A..... set in conc/rock has been placed/found, bearing..... ° M from Mast/Plug/Pillar

7. A..... set in conc/rock has been placed/found, bearing..... ° M from Mast/Plug/Pillar

8. Action required: **day clearing**..... **Paint**..... **M.B.V.**.....

STANDPOINT: **↳ 2 axes or light chainsaw** STANDPOINT:

Mark	Direction	Horiz. Distance	Height Difference	Mark	Direction	Horiz. Distance	Height Difference
REQUIRED							
DYRABA (EDM)	312°M	M4V	above standpt.				above standpt.
HOGARTH (EDM)	Needs clearing to see out		above standpt.				above standpt.
BLACK - CAMP EDM	Traverse str. required or clearing between trigs		above standpt.				above standpt.
			below standpt.				below standpt.
			above standpt.				above standpt.
			below standpt.				below standpt.
			above standpt.				above standpt.
			below standpt.				below standpt.

Prepared by: **A. Sivertsen** 7-8-80 Checked: **W. J. ...** Noted on U.T.M. Card

SI 2733-1

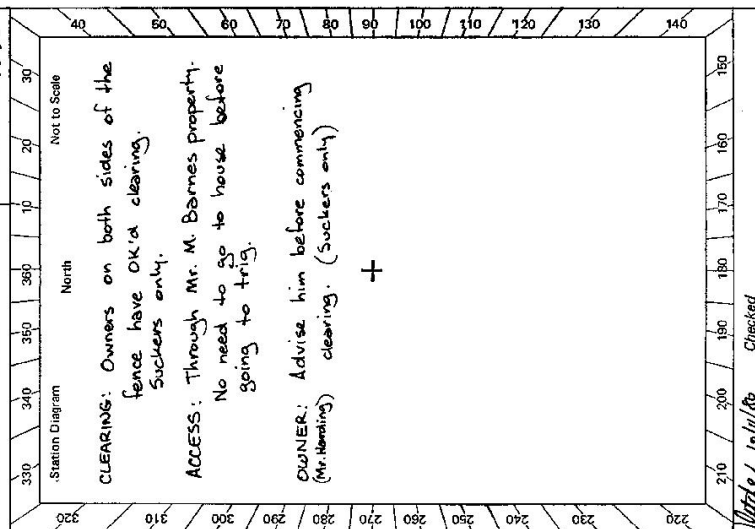

GS

<p>STATION</p> <p style="text-align: center;">THERESA</p> <p style="text-align: right;">TS 4346</p>	<p>Owner's Name: Mr. Len. HARDING</p> <p>Address: at PORA 14.7 km west of CASINO on Brunner Hwy on left</p> <p>Phone: 675 123</p> <p>Access Report of 3/5/1972 was found suitable/unsuitable. 4wd.</p> <p>Owner of Access: Mr. Michael BARNES</p> <p>Address: "Dyraba Station" DYRABA</p> <p>Phone: 675 144</p> <p>7km past 25.7 on access on left. ACCESS 31/7/1980 No need to call at house.</p> <p>0.0 km At hwy intersection at SOUTH CASINO. Take BRUNNER HWY towards TENTERFIELD.</p> <p>14.7 Owners house on left. (call in if clearing)</p> <p>19.7 Turn right "DYRABA CK 14" gravel road</p> <p>24.9 Bridge</p> <p>25.7 Turn left through wooden gate & follow track. (Owner of access see above)</p> <p>25.9 Turn hard left back towards fence.</p> <p>26.0 Straight ahead through wire gate & follow fence.</p> <p>26.9 Turn right off fence before steep bit - go round side of hill and cross gully.</p> <p>27.1 After crossing gully continue around side of hill & cross next gully & go up 4th spur from fence.</p> <p>27.5 10-15 min steep walk (light load) following fence.</p>
<p>Beacon Diagram</p> <p style="text-align: right;">Not to Scale</p>	<p>This section to be completed by officer constructing pillar.</p> <p>Original station mark found/not found.</p> <p>Description of mark:</p> <p>Original beacon found/not found.</p> <p>Description of beacon:</p> <p>Height Top of Vanes to Top Mark.....m.</p> <p>Height of mark.....m. above G.L. below</p> <p>Diameter of Vanesm. Height of Cairn.....m.</p> <p>Original Beacon has/has not been destroyed by me.</p>
<p>Date</p> <p>20-6-80</p> <p>3-7-80</p>	<p>Record of Station</p> <p>C. Zahra: permission from Mr. Harding for clearing</p> <p>A. Swetten: permission from Mr. Barnes for clearing & access</p>

GS

<p>STATION <u>Theresa C.P. TS 4346</u></p>	<p>Owner's Name: <u>Mr. Len Harding</u> Address: <u>14.7 km West of Casino</u> Phone: <u>675 123</u></p> <p>Owner of Access: <u>Mr. Michael Barnes</u> Address: <u>Dykeaba Station</u> Phone: <u>675 144</u> 17 Km. Post 25.1 on access on left. (No Need to call at house.)</p> <p>ACCESS: <u>4 km</u> Access Report of 21.1.19 was found suitable/usable.</p> <p>0.0 At Highway Intersection at South Casino, Take Brunner Highway toward Tenterfield. Pass owner's house on your left. Turn right, Dykeaba Creek rd, follow Gravel Road. 14.70 Turn left through wood gate & follow track. 19.70 Turn hard left back toward fence. 24.90 Straight ahead through wire gate & follow fence. 25.70 Turn right off fence before steep pinch, go round side of hill and cross gully. 25.90 At the crossing gully, continue around side of hill & cross next gully & go up toward spur from fence mentioned. 26.00 Leave vehicle, 15 minutes steep walk with light load following fence to trig. ✓ <u>mark 6</u></p>
<p>Beacon Diagram</p>	<p>Date</p> <p>Record of Station</p>
<p>This section to be completed by officer constructing pillar.</p> <p>Original station mark found/ reconstructed.</p> <p>Description of mark: <u>Cartilage Case</u></p> <p>Original beacon found/ reconstructed.</p> <p>Description of beacon: <u>Pole, Cartilage Case & Lamp Vanes</u></p> <p>Height Top of Vanes to Top Mark: <u>3.195</u> m.</p> <p>Height of mark: <u>0.125</u> m. <u>above</u> G.L. <u>below</u></p> <p>Diameter of Vanes: <u>0.125</u> m. Height of Cairn: <u>3.10</u> m.</p> <p>Original Beacon has has not been destroyed by me.</p>	