

CENTRAL MAPPING AUTHORITY

GEODETIC SURVEY OF N.S.W.

GEODETIC STATION RECONNAISSANCE and MAINTENANCE REPORT

STATION: RABBIT No.: 3833

MAP SHEET SCALE: 250 000 CRAFTON

INSPECTED BY: D. KINLYDE DATE: 16.8.78

AUTHORITY: CHA 67/2/2 FIELD BOOK: -

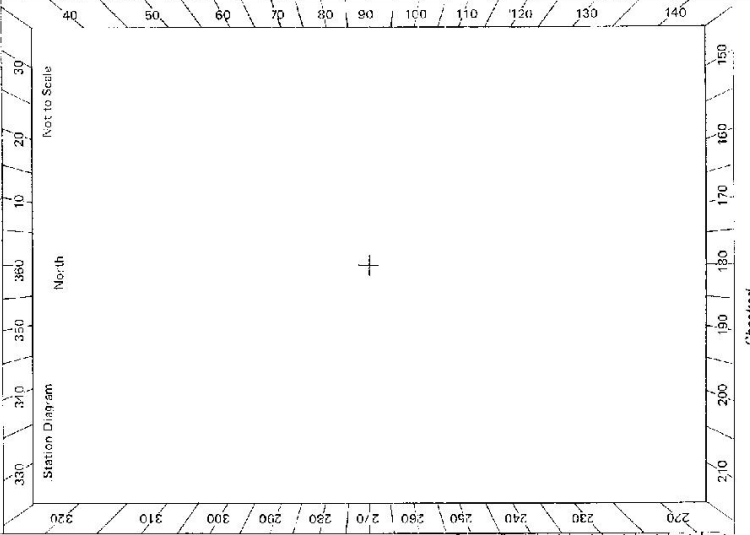

Description: *Note: Cross out word or words which do not apply*

1. Cleared by lanes bearing..... *not cleared*..... from Trig. Mast
2. Mast & Vanes have been painted white & black respectively.
3. The station/pillar was *not* unpiled/constructed *on*..... *to*....., dimensions now being: *beetle in conc.* should be explicit, e.g., S/Steel Pillar Plate, Steel plug, Brass plug, Bolt, G.I. Pipe
Description of mark..... *beetle in conc.* ^{above} _{below} G.L.
- Height of mark..... ^{above} _{below} rock/concrete; Mark is..... ^{above} _{below} G.L.
- Height of Top Vanes to Top Mark/Pillar plate.....m. Diameter of Vanes (vertical).....m.
- Height of Cairn.....m. Diameter of Cairn.....m. Name Plate found/not found/placed.
- Length of Mast.....m. (approximate if not unpiled)
4. A..... ^{above} _{below} set in conc./rock has been placed/found, bearing.....°M from Mast/Plug/Pillar } *no marks found*
5. A..... ^{above} _{below} set in conc./rock has been placed/found, bearing.....°M from Mast/Plug/Pillar }
6. A..... ^{above} _{below} set in conc./rock has been placed/found, bearing.....°M from Mast/Plug/Pillar
7. A..... ^{above} _{below} set in conc./rock has been placed/found, bearing.....°M from Mast/Plug/Pillar

8. Action required: *4 days clearing for 360° vision, suitable for conc. pillar*
1 day clearing for optimisation requirements (lanes on TS and 283 M)

STANDPOINT:			
Mark	Direction	Horiz. Distance	Height Difference
			above standpt.
			below standpt.
			above standpt.
			below standpt.
			above standpt.
			below standpt.
			above standpt.
			below standpt.
			above standpt.
			below standpt.
			above standpt.
			below standpt.
			above standpt.
			below standpt.

Prepared by: D. Kinlyde Checked: *A. Paterson 8/11/78* Noted on U.T.M. Card

GS

STATION **R.A.BBIT Ts 3833**

Owner's Name: **M. W. McINTOSH**
 Address: **C. LAUREVAUX**
 Phone: **CL. 0065 056**

Current Occupant:
 Address:
 Phone:

ACCESS

Access Report of 18.12.1971 was found suitable/unsuitable.

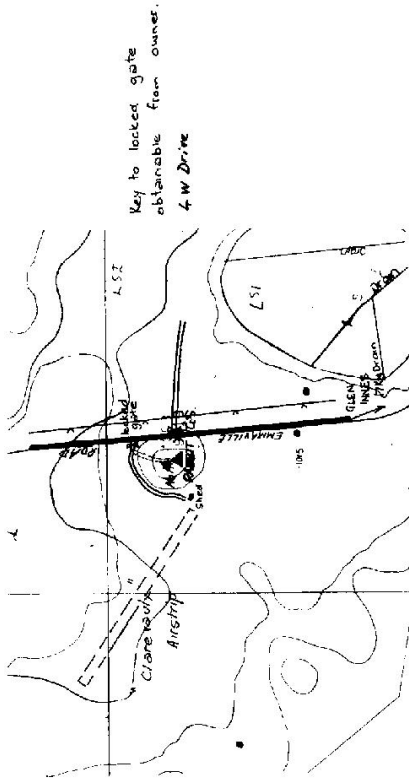

Beacon Diagram	Not to Scale
[Grid area for diagram]	

This section to be completed by officer constructing pillar.

Original station mark found/not found.

Description of mark:

Original beacon found/not found.

Description of beacon:

Height Top of Vanes to Top Markm.

Height of markm. above G.L. / below

Diameter of Vanesm. Height of Cairnm.

Original Beacon has/has not been destroyed by me.

Date	Record of Station