

CENTRAL MAPPING AUTHORITY

GEODETIC SURVEY OF N.S.W.

GEODETIC STATION RECONNAISSANCE and MAINTENANCE REPORT

Description:

Note: Cross out word or words which do not apply

1. Cleared by lanes bearing $118^{\circ} 20' 30''$ ~~North~~ ~~to~~ ~~350'~~ ~~from~~ ~~Trig. Mast~~
2. Mast & Vanes have been painted white & black respectively. ✓
3. The station/~~pillar~~ was unpiled/~~was not used~~/~~was replaced~~ on $11-9-80$, dimensions now being: ~~285~~ ~~Trig. base~~ should be explicit, e.g., S/Steel Pillar Plate, Steel plug, Brass plug, Bolt, G.I. Pipe
- Description of mark: ~~Brass Trig base~~
- Height of mark 0.055 m. ~~above~~ ~~rock/concrete~~; Mark is 0.055 m. ~~above~~ ~~G.L.~~
- Height of Top Vanes to Top Mark/~~Plate~~ 3.588 m. ✓ Diameter of Vanes (vertical) 1.010 m.
- Height of Cairn 1.300 m. ✓ Diameter of Cairn 2.400 m. ✓ Name Plate ~~found~~/~~not found~~/~~placed~~.
- Length of Mast 3.663 m. (approximate if not unpiled)
4. A. ~~Copper Nail~~ set in conc/~~rock~~ has been placed/~~found~~, bearing 269° M from Mast/Plug/Pillar
5. A. ~~G.I. Pipe~~ set in conc/~~rock~~ has been placed/~~found~~, bearing 230° M from Mast/Plug/Pillar
6. A. set in conc/rock has been placed/~~found~~, bearing 155° M from Mast/Plug/Pillar
7. A. set in conc/rock has been placed/~~found~~, bearing 155° M from Mast/Plug/Pillar

8. Action required: ~~Pillar construction~~

STANDPOINT: ~~BRASS TRIG AVE IN ROCK~~ STANDPOINT: ~~G.I. PIPE IN CONC~~

Mark	Direction	Horiz. Distance	Height Difference	Mark	Direction	Horiz. Distance	Height Difference
ADJUTANTY BS (P)	$0^{\circ} 00' 00''$		above standpt	ADJUTANTY BS (P)	$0^{\circ} 00' 00''$		above standpt
G.I. PIPE	$0^{\circ} 08' 16''$	5.250	below	BOLEMAN BS (P)	$49^{\circ} 22' 00''$		below standpt
BOLEMAN BS (P)	$49^{\circ} 20' 50''$		above standpt	ENMAN BS	$95^{\circ} 42' 20''$		above standpt
COPPER NAIL	$49^{\circ} 16' 00''$	5.183	above standpt	COPPER NAIL	$115^{\circ} 30' 00''$	4.332	above standpt
ENMAN BS	$95^{\circ} 37' 40''$		below	BRASS TRIG base	$140^{\circ} 08' 00''$	5.250	below
			above standpt				above standpt
			below				below

Prepared by: ~~Boys~~ $24-9-80$. Checked: ~~Dr. M. ...~~ $24/9/80$ Noted on U.T.M. Card ~~Spillman~~ $11/5/81$, Checked

St 2733-1

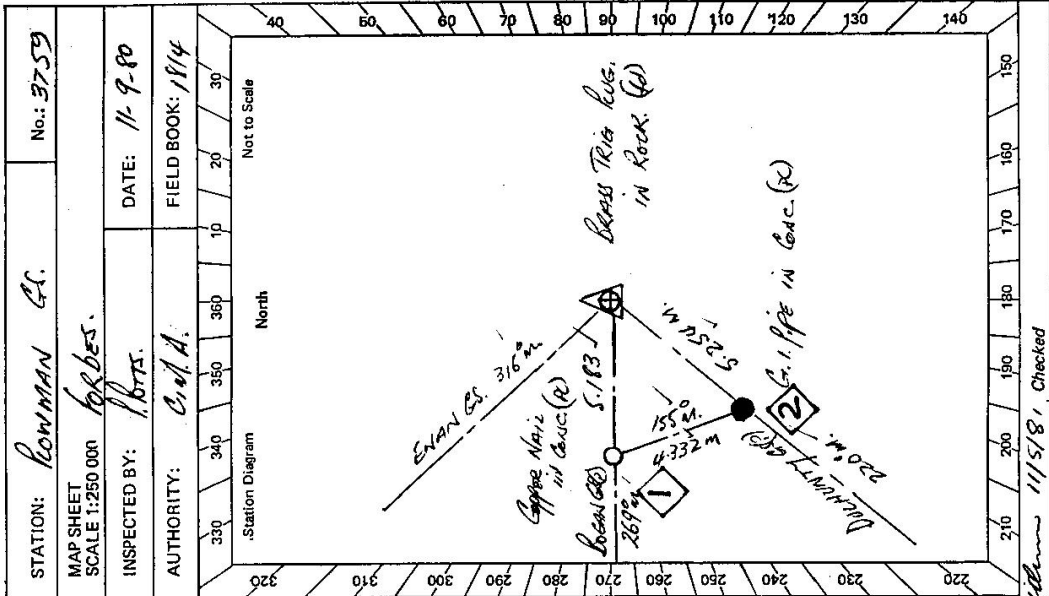

STATION: ROWMAN G.I. No.: 3759

MAP SHEET SCALE 1:250 000

INSPECTED BY: B.Boys DATE: 11-9-80

AUTHORITY: C.M.A. FIELD BOOK: 1814

STATION **RONNIMAN BR.** TS **3759**

Owner's Name: **Mr. JOHN RHODES**
 "NERONIA"
 Address: **CONDODOCIN ROADS**
TRIG RESERVE 28 031.
 Phone:

Current Occupant:

ACCESS

Access Report of 11.1.1988 was found suitable/unsuitable.
FERRIERE.
 0.00. **NO. MAKES HEAD NORTH ON CARLYNG STREET**
 0.10 **TURN LEFT INTO CHURCH STREET**
 0.30 **TURN RIGHT INTO CLARKINA STREET**
 0.50 **TURN LEFT INTO BUSHMAN STREET**
 1.30 **TURN RIGHT ONTO MAKES - CONDODOCIN ROADS**
 6.00 **RAILWAY LINE CROSSING**
 23.40 **CROSS INTERSECTION MAKES - CONDODOCIN**
MONTECLA - GUNNIBLAND
 24.70 **TURN RIGHT ONTO BEAVEL ROAD**
 25.70 **TURN RIGHT WHITE MALE BOX J# J RHODES "NERONIA"**
TO THROUGH DOUBLE IRON GATES.
 26.00 **DOUBLE IRON GATES (SINGLE GATE LEADS TO MR RHODES HOUSE)**
 26.20 **DOUBLE IRON GATES - THEN TURN RIGHT & FOLLOW FENCE.**
 26.90 **TURN LEFT & BELOW FENCE LINE**
 27.50 **GEODETIC STATION RONNIMAN.**

NOTE: THIS STATION SUITABLE FOR CONCRETE PILE

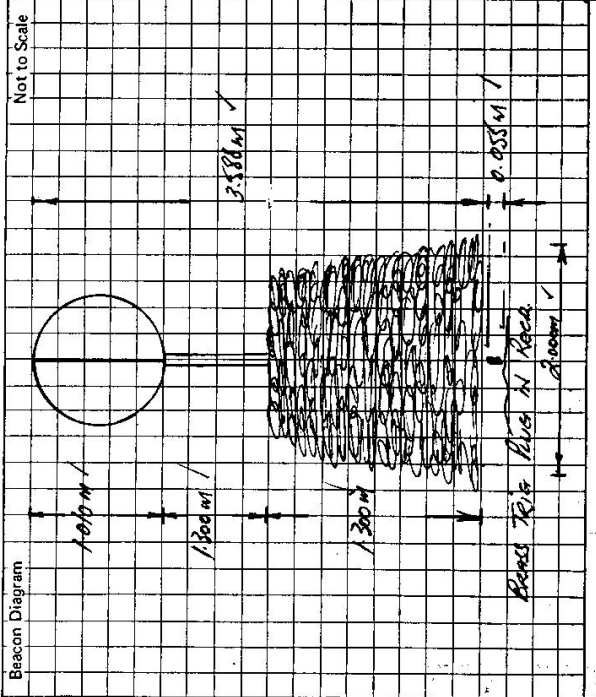

This section to be completed by officer constructing pillar.

Original station mark found/~~not found~~.
 Description of mark: **TRIG PILE**
 Original beacon found/~~not found~~.
 Description of beacon: **Cairn box & Disc**
 Height Top of Vanes to Top Mark: **3.775** m.
 Height of mark: **2.055** m. above rock/~~conc~~ m. above G.L.
 Diameter of Vanes: **0.70** m. (Double Vanes) below
 Height of Cairn: **1.200** m.
 Original Beacon has/~~has not~~ been destroyed by me.

Record of Station

Date	By
11/1/88	Mr. Copper Natic
06/01/88	49 21 50 ✓
EVAN BR.	95 42 00 ✓
BEAMS TRIG PILE	229 11 20 ✓ 5.183 ✓ 0.007 below STATION
G.L. ME	245 30 00 ✓ 4.332 ✓ 0.143 ✓ ABOVE STATION