

CENTRAL MAPPING AUTHORITY
Department of Lands

Trigonometrical Survey of N.S.W.

RECONNAISSANCE and MAINTENANCE REPORT

This Trig. Station has been:-

Note: Cross out word or words which do not apply

1. ~~Completely cleared to permit 360° vision to surrounding trigs.~~
2. Cleared by lanes bearing from Trig. Mast
3. Trig. Mast & Vanes have been painted white & black respectively.
Pillar constructed 11 Nov 1922
4. The Trig. was unpiled/~~near-emptied~~ dimensions now being-
Description of mark Steel pillar plate should be explicit, e.g. Steel plug, Brass plug, Bolt, G.I. Pipe
Height of mark m ^{GL} above ~~rock/concrete~~ below G.L. Diameter of Vanes (vertical) 0.91 m.
- Height of Top Vanes to Top Mark 2.070 m.
- Height of Cairn m. Diameter of Cairn m.
- Length of Mast m. (approximate if not unpiled)
5. A. S.S.M. set in conc/~~rock~~ has been placed ^{GL} 5.823 m. bearing 289 °M from Trig. Mast
6. Conc. Case set in conc/~~rock~~ has been placed ^{GL} 2.802 m. bearing 297 °M from Trig. Mast
7. A G.I. Pipe set in conc/~~rock~~ has been placed ^{GL} 3.732 m. bearing 341 °M from Trig. Mast
8. A set in conc/rock has been placed m. bearing °M from Trig. Mast
9. Connection S.S.M. to G.I. Pipe : 4.535 m. bearing 70 °M
10. Connection ^{Cartridge Case} to S.S.M. : 3.043 m. bearing 286 °M
11. Connection ^{Case} to G.I. Pipe : 2.624 m. bearing 31 °M
12. Connection to m. bearing °M
13. Diff. Hr. Pillar Plate is 1.490 m. ^{above} ~~below~~ Cartridge Case
14. Diff. Hr. Pillar Plate is 1.213 m. ^{above} ~~below~~ S.S.M.
15. Diff. Hr. Pillar Plate is 1.172 m. ^{above} ~~below~~ G.I. Pipe
16. Diff. Hr. is m. ^{above} ~~below~~

Prepared by: *[Signature]* Checked: _____

Noted on U.T.M. Card

STATION PARROTS NEST (Pillar) GS TS 3673
Co: Roos Ph: South Gundurimba
Map Sheet: LISMORE No: 9540-S
Inspected by: G. Milby Date: 8 Aug 74
Authority: C.M.A. Field Book: 1334

Beacon Diagram Not to Scale

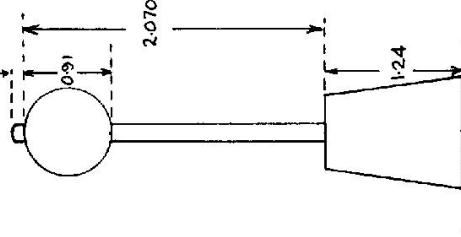

Date 18/11/72 Record of Station

Original beacon removed & replaced by conc. pillar.

Checked

STATION PARROTS NEST GS IS 3673

Owners Name: Mr. Tom O'LEXY

Address: Tunceator Road

LISMORE

B74 Access 8-8-1974

Km. 0.0

9.0

13.5

13.65

14.5

Not to Scale

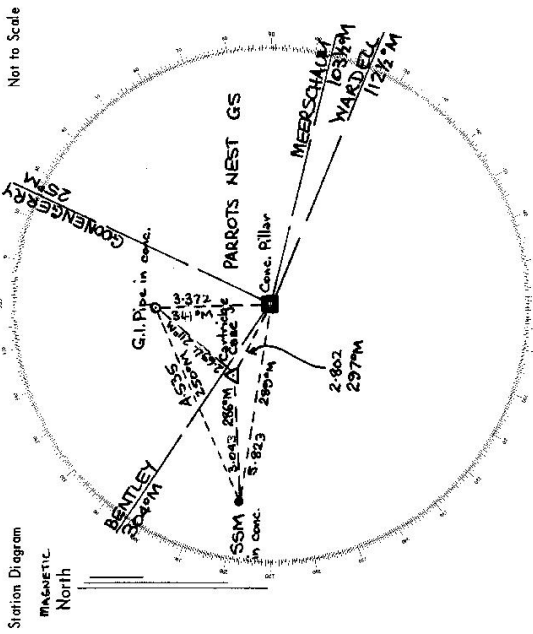

List of Observed Directions:-

Standpoint: Conc. Pillar		Standpoint:	
Station	Direction	Station	Direction
BENTLEY	352	SSM in conc.	344.49
G.I. Pipe in conc.	35	Cartridge Case in conc.	342.47
GOOENGERY	81		
MEERSCHAUM	160		
WARDELL	169		
Standpoint: Cartridge Case		Standpoint:	
Station	Direction	Station	Direction
BENTLEY	352	WARDELL	169
GOOENGERY	81	SSM in conc.	340.14
G.I. Pipe in conc.	84		
MEERSCHAUM	160		
Conc. Pillar	169		

Feature
 Lismore P.O. Travel south via Malsworth St and turn right onto Brunner Hwy.
 Casino turn-off. Turn right & follow road in northerly direction along top of ridge.
 Pass PMG towers.
 Turn off main track to your left just below main barbed wire gate to homestead, through steel gate on same fence-line.
 Proceed along flat ridge.
 Steel gate. Turn right along rough rocky track, along side of ridge under high tension wires to small timbered knob.
 Go through gap in timber on top of knob.
 Barbed wire gate.
 Follow very faint track through long grass in a westerly direction for about 150 yards to Trig.

7498

Trigonometrical Survey of N.S.W.

RECONNAISSANCE and MAINTENANCE REPORT

Department of Lands

STATION **PARROTS NEST GS (Rillar) TS 3673**

Co: **Rous** Ph: **South Gundurimbah**

Map Sheet: **LISMORE** No: **9540-S**

Inspected by: **D. Kain** Date: **8 August 1977**

Authority: **C.M.A.** Field Book: **1408**

This Trig. Station has been:-

1. Completely cleared to permit 360° vision to surrounding Trigs.
2. Cleared by lanes bearing **290-183° M.** **200-263° M.** from Trig. Mast
3. Trig. Mast & Vanes have been painted white & black respectively.
4. The Trig. was unpiled/not unpiled, dimensions now being: **.....** should be explicit, e.g. Steel plug, Brass plug, Bolt, G.I. Pipe

Description of mark.....

Height of mark..... m above rock/concrete..... m below G.L.

Height of Top Vanes to Top Mark..... m. Diameter of Vanes (vertical)..... m.

Height of Cairn..... m. Diameter of Cairn..... m.

Length of Mast..... m. (approximate if not unpiled)

5. A. G.I. Pipe..... set in conc/rock has been ^{found} placed..... m. bearing..... °M from Trig. Mast
6. A. S.S.M..... set in conc/steel has been ^{found} placed..... m. bearing..... °M from Trig. Mast
7. A..... set in conc/soil has been placed..... m. bearing..... °M from Trig. Mast
8. A..... set in conc/rock has been placed..... m. bearing..... °M from Trig. Mast
9. Connection..... to..... m. bearing..... °M
10. Connection..... to..... m. bearing..... °M
11. Connection..... to..... m. bearing..... °M
12. Connection..... to..... m. bearing..... °M
13. Diff. Ht. is..... m. ^{above} below
14. Diff. Ht. is..... m. ^{above} below
15. Diff. Ht. is..... m. ^{above} below
16. Diff. Ht. is..... m. ^{above} below

Prepared by: *[Signature]* Checked: *[Signature]* Noted on U.T.M. Card

Beacon Diagram

Not to Scale

0.305

1.425

1.215

Mast & vanes erected

Date..... Record of Station.....

GEODETIC SURVEY OF N.S.W.

CENTRAL MAPPING AUTHORITY

GEODETIC STATION RECONNAISSANCE and MAINTENANCE REPORT

Description:

Note: Cross out word or words which do not apply

1. Cleared by James bearing ~~1.0 m. ...~~ ...
 2. Mast & Vanes have been painted white & black respectively.
 3. The station/pillar was unpiled/not unpiled/constructed on ...
- Description of marks: S.I.S. Pillar. Plate should be explicit, e.g., S/Steel Pillar Plate, Steel plug, Brass plug, Bolt, G.I. Pipe
- Height of mark ... m. above rock/concrete; Mark is ... m. above below G.L.
- Height of Top Vanes to Top Mark/Pillar plate ... m. Diameter of Vanes (vertical) ... m.
- Height of Cairn ... m. Diameter of Cairn ... m. Name Plate found/not found/placed.
- Length of Mast ... m. (approximate if not unpiled)
4. A...C... set in conc/teeek has been placed/found, bearing 2.25. °M from Mast/Plug/Pillar 2. 8 m
 5. A...S... set in conc/teeek has been placed/found, bearing 2.22. °M from Mast/Plug/Pillar 5. 2 m
 6. A...G... set in conc/teeek has been placed/found, bearing 3.4. °M from Mast/Plug/Pillar 3. 4 m
 7. A... set in conc/rock has been placed/found, bearing ... °M from Mast/Plug/Pillar
 8. Action required: New name plate, painting, cleaning, ...

STANDPOINT: Pillar Plate

Mark	Direction	Hez. Distance	Height-Difference	Mark	Direction	Hez. Distance	Height-Difference
REQUIREMENTS							
LISMORE	32° 41' Grid	Orange & white	above standpt	BROOKLET	65° 23' Grid	P	above standpt
TREGERGLE	85° 33' "	New house	above standpt	CASINO	261° 42' "	ON	above standpt
WYRALLAH	112° 20' "	Cairn	above standpt	BUGHTONS GAP	208° 46' "	Doubtful	above standpt
WARRDELL	125° 21' "	Gap in hill	below	BARNEDE	295° 37' "	Not on	above standpt
OTHERS				BENTLEY	315° 28' "	Timbered hill	below
ELLINGHAM	226° 34' "	Timbered	above standpt	FERNSIDE	328° 05' "	ON	above standpt
BLUE KNOB	359° 05' "	Large Hill	below	DUNOON	26° 40' "	Not on	above standpt

Prepared by: D. Fredriksen 25/6/80 Checked: P. Holden 26-6-80 Noted on U.T.M. Card

S: 2739-1

STATION: PARROTS NEST 'P' No.: 3673

MAP SHEET SCALE 1:250 000 TWEED HEADS

INSPECTED BY: D. FREDRIKSEN DATE: 26/4/80

AUTHORITY: C. M. A. FIELD BOOK: 1873

Station Diagram

North

Not to Scale

close ridge

conc. pillar fd. Parrots Nest T.S.

S. Petrie 19/80 Checked

GS

STATION PARROTS NEST P IS 2172

Owner's Name: Des. Livingstone
 Address: Northcotts Rd
 Phone: South Coast
 Phone: Lia. Lismore Ph. 286253

Current Occupant:
 Address:
 Phone:

ACCESS

old Access Report of 7/4/1988 was found suitable/unsuitable.

Kms. Feature
 0-00 LISMORE P.O. head towards Casino
 8-6 Pass Coraki and Woodburn Turn off on L.H.S.
 9-3 Turn RIGHT towards Parrots Nest
 11-8 Grid and Gate
 12-6 Pass new brick house on L.H.S.
 12-72 Take faint track to left opposite white tower
 12-79 Thru iron gate
 12-97 Thru iron gate cross open paddock
 13-21 start of cutting on R.H.S. of ridge
 13-59 over knob under power lines
 13-77 Turn LEFT off track up hill
 13-92 Thru wire gate
 14-03 At trig.

2733-2 D. West. Government Printer

Beacon Discrepan	OTHER	TRIGS	cbnd	Net-to-See
MUMULGI	42'3"	Grid	Bald hill	
CLUNES	54'21"		Windbreak on hill	
MJEANS RIDGE	72'53"		NOT ON	
ROUS MILL	111'46"		Tree clumps on bare hill	
MEERSCHUM	116'14"		Near tower	
BROADWATER	130'50"		P	
CORAKI	165'01"		Not on	
LEEVILLE	239'10"		Low bald ridge	
PEARCES CREEK	72'08"		Not on	
CHELMSEFORD	326'17"		Not in end timbered ridge	
BILLET	344'59"		Timbered hill, grazing line	
MOUNTAINB	73'31"		Abvtd close ridge	
	72'26"		Trig on water tower	

This section to be completed by officer constructing pillar.

Original station mark found/not found.

Description of mark:

Original beacon found/not found.

Description of beacon:

Height Top of Vanes to Top Mark.....m.

Height of mark.....m. above G.L. below

Diameter of Vanesm. Height of Cairnm.

Original Beacon has/has not been destroyed by me.

Date	Record of Station
	clearing & access permission granted at any time

CENTRAL MAPPING AUTHORITY

GEODETIC SURVEY OF N.S.W.

GEODETIC STATION RECONNAISSANCE and MAINTENANCE REPORT

STATION: **PARROT'S NEST (P)** No: **3673**

MAP SHEET
SCALE 1:250 000

INSPECTED BY: **C. PARKES**

DATE: **17/12/80**

AUTHORITY: **C.M.A.** FIELD BOOK: **1695**

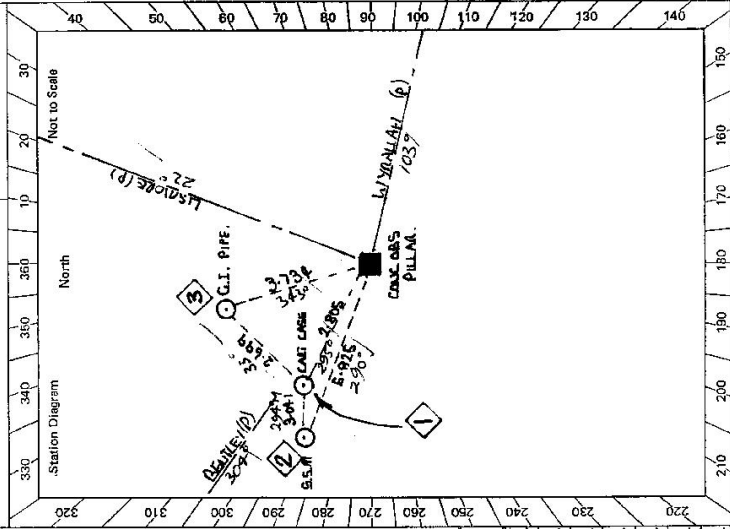

- Description: **Note: Cross out word or words which do not apply**
- Cleared by lanes bearing **300° to 135°** to **200° to 210°** from Trig. Mast
 - Mast & Vanes have been painted white & black respectively. ✓
 - The station/pillar was unpilled/~~not unpilled~~/~~constructed~~ on **17/12** **1980**, dimensions now being: Description of mark **STEEL PILLAR PLATE** could be explicit, e.g., S/Steel Pillar Plate, Steel plug, Brass plug, Bolt, G.I. Pipe
Height of mark **1.215** m. ^{above} **1.375** m. ^{above} ~~below~~ G.L.
Height of Top Vanes to Top Mark/Pillar plate **1.425** m. Diameter of Vanes (vertical) **0.500** m.
Height of Cairn **0.000** m. Diameter of Cairn **0.000** m. Name Plate found/~~not found~~/placed.
Length of Mast **0.000** m. (approximate if not unpilled)
 - A **S.S.M.** set in conc/~~rock~~ has been ~~placed~~/found, bearing **290.00**° M from Mast/~~Plug~~/Pillar
 - A **CARTRIDGE CASE** set in conc/~~rock~~ has been ~~placed~~/found, bearing **295.00**° M from Mast/~~Plug~~/Pillar
 - A **G.I. PIPE** set in conc/~~rock~~ has been ~~placed~~/found, bearing **303.00**° M from Mast/~~Plug~~/Pillar
 - A **CONCRETE PILLAR** set in conc/~~rock~~ has been ~~placed~~/found, bearing **103.00**° M from Mast/~~Plug~~/Pillar
 - Action required: **None**

STANDPOINT: PILLAR PLATE			STANDPOINT: CARTRIDGE CASE		
Mark	Direction	Horiz. Distance	Mark	Direction	Horiz. Distance
LISMORE (P)	0 00 00		LISMORE (P)	0 00 00	
WYKALLAH (P)	79 38 50		WYKALLAH (P)	79 37 55	
S.S.M.	261 36 50	5.825	PILLAR PLATE	91 29 05	4.805
CARTRIDGE CASE	272 34 25	2.804	S.S.M.	263 04 35	3.041
BEATLEY	282 47 00		BEATLEY (P)	282 46 05	
G.I. PIPE	318 36 35	3.734	G.I. PIPE	7 03 50	1.699

Prepared by: **C. PARKES** Checked: **[Signature]** Noted on U.T.M. Card

CSI

STATION **PARROTS NEST (P) TS 3673**

Owner's Name: **DES. LIVINGSTONE**
 Address: **MARATHOTTIS Rd**
SOUTH CUMBUJURABA
 Phone: **186253**

Current Occupant:
 Address:
 Phone:

ACCESS

Access Report of **17/12/1985** was found suitable/unsuitable.
K.A.
SECTION
LEISURE P.O. HEAD TOWARDS CASINO.
8-60 PASS CORAKI AND WOODBURN TURN OFF ON L.H.S.
9-30 TURN RIGHT TOWARDS PARROTS NEST.
11-80 CAR AND GATE.
11-60 PASS BRICK HOUSE ON L.H.S.
12-72 TAKE FAINT TRACK TO LEFT OPPOSITE WHITE TOWER.
12-79 THROUGH IRON GATE.
12-97 THROUGH IRON GATE AND ACROSS Paddock.
13-21 START OF CUTTING ON R.H.S. OF RIDGE.
13-59 OVER RIDGE UNDER POWER LINES.
13-77 TURN LEFT OFF TRACK UP HILL.
13-91 THROUGH WIRE GATE.
14-03 PARROTS NEST G.S. OP.

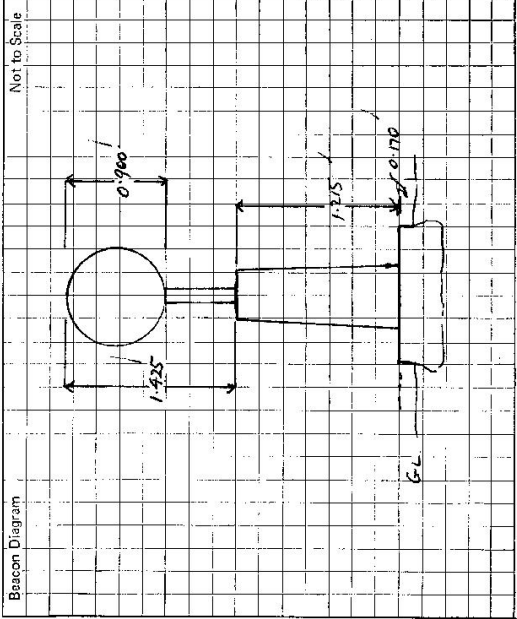

This section to be completed by officer constructing pillar.

Original station mark ~~found~~ not found.

Description of mark: **CANTONMENT CASE IN CONC**

Original beacon ~~found~~ not found.

Description of beacon:

Height Top of Vanes to Top Mark:m.

Height of mark: **0.15** above **0.05** below G.L.

Diameter of Vanes:m. Height of Cairn:m.

Original Beacon has not been destroyed by me.

Date	Record of Station