

Department of Lands  
 Integral Survey of N.S.W.  
 RECONNAISSANCE and MAINTENANCE REPORT

STATION T.S. 3646 PADDINGTON

Co: CLIMBERLAND Ph: ALE YANDRIA  
 Map Sheet: SYDNEY — 1845 No: 1845  
 Inspected by: J. KWASNICA Date: 27. 6. 79  
 Authority: ISB Field Book: DDP 876  
 Beacon Diagram Not to Scale

This Trig. Station has been: Integral Survey of N.S.W.

NATURAL 360° VISION

from Trig. Mast

MADE IN 5/5 Δ

should be explicit, e.g. Steel plug, Brass plug, Bolr, Concrete Pillar

1. Completely cleared to permit 360° vision to surrounding Trigs. NATURAL 360° VISION

2. Cleared by lances bearing MADE IN 5/5 Δ

3. Trig. Mast & Vanes have been painted white & black respectively.

4. The Trig. was unpiled/not unpiled, dimensions now being: MADE IN 5/5 Δ

Description of mark: MADE IN 5/5 Δ

Height of mark: MADE IN 5/5 Δ m above rock/concrete

Height of Top Vanes to Top Mark/Top pillar plate MADE IN 5/5 Δ m Diameter of Vanes (vertical) MADE IN 5/5 Δ m.

Height of Cairn MADE IN 5/5 Δ m. Diameter of Cairn MADE IN 5/5 Δ m.

Length of Mast MADE IN 5/5 Δ m. (approximate if not unpiled)

5. A BRASS Δ 2 set in conc. MADE IN 5/5 Δ has been placed 43.203 m. bearing 263 <sup>MADE IN 5/5 Δ</sup> from Trig. Mast/pillar

6. A BRASS Δ 1 set in conc./soil has been placed 43.104 m. bearing 302 <sup>MADE IN 5/5 Δ</sup> from Trig. Mast/pillar

7. A MADE IN 5/5 Δ set in conc./soil has been placed 43.104 m. bearing 302 <sup>MADE IN 5/5 Δ</sup> from Trig. Mast/pillar

8. A MADE IN 5/5 Δ set in conc./rock has been placed 43.104 m. bearing 302 <sup>MADE IN 5/5 Δ</sup> from Trig. Mast/pillar

9. Connection BRASS Δ 1 to BRASS Δ 2 8.986 m. bearing 188 <sup>MADE IN 5/5 Δ</sup>

10. Connection MADE IN 5/5 Δ to MADE IN 5/5 Δ MADE IN 5/5 Δ m. bearing MADE IN 5/5 Δ

11. Connection MADE IN 5/5 Δ to MADE IN 5/5 Δ MADE IN 5/5 Δ m. bearing MADE IN 5/5 Δ

12. Connection MADE IN 5/5 Δ to MADE IN 5/5 Δ MADE IN 5/5 Δ m. bearing MADE IN 5/5 Δ

13. Diff. Ht. BRASS Δ 2 is 3.999 m. above MADE IN 5/5 Δ (TS)

14. Diff. Ht. BRASS Δ 1 is 0.042 m. above MADE IN 5/5 Δ (TS)

15. Diff. Ht. BRASS Δ 2 is 3.956 m. above BRASS Δ 1

16. Diff. Ht. MADE IN 5/5 Δ is MADE IN 5/5 Δ m. above MADE IN 5/5 Δ

Prepared by: John Kwasnica Checked: CV

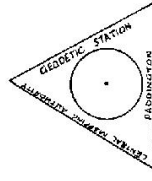

Date	MAIL IN STAINLESS STEEL Δ	Record of Station
27/6/79	RECOVERY MARKS	PLACED

STATION TS 3646 PADDINGTON

Owners Name..... **OTC**  
 Current Occupant..... **OTC**  
 Address..... **ANZ BUILDING, 5<sup>TH</sup> FLOOR, 20 MARTIN PLACE, SYDNEY.**  
 Address..... **ANZ BUILDING, 5<sup>TH</sup> FLOOR, 20 MARTIN PLACE, SYDNEY.**  
 TOP OF OTC BUILDING  
 Access 361 Oxford St. Paddington.  
 Access 21-6-1831

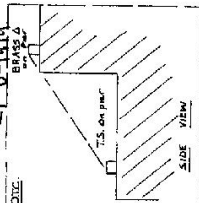
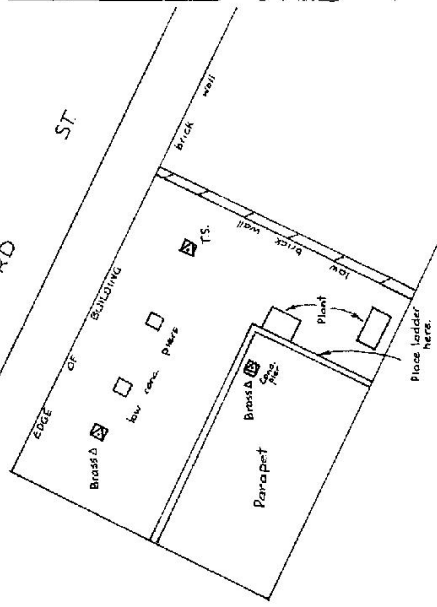

Contact OTC officer 230 - 5744. Then pick him up 5th Floor. ANZ building, 20 Martin Place, Sydney. He will take you to 361 Oxford Street, Paddington where security at ground floor will be arranged. Ladder can be obtained from storeroom on 3rd floor after enquiring. (OTC will move to MLC building end of 1979).

D. West, Government Printer, New South Wales - 1976

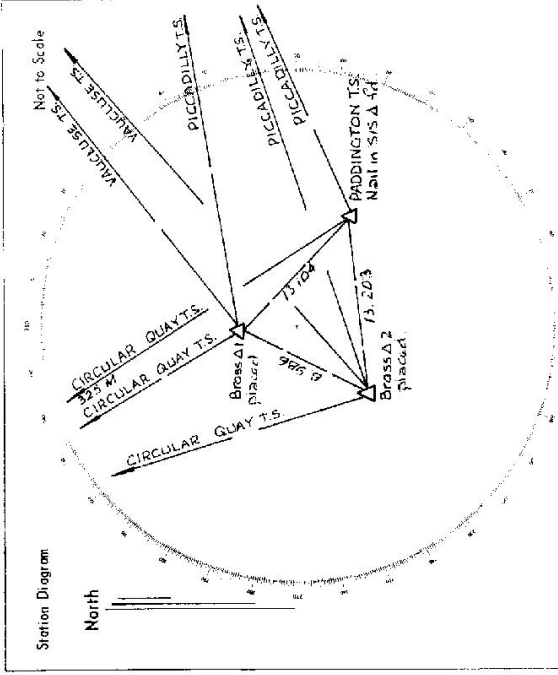

List of Observed Directions:-

Station	Direction	Station	Direction
TS 10297 (CIRCULAR QUAY)	320° 00' 00"	TS 10297 (CIRCULAR QUAY)	345° 00' 00"
TS 10008 (PICCADILLY)	71° 18' 19"	TS 4537 (MULLUSE RES)	44° 49' 54"
TS 3646 B12 (PADDINGTON)	263° 02' 44"	TS 10008 (PICCADILLY)	66° 47' 21"
TS 3646 B71 (PADDINGTON)	302° 59' 36"	TS 3646 (PADDINGTON)	117° 55' 26"
TS 3646 B72 (PADDINGTON)	68° 32' 49"	TS 3646 B72 (PADDINGTON)	68° 32' 49"
Brass A 2			
TS 10297 (CIRCULAR QUAY)	320° 00' 00"	Station	Direction
TS 3646 B71 (PADDINGTON)	15° 24' 41"		
TS 4537 (MULLUSE RES)	49° 38' 07"		
TS 10008 (PICCADILLY)	71° 14' 32"		
TS 3646 (PADDINGTON)	82° 50' 20"		