

Integra  
a division of N.S.W.

Department of Lands

RECONNAISSANCE and MAINTENANCE REPORT 3631

STATION ORCHARD HILLS (P)

TS 3631

This Trig. Station has been:-

Note: Cross out word or words which do not apply

1. Completely cleared to permit 360° vision to surrounding Trigs.

2. Cleared by lanes bearing from Trig. Mast

Co: \_\_\_\_\_ No: \_\_\_\_\_  
 Map Sheet: \_\_\_\_\_ Date: \_\_\_\_\_  
 Inspected by: \_\_\_\_\_  
 Authority: \_\_\_\_\_ Field Book: \_\_\_\_\_

Beacon Diagram  
Not to Scale

STATION <u>ORCHARD HILLS (P)</u> <u>RES</u> <u>RES</u>				
To	R.L. (metres)	Direction or Vert. Angle	Variance	Observer
		Observer	Date	Date
			± 1.03	
			± 0.10	
<p>REMARKS: H.L. = 90.3 m. AHD Levelled 2/10/05</p>				

All sections corrected to centre  
 G 38  
 13. Vert. m. .... is ..... m. below  
 14. Diff. Ht. .... is ..... m. above  
 15. Diff. Ht. .... is ..... m. below  
 16. Diff. Ht. .... is ..... m. above  
 Prepared by: \_\_\_\_\_  
 Checked: \_\_\_\_\_

Date \_\_\_\_\_ Record of Station  
 \_\_\_\_\_  
 \_\_\_\_\_  
 \_\_\_\_\_  
 \_\_\_\_\_

STATION TS 3631 ORCHARD HILLS (P)

Current Occupant

Owners Name

Address

Address

Access

STATION ORCHARD HILLS RES P 210

To

From/To

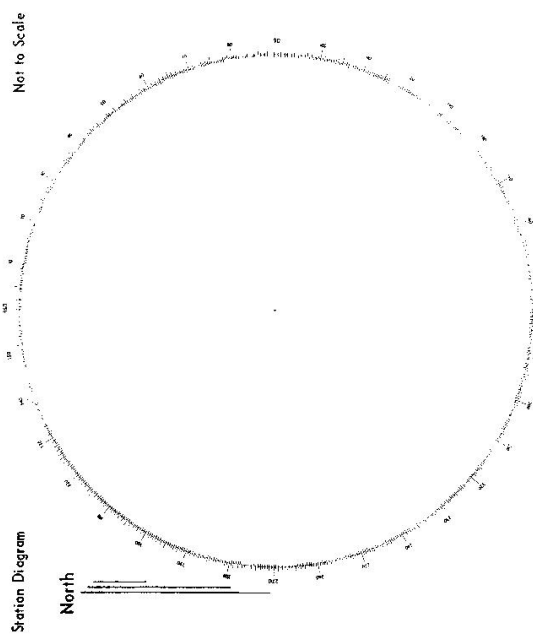

List of Observed Directions:-

Standpoint:		Standpoint:	
Station	Direction	Station	Direction
Station	Direction	Station	Direction

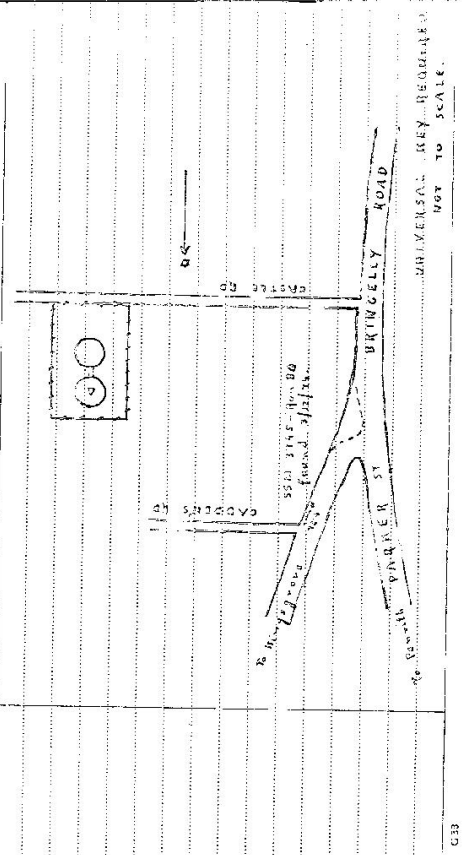

D. West, Government Printer, New South Wales - 1976

75103

Department of Lands  
Integr. Survey of N.S.W.  
RECONNAISSANCE and MAINTENANCE REPORT 3631

STATION ORCHARD HILLS (P) TS 3631

Map Sheet: \_\_\_\_\_ Ph: \_\_\_\_\_ No: \_\_\_\_\_  
 Inspected by: C. STRAKEY Date: 15/8/15  
 Authority: DEPT. LANDS Field Book: 66887

Beacon Diagram: Not to Scale

This Trig. Station has been:-  
 1. Completely cleared to permit 360° vision to surrounding Trigs.  
 2. Cleared by fence-bearing ..... from Trig. Mast  
 3. Trig. Mast & Vanes have been painted white & black respectively.  
 4. The Trig. was unpiled/ret-unpiled, dimensions now being:  
 Description of mark ..... should be explicit, e.g. Steel plug, Brass plug, Bolt, Concrete Pillar  
 Height of mark ..... m above rock/concrete ..... m below G.L.  
 Height of Top Vanes to Top-Mark/Top pillar plate 2.54 ..... m Diameter of Vanes (vertical) ..... m.  
 Height of Cairn ..... m Diameter of Cairn ..... m.  
 Length of Mast 1.24 ..... m. (approximate if not unpiled)  
 5. A ..... set in conc./rock has been placed/d ..... m. bearing .....°M from Trig. Mast/pillar  
 6. A ..... set in conc./soil has been placed/d ..... m. bearing .....°M from Trig. Mast/pillar  
 7. A ..... set in conc./soil has been placed/d ..... m. bearing .....°M from Trig. Mast/pillar  
 8. A ..... set in conc./rock has been placed/d ..... m. bearing .....°M from Trig. Mast/pillar  
 9. Connection ..... to ..... m. bearing .....°M  
 10. Connection ..... to ..... m. bearing .....°M  
 11. Connection ..... to ..... m. bearing .....°M  
 12. Connection ..... to ..... m. bearing .....°M  
 13. Diff. Ht. .... is ..... m. above below  
 14. Diff. Ht. .... is ..... m. above below  
 15. Diff. Ht. .... is ..... m. above below  
 16. Diff. Ht. .... is ..... m. above below

Beacon Diagram:

Date	Record of Station

Prepared by: C. STRAKEY  
 Checked: S. H. J.

STATION ORCHARD HILLS / (D) TS 3631

Owners Name: .....  
 Current Occupant: .....  
 Address: .....  
 Address: .....

Access 18/8/1975  
 FROM KINGSWOOD TAKE BRINGELLY RD  
 TS is on left at about 3km.

Not to Scale

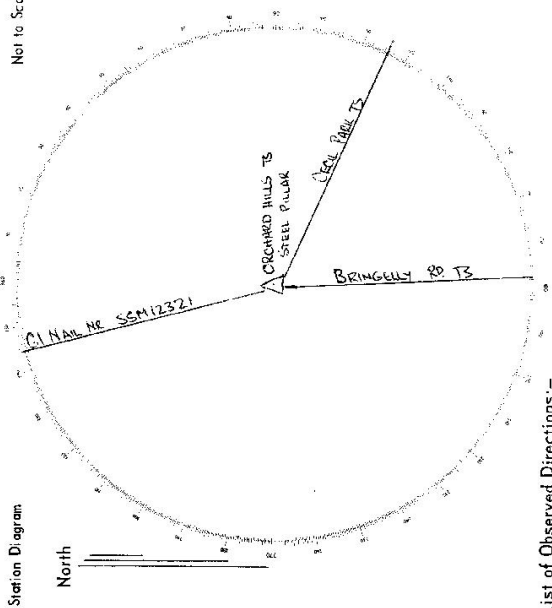

List of Observed Directions:-

Standpoint: 1144r		Standpoint:	
Station	Direction	Station	Direction
ORCH. PULAK TS	0° 00' 26"		
BRINGELLY RD TS	80° 55' 43.5"		
GI NAIL no. 55M12321	228° 30' 19.5"		
Station	Direction	Station	Direction