

75-10.3

Department of Lands

Integrating Survey of N.S.W.

RECONNAISSANCE and MAINTENANCE REPORT 3544 STATION NORES 7.5. 3544

Co: _____ Ph: _____

Map Sheet: _____ No: _____

Inspected by: L. M. HAYES Date: DEC 1974

Authority: LANDS DEPT. Field Book: 684.32

This Trig. Station has been:- Note: Cross out word or words which do not apply

1. Completely cleared to permit 360° vision to surrounding Trigs.
2. Cleared by lanes bearing _____ from Trig. Mast
3. Trig. Mast & Vanes have been painted white & black respectively.
4. The Trig. was unpiled/not unpiled, dimensions now being:

Description of mark: set steel pin in conc. box should be explicit, e.g. Steel plug, Brass plug, Bolt, Concrete Pillar

Height of mark: 0.05 m ^{above} / rock/concrete ^{below} 0.19 m ^{above} / G.L. ^{below}

Height of Top Vanes to Top Mark/Top pillar: 5.32 m Diameter of Vanes (vertical): 0.92 m.

Height of Cairn: _____ m. Diameter of Cairn _____ m.

Length of Mast: _____ m. (approximate if not unpiled)

5. A. Copper Spike 1 set in conc/rock has been placed/fd 5.853 m, bearing 156°M from Trig. Mast/pillar
6. A. Copper Spike 2 set in conc/soil has been placed/fd 5.831 m, bearing 242°M from Trig. Mast/pillar
7. A. _____ set in conc/soil has been placed/fd _____ m, bearing _____°M from Trig. Mast/pillar
8. A. _____ set in conc/rock has been placed/fd _____ m, bearing _____°M from Trig. Mast/pillar

9. Connection: Copper Spike 1 to Spike 2: 8.172 m, bearing 273°M
10. Connection: _____ to _____ : _____ m, bearing _____°M
11. Connection: _____ to _____ : _____ m, bearing _____°M
12. Connection: _____ to _____ : _____ m, bearing _____°M
13. Diff. Ht. Copper Spike 1 is 0.39 m ^{above} / set steel pin ^{below}
14. Diff. Ht. Copper Spike 2 is 0.14 m ^{above} / set steel pin ^{below}
15. Diff. Ht. _____ is _____ m, ^{above} / ^{below}
16. Diff. Ht. _____ is _____ m, ^{above} / ^{below}

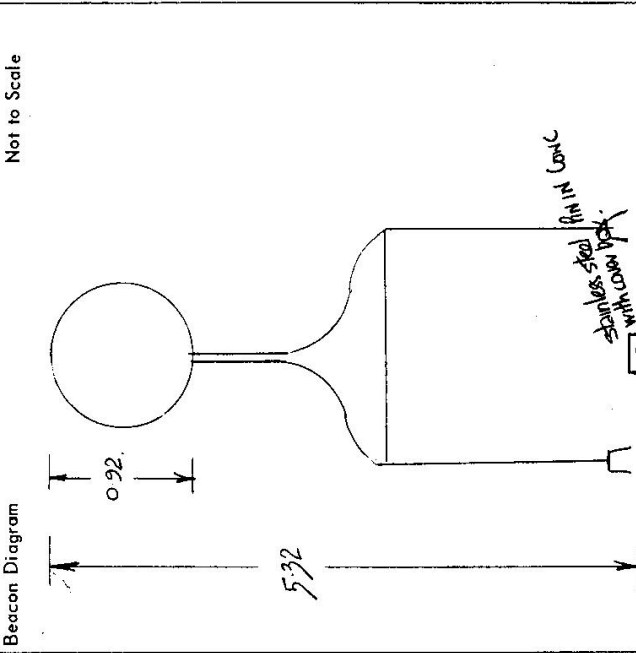

Date	Record of Station

Prepared by: L. M. HAYES Checked: P. Peter. Bray

STATION Nooris TS 3544

Owners Name.....
 Current Occupant.....
 Address.....
 Address.....

Dec 1974

Access CONVENTIONAL VEHICLE IN & DEY WENTHAR

TAKE UZBIA RD FROM LAVINGTON TO CENTRUR RD. ON LEFT. FOLLOW CENTRUR. RD. FOR 2.1KMS. TO ORENOL ST TURN LEFT AND FOLLOW RD TURNING LEFT AT END OF ST. FOLLOW DIRT ROAD TO LARGE WHITE HOUSE ON TOP OF CLISE THEN FOLLOW MAPER SKETCH

Not to Scale

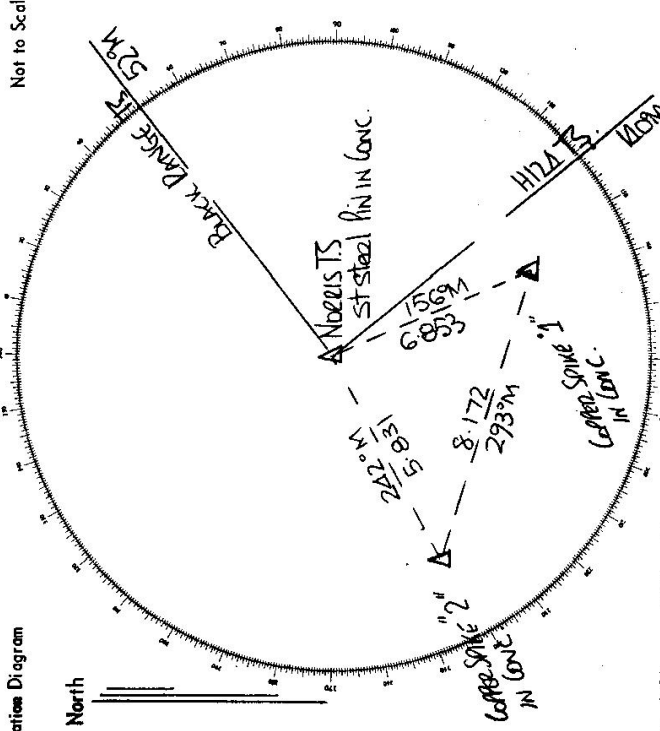

List of Observed Directions:-

Station	Direction	Station	Direction
Black Range TS	359.59' 60"	Nooris TS	
H12A TS	83.43' 11.5"		
Copper Spike 1	111.09' 50.5"		
Copper Spike 2	190.55' 24.5"		
Copper Spike "1"			
Copper Spike "2"	357.59' 60"		
steel pin Nooris TS	44.36' 27"		

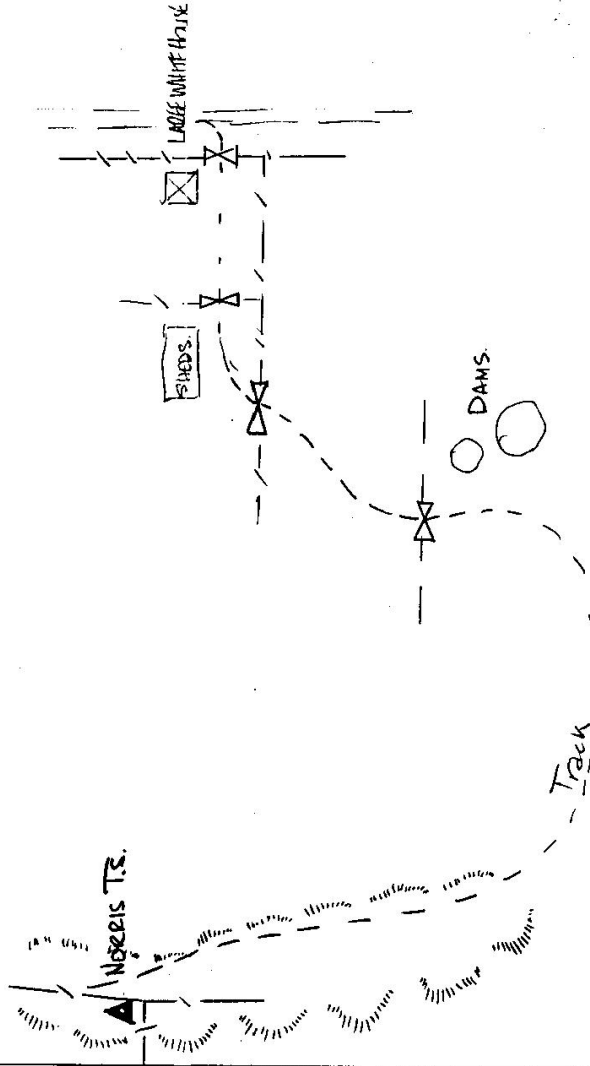

CENTRAL MAPPING AUTHORITY
Department of Lands

Trigonometrical Survey of N.S.W.

RECONNAISSANCE and MAINTENANCE REPORT

This Trig. Station has been:-

Note: Cross out word or words which do not apply

1. Completely cleared to permit 360° vision to surrounding Trig. Stations.
2. Cleared by lanes bearing 10-28°, 40-135°, 305-352°M from Trig. Mast
3. Trig. Mast & Vanes have been painted white & black respectively. ✓ Quadripod needs painting
4. The Trig. was unpiled/not unpiled, dimensions now being: _____

Description of mark: S/S Pin in conc. base (No. 10) should be explicit, e.g. Steel plug, Brass plug, Bolt, G.I. Pipe
 Height of mark: 0.03 m above rock/concrete m above below G.L.
 Height of Top Vanes to Top Mark: 5.297 m. ✓ Diameter of Vanes (vertical): 0.22 m.
 Height of Cairn: m. Diameter of Cairn: m.

- Length of Mast: m. (approximate if not unpiled)
5. A.C. Nail ① set in conc/rock has been placed 6.846 m. bearing 166°M from Trig. Mast
 6. A.C. Nail ② set in conc/soil has been placed 5.829 m. bearing 245°M from Trig. Mast
 7. A..... set in conc/soil has been placed m. bearing°M from Trig. Mast
 8. A..... set in conc/rock has been placed m. bearing°M from Trig. Mast
 9. Connection Cu Nail ① to Cu Nail ②: 8.165 m. bearing 300°M

10. Connection to m. bearing°M
11. Connection to m. bearing°M
12. Connection to m. bearing°M
13. Diff. Ht. Cu Nail ① is 0.386 m. above below S/S Pin
14. Diff. Ht. Cu Nail ② is 0.144 m. above below S/S Pin
15. Diff. Ht. is m. above below
16. Diff. Ht. is m. above below

Prepared by: *[Signature]* Checked: *[Signature]* Noted on U.T.M. Card

STATION MORRIS TS 3544
 Co: Goulburn ✓ Ph: Albany
 Map Sheet: Albany No: 8225N
 Inspected by: A. Smettsen Date: 7.12.76
 Authority: CMA Field Book: IS19

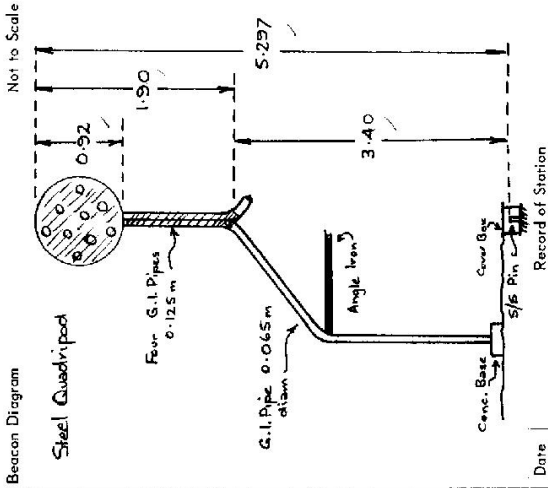

Date	Record of Station

Checked

STATION NORRIS TS 3544

Owners Name: Mr. Murray, MURISED Current Occupant:

Address:

Phone: Albury 253994 Phone before going there:

Access 4WD Phone before going there:

- | Kms | Feature |
|-----|---|
| 0.0 | LAVINGTON P.O. opposite Garrison Hotel |
| 1.7 | Take road towards URANA & JINDERA 13. |
| 1.9 | Bridge |
| 2.1 | Turn left into CENTAUR RD. |
| 3.4 | Turn left into HANNA ST. Large sports oval on LHS |
| 3.9 | Turn right onto gravel road. |
| | Locked gate on LHS on top of hill. |
| | see diagram |

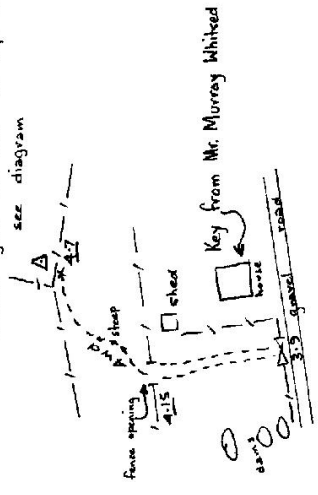

Station Diagram

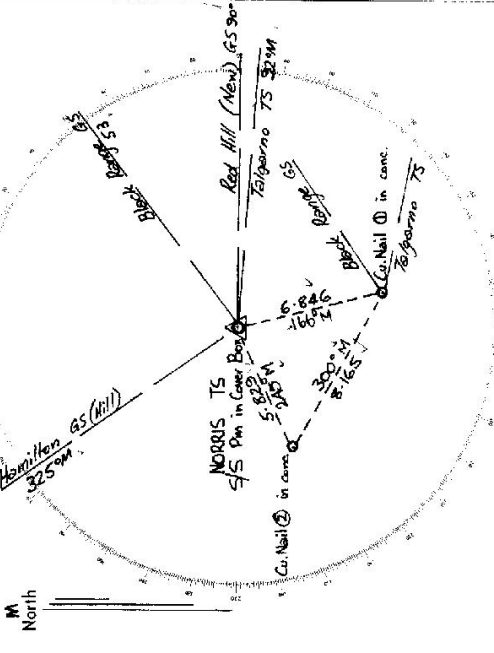

List of Observed Directions:-

Standpoint: S/S Pin in Cover Box Standpoint: Cu. Nail 1

Station	Direction	Station	Direction
TALGARNO TS	359 59 60	TALGARNO TS	359 59 60
Cu. Nail 1	71 19 ✓	Cu. Nail 1	204 43 ✓
Cu. Nail 2	151 05 ✓	S/S Pin	251 21 ✓
BLACK RANGE GS	320 09 03	BLACK RANGE GS	326 06 34

Station	Direction	Station	Direction

LAND INFORMATION CENTRE

GEODETIC SURVEY OF A.S.M.

GEODETIC STATION RECONNAISSANCE and MAINTENANCE REPORT

Description:

1. Cleared by vanes bearing..... *359 - 1629, 3059 - 3509, 109 - 259*..... from Trig. Mast
 Note: Cross out word or words which do not apply
2. Mast & Vanes have been painted white & black respectively.
3. The station/pillar was unpiled/not unpiled/constructed on..... *19*....., dimensions now being:
 Description of mark *STEEL PIN UNDER COVER BOX WITH A QUADROPOD OVER TOP* should be explicit, e.g., S/Steel Pillar Plate, Steel plug, Brass plug, Bolt, G.I. Pipe
 Height of mark.....m. above/below rock/concrete; Mark is.....m. above/below G.L.
 Height of Top Vanes to Top Mark/Pillar plate.....m. Diameter of Vanes (vertical).....m.
 Height of Cairn.....m. Diameter of Cairn.....m. Name Plate found/not found/placed.
 Length of Mast.....m. (approximate if not unpiled)
4. A..... *PM 29455*..... set in conc/reef has been placed/~~found~~, bearing..... *52*°M from Mast/Plug/Pillar
5. A..... set in conc/rock has been placed/found, bearing.....°M from Mast/Plug/Pillar
6. A..... set in conc/rock has been placed/found, bearing.....°M from Mast/Plug/Pillar
7. A..... set in conc/rock has been placed/found, bearing.....°M from Mast/Plug/Pillar
8. Action required:.....

STANDPOINT:

Mark	Direction	Horiz. Distance	Height Difference	Mark	Direction	Holiz. Distance	Height Difference
			above standpt. below				above standpt. below
			above standpt. below				above standpt. below
			above standpt. below				above standpt. below
			above standpt. below				above standpt. below
			above standpt. below				above standpt. below
			above standpt. below				above standpt. below
			above standpt. below				above standpt. below

Prepared by: *Had 24/3/92*

Checked: *Ruby 23.6.92*

Noted on U.T.M. Card

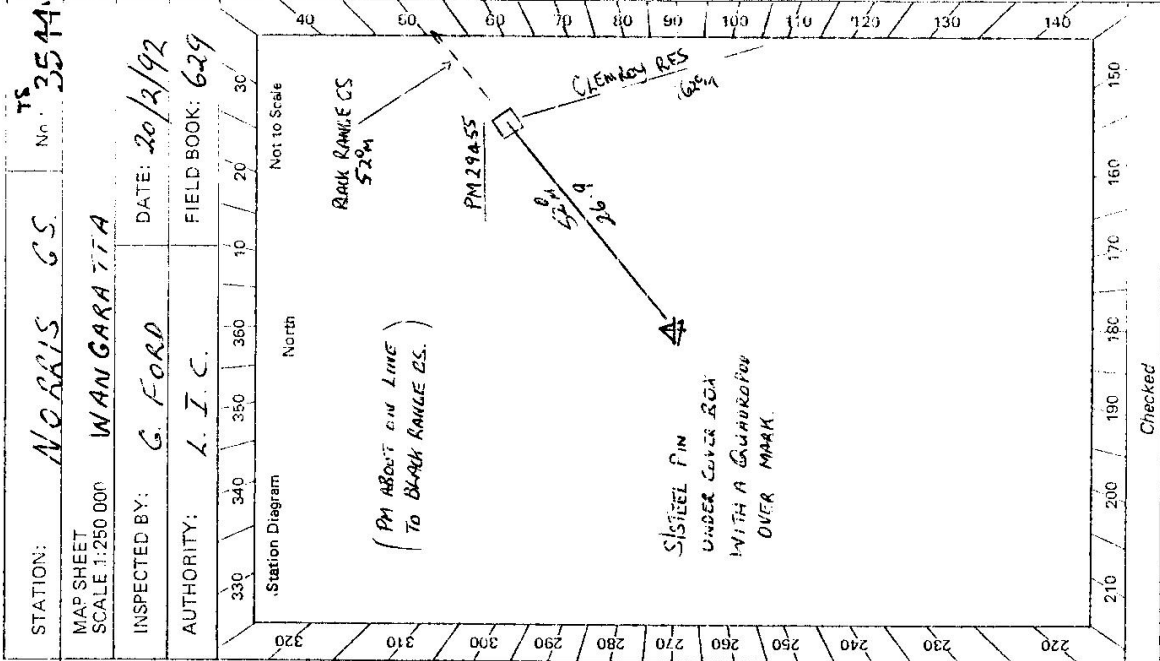

STATION: *NORRIS CS*
 MAP SHEET SCALE 1:250 000
 INSPECTED BY: *G. FORD*
 AUTHORITY: *L. I. C.*
 DATE: *20/2/92*
 FIELD BOOK: *629*
 TS No. *3544*

Checked

Station NO RRIS CS TS 354-4	Owner's Name: ALBURY WOODONGA DEVELOPMENT CORPORATION Access Lessee L.H. WADDEON Address: THURGOODA ALBURY Phone: 060 253127
Beacon Diagram: No: to Scale	Access Report of 20/10/2021 was found suitable/unsuitable. ACCESS LAVINGTON P.O. x INTERSECTION HUME H.W.J. x URANA R.D. TAKE URANA RD WEST TO CENTAUR RD 1.90 KM. INTERSECTION URANA RD x CENTAUR RD HEAD ALONG CENTAUR RD TOWARDS LAVINGTON SPORTS CLUB TURN LEFT AT HANNA ST [LAVINGTON SPORTS CLUB ON R.H.S.] TURN RIGHT INTO PEARSELL ST [INTERSECTION DIRT ROAD] TURN LEFT GO THROUGH SINGLE IRON GATE JUST BEFORE HOUSE WITH ROCK FRONT FENCE AND FOLLOW FANT TRACK UP PAST STABLES [ACCESS LESSEE LIVES HERE] FOLLOW TRACK AROUND SIDE OF HILL TO LEFT CROSS STONE BRIDGE AT SADDLE AND FENCE FOLLOW FENCE UP TO THE RIGHT AT TRIG.
This section to be completed by officer constructing niliar. Original station mark found/not found: Description of mark: Original beacon found/not found: Description of beacon: Height Top of Vanes to Top Markm. Height of markm. above G.L.m. below Diameter of Vanesm. Height of Cairnm. Original Beacon has/has not been destroyed by me.	Date Record of Station