

GEODETIC STATION RECONNAISSANCE and MAINTENANCE REPORT

STATION: **NM/C/83** No.: **3517**

MAP SHEET
SCALE 1:250 000 **WALGETT**

INSPECTED BY: **D. Fredriksen** DATE: **10/7/79**

AUTHORITY: **C.M.A.** FIELD BOOK:

Access and Locality Sketch: Particulars of station marking and beacon: apply last

STATION-MARK: $\frac{1}{2}$ " diameter copper tube set in $\frac{1}{2}$ " diameter G.I. pipe which has been driven to G.L. This is centralized in a concrete block marked with the station number.

BEACON: station found Nil.

REFERENCES MARKS: Three $\frac{1}{2}$ " diameter copper tubes in concrete blocks which are re-inforced with steel pickets driven into the ground. One steel Witness Post and one roofing nail in centre of red painted blaze on a tree, both marked NM/C/83.

ACCESS: Diameter of Vines

Length of Mast: NM/C/83 is sited at a very slight bend in the Walgett - Brewarrina road 27.35 miles west of Walgett. This is very close to the northern edge of the road so that observations could be made along the cleared line of the road (east 7 1/2 miles and west 5 1/2 miles). A 30' tower was needed for all observations and measurements along a 12" diameter trench was dug around the R.M. indicated as the station itself was too close to the road.

- 6. A.....set in conc/rock has been placed/found, bearing.....°M from Mast/Plug/Plum
- 7. A.....set in conc/rock has been placed/found, bearing.....°M from Mast/Plug/Plum

8. Action required:.....

STANDPOINT:			
Mark	Direction	Horiz. Distance	Height Difference
			above standpt
			below
			above standpt
			below
			above standpt
			below
			above standpt
			below
			above standpt
			below

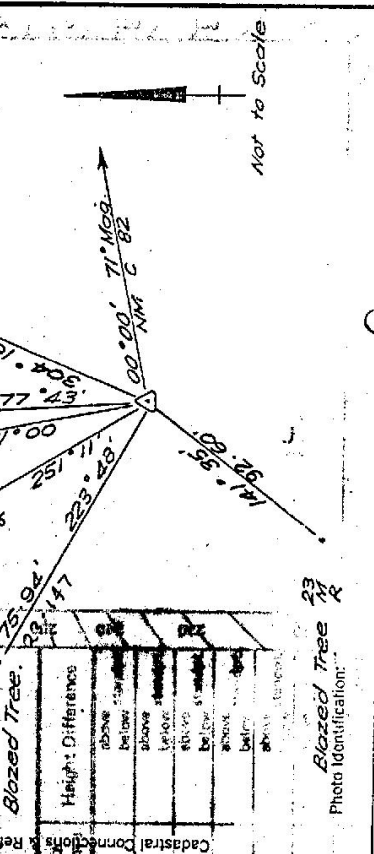

Prepared by: **D. Fredriksen** 25/10/79 Checked:

Checked

