

GEODETIC SURVEY OF N.S.W.

CENTRAL MAPPING AUTHORITY

GEODETIC STATION RECONNAISSANCE and MAINTENANCE REPORT

STATION: NM/C/80 No.: 3514

MAP SHEET  
SCALE 1:250 000 WALGETT

INSPECTED BY: D. FREDRIKSEN DATE: 10/7/79

AUTHORITY: C.M.A. FIELD BOOK:

Particulars of station marking and beacon:

3/4" diameter copper tube inserted in 1/2" diameter G.I. pipe. Mast set in concrete block which is marked with the station number.

Beacon: Nil.

REFERENCE MARKS.

Three 1/2" diameter copper tubes set in concrete blocks which have been re-inforced with steel pickets set directly below the copper tubes. One steel Witness Post, one red painted blaze on a tree (eucalypt) and a red painted triangle on a telegraph pole.

ACCESS.

NM/C/80 is sited close to the north side of the Walgett - Brewarrina road, 14.4 miles west of Walgett. It was so close to see to the road bend 3.9 miles east, and west along the narrow clearing of the telephone line for about 4 miles.

Views are restricted in all directions otherwise from 300 ft tower was needed for all observations and measurements. A 12" diameter trench was dug around the station mark.

- 6. A.....set in conc/rock has been placed/found, bearing.....° M from Mast/P
- 7. A.....set in conc/rock has been placed/found, bearing.....° M from Mast/P
- 8. Action required:.....

STANDPOINT:

Mark	Direction	Horiz. Distance	Height Difference	Mark	Direction
			above standpt		
			below		
			above standpt		
			below		
			above standpt		
			below		
			above standpt		
			below		
			above standpt		
			below		
			above standpt		
			below		

Prepared by: D. Fredriksen 25/10/79

Noted on U.T.M. Card

Checked

SI 2733-1

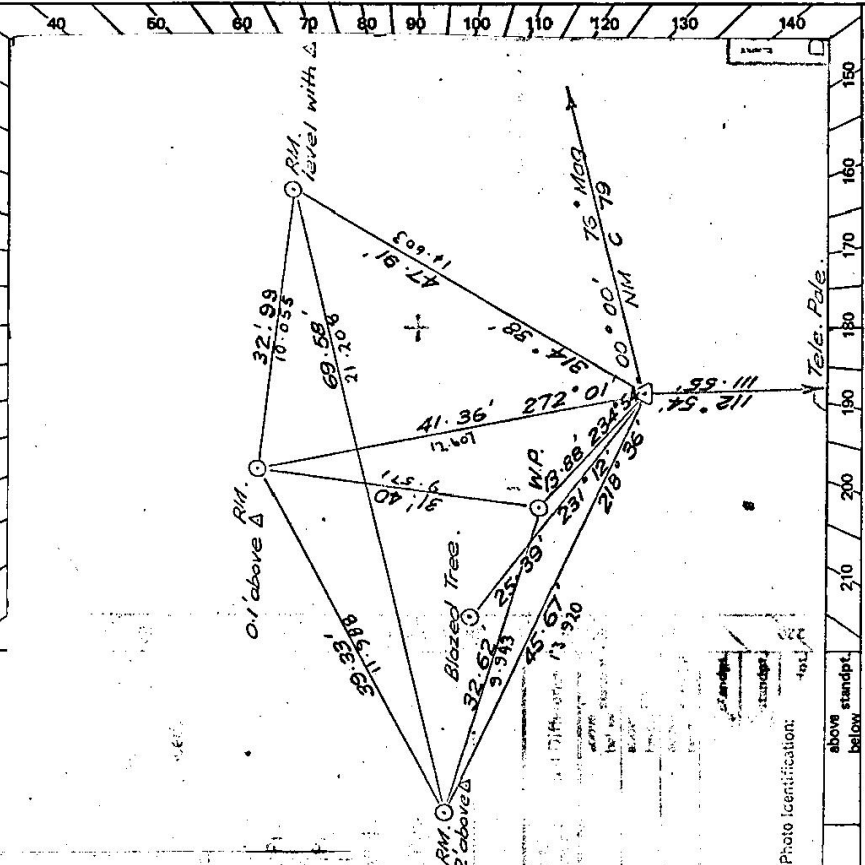

St 2733-2 D. West, Government Printer

<p>STATION <u>NM/C/80</u> TS <u>3514</u></p>	<p>Owner's Name: .....</p> <p>Address: .....</p> <p>Phone: .....</p> <p>Current Occupant: .....</p> <p>Address: .....</p> <p>Phone: .....</p> <p style="text-align: center;">ACCESS</p>	
<p>Beacon Diagram</p>	<p>Not to Scale</p>	<p>Date</p> <p>Record of Station</p>
<p>This section to be completed by officer constructing pillar.</p>		
<p>Original station mark found/not found. ....</p>		
<p>Description of mark: .....</p>		
<p>Original beacon found/not found. ....</p>		
<p>Description of beacon: .....</p>		
<p>Height Top of Vanes to Top Mark.....m.</p>		
<p>Height of mark.....m. above rock/conc.....m. below G.L.</p>		
<p>Diameter of Vanes.....m. Height of Cairn.....m.</p>		
<p>Original Beacon has/has not been destroyed by me. ....</p>		