

CENTRAL MAPPING AUTHORITY

GEODETTIC STATION RECONNAISSANCE and MAINTENANCE REPORT

Access and Locality Sketch:

Particulars of station marking and beacon:

STATION MARK. 1.5" diameter copper tube inserted in a 4' length of G.I. pipe which has been driven to G.I. This is encased in a concrete block marked with the station number.

BEACON. Nil.

REFERENCE MARKS. Three 1/2" copper tubes set in concrete blocks which are reinforced with 18" steel fence posts set below the copper tubes. One 2" diameter steel Witness Post, one blaze on eucalypt painted red, and a red painted triangle on a power line pole.

ACCESS. NW/C/68 is in flat, lightly timbered country, about 8 miles by road, east of Walgett. It is sited at the prominent bend shown. Views are restricted to the cleared lane of the road to the east, and a narrow clearing in the timber to NW/C/69. A 10' tower was needed for all observations and measurements. The station is marked by a 12" diameter trench around the station mark.

7. A. set in conc/rock has been placed/found, bearing.....° M from Mast/Plug/Pillar

8. Action required:.....

STANDPOINT: NW/C/68 Cu tube in conc. fd.				STANDPOINT:			
Mark	Direction	Horiz. Distance	Height Difference	Mark	Direction	Horiz. Distance	Height Difference
G.I. in A in tree (see map)	11° 48'	58.113	above standpt				above standpt
Corner fence post	127° 02'	36.866	above standpt				above standpt
G.I. in blaze placed	137° 57'	23.898	below standpt				below standpt
† Power Pole (N° 592)	280° 16'	103.86	below standpt				below standpt
			above standpt				above standpt
			below				below

Prepared by: D. Fredriksen 30/10/79

Noted on U.T.M. Card

Checked

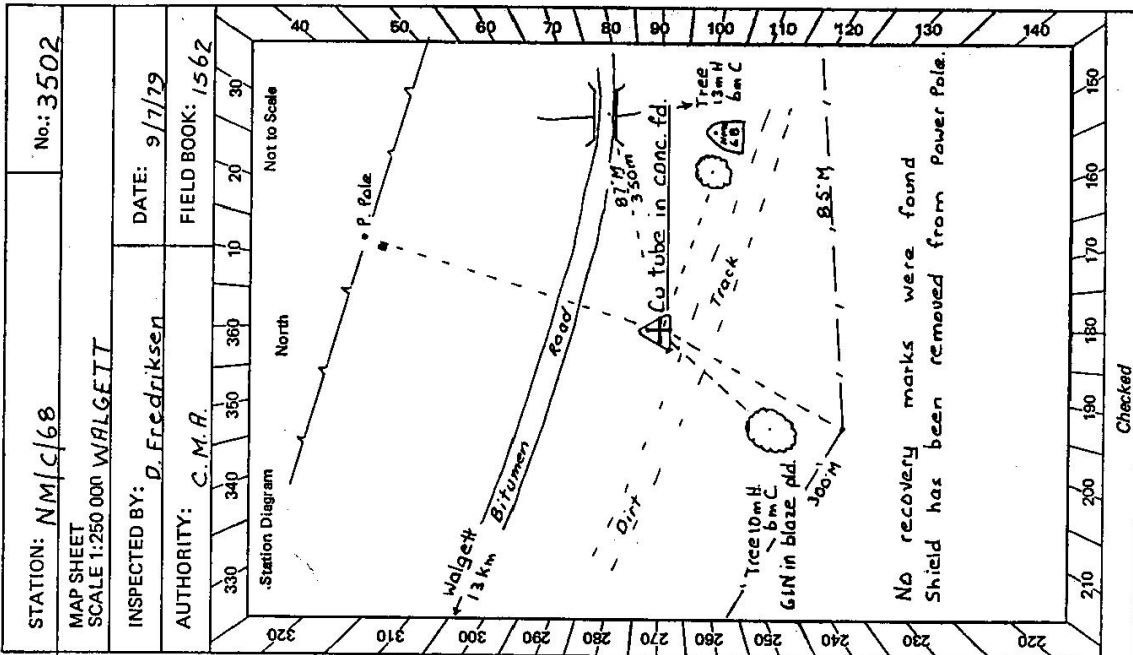

STATION: NM/C/68 No.: 3502

MAP SHEET SCALE 1:250 000 WALGETT

INSPECTED BY: D. Fredriksen DATE: 9/7/79

AUTHORITY: C. M. A. FIELD BOOK: 1562

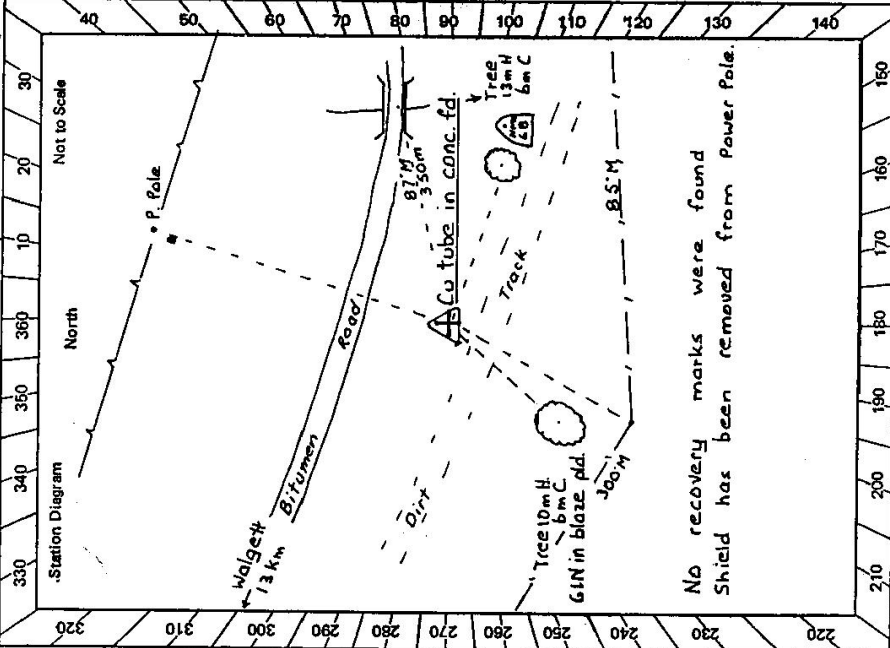

St. 2733-2 D. West, Government Printer

STATION NM/C/68 TS 3502

Beacon Diagram	Not to Scale

Owner's Name:
 Address:
 Phone:

Current Occupant:
 Address:
 Phone:

ACCESS

Access Report of 9.7.1979 was found suitable/unsuitable.

Kms. Feature

0.0 5kms North of Walgett on the Castle rough Hwy. head
 East towards Burren Junction
 4.8 Grid
 6.4 Grid
 8.3 NM/C/68 on R.H.S.
 8.65 Bridge

This section to be completed by officer constructing pillar,

Original station mark found/not found.

Description of mark:

Original beacon found/not found.

Description of beacon:

Height Top of Vanes to Top Mark.....m.

Height of mark.....m. above G.L.
 below

Diameter of Vanesm. Height of Cairnm.

Original Beacon has/has not been destroyed by me.

Date

Record of Station

GEODETIC SURVEY OF N.S.W.

GEODETIC STATION RECONNAISSANCE and MAINTENANCE REPORT

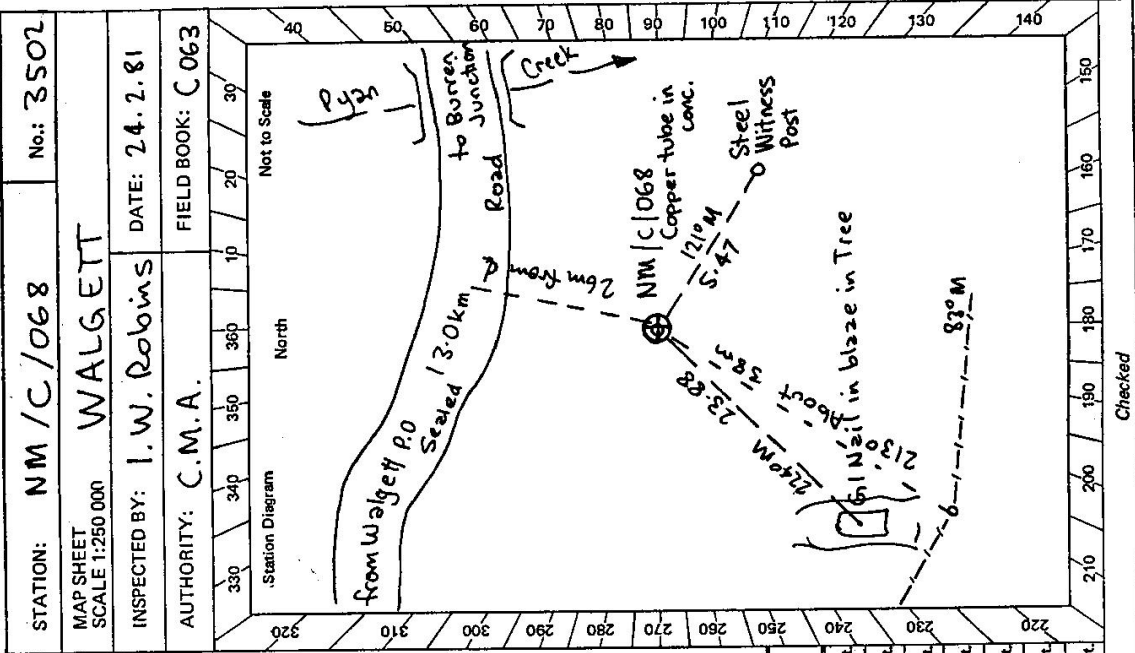

Description: Cleared by lance-bearing from Trig. Mast

1. Cleared by lance-bearing from Trig. Mast
2. Mast & Vanees have been painted white & black respectively.
3. The station/pillar was unspited/not unspited/constructed on 10 m, dimensions now being: Copper tube
Description of mark: W. S. Conc. should be explicit, e.g., S/Steel Pillar Plate, Steel plug, Brass plug, Bolt, G.I. Pipe
Height of mark: 0.0 m. above rock/concrete; Mark is 0.15 m. above G.L.
Height of Top Vanees to Top Mark/Pillar plate: 0 m. Diameter of Vanees (vertical): 0 m.
Height of Cairn: 0 m. Diameter of Cairn: 0 m. Name Plate found/not found/placed.
Length of Mast: 0 m. (approximate if not unspited)
4. A steel witness post in conc. has been placed/found, bearing 121°M from Mast/Plug/Pillar
5. A GINZIL in blaze has been found/found, bearing 213°M from Mast/Plug/Pillar
6. No other reference marks searched for
7. Action required: 3m tower necessary if connection to any other point is required from this mark

Mark	Direction	Horiz. Distance	Height Difference	Mark	Direction	Horiz. Distance	Height Difference
			above standpt.				above standpt.
			below				below
			above standpt.				above standpt.
			below				below
			above standpt.				above standpt.
			below				below
			above standpt.				above standpt.
			below				below
			above standpt.				above standpt.
			below				below

STANDPOINT:

Prepared by: Daryl Rob 4.3.8/Checked:

Noted on U.T.M. Card

