

CENTRAL MAPPING AUTHORITY

GEODETIC SURVEY OF N.S.W.
 GEODETIC STATION RECONNAISSANCE and MAINTENANCE REPORT

STATION: **NML/53** No: **3490**

MAP SHEET SCALE 1:250 000 **NARRABRI**

INSPECTED BY: **D. FREDRIKSEN** DATE: **6/7/79**

AUTHORITY: **C.M.A.** FIELD BOOK: **1562**

- Description: *Note: Cross out word or words which do not apply*
- Cleared by lanes bearing..... from **Trig. Mast**
 - Mast & Vanes have been painted white & black respectively.
 - The station/pillar was unplied/not unplied/constructed on.....**19**....., dimensions now being: **Cu Tube in conc. fd.**
 Description of mark.....should be explicit, e.g., S/Steel Pillar Plate, Steel plug, Brass plug, Bolt, G.I. Pipe
 Height of mark.....m. above rock/concrete; Mark is.....m. above G.L.
 - Height of Top Vanes to Top Mark/Pillar plate.....m. Diameter of Vanes (vertical).....m.
 Height of Cairn.....m. Diameter of Cairn.....m. Name Plate found/not found/placed.
 - Length of Mast.....m. (approximate if not unplied)
 - A. **RM1**, set in conc/rock has been placed/found, bearing **35.6**.....° M from Mast/Plug/Pillar
 - A. **RM2**, set in conc/rock has been placed/found, bearing **8.6**.....° M from Mast/Plug/Pillar
 - A. **RM3**, set in conc/rock has been placed/found, bearing **1.77**.....° M from Mast/Plug/Pillar
 - A.....set in conc/rock has been placed/found, bearing.....° M from Mast/Plug/Pillar
 - Action required:.....

STANDPOINT: **Cu Tube in conc.**

Mark	Direction	Horiz. Distance	Height Difference	Mark	Direction	Horiz. Distance	Height Difference
RM 1	6° 22'	5.934	0.075				
RM 2	95° 51'	5.994	0.125				
RM 3	187° 15'	6.011	0.210				
Fence Corner PP1	6°	53.0					
Bore 3623-1(728)	337° 37'	64.8	0.11				
Road Intersection PP2	9° 30'	121.4					

Prepared by: **D. FREDRIKSEN** 29/6/79 Checked: **D. Fredriksen** 27/7/79

St 2733-1

Noted on U.T.M. Card

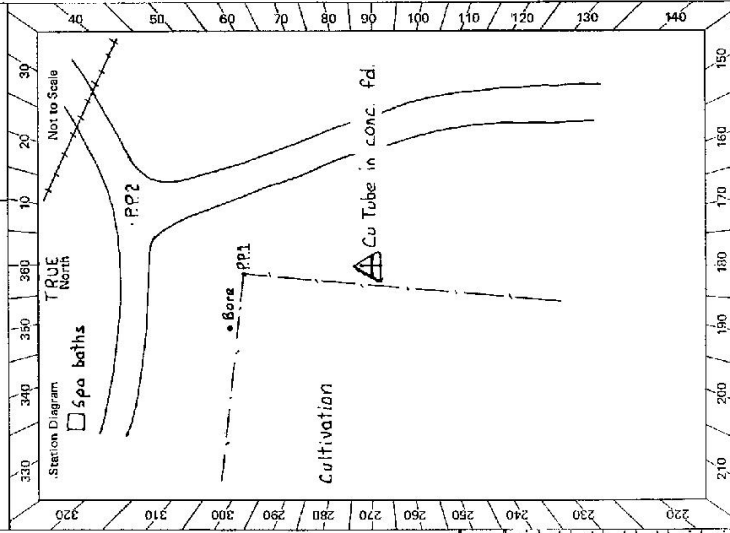

Checked

St. 2733-2 D. West, Government Printer

STATION NM/C/53 TS 3490

Owner's Name:
 Address:
 Phone:
 Current Occupant:
 Address:
 Phone:

ACCESS

Access Report of 6/7/79 was found suitable/unsuitable.

FEATURE

- KMS 0-0 Coronation Hotel, BURREN JUNCTION heading South towards railway
 0-2 Turn LEFT towards WEE WEA
 3-9 Turn RIGHT off main road S.P. "Bore Baths"
 4-0 Railway crossing
 4-1 Road intersection P.P.
 4-2 At NM/C/53 see sketch.

NM/C/53 PPI was pinned on C.M.A. photo NSW 2717186
 " " " " " RASC " " NSW 2717186

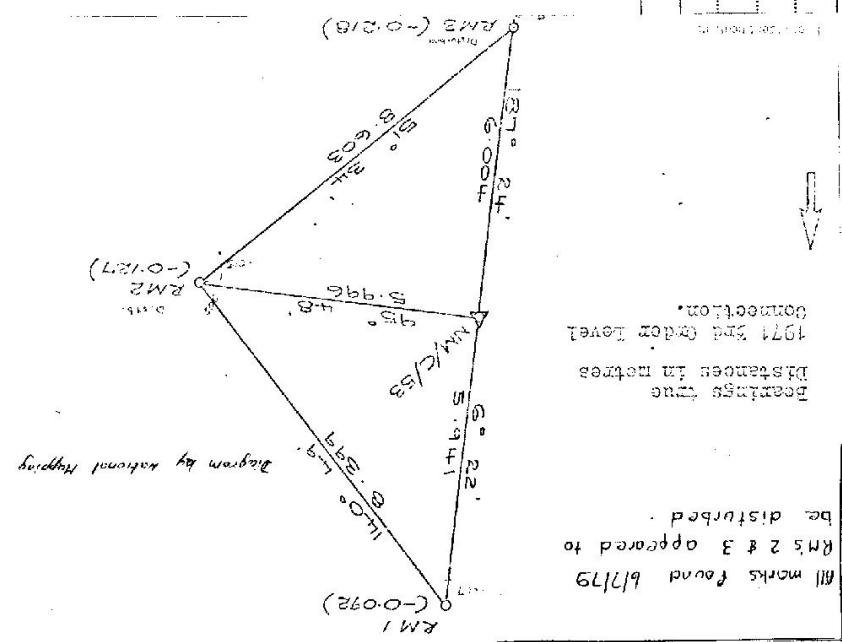

Date	Record of Station