

CENTRAL MAPPING AUTHORITY
 GEODETIC SURVEY OF N.S.W.
 GEODETIC STATION RECONNAISSANCE and MAINTENANCE REPORT

Description: *3.2m x 0.5m* Note: Cross out word or words which do not apply

1. Cleared by lanes bearing..... *3.2m x 0.5m*..... from Trig. Mast

2. Mast & Vanes have been painted white & black respectively.

3. The station/pillar was unpiled/~~not unpiled~~ constructed on..... *19.7.77*..... dimensions now being:

Description of mark..... *Ray*..... should be explicit, e.g. ~~Steel Pillar Plate~~, ~~Steel plug~~, Brass plug, Bolt, ~~G.L. Pipe~~

Height of mark..... m, above below rock/concrete; Mark is..... m, above below G.L.

Height of Top Vanes to Top Mark/Pillar plate m. Diameter of Vanes (vertical)..... m.

Height of Cairn..... m. Diameter of Cairn..... m. Name Plate ~~found~~/not found/~~placed~~.

Length of Mast m. (approximate if not unpiled)

4. A..... set in conc/rock has been placed/~~found~~, bearing..... ° M from Mast/Plug/Pillar

5. A..... set in conc/~~rock~~ has been placed/~~found~~, bearing..... ° M from Mast/Plug/Pillar

6. A..... set in conc/rock has been placed/~~found~~, bearing..... ° M from Mast/Plug/Pillar

7. A..... set in conc/rock has been placed/~~found~~, bearing..... ° M from Mast/Plug/Pillar

8. Action required..... *No. Ref. to stn. marks placed by D.P.H. and G.L. Mast destroyed....*

STANDPOINT:				STANDPOINT:			
Mark	Direction	Horiz. Distance	Height Difference	Mark	Direction	Horiz. Distance	Height Difference
			above standpt.				above standpt.
			below standpt.				below standpt.
			above standpt.				above standpt.
			below standpt.				below standpt.
			above standpt.				above standpt.
			below standpt.				below standpt.
			above standpt.				above standpt.
			below standpt.				below standpt.
			above standpt.				above standpt.
			below standpt.				below standpt.

Prepared by: *M. L. L.* Checked: *B. M. L.* on U.T.M. Card

STATION: *T.S. MUTTAP.* No.: *5298*

MAP SHEET SCALE 1:250 000 *COOTAMUNDRA S1 55-11*

INSPECTED BY: *W. SHANBERRY* DATE: *25. 1977*

AUTHORITY: *Dept. of M.S. Res.* FIELD BOOK: *002178 PG 0-13*

St 2733-2 D. West, Government of

TS 3298 →

Not to Scale

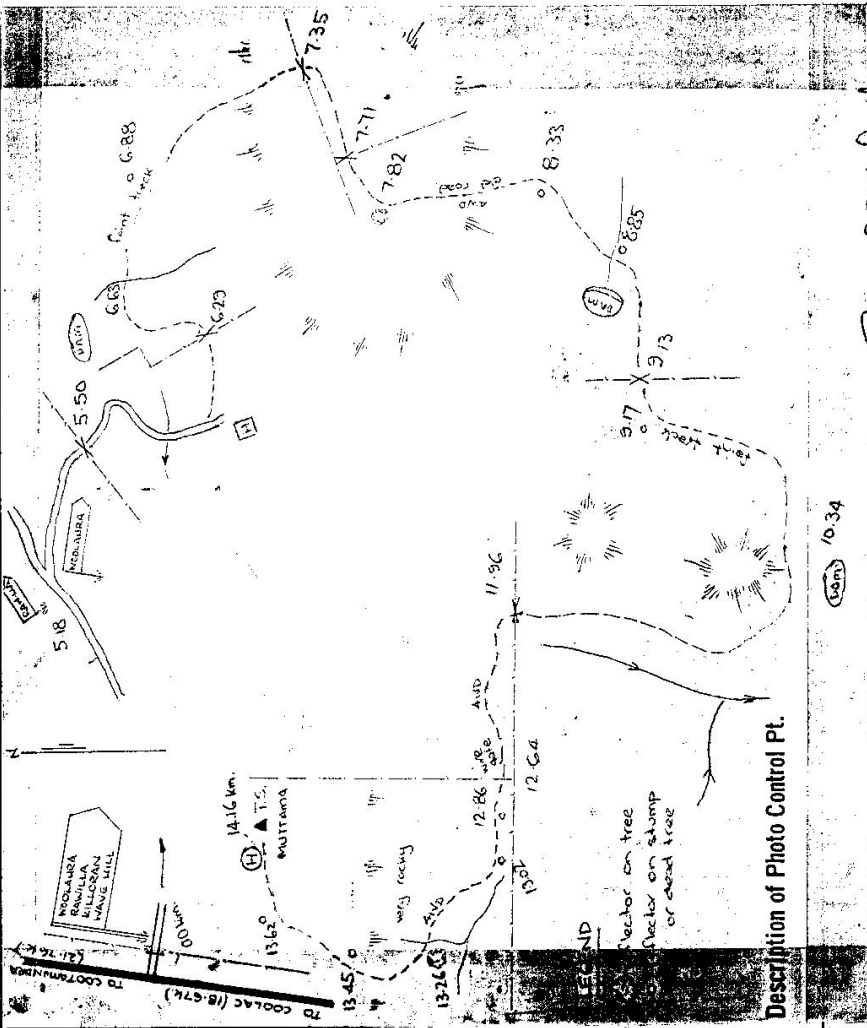
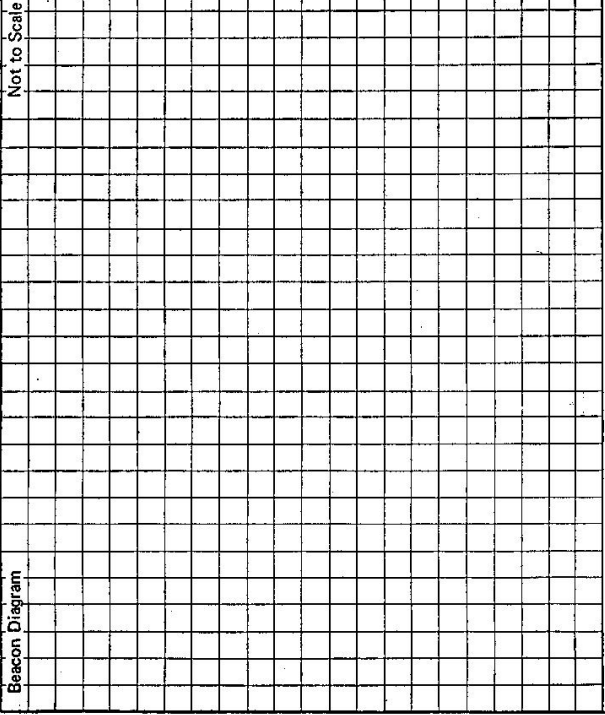

Description of Photo Control Pt.

10.34

This section to be completed by officer constructing pillar.

Original station mark found/not found.

Description of mark:

Original beacon found/not found.

Description of beacon:

Height Top of Vanes to Top Mark.....m.

Height of mark.....m. above G.L. below G.L.

Diameter of Vanesm. Height of Cairnm.

Original Beacon has/has not been destroyed by me.

January 1977. Visited by D.M.H. - Station found unspiced.

CENTRAL MAPPING AUTHORITY

GEODETIC SURVEY OF N.S.W

GEODETIC STATION RECONNAISSANCE and MAINTENANCE REPORT

STATION: **MUTJAMA G.S.** No.: **3298**

MAP SHEET SCALE 1:250 000

INSPECTED BY: **G. L. FORD** DATE: **21-10-80**

AUTHORITY: **C. M. A.** FIELD BOOK: **1810**

Description: **36.0°** Note: Cross out word or words which do not apply

1. Cleared by lanes bearing **36.0°** ✓ Note: Cross out word or words which do not apply

2. Mast & Vanes have been painted white & black respectively. ✓

3. The station/pillar was unplied/hot-impaled/constructed on **21-10-80** dimensions now being: **19.80**

Description of mark: **BRASS PLUG** should be explicit, e.g., **Steel pillar/Plate/Steel plug/Brass plug, Bolt, G.I. Pipe**

Height of mark: **0.030** m. above rock/concrete; Mark is **0.185** m. above G.L.

Height of Top Vanes to Top Mark/Pillar/Plate: **3.425** m. Diameter of Vanes (vertical): **0.905** m.

Height of Cairn: **1.500** m. Diameter of Cairn: **2.200** m. Name Plate found/not found/placed.

Length of Mast: **3.445** m. (approximate if not unplied)

4. A **G.I. NAIL** set in conc/rock has been placed/found, bearing **46.0°** M from Mast/Plug/Pillar

5. A **G.I. PIPE** set in conc/rock has been placed/found, bearing **32.6°** M from Mast/Plug/Pillar

6. A set in conc/rock has been placed/found, bearing **0.00°** M from Mast/Plug/Pillar

7. A set in conc/rock has been placed/found, bearing **0.00°** M from Mast/Plug/Pillar

8. Action required:

STANDPOINT: **BRASS TRIG PLUG** STATIONPOINT: **G. I NAIL**

Mark	Direction	Horiz. Distance	Height Difference	Mark	Direction	Horiz. Distance	Height Difference
CROWE / (P) 0 00 00	0 00 00		above standpt.	CROWE	0 00 00		above standpt.
G.I. PIPE / 176 52 36	176 52 36	4.122	below standpt.	TRIG PLUG	87 09 50	4.227	below standpt.
COONEY / G3 202 00 50	202 00 50		above standpt.	G.I. PIPE	126 40 50	5.436	above standpt.
G.I. NAIL / 258 08 10	258 08 10	4.223	below standpt.	COONEY	201 58 50		above standpt.
EDNEY / G5 245 38 40	245 38 40		below standpt.	EDNEY	295 38 10		below standpt.
			above standpt.				above standpt.
			below standpt.				below standpt.

Prepared by: **J.J. Ford**

Checked: **0** Noted on U.T.M. Card

81 2783-1

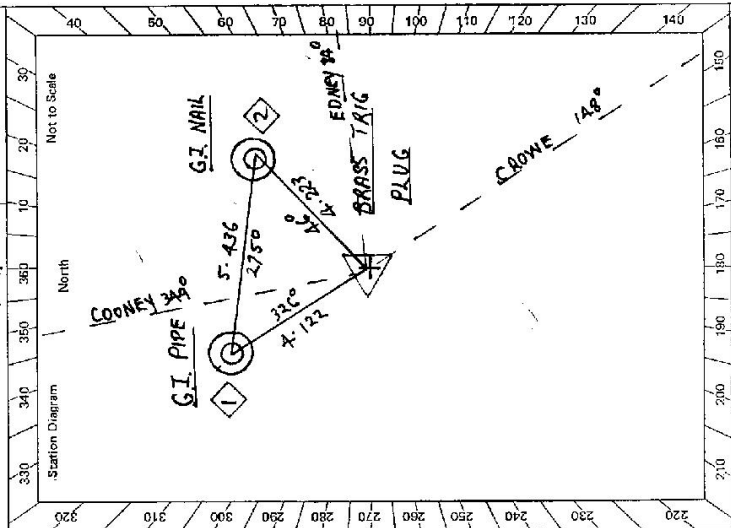

STATION MUTTAMATS 3298 G.S.	Owner's Name: M. MAHER Address: COOLAC Phone:	Current Occupant: Address: Phone:	ACCESS Access Report of 21/10/1980 was found suitable/unsuitable. 0-00 COOTAMUNDRA P.O. 0-25 TURN RIGHT 3 WNEE 0-45 TURN RIGHT GUNDREZ 0-65 RAILWAY LINE 21-45 THAN LEFT OVER RAMP AT SIGNS "RAVILLA KILORAN WAVE HILL" FOLLOW MAIN ROAD OVER THREE MORE RAMP 26-50 TURN RIGHT AT SIGN WOOLAHRA 27-30 GATE, FOLLOW EITHER TRACK TO HOUSE HOUSE PART HOUSE AND WHEAT SILOS 27-70 GATE FOLLOW TRACK PART SHEARING SHEDS 28-15 GATE IN CORNER 28-20 GATE THROUGH EAST WEST FENCE FOLLOW FENCE TO DAM IN Gully 28-55 DAM HEAD SOUTH UP TO TOP OF ... RIDGE FOLLOWING OLD SHEEP TRACKS 28-90 FENCED IN WELL TURN EAST UP ROCKY SPAK 29-05 TOP OF ROCKS SECTION BLAZED TREE WOOD WAY ROUND SOUTH TO BLACK ARROW ON ROCK 29-40 BLACK ARROW ON ROCK EAST UP TO TOP OF HILL 29-70 TOP OF HILL MAKE WAY SOUTH AROUND EASTERN SIDE OF ROCKS 29-95 FENCE 2 MET WALK TO TRIC
Beacon Diagram 		Date Record of Station	
Beacon Diagram Not to Scale 0.905 2.445 2.700 1.500		This section to be completed by officer constructing pillar. Original station mark found/ not found . Description of mark: BRASS PLUG Original beacon found /not found. Description of beacon: Height Top of Vanes to Top Markm. Height of markm. above rock/concm. below G.L. Diameter of Vanesm. Height of Cairnm. Original Beacon has/ has not been destroyed by me.	

LAND INFORMATION CENTRE

GEODETIC SURVEY OF N.S.W.

GEODETIC STATION RECONNAISSANCE and MAINTENANCE REPORT

STATION: **MUTTAMA** No.: **3298**

MAP SHEET SCALE 1:250 000 **COOLAC 1:50 000**

INSPECTED BY: **G. WORMALD** DATE: **6/1996**

AUTHORITY: **LIC** FIELD BOOK:

Description:
 1. Cleared by Janes bearing.....
 2. Mast & Vanes have been painted white & black respectively.
 3. The station/pillar was unpiled/not unpiled/constructed on..... 19....., dimensions now being:

Description of mark..... should be explicit, e.g., S/Steel Pillar Plate, Steel plug, Brass plug, Bolt, G.I. Pipe

Height of mark.....m. above rock/concrete; Mark is.....m. above G.L.

Height of Top Vanes to Top Mark/Pillar platem. Diameter of Vanes (vertical).....m.

Height of Cairn.....m. Diameter of Cairn.....m. Name Plate found/not found/placed.

Length of Mastm. (approximate if not unpiled)

4. A.....set in conc/rock has been placed/found, bearing.....°M from Mast/Plug/Pillar

5. A.....set in conc/rock has been placed/found, bearing.....°M from Mast/Plug/Pillar

6. A.....set in conc/rock has been placed/found, bearing.....°M from Mast/Plug/Pillar

7. A.....set in conc/rock has been placed/found, bearing.....°M from Mast/Plug/Pillar

8. Action required:.....

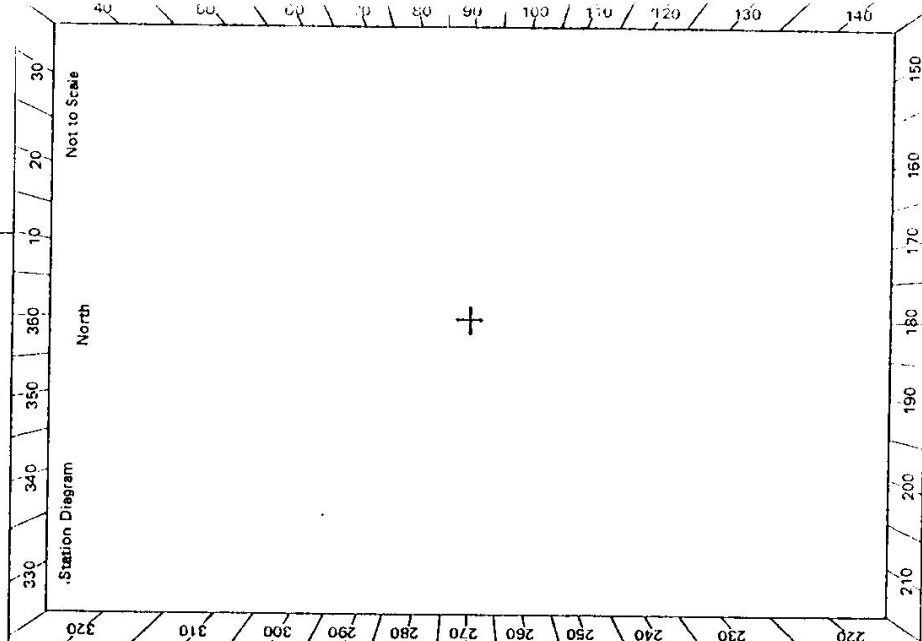

STANDPOINT:				STANDPOINT:			
Mark	Direction	Horiz. Distance	Height Difference	Mark	Direction	Horiz. Distance	Height Difference
			above standpt.				above standpt.
			below				below
			above standpt.				above standpt.
			below				below
			above standpt.				above standpt.
			below				below
			above standpt.				above standpt.
			below				below
			above standpt.				above standpt.
			below				below
			above standpt.				above standpt.
			below				below

Prepared by: *Alle* 2/6/1997

Checked: *Checked* Noted on U.T.M. Card

SI 2733-2 D. West, Government Printer

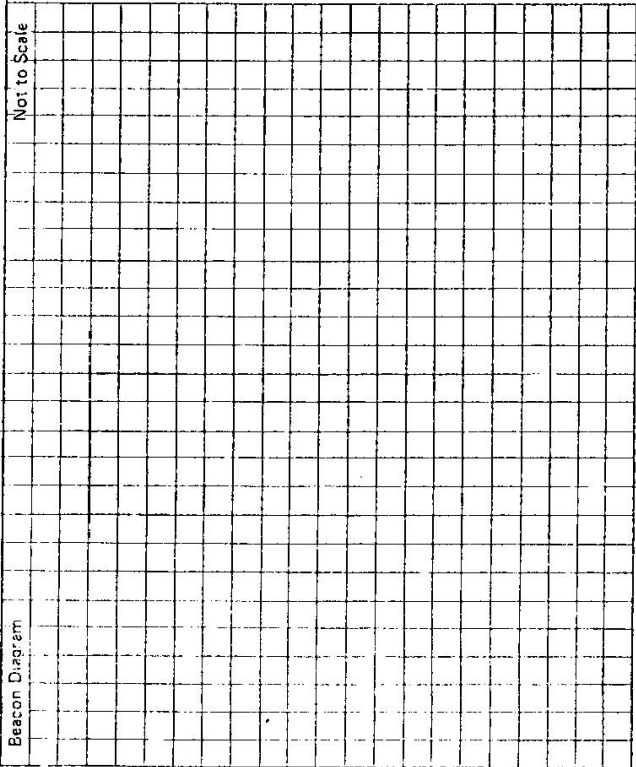
Beacon Diagram 	STATION MUTTAMA TS 3298	Owner's Name: Current Occupant: Address: Address: Phone: Phone: ACCESS Access Report of 21.10.1980 was found suitable/ unavailable . ACCESS TIME ABOUT ONE HOUR.
This section to be completed by officer constructing pillar. Original station mark found/not found. Description of mark: Original beacon found/not found. Description of beacon: Height Top of Vanes to Top Markm. Height of markm. above rock/concm. above G.L. belowm. below G.L. Diameter of Vanesm. Height of Cairnm. Original Beacon has/has not been destroyed by me.	Date June 1996	Record of Station Trig unimpiled for GPS and roughly repiled - G. Wormald.