

LAND INFORMATION CENTRE

GEODETIC SURVEY OF N.S.W.

GEODETIC STATION RECONNAISSANCE and MAINTENANCE REPORT

STATION: MORROW TS No.: 3210

MAP SHEET SCALE 1:250 000 NYHAGEE GINDOONO 1:100 000

INSPECTED BY: G. FORD DATE: 21-9-99

AUTHORITY: L. I. C. FIELD BOOK: —

Description:

Note: Cross out word or words which do not apply
 Clear for G.P.S. from Trig. Mast

1. Cleared by Janes bearing.....
2. Mast & Vanes have been painted white & black respectively, replaid
3. The station/pillar was unplaid/not unplaid/constructed on..... 2.6 NOV. 1999, dimensions now being:

Description of mark: Brass Plug, should be explicit, e.g. S/Steel Pillar Plate, Steel plug, Brass plug, Bolt, G.L. Pipe
 Height of mark: 0.04 m. above back/concrete; Mark is..... m. above G.L.

Height of Top Vanes to Top Mark/Pillar plate: NA m. Diameter of Vanes (vertical):..... m.
 Height of Cairn: 1.2 m. Diameter of Cairn: 2.2 m. Name Plate found/not found/placed.
 Length of Mast:..... m. (approximate if not unplaid)

4. A..... set in conc/rock has been placed/found; bearing.....° M from Mast/Plug/Pillar
5. A..... set in conc/rock has been placed/found; bearing.....° M from Mast/Plug/Pillar
6. A..... set in conc/rock has been placed/found; bearing.....° M from Mast/Plug/Pillar
7. A..... set in conc/rock has been placed/found; bearing.....° M from Mast/Plug/Pillar
8. Action required: NEW MAST CARBON NEEDS REPAIRING.

STANDPOINT:

STANDPOINT:

Mark	Direction	Horiz. Distance	Height Difference	Mark	Direction	Horiz. Distance	Height Difference
			above standpt.				above standpt.
			below standpt.				below standpt.
			above standpt.				above standpt.
			below standpt.				below standpt.
			above standpt.				above standpt.
			below standpt.				below standpt.
			above standpt.				above standpt.
			below standpt.				below standpt.
			above standpt.				above standpt.
			below standpt.				below standpt.

Figured by: [Signature] 14/10/99

Checked:

Noted on U.T.M. Card

Checked

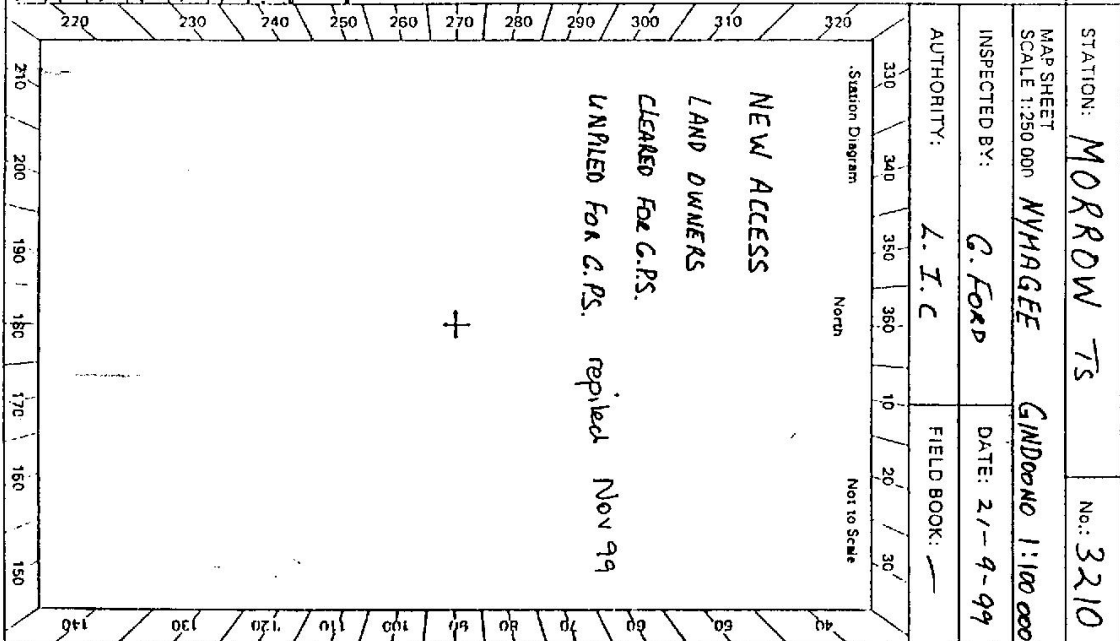

ST 2733-2 D. West. Government Printer

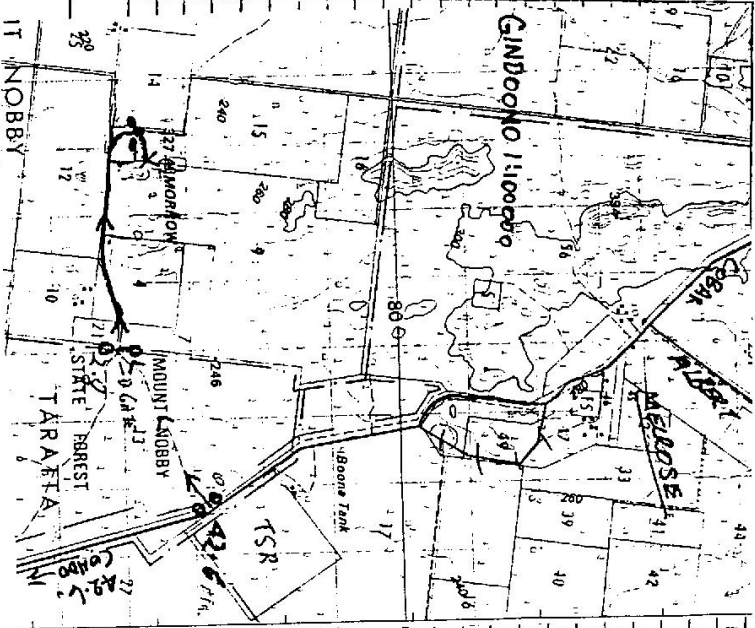

Not to Scale

Original beacon found/not found.
 Description of beacon:
 Height Top of Vanes to Top Mark: m.
 Height of mark: m. above rock/cone m. below G.L.
 Diameter of Vanes m. Height of Cairn m.
 Original Beacon has/has not been destroyed by me.

STATION MORROW TS 3210

*** Owner's Name: BRUCE WATTS & NATHARINE SCHOEFFEL**
 Address: "NYORA" (23 Km. on Road) CONDO - COBAR RD.
 Phone: 6896 2935
 Current Occupant: MRS CASKEY
 Address: CONDO - COBAR RD.
 Phone:

3210 MORROW TS

Access Report of/19..... was found suitable/unsuitable.

- 0.00 7.00 PO Condobolin head towards Cobar for abt 42.6 KM
- 2.80 4.20 Left through gate into Mount Nobly State Forest (opp TSR reserve)
- 3.45 3.55 Double iron gates into Mrs Caskey land
- 3.50 3.50 Road veers left towards house go right to fence corner & gates
- 6.00 1.00 3 small gates
- 6.45 0.55 Tank on right
- 6.60 0.40 Double iron gates (trig owner land)
- 6.80 0.20 Turn right off track to wards hill
- 7.00 0.00 Cross small dry creek
- Stop at small pile of rocks
- Walk up from southern end of hill 10 mins to trig

Travel time 43 KM from condo bitumen RD
 + 30 mins from turn off to trig

WATT BRUCE & SCHOEFFEL KATE Search Again
 VET SURGNS 9 MELROSE ST CONDOBOLIN 2877 (02) 6895-2511
 NYORA CONDOBOLIN 2877 (02) 6896-2935
 MOBILE SERVICE 017 915 640

*** NOTE BRUCE WATT SAID NOT TO CONTACT MRS CASKEY BECAUSE HE WILL CONTACT HER (SHE HAS FENCE OFF ANOTHER ACCESS)**

21/9/99