

Integral Survey of N.S.W.

RECONNAISSANCE and MAINTENANCE REPORT 2908 STATION IUGARNO IS 2908

Department of Lands

This Trig. Station has been:-

Note: Cross out word or words which do not apply

1. Completely cleared to permit 360° vision to surrounding Trigs.
2. Cleared by lanes bearing from Trig. Mast

Co: _____ Ph: _____
 Map Sheet: _____ No: _____
 Inspected by: _____ Date: _____
 Authority: _____ Field Book: _____

STATION IUGARNO Elev. Res. R.L. 98.26

to R.L. _____ meters

Direction of Vert. Angle Variance Observer Date

Dist. in metres at M.S.L. Variance Inst. Observer Date

See Reverse for Location Diagram

J. Nyx 28 Jan 1974

L.B. 19168

R.L. 98.26m (Lev. M.W.S. (D.B.)
 Punch Mk. in Steel Plate

All directions Corrected to centre

All Vert's corrected ground to ground

SEE REAR OF CARD FOR REMARKS

14. Diff. Ht. is m. above below
15. Diff. Ht. is m. above below
16. Diff. Ht. is m. above below

Prepared by: _____ Checked: _____

Date _____ Record of Station _____

Beacon Diagram Not to Scale

STATION LOGARNO TS 2908

Current Occupant.....

Address.....

Owners Name.....

Address.....

Access.....

LOGARNO ELEV RES (CENTRE)

Remarks

Maple St
 East Hills
 Sandell Pl
 Rossana
 Logarno
 I.S. LOGARNO
 15.8.84
 Diagram Not to Scale
 Measurements in Metres.

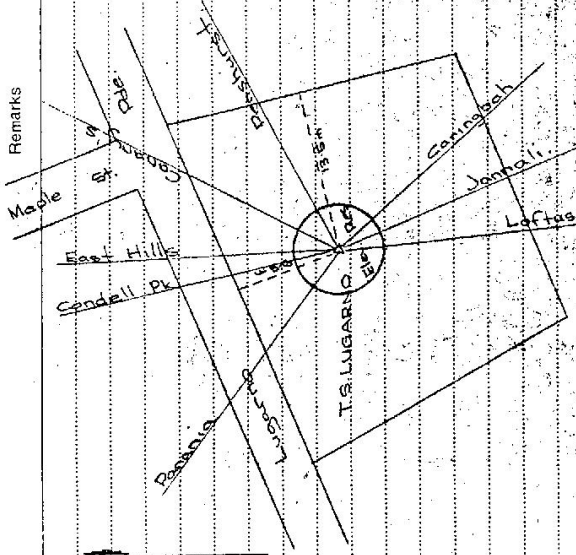

Not to Scale

Station Diagram

North

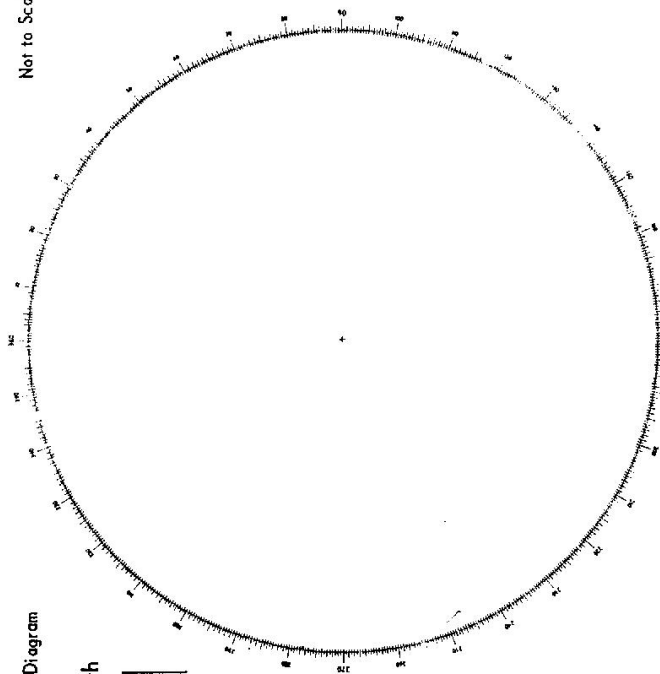

List of Observed Directions:-

Standpoint:		Standpoint:	
Station	Direction	Station	Direction

75-109

Department of Lands

Integration St. of N.S.W

RECONNAISSANCE and MAINTENANCE REPORT 2908 STATION LUGARNO TS 2908

This Trig. Station has been:-

Co: Ph: No: Map Sheet: Inspected by: C Stankley Date: 23/5/75 Authority DEPT LANDS Field Book: PDP 366

Not to Scale

1. Completely cleared to permit 360° vision to surrounding Trigs.

2. ~~Cleared by James bearing~~ from Trig. Mast

3. Trig. Mast & Vanes have been painted white & black respectively.

4. The Trig. was unpiled/~~not unpiled~~, dimensions now being:

Description of mark... DRILL HOLE... ~~in steel PLATFORM~~ should be explicitly e.g. Steel plug, Brass plug, Bolt, Concrete Pillar

Height of mark... m ^{above} rock/concrete ~~below~~ G.L.

Height of Top Vanes to Top Mark... 3.80 m Diameter of Vanes (vertical) 0.60 m.

Height of Cairn... m Diameter of Cairn... m.

Length of Mast... 1.83 m. (approximate if not unpiled)

5. A... set in conc/rock has been placed/rd... m. bearing... M from Trig. Mast/pillar

6. A... set in conc/soil has been placed/rd... m. bearing... M from Trig. Mast/pillar

7. A... set in conc/soil has been placed/rd... m. bearing... M from Trig. Mast/pillar

8. A... set in conc/rock has been placed/rd... m. bearing... M from Trig. Mast/pillar

9. Connection... to... m. bearing... M

10. Connection... to... m. bearing... M

11. Connection... to... m. bearing... M

12. Connection... to... m. bearing... M

13. Diff. Ht. is... m. ^{above} ~~below~~

14. Diff. Ht. is... m. ^{above} ~~below~~

15. Diff. Ht. is... m. ^{above} ~~below~~

16. Diff. Ht. is... m. ^{above} ~~below~~

Prepared by: C Stankley

Checked: J Robertson

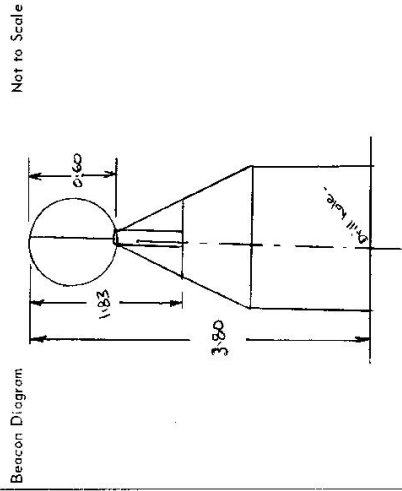

Date

Record of Station

STATION LUGARN TS 2908

Owners Name:
 Current Occupant:
 Address:
 Address:

23/9/1975
 Access On Lugarno Parade Lugarno.

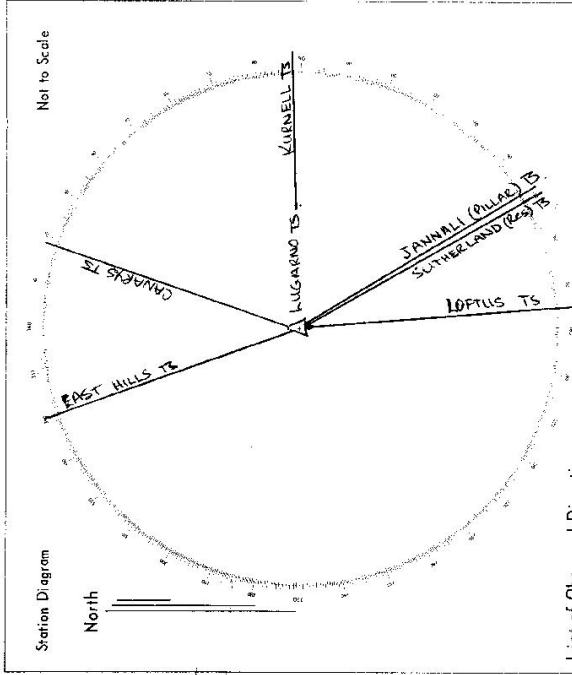

List of Observed Directions:-

Standpoint: Drill hole.		Standpoint:	
Station	Direction	Station	Direction
EAST HILLS TS	0° 00' 00"	LOFTUS TS	193° 20' 55.2"
CANAKYS TS	37° 25' 17.2"		
KURNELL TS	109° 32' 44.4"		
JANNALL (Pillar) TS	167° 43' 32.9"		
SUTHERLAND TS	169° 18' 26.8"		
Station	Direction	Station	Direction