

CENTRAL MAPPING AUTHORITY
Department of Lands

Trigonometrical Survey of N.S.W.

RECONNAISSANCE and MAINTENANCE REPORT

This Trig. Station has been:-

Note: Cross out word or words which do not apply

1. Completely cleared to permit 360° vision to surrounding Trigs.
2. Cleared by lanes bearing..... from Trig. Mast
3. Trig. Mast & Vanes have been painted white & black respectively.
4. The Trig. was unpiled/not unpiled, dimensions now being: ~~Original~~ Station Mark found/not found

Description of mark..... should be explicit, e.g. Steel plug, Brass plug, Bolt, G.I. Pipe
 Height of mark..... m ^{above} _{below} rock, concrete m ^{above} _{below} G.L.
 Height of Top Vanes to Top Mark..... m. Diameter of Vanes (vertical)..... m.
 Height of Cairn..... m. Diameter of Cairn..... m.
 Length of Mast..... m (approximate if not unpiled)

5. A..... set in conc/rock has been placed..... m. bearing.....°M from Trig. Mast
6. A..... set in conc/soil has been placed..... m. bearing.....°M from Trig. Mast
7. A..... set in conc/soil has been placed..... m. bearing.....°M from Trig. Mast
8. A..... set in conc/rock has been placed..... m. bearing.....°M from Trig. Mast
9. Connection..... m. bearing.....°M
10. Connection..... to..... m. bearing.....°M
11. Connection..... to..... m. bearing.....°M
12. Connection..... to..... m. bearing.....°M
13. Diff. Ht. is..... m. ^{above} _{below}
14. Diff. Ht. is..... m. ^{above} _{below}
15. Diff. Ht. is..... m. ^{above} _{below}
16. Diff. Ht. is..... m. ^{above} _{below}

Prepared by: Glen Jones 18-3-77 Checked: [Signature] 18-3-77 Noted on U.T.M. Card

STATION LOWES GS. OP. TS 2900

Co: WEST MORELAND Ph: BOLTON

Map Sheet: GERON 8830N

Inspected by: G. JONES

Authority: C.M.A.

No: 0-08

Date: 8/3/77

Field Book: 1544

Beacon Diagram

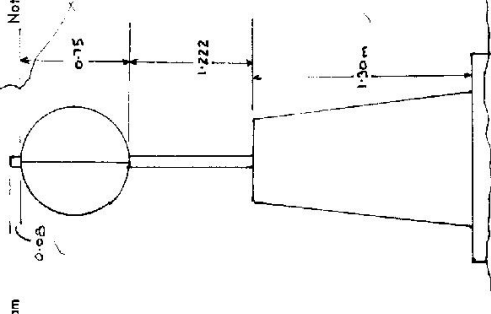

Date: _____ Record of Station

Checked

STATION **LOWES GS. OP.** TS 2900

Owners Name.....
 Current Occupant.....
 Address.....
 Address.....

Station Diagram

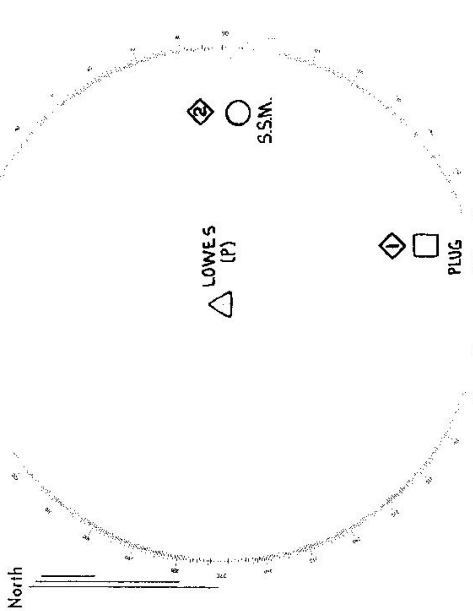

Access 8/3/1977
 Km

- 0.00 — Intersection at O'Connell. Sign says "Boathurst 22, Oberon 26, Black Springs 29, Wisemans creek 10". Take sealed road towards Oberon. →
- 1-15 — Bridge "Eight mile swamp creek"
- 1-20 — Sealed road on left continue straight ahead.
- 2-8 — Take dirt road to left. sign says "Carlinwood 14"
- 8-5 — Bridge "Rainville creek"
- 11-9 — Turn right thru gate "Sylmouthe Valley" and follow dirt track towards house.
- 12.6 — Gate. Go thru gate and proceed around telegraph pole to the right. Once thru sheds go down to gate at bottom right and of paddock
- 12.8 — Gate. Thru gate and follow track straight ahead and around hill.
- 13.7 — Keep dam to right and proceed uphill to opening in fence Thru opening in fence and follow wheeltracks to top of ridge thence along ridge.
- 14.3 — Thru gate and follow faint track up ridge.
- 15.6 — Triple gate. Take centre one and follow track to top of hill
- 15.9 — Lowes pillar.

List of Observed Directions:-

Standpoint:		Standpoint:	
Station	Direction	Station	Direction



CENTRAL MAPPING AUTHORITY

GEODETIC SURVEY OF N.S.W.

GEODETIC STATION RECONNAISSANCE and MAINTENANCE REPORT

Description:
 1. Cleared by lanes bearing 200 - 105 *Note: Cross out word or words which do not apply*
 2. Mast & Vanes have been painted white & black respectively. ✓
 3. The station/pillar was unpiled/~~not unpiled~~/~~constructed~~ on 15 - Avenue 19.84m, dimensions now being:
 Description of mark S/S Pillar Plate should be explicit, e.g., S/Steel Pillar Plate, Steel plug, Brass plug, Bolt, G.I. Pipe
 Height of markm. ^{above}/_{below} rock/concrete; Mark ism. ^{above}/_{below} G.L.
 Height of Top Vanes to Top Mark/Pillar platem. Diameter of Vanes (vertical)m.
 Height of Cairnm. Diameter of Cairnm. Name Plate ~~found~~/~~not found~~/~~placed~~.
 Length of Mastm. (approximate if not unpiled)
 4. A Trig. Plug 1 set in conc/rock has been placed/found, bearing 152.0° M from Mast/Plug/Pillar (not connected)
 5. A SSM 7184 2 set in conc/rock has been placed/found, bearing 77.0° M from Mast/Plug/Pillar
 6. A SSM (No. number) 3 set in conc/rock has been placed/found, bearing 129.0° M from Mast/Plug/Pillar
 7. A G.I. Pipe 4 set in ^{soil}conc/rock has been placed/found, bearing 230.0° M from Mast/Plug/Pillar
 8. Action reported: G.I. Pipe in soil placed for EDM to traverse point towards WHALAN (P)

STANDPOINT: Conc Pillar			STANDPOINT: SSM (No Number)			
Mark	Direction	Horiz. Distance	Height Difference	Direction	Horiz. Distance	Height Difference
TANNAS (P)	0 00 00		above standpt	0 00 00		above standpt
SSM 7184	189 03 00	3.469	1.466 above standpt	0 21 30	17.611	0.352 below standpt
SSM (No number)	241 53 00	5.400	1.450 above standpt	61 52 00	5.399	1.450 below standpt
STROMLO (P)	324 50 01		1.802 above standpt	101 46 30	4.308	0.016 below standpt
G.I. Pipe in soil	342 52 00	15.759	1.802 above standpt	324 50 24		below standpt

Prepared by: A. Sivertsen 25/10/84
 Checked: Noted on U.T.M. Card

STATION: LOWMES No.: 2900

MAP SHEETS Bathurst SCALE 1:100 000

INSPECTED BY: A. Sivertsen DATE: 15 - B - 84

AUTHORITY: CMA FIELD BOOK: C350

Station Diagram

North

Not to Scale

LOWMES (P)

TANNAS (P)

SSM 7184

STROMLO (P)

G.I. Pipe in soil

STANDPOINT: G.I. Pipe in soil

Mark

Direction

Horiz. Distance

Height Difference

TANNAS (P) 0 00 00

Pillar 162 51 10 15.762 1.802 above stpt

SSM 7184 167 29 20 18.932 0.338 above stpt

STROMLO (P) 324 47 47

210 300 180 170 160 150

Checked

