

CENTRAL MAPPING AUTHORITY
Department of Lands

Trigonometrical Survey of N.S.W.

RECONNAISSANCE and MAINTENANCE REPORT

STATION KEECH TS 2672

Co: PHILLIP Ph: RUNKER
Map Sheet: MT. POMANY No: 8932 - N
Inspected by: A. Silvertsen Date: 16 MAR. 1974
Authority: C. M. A. Field Book: # 524 below
Beacon Diagram Net to Scale

This Trig. Station has been:-
Note: Cross out word or words which do not apply

1. Completely cleared to permit 360° vision to surrounding Trigs.
2. Cleared by Jones bearing from Trig. Mast
3. Trig. Mast & Vanes have been painted white & black respectively.
4. The Trig. was unpiled/~~not unpiled~~, dimensions now being:

Description of mark... Brass Trig. Plug in conc. should be explicit, e.g. Steel plug, Brass plug, Bolt, G. I. Pipe
Height of mark... 0.030 m above rock/concrete ... 0.03 m above G.L.
Height of Top Vanes to Top Mark... 2.816 m. Diameter of Vanes (vertical)... 0.91 m.
Height of Cairn... 1.0 m. Diameter of Cairn... 2.30 m.

- Length of Mast... 3.34 m. (approximate if not unpiled)
5. A. ~~SET~~ set in conc/rock has been placed... 5.110 m. bearing... 2.3° from Trig. Mast
 6. A. set in conc/soil has been placed... m. bearing... 0°M from Trig. Mast
 7. A. set in conc/soil has been placed... m. bearing... 0°M from Trig. Mast
 8. A. set in conc/rock has been placed... m. bearing... 0°M from Trig. Mast

9. Connection to... m. bearing... 0°M
10. Connection to... m. bearing... 0°M
11. Connection to... m. bearing... 0°M
12. Connection to... m. bearing... 0°M
13. Diff. Ht. ~~ST Pipe in Conc. Pl.~~ is... 0.215 m. above below Trig. Plug in Conc. Pl.
14. Diff. Ht. is... m. above below
15. Diff. Ht. is... m. above below
16. Diff. Ht. is... m. above below

Prepared by: *A. Silvertsen* 16.3.74 Checked: Noted on U.T.M. Card

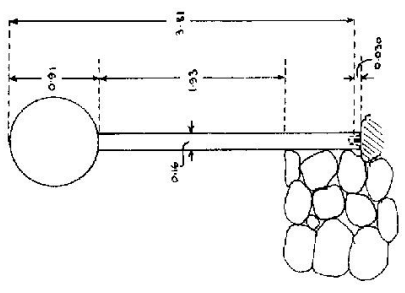

* G.S.M.S. REFLECTOR MARK 19 Falls 23.
Date _____ Record of Station _____
Checked

26-03

Department of Lands

RECONNAISSANCE and MAINTENANCE REPORT 2672

STATION KEECH 2672

This Trig. Station has been:-

1. Completely cleared to permit 360° vision to surrounding Trigs.
2. Cleared by James bearing from Trig. Mast
3. Trig. Mast & Vanes have been painted white & black respectively.
4. The Trig. was unpiled/~~not unpiled~~, dimensions now being:
 - Description of mark... BRASS. 8x6. should be explicit, e.g. Steel plug, Brass plug, Bolt, Concrete Pillar
 - Height of mark... 0.03 m above rock/concrete above G.L.
 - Height of Top Vanes to Top Mark/Top pillar plate 3.78 m Diameter of Vanes (vertical) 0.51 m.
 - Height of Cairn 1.0 m. Diameter of Cairn 2.5 m.
 - Length of Mast 3.81 m. (approximate if not unpiled)
5. A set in conc/rock has been placed/fd m. bearing m from Trig. Mast/pillar
6. A set in conc/soil has been placed/fd m. bearing m from Trig. Mast/pillar
7. A set in conc/soil has been placed/fd m. bearing m from Trig. Mast/pillar
8. A set in conc/rock has been placed/fd m. bearing m from Trig. Mast/pillar

Co: PHILLIP
 Map Sheet: MT POWANG
 Inspected by: C. W. STARKLEY
 Authority: DLPS LANDS
 No: 8932-N
 Date: 3-12-75
 Field Book: G.P.L. 27
 Not to Scale

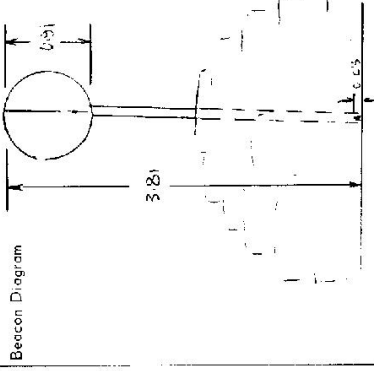

Date	Record of Station

Prepared by: [Signature]

Checked: [Signature]

STATION KEECI TS 2672

Owners Name..... Current Occupant.....

Address..... Address.....

Access 3-12-1975

FROM RYLSTONE TAKE MUSWELLBROOK ROAD. 00kms
 TURN RIGHT INTO PROPERTY AT GATE SIGNPOSTED
 "MOUNTAIN VIEW" (AT BREAKFAST CREEK). 14.4 kms

FOLLOW TRACK PAST HOUSE THEN THROUGH GATES
 TO GET ON SOUTHERN SIDE OF MAIN EAST WEST
 FENCE. 14.7 kms

FOLLOW FENCE TO STEEP CREEK CROSSING.
 CROSS CREEK THEN TURN RIGHT UP RIDGE
 AND DRIVE AS FAR AS POSSIBLE 15.2 kms
 FOLLOW RIDGE UP TO TS ABOUT 40 min walk.

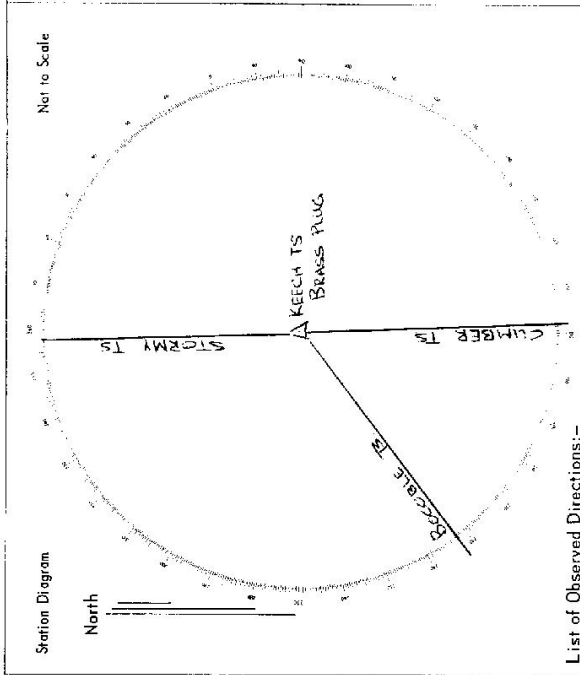

List of Observed Directions:-

Standpoint: TRIG PLUG		Standpoint:	
Station	Direction	Station	Direction
SILVERY TS	0°00'00"		
CUMBER (P) TS	118°50'13.4"		
BOGGON (P) TS	234°13'17.1"		

CENTRAL MAPPING AUTHORITY

GEODETIC SURVEY OF N.S.W.

GEODETIC STATION RECONNAISSANCE and MAINTENANCE REPORT

Description:

1. Cleared by lanes bearing 360° from Trig. Mast

2. Mast & Vanes have been painted white & black respectively.

3. The station ~~was~~ is unpiled/~~not~~ is constructed on 19.78 m. dimensions now being:

Description of mark BRASS PLUG should be explicit, e.g., S/Steel Pillar Plate, Steel plug, Brass plug, Bolt, G.I. Pipe

Height of mark 0.30 m. ^{above} rock/~~concrete~~; Mark is above G.L.

Height of Top Vanes to Top Mark/Pillar plate 2.99 m. Diameter of Vanes (vertical) 0.9 m.

Height of Cairn 1.30 m. Diameter of Cairn 2.20 m. Name Plate ~~found~~ not found placed.

Length of Mast 3.020 m. (approximate if not unpiled)

4. COPPER NAIL set in conc/~~rock~~ has been placed/~~found~~, bearing 130° from Mast/Plug/~~Pillar~~

5. G.I. PIPE set in conc/~~rock~~ has been placed/~~found~~, bearing 202° from Mast/Plug/~~Pillar~~

6. A set in conc/~~rock~~ has been placed/~~found~~, bearing 0° from Mast/Plug/~~Pillar~~

7. A set in conc/~~rock~~ has been placed/~~found~~, bearing 0° from Mast/Plug/~~Pillar~~

8. Action required: BRASS PLUG STANDPOINT: COPPER NAIL

Mark	Direction	Horiz. Distance	Height Difference	Mark	Direction	Horiz. Distance	Height Difference
CUMBER PILLAR	359 59 60	3.59	above standpt.	CUMBER PILLAR	09 60	3.59	below standpt.
G.I. PIPE	28 56 45	5.471	above standpt.	G.I. PIPE	72 27 00	5.997	above standpt.
DERALE G.S.	92 33 00	4.271	above standpt.	DERALE G.S.	92 32 45	4.278	above standpt.
COPPER NAIL	314 07 55	4.281	below standpt.	BRASS PLUG	134 07 10	4.278	below standpt.
			above standpt.				below standpt.
			below standpt.				above standpt.
			below standpt.				below standpt.
			above standpt.				above standpt.

Prepared by:

Checked:

SL 2739-1

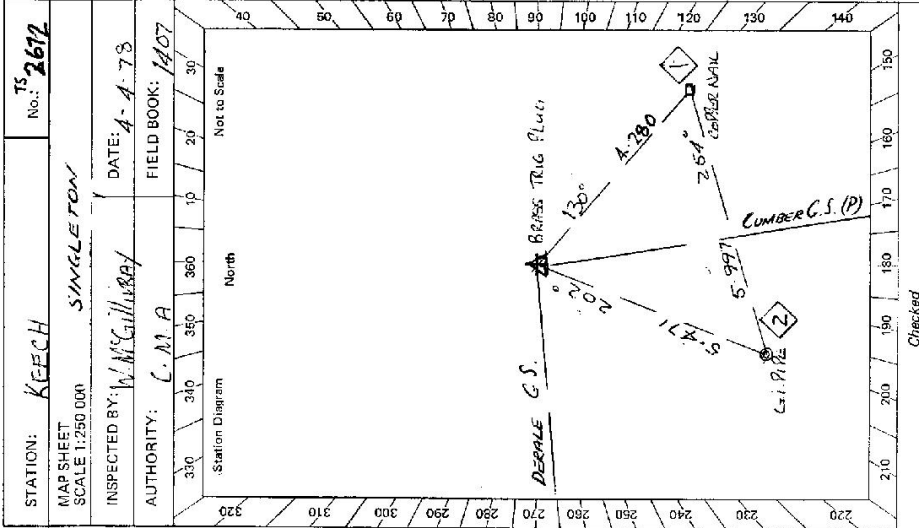

Checked

STATION Keech TS 2672	Owner's Name: Address: Phone: Current Occupant: Address: Phone: Access Report of 16/3/74 was found suitable.	Not to Scale
This section to be completed by officer constructing pillar. Original station mark found/ not found . Description of mark: BRASS PILLAR IN ROCK Original beacon found/ not found . Description of beacon: CIRCUAR MARK IN SAND Height Top of Vanes to Top Mark: 3.785 m. Height of mark 0.30 above rock/stone m. below G.L. Diameter of Vanes 0.917 m. Height of Cairn 1.00 m. Original Beacon has/ has not been destroyed by me.		Date Record of Station

GEODETTIC SURVEY OF N.S.W.

CENTRAL MAPPING AUTHORITY

GEODETTIC STATION RECONNAISSANCE and MAINTENANCE REPORT

STATION: **KEECH G.S** No.: **2672**

MAP SHEET SCALE: **1:250 000** **SINGLETON**

INSPECTED BY: **D. FREDRIKSEN** DATE: **6-2-79**

AUTHORITY: **C.M.A.** FIELD BOOK: **C-001/g**

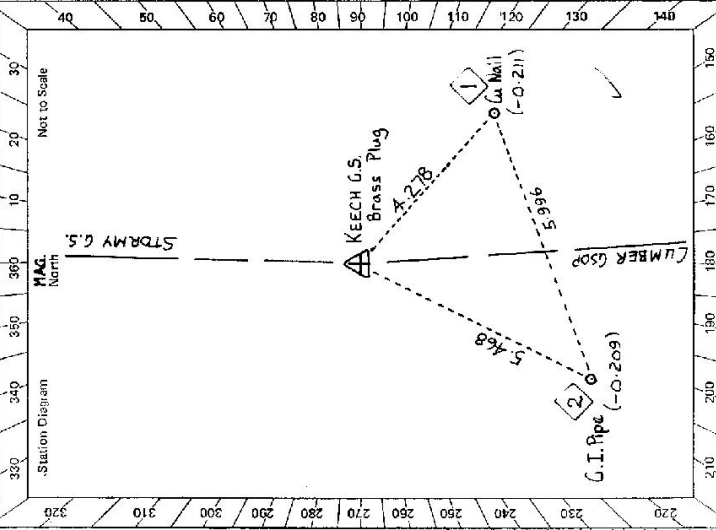

- Description: **36.0°**
 Note: *Cross out word or words which do not apply*
 1. Cleared by ~~laser-bearing~~ **36.0°** from Trig. Mast
 2. Mast & Vanes have been painted white & black respectively.
 3. The station ~~pillar~~ was unpiled/~~not unpiled~~/~~constructed on 6th February~~ **1979**, dimensions now being:
 Description of mark: ~~Brass Plug~~ **Steel Pillar Plate, Steel plug, Brass plug, Bolt, G.I. Pipe**
 Height of mark: ~~0.033~~ **0.033** m. ~~rock/concrete~~ **rock/concrete** Mark is ~~above~~ **below** G.L.
 Height of Top Vanes to Top Mark/~~Pillar-plate~~ **2.062** m. Diameter of Vanes (vertical) **0.915** m
 Height of Cairn: **1.0** m. Diameter of Cairn **2.0** m. Name Plate found/not found/placed.
 Length of Mast: **3.017** m. (approximate if not unpiled)
 4. A ~~set in conc/rock has been placed/found, bearing~~ **0** M from Mast/Plug/Pillar
 5. A ~~set in conc/rock has been placed/found, bearing~~ **0** M from Mast/Plug/Pillar
 6. A ~~set in conc/rock has been placed/found, bearing~~ **0** M from Mast/Plug/Pillar
 7. A ~~set in conc/rock has been placed/found, bearing~~ **0** M from Mast/Plug/Pillar
 8. Action required: **None**

Mark	Direction	Horiz. Distance	Height Difference	Mark	Direction	Horiz. Distance	Height Difference	STANDPOINT: Copper Nail	
								above/below standpt.	above/below standpt.
STORMY G.S.	0 00 00			STORMY G.S.	0 00 00				
G.I. Nail	132 56 30	4.278	0.210	CUMBER G.S.P.	178 51 21				
CUMBER G.S.P.	178 50 11			G.I. Pipe	251 18 30	5.996	0.003		
G.I. Pipe	207 44 30	5.468	0.209	Brass plug	312 58 00	4.278	0.212		

Prepared by: **K. THOMPSON** Checked: **W. Palmer 19/4/79** Note: on U.T.M. Card