

CENTRAL MAPPING AUTHORITY
Department of Lands

Trigonometrical Survey of N.S.W.

RECONNAISSANCE and MAINTENANCE REPORT

This Trig. Station has been:-

Note: Cross out word or words which do not apply

1. Completely cleared to permit 360° vision to surrounding Trigs.
2. Cleared by lanes bearing..... from Trig. Mast
3. Trig. Mast & Vanes have been painted white & black respectively.
4. The Trig. was unpiled/not unpiled, dimensions now being: ~~3.23m x 3.23m x 3.23m~~

Description of mark..... BRASS PLUG should be explicit, e.g. Steel plug, Brass plug, Bolt, G.I. Pipe
 Height of mark..... m ^{above} / _{below} rock/concrete m ^{above} / _{below} G.L.
 Height of Top Vanes to Top Mark..... m. Diameter of Vanes (vertical)..... m.
 Height of Cairn..... m. Diameter of Cairn..... m.

Length of Mast..... m. (approximate if not unpiled)
 5. A. G.I. PIPE set in conc/rock has been placed 2.558 m. bearing.....°M from Trig. ^{PLUG} Mast
 6. A. G.I. PIPE set in conc/soil has been placed 2.523 m. bearing.....°M from Trig. ^{PLUG} Mast
 7. A..... set in conc/soil has been placed..... m. bearing.....°M from Trig. Mast
 8. A..... set in conc/rock has been placed..... m. bearing.....°M from Trig. Mast
 9. Connection CUMUL. to G.I. PIPE : 2.260 m. bearing.....°M

10. Connection..... to..... m. bearing.....°M
 11. Connection..... to..... m. bearing.....°M
 12. Connection..... to..... m. bearing.....°M
 13. Diff. Ht. G.I. PIPE is 0.148 m. ^{above} / _{below} TRIG. PLUG
 14. Diff. Ht. CUMUL. is 0.197 m. ^{above} / _{below} TRIG. PLUG
 15. Diff. Ht. is..... m. ^{above} / _{below}.....
 16. Diff. Ht. is..... m. ^{above} / _{below}.....

Prepared by: [Signature] 11/12/16 Checked:..... Noted on U.T.M. Card

STATION JONES G.S. TS 2636
 Co: LIMBERLAND Ph: MAULY DRIVE
 Map Sheet: SYDNEY No: 4130 S
 Inspected by: D. KAIN Date: 29th SEPTEMBER 1972
 Authority: C. M. A. Field Book: Recⁿ No 9
 Beacon Diagram Net to Scale

Date 9/72 Record of Station
BRASS TRIG. PLUG FOUND

74 DR

CENTRAL MAPPING AUTHORITY

Department of Lands

Trigonometrical Survey of N.S.W.

RECONNAISSANCE and MAINTENANCE REPORT

This Trig. Station has been:

Note: Cross out word or words which do not apply

1. Completely cleared to permit 360° vision to surrounding Trig.
2. Cleared by James bearing..... from Trig. Mast
3. Trig. Mast & Vanes have been painted white & black respectively.
4. The Trig. was unpiled/not unpiled, dimensions now being:

Description of mark ~~37044555 3922 286607 04 1444 2478~~ should be explicit, e.g. Steel plug, Brass plug, Bolt, G.I. Pipe

Height of mark..... m above rock/concrete ~~1.44~~..... m above G.L.

Height of Top Vanes to Top Mark ~~2.68~~..... m. Diameter of Vanes (vertical) ~~0.541~~..... m.

Height of Cairn..... m. Diameter of Cairn..... m.

Length of Mast..... m. (approximate if not unpiled)

5. A. ~~G.I. PIPE~~..... set in conc/teck has been placed ~~2.548~~..... m. bearing ~~153~~.....°M from Trig. Mast ^{PILLAR}
6. A. ~~G.I. MARK~~..... set in conc/soil has been placed ~~2.519~~..... m. bearing ~~230~~.....°M from Trig. Mast ^{PILLAR}
7. A..... set in conc/soil has been placed..... m. bearing.....°M from Trig. Mast
8. A..... set in conc/rock has been placed..... m. bearing.....°M from Trig. Mast

9. Connection ~~G.I. MARK~~ to ~~G.I. PIPE~~ : ~~3.253~~..... m. bearing.....°M

10. Connection..... to..... m. bearing.....°M

11. Connection..... to..... m. bearing.....°M

12. Connection..... to..... m. bearing.....°M

13. Diff. Ht. ~~G.I. PIPE~~ is ~~1.416~~..... m. ^{above} ~~PILLAR PLATE~~

14. Diff. Ht. ~~G.I. MARK~~ is ~~1.307~~..... m. ^{above} ~~PILLAR PLATE~~

15. Diff. Ht. is..... m. ^{above}

16. Diff. Ht. is..... m. ^{above}

Prepared by: John 10/12/70

Checked:

Noted on U.T.M. Card

Checked

STATION ~~JONES~~ ~~G.S. 2636~~

Co: ~~CUMBERLAND~~ | Ph: ~~MANLY COVE~~

Map Sheet: ~~SYDNEY~~

No: ~~9130 S~~

Inspected by: ~~D. KAIN~~

Date: ~~5th FEBRUARY 1972~~

Authority: ~~C.M.A.~~

Field Book: ~~4224 46.9~~

Beacon Diagram

Not to Scale

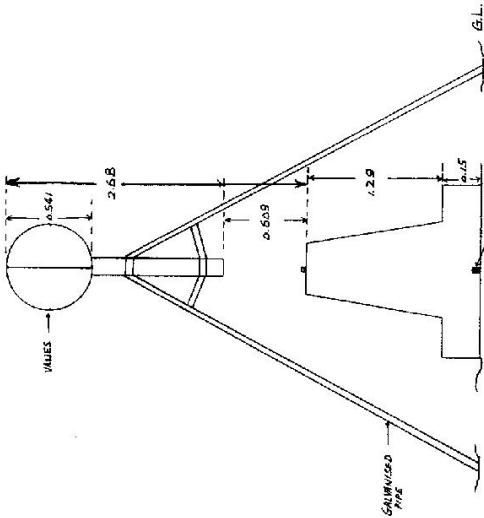

Date: ~~0/77~~

Record of Station

~~CONCRETE PILLAR BUILT AND SET IN UNDER GALVANIZED PIPE 1970~~
~~[ESTABLISHED OVER ORIGINAL MARK]~~
~~22-4-91 NEW MARK ESTABLISHED~~

STATION JONES G.S. TS 2636

Owners Name: Current Occupant:

Address: Address:

Access 5-10-1972

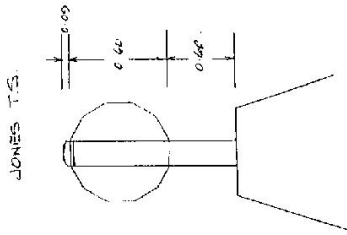

New mast & vane erected (700 hrs 22.4.91)
Effective Ht = 1.20 m

*David Howard
Senior Surveyor*

Out to Station

Station Diagram

Mag North

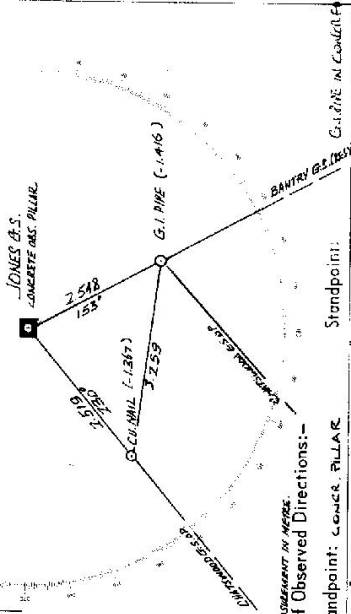

Accessed from in Access
List of Observed Directions:-

Station	Direction	Station	Direction
BANTRY RES. T.S.	307° 54' 60"	BANTRY RES. T.S.	333° 57' 60"
CHATELAIN PILLAR G.S.	77° 37' 40"	CHATELAIN PILLAR G.S.	79° 32' 04"
C.W. MAIN MAST VANE	80° 04'	C.W. MAIN MAST VANE	80° 25'
CHATELAIN PILLAR	359° 59'	CHATELAIN PILLAR	174° 57'

Station	Direction	Station	Direction

