

Department of Lands

Central Mapping Authority

Trigonometrical Survey of N.S.W.

RECONNAISSANCE and MAINTENANCE REPORT on HERBERT T.S. 2467 TRIG. STATION

Parish NELSON County CUMBERLAND Map Sheet PENRITH NORTH No. 6030

Inspected by R. G. HANNA Date of Inspection 22nd JUNE 1972

This Trig. Station has been:-

Note: Cross out word or words which do not apply

1. Completely cleared to permit 360° vision to surrounding Trigs.
2. Cleared by vanes bearing from Trig. Mast
3. The Trig. was unpiled/~~not unpiled~~. dimensions now being:

Original Trig. Plug was found/ not found .	
Length of Mast feet (approximate if not unpiled)	Mast (Round feet diameter (Square feet
Height of Trig. Plug feet (above rock/concrete)	
Height of Top Vanes to Top Trig. Plug feet	Diameter of Vanes (vertical) feet
Height of Cairn feet	Diameter of Cairn feet

(If other type Trig. beacon is erected - Diagram is required below in Remarks)

4. Trig. Mast & Vanes have been painted white & black respectively.
5. An S.S.M. set in conc/rock has been placed feet bearing M to Trig. Mast/Plug
6. A G.I. Pipe set in conc/soil has been placed feet bearing M to Trig. Mast/Plug
7. Connection S.S.M. to G.I. Pipe feet bearing M

REMARKS:- (To include diagram of marks placed)

North

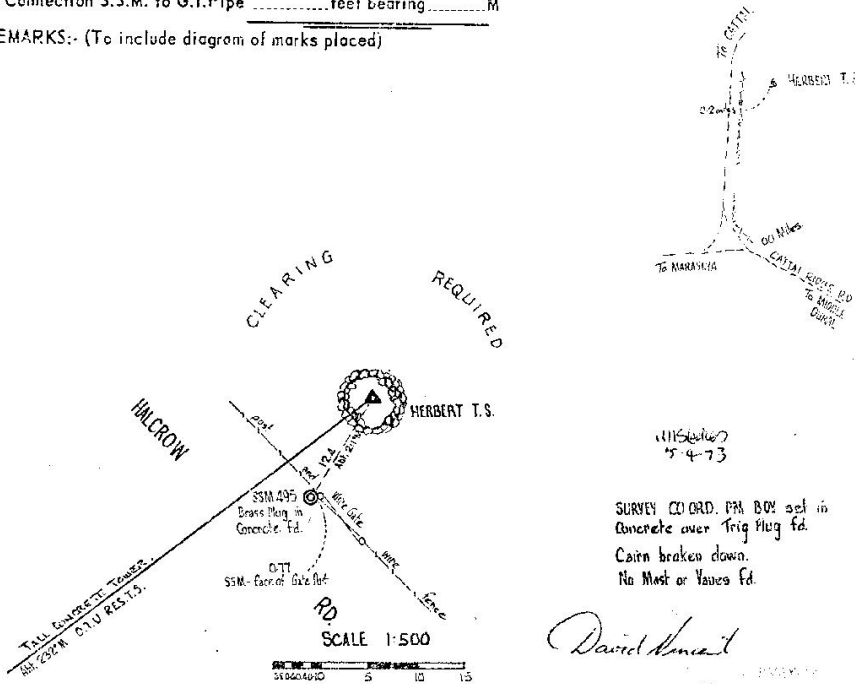

UNSHED
5-4-73
SURVEY COORD. P.M. BOY set in
Concrete over Trig Plug fd.
Cairn broken down.
No Mast or Vanes fd.

David Hanna

Signature R. G. Hanna 5TH JULY 1972

TS 2467
Trigonometrical Survey of N.S.W.

RECONNAISSANCE and MAINTENANCE REPORT on HERBERT TRIG. STATION

Parish NELSON County CUMBERLAND Map Sheet PENRITH NORTH No. 903011

Inspected by J. JUDGE Date of Inspection 12.4.72

This Trig. Station has been:-

Note: Cross out word or words which do not apply

1. Completely cleared to permit 360° vision to surrounding Trigs.
2. Cleared by lanes bearing to D.T.U. Res. T.S. 232° M. from Trig. Mast
3. The Trig. was unpiled/~~not unpiled~~, dimensions ~~now being~~:

Original Trig. Plug was found/~~not found~~.

Length of Mast feet (approximate if not unpiled) Mast (Round feet diameter
(Square feet

Height of Trig. Plug feet (above rock/concrete) Diameter of Vanes (vertical) feet

Height of Top Vanes to Top Trig. Plug feet

Height of Cairn feet Diameter of Cairn feet

(If other type Trig. beacon is erected Diagram is required below in Remarks)

4. Trig. Mast & Vanes have been painted white & black respectively.
5. An S.S.M. set in conc/rock has been placed feet bearing ° M to Trig. Mast/Plug
6. A G.I. Pipe set in conc/soil has been placed feet bearing ° M to Trig. Mast/Plug
7. Connection S.S.M. to G.I. Pipe feet bearing ° M

REMARKS:- (To include diagram of marks placed)

North

Unnumbered P.M. Cover Box has been placed around Trig Plug. Fd.
Trig was not repiled - Remains of Cairn surround Cover Box
Mast and Vanes gone

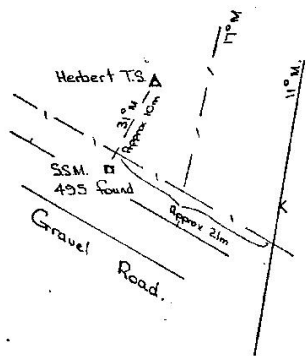

Card & Steel
Sketch
6.9.72

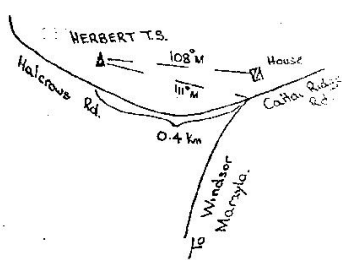

Signature M. Krabe

S.J.S.
12.4.72