

CENTRAL MAPPING AUTHORITY
Department of Lands

Trigonometrical Survey of N.S.W.

RECONNAISSANCE and MAINTENANCE REPORT

This Trig. Station has been:-

Note: Cross out word or words which do not apply

1. Completely cleared to permit 360° vision to surrounding ~~Trigs~~
2. Cleared by lanes bearing from Trig. Mast
3. Trig. Mast & Vanes have been painted white & black respectively. ✓
4. The Trig. was unpiled
dimensions now being:

Description of mark: Brass Plug in Rock Found ✓ should be explicit, e.g. Steel plug, Brass plug, Bolt, G.I. Pipe
 Height of mark: 0.020 m above rock ✓ 0.02 m above below G.L.
 Diameter of Vanes (vertical) 0.920 m.

Height of Cairn: m. Diameter of Cairn: m.

Length of Mast: m. (approximate if not unpiled)

5. A G.I. PIPE ✓ set in conc/rock has been placed. 2.722 m. bearing 165° ✓ from Trig. ^{Plug} Meet ✓
6. A Copper NAIL ✓ set in conc/ has been placed. 3.760 m. bearing 45° ✓ from Trig. ^{Plug} Meet ✓
7. A set in conc/soil has been placed m. bearing "M from Trig. Mast
8. A set in conc/rock has been placed m. bearing "M from Trig. Mast

9. Connection G.I. PIPE to Copper NAIL 5.636 m. bearing 21° ✓ M

10. Connection: to: m. bearing: "M

11. Connection: to: m. bearing: "M

12. Connection: to: m. bearing: "M

13. Diff. Ht. G.I. PIPE ✓ is 0.105 m. ^{above} TRIG. Plug ✓

14. Diff. Ht. Copper NAIL ✓ is 0.260 m. ^{below} TRIG. Plug ✓

15. Diff. Ht. Copper NAIL ✓ is 0.365 m. ^{above} G.I. PIPE ✓

16. Diff. Ht. is m. ^{above} G.I. PIPE ✓

Prepared by: Shack 3/3/76 Checked: 5

Noted on U.T.M. Card

STATION GUNDERMAN TS 2366

Co: CUMBERLAND Ph: Frederick

Map Sheet: GUNDERMAN No: 9131-III-S

Inspected by: H. P. JACKSON Date: 9/2/76

Authority: Geodetic Survey Div. C.M.A. Field Book: AB 1483

Benton Diagram Not to Scale

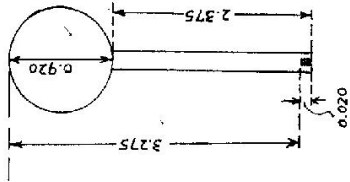

Date 1976 9/2 - Connections effected.

Record of Station

Checked

STATION **GUNDERMAN TS 2316**

Current Occupant:

Address:

Owners Name: **COMMON LAND**

Address:

Access **9-2-1976**

Not to Scale

Station Diagram

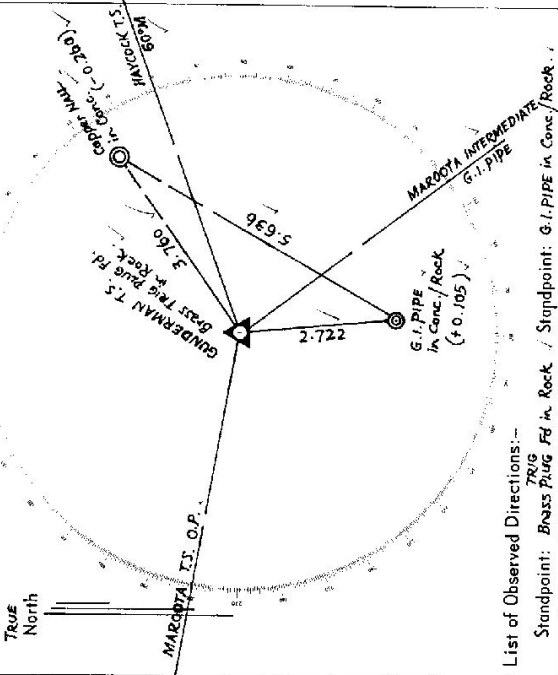

List of Observed Directions:-

Station	Direction	Station	Direction
HAYCOCK T.S.	359.59.60	HAYCOCK T.S.	359.59.60
MARBOOTA INTERMEDIATE G.I. PIPE	73.05.49	MARBOOTA INTERMEDIATE G.I. PIPE	73.05.49
G.I. PIPE in Conc./Rock	104.31	GUNDERMAN TRIG PLUG in Rock	284.28
MARBOOTA T.S. O.P.	210.08.75	Copper NAIL in Conc.	319.50
Copper NAIL in Conc.	344.32		
HAYCOCK T.S.	359.59.60		
MARBOOTA INTERMEDIATE G.I. PIPE	73.05.49		
MARBOOTA T.S. O.P.	210.08.75		

