

CENTRAL MAPPING AUTHORITY  
Department of Lands

Trigonometrical Survey of N.S.W.

RECONNAISSANCE and MAINTENANCE REPORT

STATION FREECUARD

TS 2105

Co.:

Map Sheet: GOSFORD

Ph:

No: 9131

Date:

Field Book:

Not to Scale

Inspected by:

Authority

Beacon Diagram

Note: Cross out word or words which do not apply

This Trig. Station has been:-

1. Completely cleared to permit 360° vision to surrounding Trigs.
2. Cleared by lanes bearing..... from Trig. Mast
3. Trig. Mast & Vanes have been painted white & black respectively.
4. The Trig. was unpiled/not unpiled, dimensions now being: *Original Station Mark found, not found*

Description of mark: *Plug in Rock*..... should be explicit, e.g. Steel plug, Brass plug, Bolt, G.I. Pipe

Height of mark..... m <sup>above</sup> <sub>below</sub> rock/concrete..... m <sup>above</sup> <sub>below</sub> G.L.

Height of Top Vanes to Top Mark..... m. Diameter of Vanes (vertical)..... m.

Height of Cairn..... m. Diameter of Cairn..... m.

Length of Mast..... m. (approximate if not unpiled)

5. A..... set in conc/rock has been placed..... m, bearing.....°M from Trig. Mast
6. A..... set in conc/soil has been placed..... m, bearing.....°M from Trig. Mast
7. A..... set in conc/soil has been placed..... m, bearing.....°M from Trig. Mast
8. A..... set in conc/rock has been placed..... m, bearing.....°M from Trig. Mast

9. Connection..... to..... m, bearing.....°M

10. Connection..... to..... m, bearing.....°M

11. Connection..... to..... m, bearing.....°M

12. Connection..... to..... m, bearing.....°M

13. Diff. Ht. .... is..... m, <sup>above</sup> <sub>below</sub>

14. Diff. Ht. .... is..... m, <sup>above</sup> <sub>below</sub>

15. Diff. Ht. .... is..... m, <sup>above</sup> <sub>below</sub>

16. Diff. Ht. .... is..... m, <sup>above</sup> <sub>below</sub>

Prepared by:..... Checked:.....

Noted on U.T.M. Card

Date

Record of Station

Checked

CENTRAL MAPPING AUTHORITY  
Department of Lands

Trigonometrical Survey of N.S.W.

RECONNAISSANCE and MAINTENANCE REPORT

This Trig. Station has been:-

Note: Cross out word or words which do not apply

1. Completely cleared to permit 360° vision to surrounding Trigs.
2. Cleared by vanes bearing from Trig-Mast
3. Trig-Mast & Vanes have been painted white & black respectively.
4. The Trig. was unpiled/not unpiled, dimensions now being:

Description of mark..... should be explicit, e.g. Steel plug, Brass plug, Bolt, G.I. Pipe  
 Height of mark..... m <sup>above</sup> rock/concrete ..... m <sup>below</sup> G.L.  
 Height of Top Vanes to Top Mark..... m. Diameter of Vanes (vertical)..... m.  
 Height of Cairn..... m. Diameter of Cairn..... m.

5. A..... m. (approximate if not unpiled)
6. A..... set in conc/rock has been placed..... m. bearing.....°M from Trig. Mast
7. A..... set in conc/soil has been placed..... m. bearing.....°M from Trig. Mast
8. A..... set in conc/rock has been placed..... m. bearing.....°M from Trig. Mast

9. Connection..... to..... m. bearing.....°M
10. Connection..... to..... m. bearing.....°M
11. Connection..... to..... m. bearing.....°M
12. Connection..... to..... m. bearing.....°M
13. Diff. Ht. .... is..... m. <sup>above</sup> <sub>below</sub>
14. Diff. Ht. .... is..... m. <sup>above</sup> <sub>below</sub>
15. Diff. Ht. .... is..... m. <sup>above</sup> <sub>below</sub>
16. Diff. Ht. .... is..... m. <sup>above</sup> <sub>below</sub>

Prepared by: P. CARR

Noted on U.T.M. Card

Checked:

Checked

STATION FREEGUARD T.S. 2105  
 Co: NORTHUMBERLAND Pt: WALLAMBINE  
 Map Sheet: GOSFORD No: 9131 S  
 Inspected by: P. CARR Date: 4/8/76  
 Authority: C.M.A. Field Book:

Beacon Diagram Not to Scale

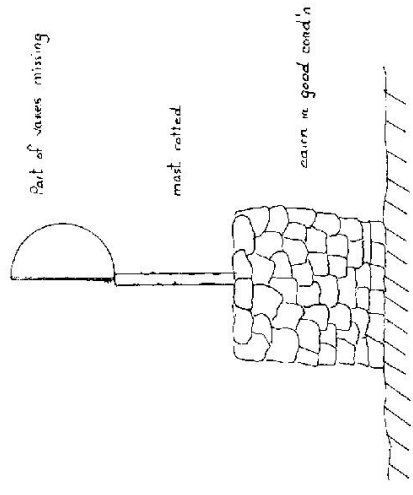

Date	Record of Station

STATION **FREGUARD T.S. 2105**

Owners Name: .....  
 Current Occupant: .....  
 Address: .....  
 Address: .....

Access  
 Km  
**4-8-1976**  
 (4 wheel drive)

- 0-0 ST. ALBANS P.O. and SETTLERS ARMS INN. TAKE ROAD TO CESSNOCK.
- 3-2 QUARRY ON RIGHT.
- 4-3 GRID
- 11-6 TURN RIGHT ONTO TRACK UP HILL. ( Just Before crossing creek )
- 12-3 IRON GATE.
- 15-5 TURN RIGHT ONTO OLD OVERGROWN TRACK.
- 17-0 OLD LOG LOADING RAMP ON RIGHT.
- 17-4 TAKE TRACK TO LEFT.
- 18-5 OLD LOG LOADING RAMP ON LEFT.
- 20-0 PARK TRACK and 10 min climb UP HILL To T.S.

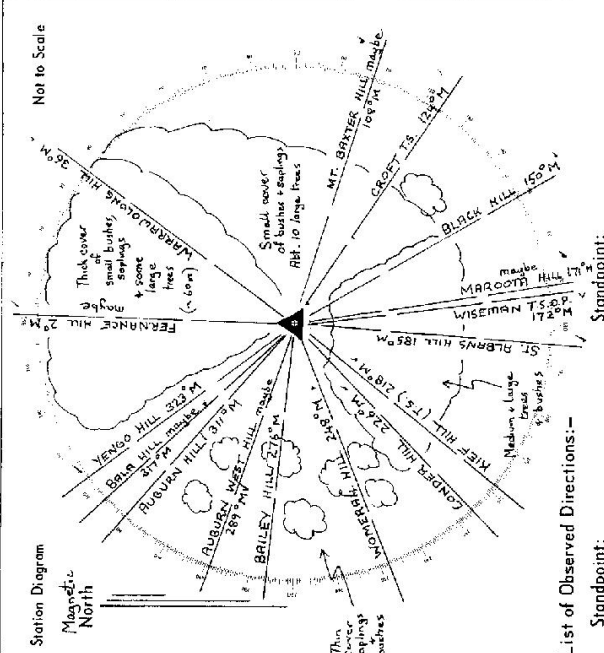

List of Observed Directions:-

Standpoint:

Station	Direction	Station	Direction

Station	Direction	Station	Direction

74-98

CENTRAL MAPPING AUTHORITY  
Department of Lands

Trigonometrical Survey of N.S.W.

RECONNAISSANCE and MAINTENANCE REPORT

STATION **FREEGUARD C.S. TS 2105**

Co: **NORTHUMBERLAND** Ph: **WALLAMBINE**

Map Sheet: **GOSFORD** No: **9131**

Inspected by: **W.M. GILLURAY** Date: **3 12 76**

Authority: **C.M.A.** Field Book:

This Trig. Station has been:-  
Note: Cross out word or words which do not apply

- 1. ~~Completely cleared to permit 360° vision to surrounding Trig.~~
- 2. Cleared by lanes bearing..... from Trig. Mast
- 3. Trig. Mast & Vanes have been painted white & black respectively.
- 4. The Trig. was unpiled/~~not unpiled~~, dimensions now being: .....  
Description of mark. **CARRIDGE CASE IN ROCK** should be explicit, e.g. Steel plug, Brass plug, Bolt, G.I. Pipe  
Height of mark..... m above rock/concrete..... m above below G.L.  
Height of Top Vanes to Top Mark **3 499** m. Diameter of Vanes (vertical) **0 916** m.  
Height of Cairn..... m. Diameter of Cairn..... m.

Length of Mast..... m. (approximate if not unpiled)

- 5. **COPPER NAIL** set in conc/rock has been placed **3 375** m. bearing **215** °M from Trig. Mast **PLUG**
- 6. **G.I. PIPE** set in conc/soil has been placed **3 674** m. bearing **289** °M from Trig. Mast **PLUG**
- 7. **A**..... set in conc/soil has been placed..... m. bearing..... °M from Trig. Mast
- 8. **A**..... set in conc/rock has been placed..... m. bearing..... °M from Trig. Mast

9. Connection..... to **G.I. PIPE** **4 290** m. bearing **337** °M

10. Connection..... to..... m. bearing..... °M

11. Connection..... to..... m. bearing..... °M

12. Connection..... to..... m. bearing..... °M

13. Diff. Ht. .... is..... m. above below

14. Diff. Ht. .... is..... m. above below

15. Diff. Ht. .... is..... m. above below

16. Diff. Ht. .... is..... m. above below

Beacon Diagram

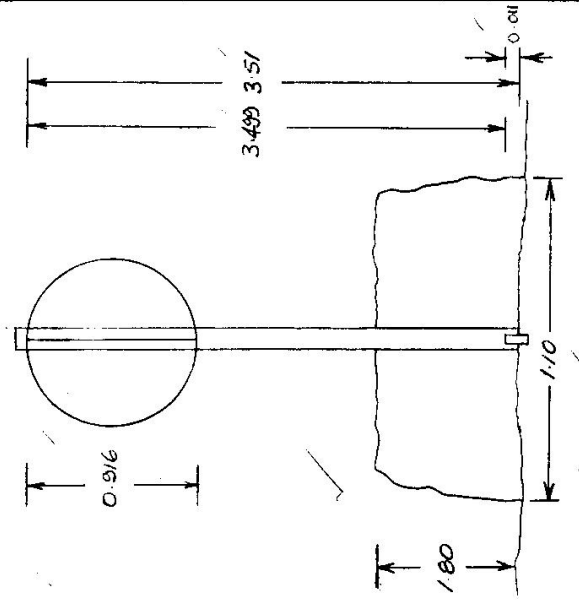

Date	Record of Station

Prepared by: **P. Myer** 2/3/77 Checked: **RMS** 2-2-77 Noted on U.T.M. Card

Checked

