

GEODETTIC SURVEY OF NSW

CENTRAL MAPPING AUTHORITY

GEODETTIC STATION RECONNAISSANCE and MAINTENANCE REPORT

Description:

1. Cleared by James-bearing. **Δ site surrounded by farm buildings & windbreak** Note: Cross out word or words which do not apply
2. Mast & Vanes have been painted white & black respectively.
3. The station/pillar was unpiled/not unpiled/constructed on.....19....., dimensions now being:  
Description of mark.....should be explicit, e.g., S/Steel Pillar Plate, Steel plug, Brass plug, Bolt, G.I. Pipe  
Height of mark.....m. <sup>above</sup> rock/concrete; Mark is.....m. <sup>above</sup> G.L.  
Height of Top Vanes to Top Mark/Pillar plate.....m. Diameter of Vanes (vertical).....m.  
Height of Cairn.....m. Diameter of Cairn.....m. Name Plate found/not found/placed.  
Length of Mast.....m. (approximate if not unpiled)
4. A.....set in conc/rock has been placed/found, bearing.....°M from Mast/Plug/Pillar
5. A.....set in conc/rock has been placed/found, bearing.....°M from Mast/Plug/Pillar
6. A.....set in conc/rock has been placed/found, bearing.....°M from Mast/Plug/Pillar
7. A.....set in conc/rock has been placed/found, bearing.....°M from Mast/Plug/Pillar

8. Action required:.....  
 STANDPOINT:.....  
 MARK:.....  
 SCALE:.....  
 1:25,000

Mark	Direction	Horiz. Distance	Height Difference	Mark	Direction	Horiz. Distance	Height Difference
			above standpt.				above standpt.
			below standpt.				below standpt.
			above standpt.				above standpt.
			below standpt.				below standpt.
			above standpt.				above standpt.
			below standpt.				below standpt.
			above standpt.				above standpt.
			below standpt.				below standpt.

Prepared by: *[Signature]*

Checked: *[Signature]*

Noted on U.T.M. Card

S: 2733-1

STATION: FINLAY No.: TS 2054

MAP SHEET SCALE 1:250 000 Goolburn

INSPECTED BY: A. Swettenham DATE: 18-10-78

AUTHORITY: CMA FIELD BOOK: 1709

Station Diagram

North

Not to Scale

No mark found - resection impossible

- useless as Δ site

+

Checked



7.5 10.9

Department of Lands

Integration of N.S.W.

RECONNAISSANCE and MAINTENANCE REPORT

STATION FINLEY TS-2054

Note: Cross out word or words which do not apply

This Trig. Station has been:-

1. Completely cleared to permit 360° vision to surrounding Trigs. ✓
2. Cleared by lanes bearing ..... from Trig. Mast
3. Trig. Mast & Vanes have been painted white & black respectively.
4. The Trig. was unpiled/not unpiled, dimensions now being:

- Description of mark..... should be explicit, e.g. Steel plug, Brass plug, Bolt, Concrete Pillar
- Height of mark..... m <sup>above</sup> <sub>below</sub> rock, concrete ..... m <sup>above</sup> <sub>below</sub> G.L.
- Height of Top Vanes to Top Mark/Top pillar plate ..... m Diameter of Vanes (vertical)..... m.
- Height of Cairn..... m. Diameter of Cairn..... m.
- Length of Mast ..... m. (approximate if not unpiled)
5. A..... set in conc/rock has been placed/fd ..... m. bearing.....°M from Trig. Mast/pillar
  6. A..... set in conc/soil has been placed/fd ..... m. bearing.....°M from Trig. Mast/pillar
  7. A..... set in conc/soil has been placed/fd ..... m. bearing.....°M from Trig. Mast/pillar
  8. A..... set in conc/rock has been placed/fd ..... m. bearing.....°M from Trig. Mast/pillar

9. Connection..... to..... m. bearing.....°M
10. Connection..... to..... m. bearing.....°M
11. Connection..... to..... m. bearing.....°M
12. Connection..... to..... m. bearing.....°M
13. Diff. Ht. .... is ..... m. <sup>above</sup> <sub>below</sub>
14. Diff. Ht. .... is ..... m. <sup>above</sup> <sub>below</sub>
15. Diff. Ht. .... is ..... m. <sup>above</sup> <sub>below</sub>
16. Diff. Ht. .... is ..... m. <sup>above</sup> <sub>below</sub>

Prepared by:

Checked:

Co: DENISON PH: ULUPUA  
 Map Sheet: BERKIAN 1:50,000 No:  
 Inspected by: R. LAUNDER Date: 15/11/93  
 Authority: GEORGE WOOD SERVICES Field Book:

Beacon Diagram Not to Scale

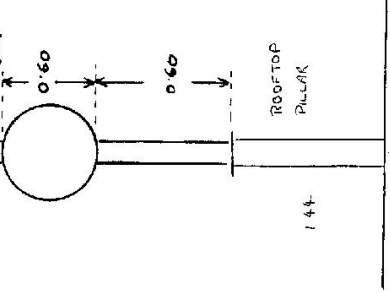

Date Record of Station

15.6.94 New Mast & Vanes Erected by R. LAUNDER

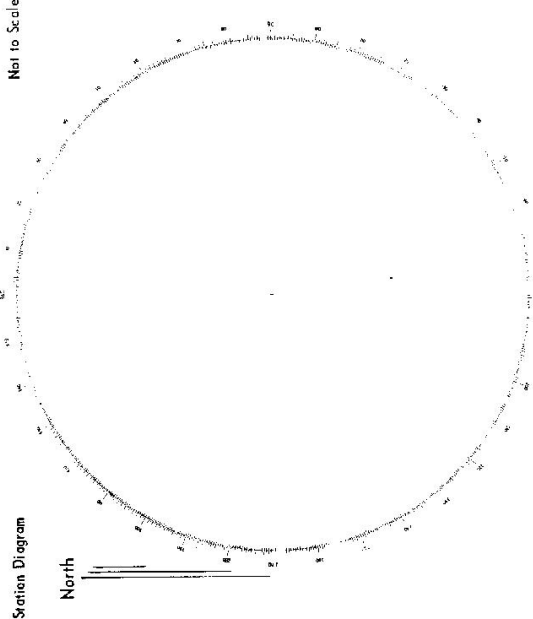
<p style="text-align: center;"><b>STATION</b>      <b>TS 2054</b></p> <p>Owners Name.....</p> <p>Address.....</p> <p>Current Occupant.....</p> <p>Address.....</p> <p>Access <b>18-11-1993</b></p> <p><b>OO</b> AT FINLEY P.O. AT CORNER OF DENISON ST. &amp; WARRATTA ST. HEAD NORTH ALONG DENISON ST.</p> <p><b>OS</b> AT COUNCIL DEPOT AT END OF DENISON ST</p> <p><b>TRIG.</b> ON CONCRETE RESERVOIR.</p> <p>- ACCESS VIA DOOR IN MAIN BRICK RAMP SHED INSIDE COUNCIL DEPOT</p> <p>- NO SAFETY CAGE ON STAIRS</p> <p>- NO SAFETY RAIL ON TOP OF RES.</p>	<p>Station Diagram</p> <p>North</p>  <p>Not to Scale</p> <p>List of Observed Directions:-</p> <table border="1" style="width: 100%; border-collapse: collapse;"> <thead> <tr> <th colspan="2">Standpoint:</th> </tr> <tr> <th style="width: 50%;">Station</th> <th style="width: 50%;">Direction</th> </tr> </thead> <tbody> <tr> <td> </td> <td> </td> </tr> <tr> <td> </td> <td> </td> </tr> <tr> <td> </td> <td> </td> </tr> </tbody> </table> <table border="1" style="width: 100%; border-collapse: collapse;"> <thead> <tr> <th style="width: 50%;">Station</th> <th style="width: 50%;">Direction</th> </tr> </thead> <tbody> <tr> <td> </td> <td> </td> </tr> <tr> <td> </td> <td> </td> </tr> <tr> <td> </td> <td> </td> </tr> </tbody> </table>	Standpoint:		Station	Direction							Station	Direction						
Standpoint:																			
Station	Direction																		
Station	Direction																		

# LOCALITY SKETCH PLAN

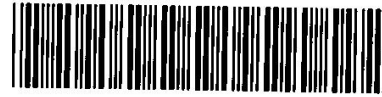

## TS2054

Local Government Area GOULBURN

Office Use - Barcode Including Number Inserted Here

Town/Suburb/Locality

Approx MGA Coordinate: Zone

Description of Mark BRONZE PLUG 0.3 BELOW

E:

NATURAL SURFACE

N:

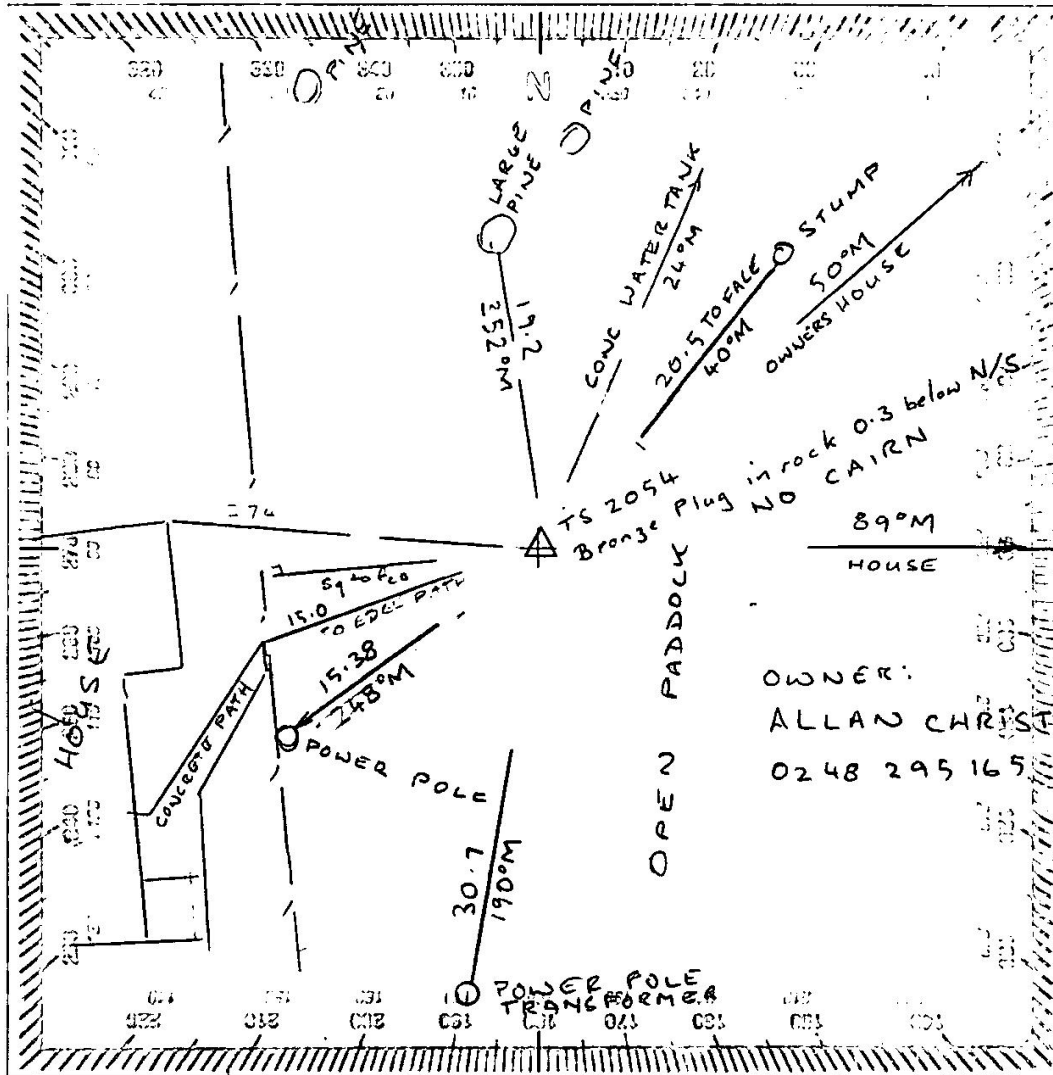

Please use black ink only

SURVEYING REGULATION			
MARK	AHD	SOURCE	DATE
HEIGHT DETERMINED BY (Specify)		- DIFF. LEVELLING - TRIG HEIGHTING	
ADOPTED MARKS		- GPS	

Measurements are in metres

TS 2054

PM FINLAY

SS

PM

Replaces

SS

I certify that the mark has been placed/found and numbered as detailed hereon.

Signed: *J. Cassidy*

Name: J. CASSIDY

Organisation placing mark: LPI

Date mark placed/found: 24/10/13

Ref:

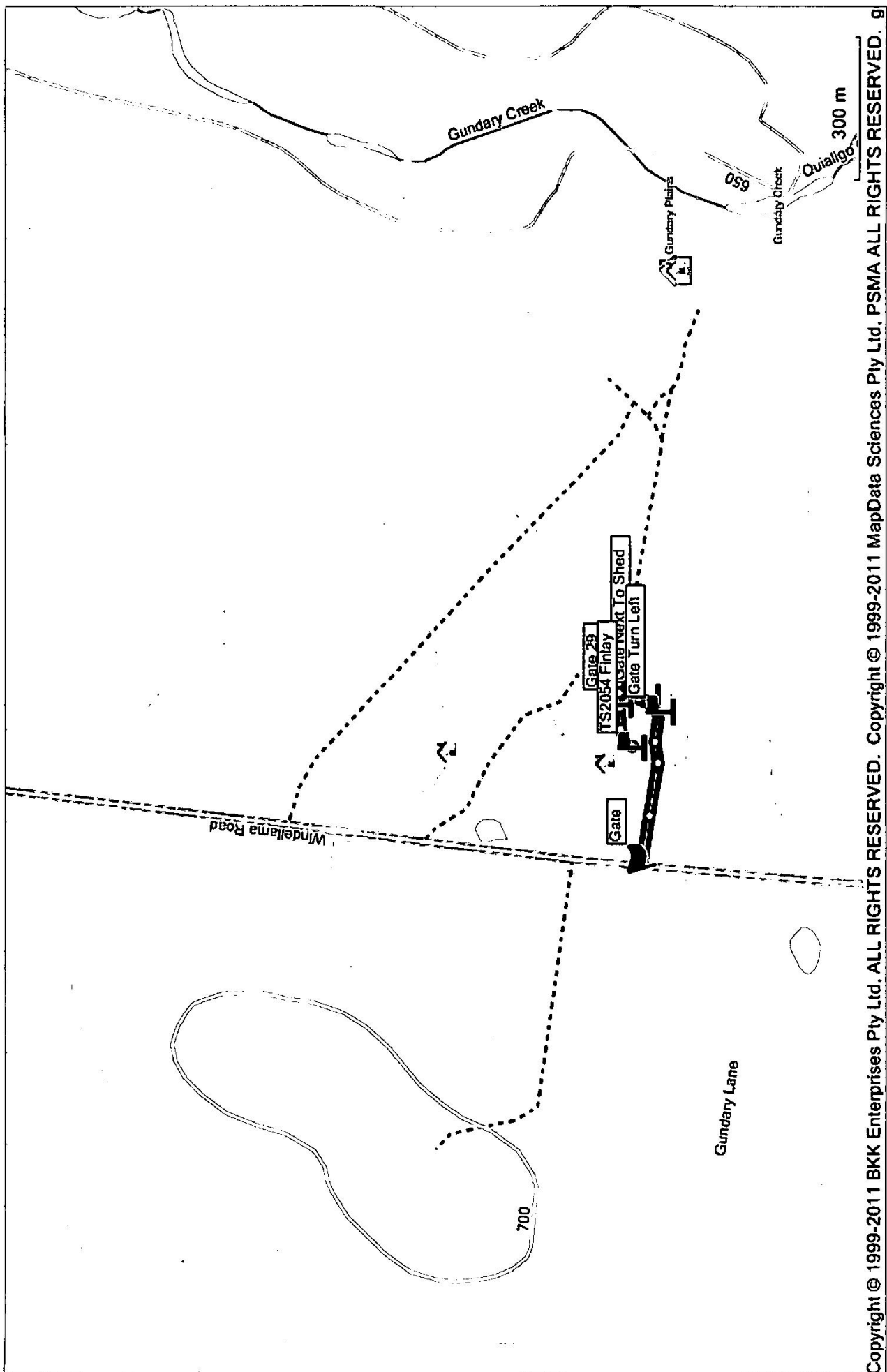

Copyright © 1999-2011 BKK Enterprises Pty Ltd. ALL RIGHTS RESERVED. Copyright © 1999-2011 MapData Sciences Pty Ltd. PSMA ALL RIGHTS RESERVED. g

CENTRAL MAPPING AUTHORITY

GEODETTIC SURVEY OF H.S.M.

GEODETTIC STATION RECONNAISSANCE and MAINTENANCE REPORT

STATION: FINLAY

MAP SHEET SCALE 1:250 000

75 No.: 2054

INSPECTED BY: A. Siversten DATE: 13-10-78

AUTHORITY: CMA FIELD BOOK: 1709

Station Diagram

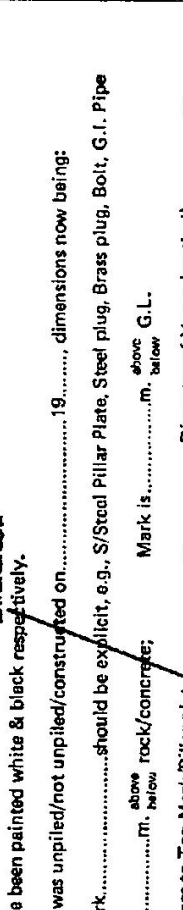

Description:

1. ~~Cleared by James-bearing Δ site supported by firm bracing from Trig. Mast~~

2. Mast & Vanes have been painted white & black respectively.

3. The station/pillar was unpiled/not unpiled/constructed on.....19....., dimensions now being:

Description of mark.....should be explicit, e.g., S/Steel Pillar Plate, Steel plug, Brass plug, Bolt, G.I. Pipe

Height of mark.....m. <sup>above</sup> rock/concrete; Mark is.....m. <sup>above</sup> G.L.

Height of Top Vanes to Top Mark/Pillar plate.....m. Diameter of Vanes (vertical).....m.

Height of Cairn.....m. Diameter of Cairn.....m. Name Plate found/not found/placed.

Length of Mast.....m. (approximate if not unpiled)

4. A.....set in conc/rock has been placed/found, bearing.....°M from Mast/Plug/Pillar

5. A.....set in conc/rock has been placed/found, bearing.....°M from Mast/Plug/Pillar

6. A.....set in conc/rock has been placed/found, bearing.....°M from Mast/Plug/Pillar

7. A.....set in conc/rock has been placed/found, bearing.....°M from Mast/Plug/Pillar

8. Action required.....

STANDPOINT: ~~S. O. M. S. P. R. A. N.~~

1:25,000

Mark	Direction	Horiz. Distance	Height Difference	Mark	Direction	Horiz. Distance	Height Difference
			above standpt below				above standpt below
			above standpt below				above standpt below
			above standpt below				above standpt below
			above standpt below				above standpt below
			above standpt below				above standpt below
			above standpt below				above standpt below
			above standpt below				above standpt below

Prepared by: [Signature]

Checked: [Signature]

Noted on U.T.M. Card

51 2733-1

66 2720-2 D. West, Government Printer

STATION **FINLAY TS 2054**

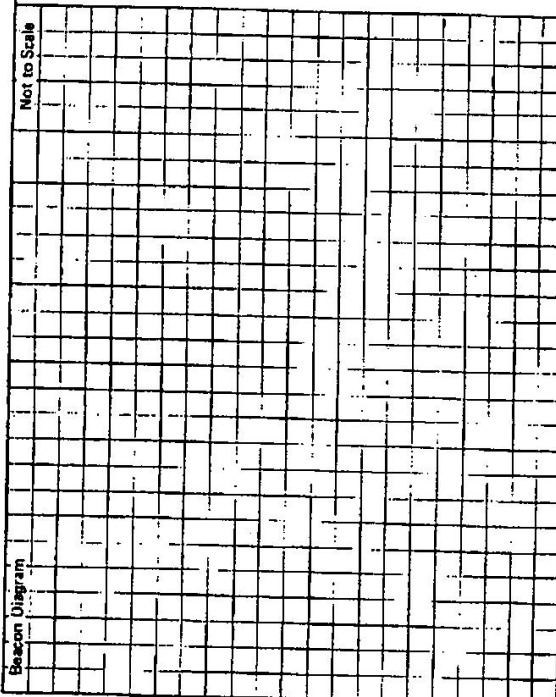

Owner's Name: .....  
 Address: .....  
 Phone: .....

Current Occupant: .....  
 Address: **"Pinupirina"** .....  
 Phone: .....

**ACCESS**

Access Report of **13/10/1918** was found suitable/unusable.

0.0 In Goulburn at J of BRADWOOD of SUNGONIA roads  
 Take SUNGONIA road  
 1.45 Take R fork towards SUNGONIA AERODROME  
 2.45 Take R fork towards AERODROME  
 5.2 Pass AERODROME entrance on R  
 10.0 Take track into "Pinupirina" on L  
 10.2 A site

This section to be completed by officer constructing pillar.

Original station mark found/not found.

Description of mark: .....

Original beacon found/not found.

Description of beacon: .....

Height Top of Vane to Top Mark: .....m.

Height of mark: .....m. above rock/cont. ....m. show G.L. below

Diameter of Vane: .....m. Height of Cairn: .....m.

Original Beacon has/has not been destroyed by me.

Date	Record of Station