

CENTRAL MAPPING AUTHORITY

GEODETIC SURVEY OF N.S.W.

GEODETIC STATION RECONNAISSANCE and MAINTENANCE REPORT

STATION: **FELSPAR G.S.** No: **2039**
 MAP SHEET: **THACKARA**
 SCALE: **1:100,000**

Description: **36.0°** Note: Cross out word or words which do not apply

1. Cleared by lanes bearing **36.0°** from Trig. Mast

2. Mast Vanes have been painted **black**

3. The station **was unpiled/re-established** on **21st November 1989**, dimensions now being:

Description of mark **Steel Pillar Plate, Steel plug, Brass plug, Bolt, G.I. Pipe**

Height of mark **0.020** m. ^{above} **concrete** Mark is **concrete** m. ^{above} G.L.

Height of Top Vanes to Top Mark **3.230** m. Diameter of Vanes (vertical): **0.97** m.

Height of Cairn **1.750** m. Diameter of Cairn **0.300** m. Name Plate found/not found/placed.

Length of Mast **3.380** m. (~~approximate~~)

4. A **STAR PICKET** set in conc/rock has been **placed**/found, bearing **305°** M from **Mast/Plug/Pillar**

5. A **STAR PICKET** set in conc/rock has been **placed**/found, bearing **358°** M from **Mast/Plug/Pillar**

6. A **STAR PICKET** set in conc/rock has been **placed**/found, bearing **59°** M from **Mast/Plug/Pillar**

7. A **STAR PICKET** set in conc/rock has been **placed**/found, bearing **0°** M from **Mast/Plug/Pillar**

8. Action required: **replace some of the marks - re-bore Cairn - Steel mast & vanes in good condition**

CONNECTION: **possible to place concrete observing Mark**

Mark	Direction	Horiz. Distance	Height Difference	Mark	Direction	Horiz. Distance	Height Difference
R.O. DRILL HOLE	0 00 00		above standpt.	R.O. DRILL HOLE	0 00 00		above standpt.
STAR PICKET (1)	164 11 55	5.112	above standpt.	1/4 COPPER TUBE TRIG. PEG	33 59 30	4.398	above standpt.
STAR PICKET (2)	217 24 50	4.396	above standpt.	STAR PICKET (1)	05 53 20	4.347	above standpt.
TWENTY MILE (1)	217 31 50		above standpt.	TWENTY MILE (2)	214 05 50		above standpt.
STAR PICKET (3)	278 18 50	4.434	above standpt.	STAR PICKET (3)	334 01 10	4.475	above standpt.
			below				below
			above standpt.				above standpt.
			below				below

STANDPOINT: **1/4 COPPER TUBE TRIG. PEG** **STAR PICKET (2)**

Prepared by: **P.B.TTS 4th DECEMBER 1989** Checked: **MP** Noted on U.T.M. Card

51 2738-1

INSPECTED BY: **P.B.TTS** DATE: **21/11/89**

AUTHORITY: **LAND INFORMATION CENTRE** FIELD BOOK: **1964**

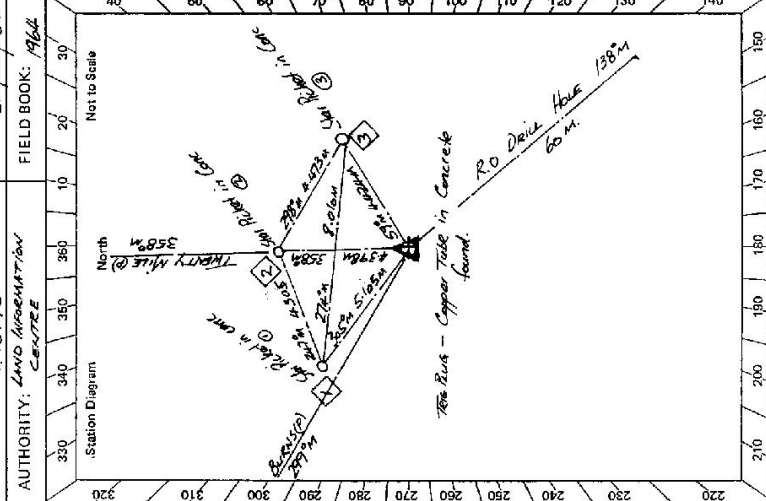

GS 24

STATION FELSPAR G.S. TS 2039

LESSEE
 Owners Name: MR. T. J. LOED
 Address: TRACHANGA ROAD, CP
POB 91 1637
 Phone: AK 509 211682 91 1638

OWNER'S NAME: WATERBU LINDS
 Address: COMMISSION
 Phone: MR. F. M. M. CARMICK

ACCESS

4WD Access
 Access Report of 11/1/1981 was found suitable/unavailable.

- 0.00 1ST OFFICE BOKEN HILL HEAD SOUTH ALONG ARGENT STREET.
- 0.44 TURN RIGHT BROWNIE STREET 3RD ADELAIDE
- 0.67 STRAIGHT THROUGH ROUNDABOUT
- 1.68 TURN LEFT WILLIAM STREET BECOMES BARRIER HIGHWAY
- 3.04 STRAIGHT AHEAD THROUGH ROUNDABOUT
- 28.58 TURN LEFT ONTO GRAVEL ROAD
- 33.28 GRID - CROSS RAILWAY LINE - GRID
- 35.13 GRID
- 38.88 10M GATE
- 41.30 AT JOURNEY INTERSECTION, TAKE ROAD TO LEFT TRIG HILL BEARING 152PM,
- 41.56 GULLY STRAIGHT AHEAD, CROSSBURN - TRIPLE CANOE MINE ON RIGHT.
- 41.62 GULLY CROSSING
- 42.80 TURN RIGHT ONTO MAINT TRACK
- 43.47 VEER RIGHT AND CROSS GULLY
- 43.56 GULLY CROSSING
- 44.29 GULLY CROSSING
- 44.47 VEER RIGHT AWAY FROM GULLY ON TRACK.
- 44.56 TAKE RIGHT FORK IN TRACKS
- 44.95 AT END OF STAND OF SWEA CREEK, VEER LEFT UP MAINT TRACK
- 45.14 FELSPAR G.S.

ACCESS TIME
 50 MINUTES
 FROM BOKEN HILL

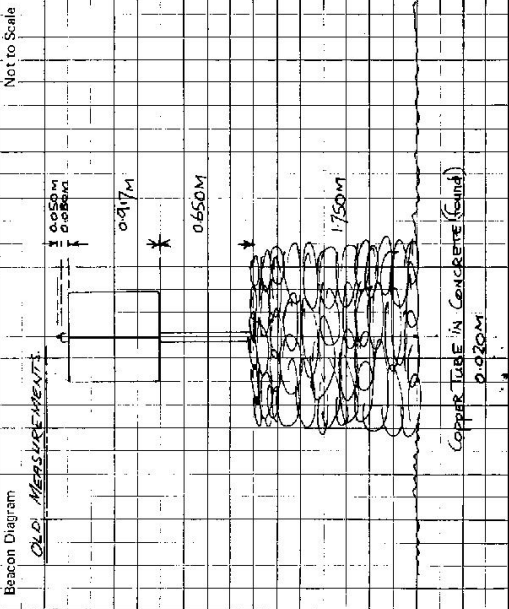

This section to be completed by officer constructing pillar.

Original station mark found/ ~~was found~~.

Description of mark: COPPER TUBE IN CONCRETE

Original beacon found/ ~~was found~~.

Description of beacon: COPPER PIPE & DISC

Height Top of Vanes to Top Mark: 3.230 m.

Height of mark: 0.020 m. above rock/conc. 0.020 m. below G.L.

Diameter of Vanes 0.917 m. Height of Cairn 1.750 m.

Original Beacon ~~has~~ has not been destroyed by me.

Date

Record of Station

CARD 2 OF 2

GEODETTIC SURVEY OF N.S.W.

CENTRAL MAPPING AUTHORITY

GEODETTIC STATION RECONNAISSANCE and MAINTENANCE REPORT

Description:

1. Cleared by lanes bearing 360°.
Note: Cross out word or words which do not apply from Trig. Mast
2. Mast & Vanes have been painted white & black respectively.
REPAIRED
3. The station/pillar was ~~unplugged~~ *reconstructed* on 2.7m ~~concrete~~ *concrete* in 1970, dimensions now being:
Description of mark: 1/2" Copper Tube should be explicit, e.g., S/Steel Pillar Plate, Steel plug, Brass plug, Bolt, G.I. Pipe
Height of mark 0.020 m. above ~~below~~ *concrete*; Mark is m. above ~~below~~ *G.L.*
Height of Top Vanes to Top Mark/ ~~Plate~~ *Plate* m. Diameter of Vanes (vertical) 0.917 m.
Height of Cairn 1.500 m. Diameter of Cairn m. Name Plate found/not found/placed.
Length of Mast m. (approximate if not unplugged)
4. A set in conc/rock has been placed/found, bearing °M from Mast/Plug/Pillar
5. A set in conc/rock has been placed/found, bearing °M from Mast/Plug/Pillar
6. A set in conc/rock has been placed/found, bearing °M from Mast/Plug/Pillar
7. A set in conc/rock has been placed/found, bearing °M from Mast/Plug/Pillar
8. Action required: Remove 2/10/90. SURVEY MARKS HAVE BEEN PLACED IN CONCRETE

STANDPOINT: STAR PICKET (3)

Mark	Direction	Horiz. Distance	Height Difference	Mark	Direction	Horiz. Distance	Height Difference
R.O DRILL HOLE	0 00 00		above standpt				above standpt
1/2" Copper Tube	92 08 30	4.435	below standpt				below standpt
STAR PICKET (1)	127 41 25	8.021	above standpt				above standpt
STAR PICKET (2)	151 15 10	4.476	below standpt				below standpt
TWENTY NINE (1)	211 19 20		above standpt				above standpt
			below standpt				below standpt

Prepared by: P. Potts 13th MARCH 1990 Checked: AG Noted on U.I.M. Card

S.O. 1407

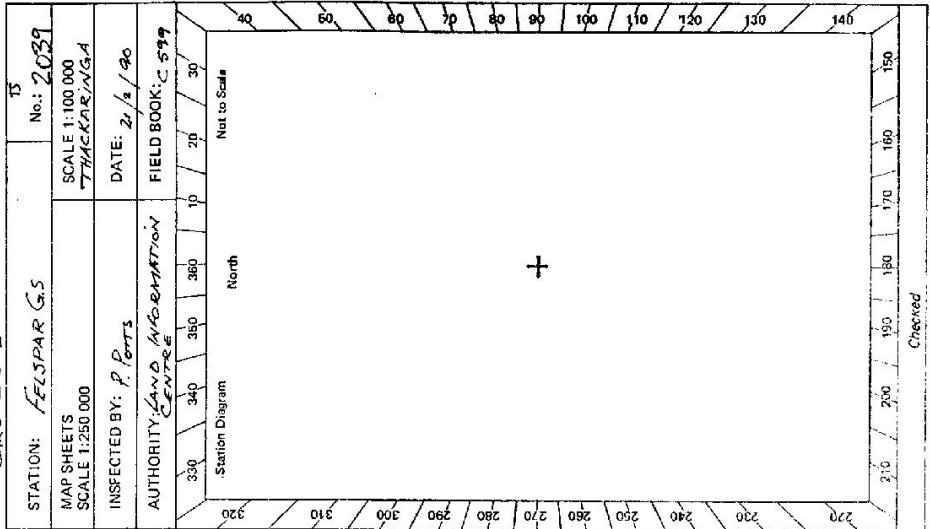

GS 24

STATION <u>FELSPAR G.S.</u> TS <u>2039</u>	LESSEE Tenant Occupant: <u>MR J.M. LORD</u> Address: <u>TRACKING WGA, BATORAL C</u> <u>PHASE 911637</u> PHONE: <u>MR SON D.L. LORD 911638</u>
Owner's Name: <u>WESTERN LANDS</u> Address: <u>COMMISSION</u> Phone: <u>MR ERIC MCCORMICK</u>	ACCESS: Access Report of <u>21.12.15</u> was found suitable/unsuitable.
Beacon Diagram Net to Scale 	This section to be completed by officer constructing pillar. Original station mark found/not found. Description of mark: Original beacon found/not found. Description of beacon: Height Top of Vanes to Top Markm. Height of markm. above G.L. below Diameter of Vanesm. Height of Cairnm. Original Beacon has/has not been destroyed by me.
Date Record of Station	