

Department of Lands  
**NON-GEODETIC CONTROL POINT**  
 RECONNAISSANCE and MAINTENANCE REPORT 1972

STATION **ENMORE (DTS) 1972**

Co: \_\_\_\_\_ Ph: \_\_\_\_\_ No: \_\_\_\_\_  
 Map Sheet: \_\_\_\_\_ Date: 30/7/75  
 Inspected by: **C. M. STARKLEY** Field Book: C.M.S.S.  
 Authority: **D.L.S. LANDS** Not to Scale

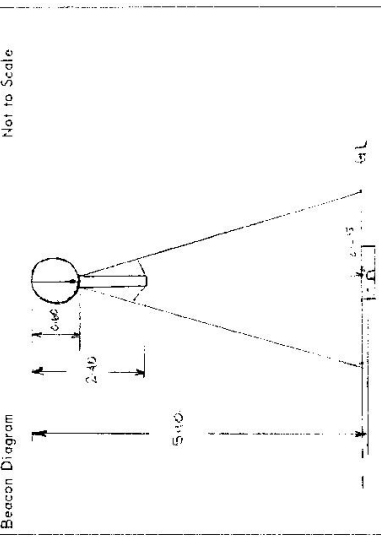

This Trig. Station has been:-  
 Note: Cross out word or words which do not apply

1. Completely cleared to permit 360° vision to surrounding Trigs.
2. Cleared by lances bearing **2.1 M. to 30.1 M.** from Trig. Mast
3. Trig. Mast & Vanes have been painted white & black respectively.
4. The Trig. was unpiled/~~not unpiled~~, dimensions now being:

Description of mark: **BRASS PLUG IN CONCRETE** should be explicit, e.g. Steel plug, Brass plug, Bolt, Concrete Pillar  
 Height of mark: **2.40 m** <sup>above</sup> ~~below~~ **concrete** <sup>above</sup> ~~below~~ **G.L.**  
 Height of Top Vanes to Top Mark: **5.10 m** Diameter of Vanes (vertical): **0.40 m**  
 Height of Chim: **0.40 m** Diameter of Chim: **0.40 m**  
 Length of Mast: **2.40 m** (approximate if not unpiled)

5. A **STEEL** set in conc/rock has been placed/d **1.550 m**, bearing **2.6** from Trig. Mast/pillar
6. A **CONCRETE** set in conc/rock has been placed/d **3.211 m**, bearing **307** from Trig. Mast/pillar
7. A **STEEL** set in conc/soil has been placed/d **1.435 m**, bearing **141** from Trig. Mast/pillar
8. A **STEEL** set in conc/rock has been placed/d **1.435 m**, bearing **141** from Trig. Mast/pillar
9. Connection: **SOIL** to **CONCRETE** **1.435 m**, bearing **141**
10. Connection: to **STEEL** **1.435 m**, bearing **141**
11. Connection: to **CONCRETE** **3.211 m**, bearing **307**
12. Connection: to **STEEL** **1.550 m**, bearing **2.6**
13. Diff. Ht. **SOIL** is **2.39 m** <sup>above</sup> ~~below~~ **Trig plug**
14. Diff. Ht. **CONCRETE** is **0.11 m** <sup>above</sup> ~~below~~ **Trig plug**
15. Diff. Ht. **STEEL** is **0.11 m** <sup>above</sup> ~~below~~ **Trig plug**
16. Diff. Ht. **CONCRETE** is **2.39 m** <sup>above</sup> ~~below~~ **Trig plug**

Prepared by: **C. STARKLEY** Checked: **B. J. J.**

Date	Record of Station

STATION ENMORE TS 1972

Owners Name..... Current Occupant.....

Address..... Address.....

Access 30-7-1975

AT CAMPBELLTOWN TAKE BADGELLY RD (ON WESTERN SIDE OF RAILWAY LINE) FOLLOW THIS W. WEST FOR ABOUT 175M TO A wooden gate on right. TS can be seen from road.

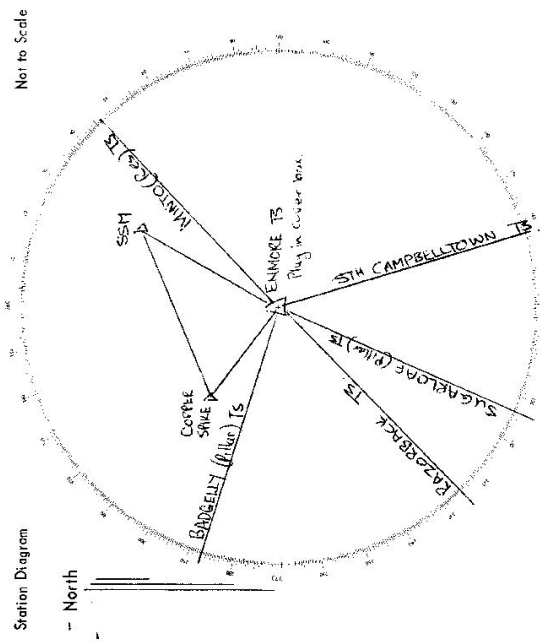

List of Observed Directions:-

Standpoint: Tg16 plus.

Station	Direction	Station	Direction
SUGARLOAF TS	02° 00' 00"	MINYO TS	202° 42' 52"
KAZORBACK TS	22° 25' 34" 8	5TH CAMPBELLTOWN TS	326° 42' 19" 1
BADGELLY TS	84° 10' 12" 6		
COFFER SRAVE W. CORR.	104° 41' 14"		
SSM W. CORR.	186° 22' 42"		

Station	Direction	Station	Direction

STATION **TS1972 ENMORE (A)**  
 Co: **CUMBERLAND Pt: ST. PETER**  
 Map Sheet: **MINTO** No: **UB230**  
 Inspected by: **R. CUBIS** Date: **8/2/80**  
 Authority: **DEPT. OF LANDS** Field Book: **PPP 1301**

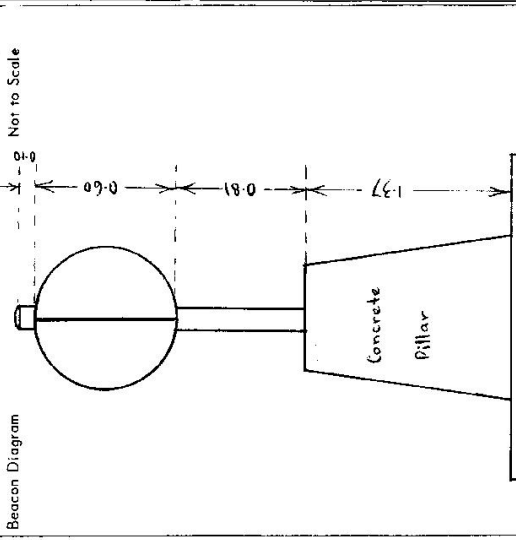

Date	Record of Station
10.1.80	New concrete Pillar erected.

Department of Lands  
 Integral Survey of N.S.W.  
**RECONNAISSANCE and MAINTENANCE REPORT**

This Trig. Station has been: Noted: Cross out word or words which do not apply

1. Completely cleared to permit 360° vision to surrounding Trigs.
2. ~~Cleared by fumes bearing~~ from Trig. Mast

3. Trig. Mast & Vanes have been painted white & black respectively.  
~~The Trig. was unpainted, dimensions now being:~~  
 Description of mark: Concrete Pillar should be explicit, e.g. Steel plug, Brass plug, Bolt, Concrete Pillar  
 Height of mark: 1.37 m above ~~concrete~~ concrete m above G.L.  
 Height of Top Vanes to Top Mark/Top pillar plate: 1.41 m Diameter of Vanes (vertical): 0.60 m.

- ~~Height of Concrete Pillar~~
- Length of Mast: 1.51 m. (approximate if not unpled)
5. Trig. Plug set in conc. ~~has been placed~~ fd 13.280 m. bearing 200 °M from Trig. ~~mark~~ pillar
6. A. SSM set in conc. ~~has been placed~~ fd 5.193 m. bearing 190 °M from Trig. ~~mark~~ pillar
7. Upper Spike set in conc. ~~has been placed~~ fd 12.739 m. bearing 217 °M from Trig. ~~mark~~ pillar
8. A set in conc./rock has been placed/rd   m. bearing   °M from Trig. Mast/pillar
9. Connection Trig. Plug to SSM 7.538 m. bearing 28 °M
10. Connection Trig. Plug to Upper Spike 3.756 m. bearing 306 °M
11. Connection   to   m. bearing   °M
12. Connection   to   m. bearing   °M
13. Diff. Ht. Trig. Plug is 2.053 m. ~~below~~ Pillar
14. Diff. Ht. SSM is 1.663 m. ~~below~~ Pillar
15. Diff. Ht. Copper Spike is 1.932 m. ~~below~~ Pillar
16. Diff. Ht. Upper Spike is 0.390 m. ~~below~~ Trig. Plug

Prepared by: R. Cubis Checked:

**STATIONS 1972 - ENMORE [P]**

Owners Name: **Campbelltown City Council**  
 (Public Reserve)  
 Address: .....  
 Current Occupant: **(Public Reserve)**  
 Address: .....

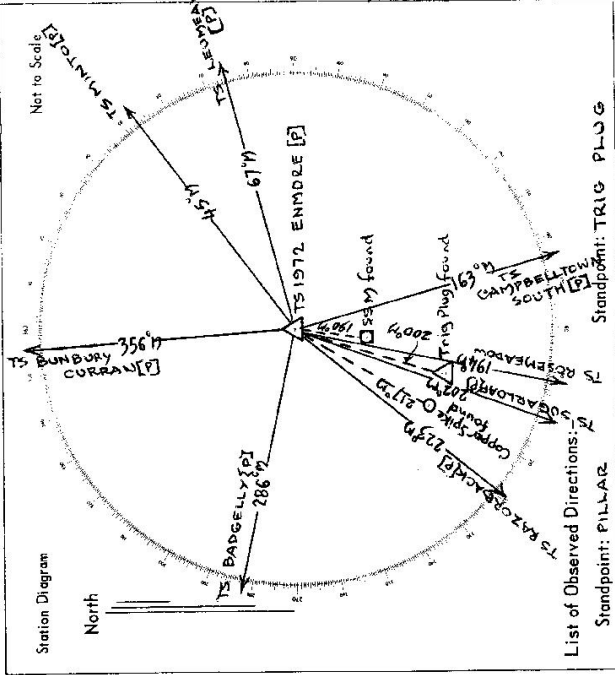
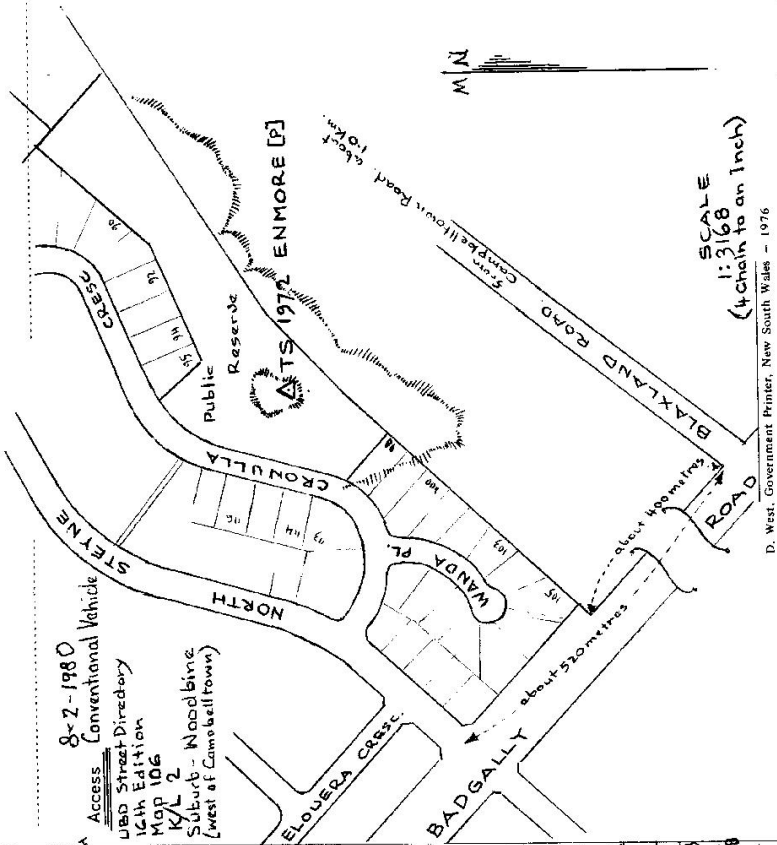

List of Observed Directions:

Station	Direction	Station	Direction
TS BADGELLY [P]	0° 00' 00"	TS BADGELLY [P]	0° 00' 00"
TS MINTO [P]	119° 18' 25"	TS CORNER SPIKE	26° 28' 05.8"
TS LEUMEAM [P]	141° 44' 39"	TS PILLAR	94° 01' 49"
TS CAMPBELLTOWN 3TH [P]	236° 54' 44.4" (unnumbered)	TS CAMPBELLTOWN 3TH [P]	102° 10' 37"
TS (unnumbered)	263° 58' 41.5"	TS MINTO [P]	118° 59' 38.2"

Standpoint: PILLAR

Station	Direction
TS LEUMEAM [P]	141° 20' 18.8"
TS SUGARLOAF [P]	236° 32' 05"
CORNER SPIKE	275° 49' 47.8"

Standpoint: TRIG PLUG

Station	Direction
TS LEUMEAM [P]	141° 20' 18.8"
TS SUGARLOAF 3TH [P]	236° 32' 05"
TS SUGARLOAF [P]	275° 49' 47.8"