

CENTRAL MAPPING AUTHORITY
Department of Lands

Trigonometrical Survey of N.S.W.

RECONNAISSANCE and MAINTENANCE REPORT 1941

STATION EERAMARAN / TS 1941

This Trig. Station has been:-

Note: Cross out word or words which do not apply

1. Completely cleared to permit 360° vision to surrounding Trig.—
2. Cleared by lanes bearing 109° to 165°, 249° to 271°, 363° to 273°, 301° to 320°, from Trig. Mast 333°, 54° to 92°
3. Trig. Mast & Vanes have been painted white & black respectively.
4. The Trig. was unpiled/~~not unpiled~~, dimensions now being:

Description of mark Brass plug in rock, 4 ft should be explicit, e.g. Steel plug, Brass plug, Bolt, C.I. Pipe
 Height of mark 0.04 m ^{above} rock/~~concrete~~ 6 ft
 Height of Top Vanes to Top Mark 3.00 m. Diameter of Vanes (vertical) 0.91 m.
 Height of Cairn 1.6 m. Diameter of Cairn 2.3 m.
 Length of Mast 3.04 m. (approximate if not unpiled)

5. A. C.I. Pipe set in conc/~~rock~~ has been placed 7.65 m. bearing 260°M from Trig. Mast
6. A. set in conc/soil has been placed m. bearing°M from Trig. Mast
7. A. set in conc/soil has been placed m. bearing°M from Trig. Mast
8. A. set in conc/rock has been placed m. bearing°M from Trig. Mast

9. Connection to m. bearing°M
10. Connection to m. bearing°M
11. Connection to m. bearing°M
12. Connection to m. bearing°M
13. Diff. Ht. C.I. Pipe is 0.48 m. ^{above} EERAMARAN T.S.
below
14. Diff. Ht. is m. ^{above}
below
15. Diff. Ht. is m. ^{above}
below
16. Diff. Ht. is m. ^{above}
below

Prepared by: E. Garvin, A.T.S. Checked: Boa, 10.7.75 Noted on U.T.M. Card

Co: BLAXLAND | Ph: EERAMARAN
 Map Sheet: KILPARNEY | No: B132
 Inspected by: E. GARVIN, A.T.S. | Date: 14.4.75
 Authority: INTEGRATION SURVEYS | Field Book:
 Beacon Diagram: Not to Scale

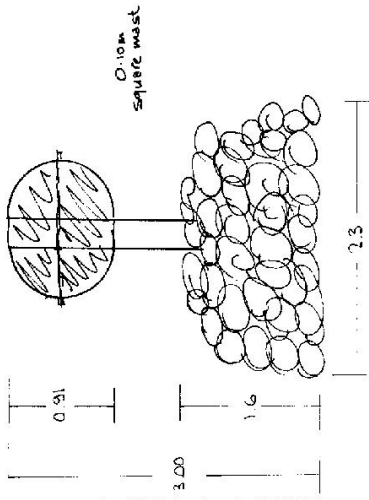

Date	Record of Station

