

Department of Lands
Integration: view of N.S.W.
75 10

RECONNAISSANCE and MAINTENANCE REPORT 1925 STATION EAST HILLS TS-1925

Co: _____ Ph: _____
 Map Sheet: _____ No: _____
 Inspected by: _____ Date: _____
 Authority: _____ Field Book: _____

Note: Cross out word or words which do not apply

This Trig. Station has been:-

1. Completely cleared to permit 360° vision to surrounding Trigs.
2. Cleared by lanes bearing from Trig. Mast

STATION: East Hills Elev. Res. (side) H. 11.2m (H. 11.5m) (H. 11.5m) (H. 11.5m) (H. 11.5m) (H. 11.5m)

To H... (metres) Direction or Vert. Angle Variance Observer Date Dist. in metres at M.S.L. Variance Fact. Observer Date

2 High
Both Jan 1974

Beacon Station
(Depth Lenses)
17.9 m Semic Platform.

All directions Connected to centre
 533
 All Vets corrected ground to ground
 SEE MAP OF CASE FOR REMARKS

14. Diff. Ht. ... is ... m. above / below
 15. Diff. Ht. ... is ... m. above / below
 16. Diff. Ht. ... is ... m. above / below
 Prepared by: _____ Checked: _____

Beacon Diagram

Date	Record of Station

Not to Scale

STATION EAST HILLS TS 1925

Owners Name
 Address
 Current Occupant
 Address

Access

STATION East Hills Elev. Res. (Side)

Remarks

To

Villiers Rd.

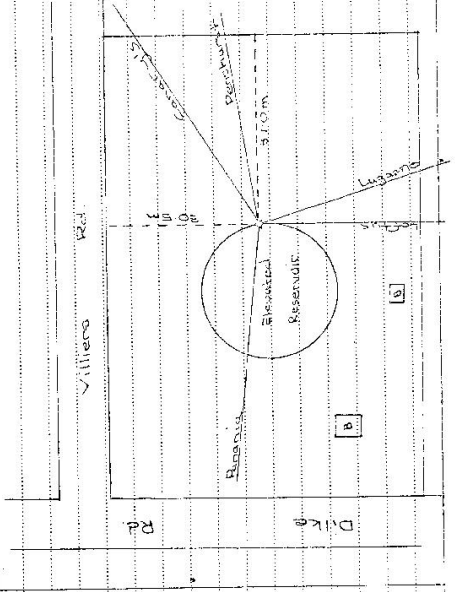

D. West, Government Printer, New South Wales - 1976

Station Diagram

North

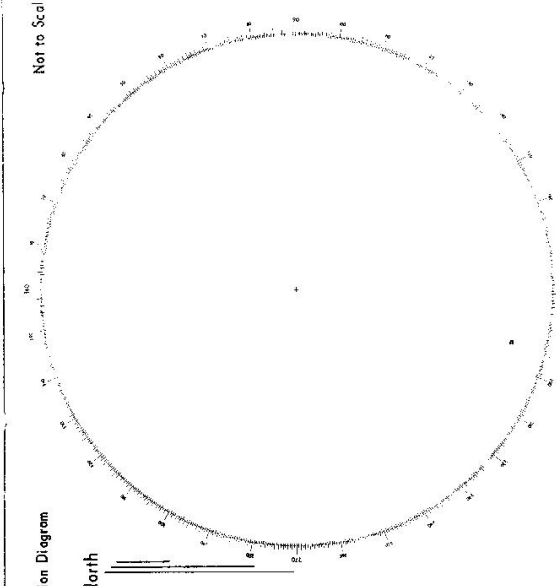

List of Observed Directions:-

Standpoint:

Standpoint:		Station	
Station	Direction	Station	Direction

Standpoint:		Station	
Station	Direction	Station	Direction