

CENTRAL MAPPING AUTHORITY

GEODETIC SURVEY OF N.S.W.
 GEODETIC STATION RECONNAISSANCE and MAINTENANCE REPORT

STATION: **DUNCAN G. S.** No.: **1900**

MAP SHEET
 SCALE 1:250 000 **DORRIGO**

INSPECTED BY: **D. FREDRIKSEN** DATE: **17/9/79**

AUTHORITY: **C.M.A.** FIELD BOOK: **---**

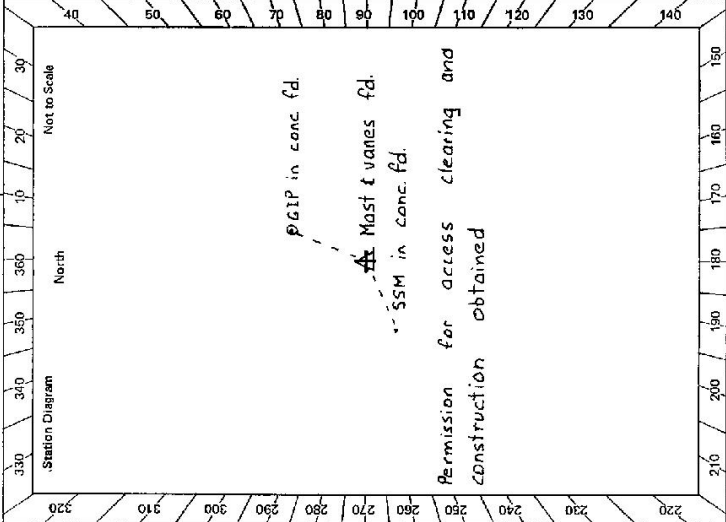

- Description:
- Cleared by lanes bearing **360°** from Trig. Mast
 - Mast & Vanes have been painted white & black respectively.
 - The station/pillar was ~~unpiled~~ **reconstructed** on **17/9/79**, dimensions now being:
 - Description of mark: **---** should be explicit, e.g. S/Steel Pillar Plate, Steel plug, Brass plug, Bolt, G.I. Pipe
 - Height of mark: **---** m. ^{above}/_{below} rock/concrete; Mark is **---** m. ^{above}/_{below} G.L.
 - Height of Top Vanes to Top Mark/Pillar plate: **---** m. Diameter of Vanes (vertical) **---** m.
 - Height of Cairn: **---** m. Diameter of Cairn **---** m. Name Plate found/not found/placed.
 - Length of Mast: **---** m. (approximate if not unpiled)
 - A **S.S.M.** set in conc/rock has been placed/found, bearing **---**° M from Mast/Plug/Pillar
 - A **G.I.P.** set in conc/rock has been placed/found, bearing **---**° M from Mast/Plug/Pillar
 - A set in conc/rock has been placed/found, bearing **---**° M from Mast/Plug/Pillar
 - A set in conc/rock has been placed/found, bearing **---**° M from Mast/Plug/Pillar
 - Action required: **Reconstruct pillar. Construct sets of cones in conc.**

STANDPOINT:

Mark	Direction	Horiz. Distance	Height Difference	Mark	Direction	Horiz. Distance	Height Difference
			above standpt.				above standpt.
			below standpt.				below standpt.
			above standpt.				above standpt.
			below standpt.				below standpt.
			above standpt.				above standpt.
			below standpt.				below standpt.
			above standpt.				above standpt.
			below standpt.				below standpt.
			above standpt.				above standpt.
			below standpt.				below standpt.

Prepared by: **D. Fredriksen** 26/9/79 Checked: **W. Palm** 26/9/79 Noted on U.T.M. Card

27251-2 D. West, Government Printer

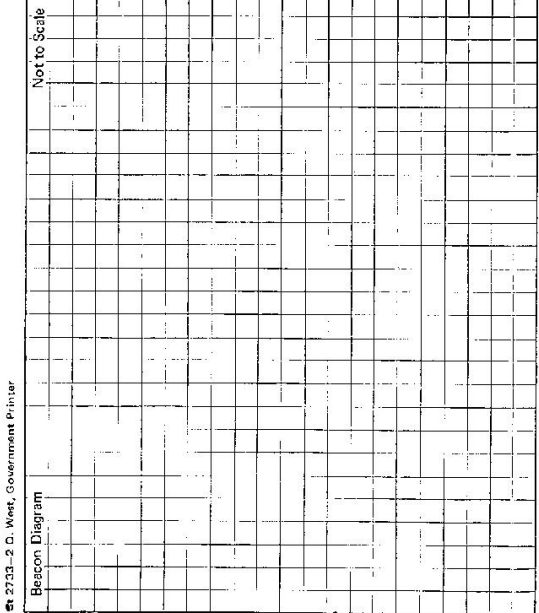

STATION **DUNCAN G.S.** TS **1900**

Owner's Name: **H.H. HERGENEY** Current Occupant:

Address: **"Mount Duncan" (1.5 km)** Address:

Phone: **0800 757543** Phone:

ACCESS 17-9-1979

Access Report of 20/10/1977 was found suitable/unsuitable.

Kms	Feature
0.0	In Guyra on the New England Hwy. Take the Ebor Rd
4.5	Turn LEFT towards "Wards Mistake"
13.3	Conc. bridge
19.2	Pass old homestead on R.H.S.
20.6	Turn LEFT off road at blazed tree on L.H.S. of main road
20.65	(Owner lives a further 0.8 km on L.H.S. of main road)
21.0	Thru wooden gate and follow faint track westward
21.45	Gully crossing, follow track that veers right (keep on track thro 2 boggy sections)
21.65	Thru wooden gate
21.95	End of dozed track
22.5	Veer LEFT keeping to top side of dam, near timber line At fence corner on west side of trig 5 min walk

This section to be completed by officer constructing pillar.

Original station mark found/not found.

Description of mark:

Original beacon found/not found.

Description of beacon:

Height Top of Vane to Top Mark m.

Height of mark m. above G.L. below rock/cone

Diameter of Vane m. Height of Cairn m.

Original Beacon has/has not been destroyed by me.

Note: A new ladder will have to be made to get onto rock (If prefabricated, about 4m long and to be anchored in granite rock at each end)

Date	Record of Station

GEODETTIC SURVEY OF N.S.W.

CENTRAL MAPPING AUTHORITY

GEODETTIC STATION RECONNAISSANCE and MAINTENANCE REPORT

Description:

- 1. Cleared by lanes bearing..... 160° to 240° *Note: Cross out ward or words which do not apply*
..... 270° to 330° from Trig. Mast
- 2. Mast & Vanes have been painted white & black respectively. ✓
- 3. The station/~~marker~~ was unplied/~~replaced~~ on 2.4m x 1.9m x 19 P., dimensions now being:
Description of mark BRASS PLATE ~~could be explicit, e.g., S/Steel Pillar Plate, Steel plug, Brass plug, Bolt, G.I. Pipe~~
- Height of mark..... 0.110 m. ^{above} ~~rock~~/_{concrete}. Mark is BRASS m. ^{above} ~~rock~~/_{concrete}. with rock
Height of Top Vanes to Top Mark ~~.....~~ 2.410 m. Diameter of Vanes (vertical) 0.095 m.
- Height of Cairn..... m. Diameter of Cairn..... m. Name Plate found/not found/placed.
Length of Mast 2.410 m. (approximate if not unplied)
- 4. A..... S.S. M..... set in ~~rock~~/_{rock} has been ~~placed~~/_{found}, bearing..... 262° M from ~~rock~~/_{rock} Plug/~~marker~~
- 5. A..... G.I. Pipe..... set in ~~rock~~/_{rock} has been ~~placed~~/_{found}, bearing..... 10° M from ~~rock~~/_{rock} Plug/~~marker~~
- 6. A..... NOIL HOLE..... set in ~~rock~~/_{rock} has been ~~placed~~/_{found}, bearing..... 06° M from ~~rock~~/_{rock} Plug/~~marker~~
- 7. A..... set in conc./rock has been placed/_{found}, bearing..... ° M from Mast/Plug/Pillar
- 8. Action required:.....

STANDPOINT: BRASS PLATE		STANDPOINT: G.I. PIPE IN ROCK	
Mark	Direction	Horiz. Distance	Height Difference
CHAMBERLAIN BR (O)	0 00 00		above standpt.
S.S. M IN ROCK	24 00 26	1.401	above standpt.
G.I. PIPE	10 10 26	1.880	above standpt.
MITCHELL BR	30 30 26		above standpt.
HOUDEGAN BR (O)	20 00 26		above standpt.
NOIL HOLE IN ROCK	23 00 26	1.937	above standpt.

Prepared by: Flora 27th September 2022
Checked: Flora

S-2733-1

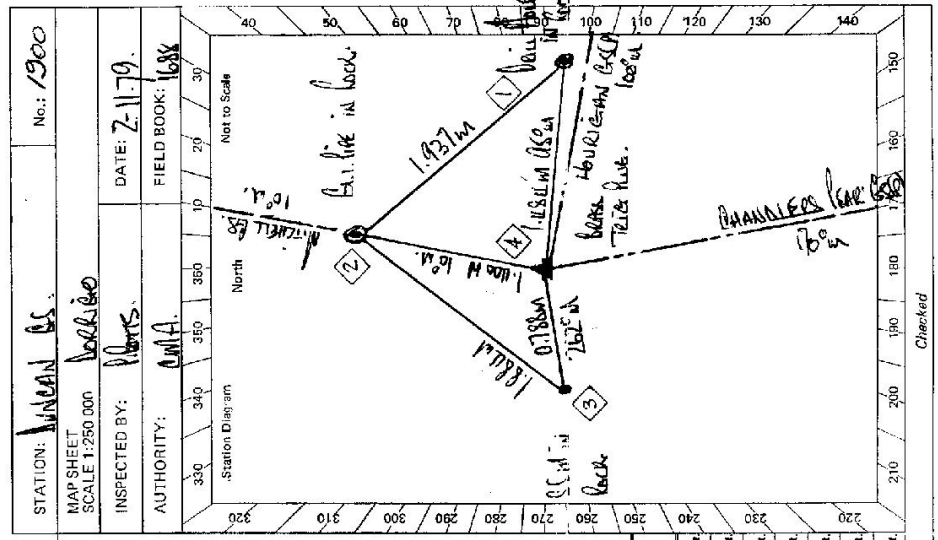

STATION: WINDAN BR No.: 1300
MAP SHEET SCALE: 1:250,000
INSPECTED BY: Flora DATE: 2-11-19
AUTHORITY: OMFA FIELD BOOK: 1688

STATION MULLAN CR. TS - 1900

Owner's Name:
 Address:
 Phone:
 Current Occupant:
 Address:
 Phone:
 Access Report of 2.11/11/19 was found suitable/unsuitable.
 ACCESS

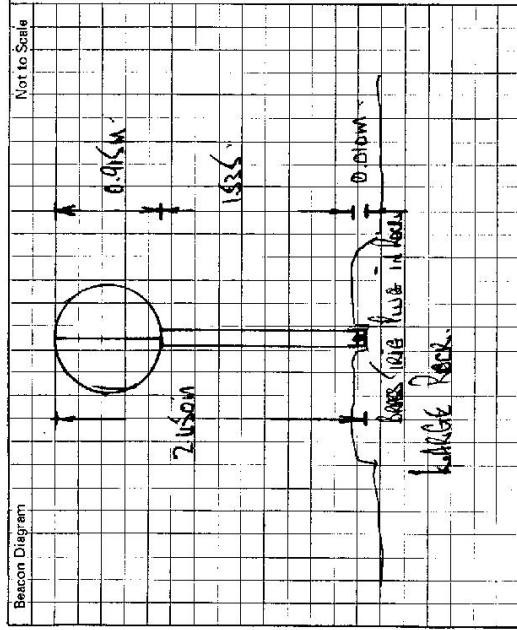

This section to be completed by officer constructing pillar.

Original station mark found/not found.
 Description of mark:
 Original beacon found/not found.
 Description of beacon:
 Height Top of Vanes to Top Mark m.
 Height of mark m. above G.L.
 m. below
 Diameter of Vanes m. Height of Cairn m.
 Original Beacon has/has not been destroyed by me.

Date	Record of Station

GEODETTIC SURVEY OF N.S.W.

CENTRAL MAPPING AUTHORITY

GEODETTIC STATION RECONNAISSANCE and MAINTENANCE REPORT

STATION: **BUNLAN G.S.C.** No.: **TS 1900**

MAP SHEET SCALE 1:250 000

INSPECTED BY: **P. BERS** DATE: **7th Nov 79**

AUTHORITY: **C.M.A.** FIELD BOOK: **1188**

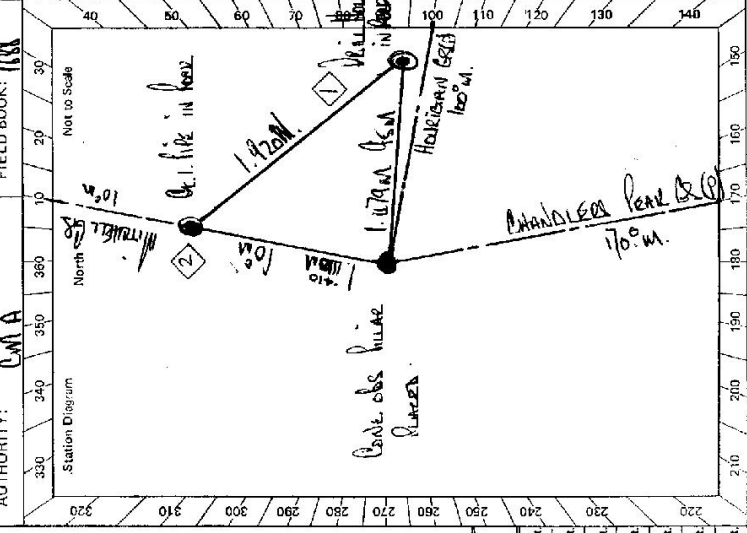

- Description:
- Cleared by lanes bearing **165° W to 240° W**, **270° W to 138° W**, dimensions now being **16.5m** by **2.4m**, **2.7m** by **1.38m**.
 - Mast & Vanes have been painted white & black respectively. ✓
 - The **SS.M. in Rose** pillar was **DESTROYED**/constructed on **1.920m**, dimensions now being **1.920m**.
 - Description of mark **CONC. OBS. PILLAR** should be explicit, e.g., S/Steel Pillar Plate, Steel plug, Brass plug, Bolt, G.I. Pipe
 - Height of mark **1.370** m. above **CONC. PILLAR**. Mark is **CONC.** Diameter of Vanes (vertical) **0.150** m.
 - Height of Top Vanes to Top **CONC.** Pillar plate **1.105** m. Diameter of Cairn **0.150** m. Name Plate **CONC.** placed.
 - Length of Mast **1.920** m. (approximate if not unplied)
 - A **G.I. PIPE** set in **CONC.**/rock has been **PLACED**/found, bearing **165° W** from **CONC. PILLAR**.
 - A **MIRRELL BR.** set in **CONC.**/rock has been **PLACED**/found, bearing **95° W** from **CONC. PILLAR**.
 - A **HOURIGAN BR.** set in **CONC.**/rock has been **PLACED**/found, bearing **289° 16' 30"** from **Mast/Plug/Pillar**.
 - A **WELL HOSE** set in **CONC.**/rock has been **PLACED**/found, bearing **287° 38' 15"** from **Mast/Plug/Pillar**.
 - Action required: **CONC. OBS. PILLAR**

STANDPOINT: **G. I. PIPE**

Mark	Direction	Horz. Distance	Height Difference	Mark	Direction	Horz. Distance	Height Difference
CONC. OBS. PILLAR	0 00 00		above 1.720 standpt.	CONC. OBS. PILLAR	0 00 00		above 1.720 standpt.
SS.M. in Rose	DESTROYED		above 1.720 standpt.	MIRRELL BR.	24 01 24	1.141	below 1.720 standpt.
MIRRELL BR.	202 34 30		below 1.720 standpt.	HOURIGAN BR.	289 16 30		below 1.720 standpt.
G. I. PIPE	204 05 10	1.110	below 1.720 standpt.	WELL HOSE	287 38 15	1.970	below 1.720 standpt.
HOURIGAN BR.	289 16 30		below 1.720 standpt.				
WELL HOSE	287 38 15	1.179	below 1.720 standpt.				

Prepared by: **P. BERS** 27th November 1979
 Noted on U.T.M. Card
 S: 2733-1

Checked

STATION DUNOAN G.S. (P) TS 1900

Owner's Name: N.H. HEARNEY Current Occupant:
 Address: MOUNT AUNGAN Address:
 Phone: 0800 795173 Phone:

ACCESS
 Access Report of 7.11.1971 was found suitable/unsuitable. BY LWS ONLY.
14.1 KEARSE
0.00. AT NEW ENGLAND HIGHWAY BUYER TAKE EBER ROAD
11.50 TURN LEFT TOWARDS WARRS MISTAKE
13.30 CONCRETE BRIDGE
19.20 PASS OLD HOMESTEAD ON LHS.
20.60 TURN LEFT OFF ROAD AT OLD BLAZE ON TREE.
20.66 BANKER LINES OBEY FURTHER DOWN SEALED ROAD
21.00 THROUGH WOODEN GATE AND FOLLOW FIRST TRACK WESTWARD
21.15 FULLY CROSSING - FOLLOW TRACK THAT USES RIGID
21.60 WOODEN GATE.
22.20 TURN LEFT AT BUNKLE ON TREE AND FOLLOW
BLIND TRACK TO TRIG
GEODETIC STATION DUNOAN.

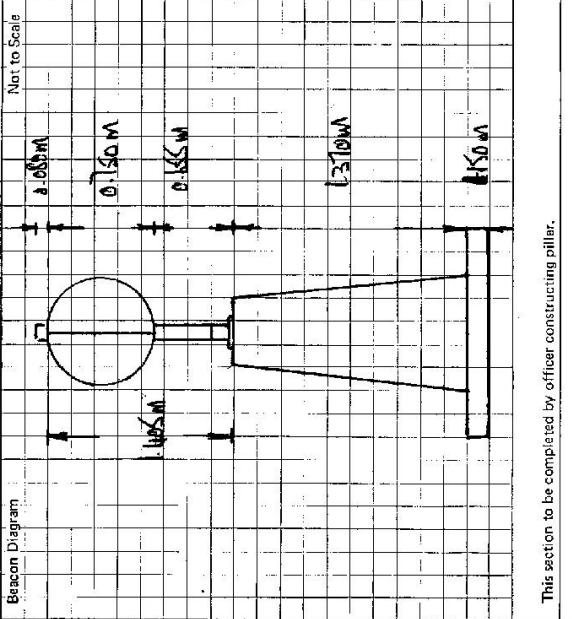

This section to be completed by officer constructing pillar.
 Original station mark found/not found.
 Description of mark:
 Original beacon found/not found.
 Description of beacon:
 Height Top of Vanes to Top Mark:m.
 Height of mark:m. above rock/concm. below G.L.
 Diameter of Vanesm. Height of Cairnm.
 Original Beacon has/has not been destroyed by me.

Date	Record of Station