

CENTRAL MAPPING AUTHORITY

GEODETIC STATION RECONNAISSANCE and MAINTENANCE REPORT

STATION: DARLING No.: 1785

MAP SHEET SCALE 1:250 000 REDAN 7233

INSPECTED BY: R Lander, A Paterson DATE: 29-3-79

AUTHORITY: C.M.A. FIELD BOOK: AB 1741

Description: *Note: Cross out word or words which do not apply*

1. Cleared by lanes bearing  $322^{\circ} - 330^{\circ}$  M,  $14^{\circ} - 126^{\circ}$  M,  $176^{\circ} - 300^{\circ}$  M ✓ from Trig. Mast
2. Mast & Vanes have been painted white & black respectively.
3. The station/pillar was ~~unplaced~~/not unplaced/respectively on 29th March 1979, dimensions now being:
  - Description of mark.....should be explicit, e.g., S/Steel Pillar Plate, Steel plug, Brass plug, Bolt, G.I. Pipe
  - Height of mark.....m. <sup>above</sup> rock/concrete; Mark is.....m. <sup>above</sup> G.L.  $0.93 \times 1.02$  ✓
  - Height of Top Vanes to Top Mark/Pillar plate.....m. Diameter of Vanes (vertical).....m. *see over*
  - Height of Cairn.....m. ✓ Diameter of Cairn  $2.5$  m. ✓ Name Plate ~~found~~/not found/~~placed~~.
  - Length of Mast.....m. ✓ (approximate if not unplaced)
4. A. Star Picket.....set in conc/rock has been placed/found, bearing  $18.0$  M. M from Mast/~~Plug/Pillar~~
5. A. Star Picket.....set in conc/rock has been placed/found, bearing  $257.0$  M from Mast/~~Plug/Pillar~~
6. A. Star Picket.....set in conc/rock has been placed/found, bearing  $322.0$  M from Mast/~~Plug/Pillar~~
7. A.....set in conc/rock has been ~~found~~, bearing..... M from Mast/~~Plug/Pillar~~
8. Action required:.....

STANDPOINT:

STANDPOINT:

Mark	Direction	Horiz. Distance	Height Difference	Mark	Direction	Horiz. Distance	Height Difference
			above standpt.				above standpt.
			below standpt.				below standpt.
			above standpt.				above standpt.
			below standpt.				below standpt.
			above standpt.				above standpt.
			below standpt.				below standpt.
			above standpt.				above standpt.
			below standpt.				below standpt.

Prepared by: A. Paterson, ATS Checked: *AW* 28/9/79. Noted on U.T.M. Card

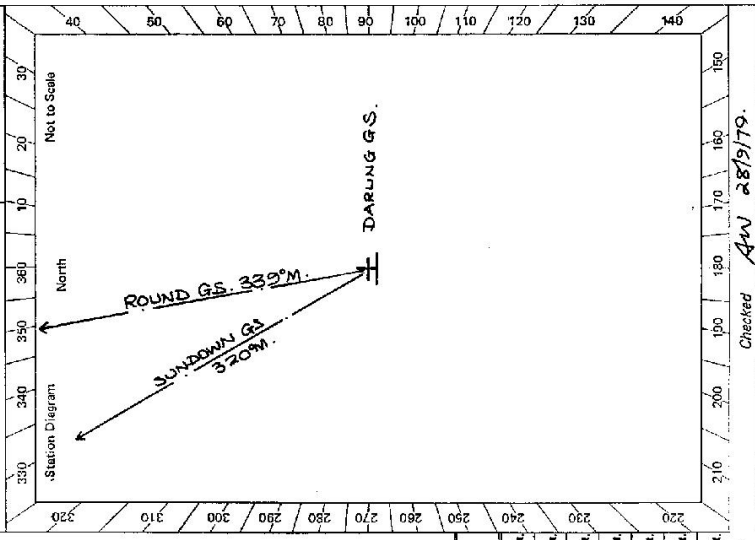

Sr 2733-2 D. West, Government Printer

STATION **DARLING** TS 1785

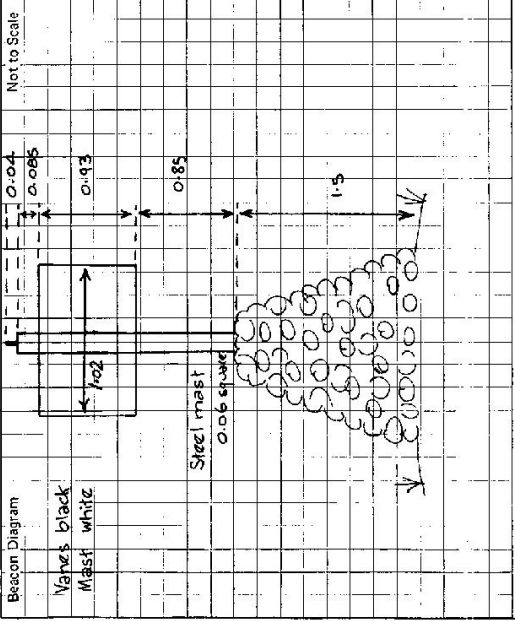

Owner's Name **C. Bright**  
 Address: **"Thornedale" station**  
**Via Broken Hill**  
 Phone: **881403**

Current Occupant: .....  
 Address: .....  
 Phone: .....

**ACCESS**  
 Access Report of 29/3/1977 was found suitable/unusable.

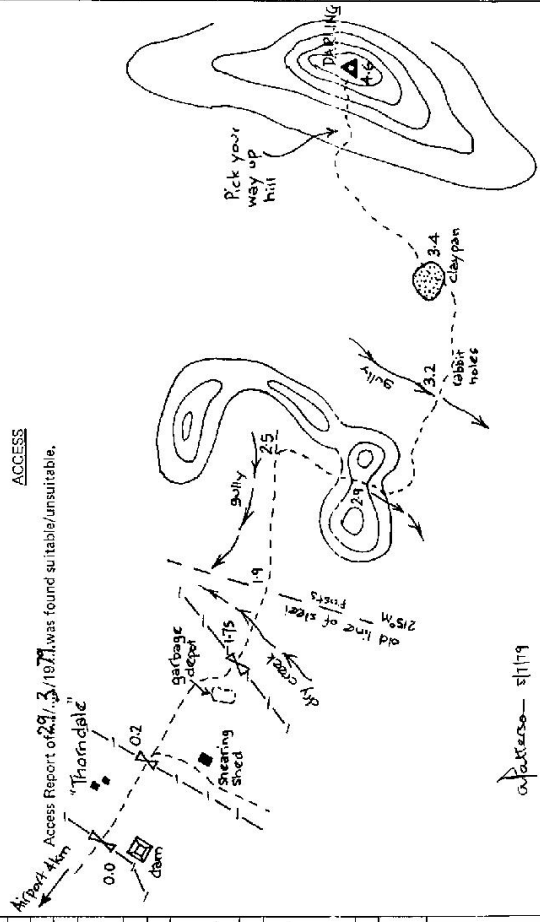

*W. G. ...*

This section to be completed by officer constructing pillar.

Original station mark found/not found.

Description of mark: .....

Original beacon found/not found.

Description of beacon: .....

Height Top of Vane to Top Mark ..... m.

Height of mark ..... m. above below rock/conc ..... m. above below G.L.

Diameter of Vanes ..... m. Height of Cairn ..... m.

Original Beacon has/has not been destroyed by me.

Date	Record of Station

CENTRAL MAPPING AUTHORITY

GEODETIC SURVEY OF N.S.W.

GEODETIC STATION RECONNAISSANCE and MAINTENANCE REPORT

STATION: DARLING No.: 1785

Description: Note: Cross out word or words which do not apply

MAP SHEET SCALE 1:250,000 PERTH/DEK

1. Cleared by lanes bearing..... from Trig. Mast

INSPECTED BY: C.M.A. DATE: MAY 1979

2. Mast & Vanes have been painted white & black respectively.

AUTHORITY:

3. The station/pillar was unpiled/not unpiled/constructed on..... dimensions now being:

FIELD BOOK:

Description of mark..... should be explicit, e.g., S/Steel Pillar Plate, Steel plug, Brass plug, Bolt, G.I. Pipe

330 340 350 360 370 380 390 400

Height of mark.....m. <sup>above</sup> rock/concrete; Mark is.....m. <sup>above</sup> <sub>below</sub> G.L.

20 30 40 50 60 70 80 90 100 110 120 130 140

Height of Top Vanes to Top Mark/Pillar plate.....m. Diameter of Vanes (vertical).....m.

220 230 240 250 260 270 280 290 300 310 320

Height of Cairn.....m. Diameter of Cairn.....m. Name Plate found/not found/placed.

150 160 170 180 190 200 210 220

Length of Mast.....m. (approximate if not unpiled)

230 240 250 260 270 280 290 300 310 320

4. A.....set in conc/rock has been placed/found, bearing.....° M from Mast/Plug/Pillar

240 250 260 270 280 290 300 310 320

5. A.....set in conc/rock has been placed/found, bearing.....° M from Mast/Plug/Pillar

250 260 270 280 290 300 310 320

6. A.....set in conc/rock has been placed/found, bearing.....° M from Mast/Plug/Pillar

260 270 280 290 300 310 320

7. A.....set in conc/rock has been placed/found, bearing.....° M from Mast/Plug/Pillar

270 280 290 300 310 320

8. Action required:.....

280 290 300 310 320

STANDPOINT:

290 300 310 320

Mark Direction Horiz. Distance Height Difference

300 310 320

above standpt. below standpt. above standpt. below standpt.

310 320

above standpt. below standpt. above standpt. below standpt.

320

above standpt. below standpt. above standpt. below standpt.

330

above standpt. below standpt. above standpt. below standpt.

340

above standpt. below standpt. above standpt. below standpt.

350

above standpt. below standpt. above standpt. below standpt.

360

above standpt. below standpt. above standpt. below standpt.

370

above standpt. below standpt. above standpt. below standpt.

380

above standpt. below standpt. above standpt. below standpt.

390

above standpt. below standpt. above standpt. below standpt.

400

above standpt. below standpt. above standpt. below standpt.

410

above standpt. below standpt. above standpt. below standpt.

420

above standpt. below standpt. above standpt. below standpt.

430

above standpt. below standpt. above standpt. below standpt.

440

above standpt. below standpt. above standpt. below standpt.

450

above standpt. below standpt. above standpt. below standpt.

460

above standpt. below standpt. above standpt. below standpt.

470

above standpt. below standpt. above standpt. below standpt.

480

above standpt. below standpt. above standpt. below standpt.

490

above standpt. below standpt. above standpt. below standpt.

500

above standpt. below standpt. above standpt. below standpt.

510

above standpt. below standpt. above standpt. below standpt.

520

above standpt. below standpt. above standpt. below standpt.

530

above standpt. below standpt. above standpt. below standpt.

540

above standpt. below standpt. above standpt. below standpt.

550

above standpt. below standpt. above standpt. below standpt.

560

above standpt. below standpt. above standpt. below standpt.

570

above standpt. below standpt. above standpt. below standpt.

580

Checked

Noted on U.T.M. Card

Checked:

Prepared by:

St 2723-1

57 of 2 cases

GEODETTIC SURVEY OF N.S.W.

CENTRAL MAPPING AUTHORITY

GEODETTIC STATION RECONNAISSANCE and MAINTENANCE REPORT

STATION: *DARLING G.S.* No.: *1785*

MAP SHEET SCALE *1:100,000* RECAN *1:100,000*

INSPECTED BY: *P.B.P.* DATE: *22/11/89*

AUTHORITY: *Land Information CENTRE* FIELD BOOK: *1964*

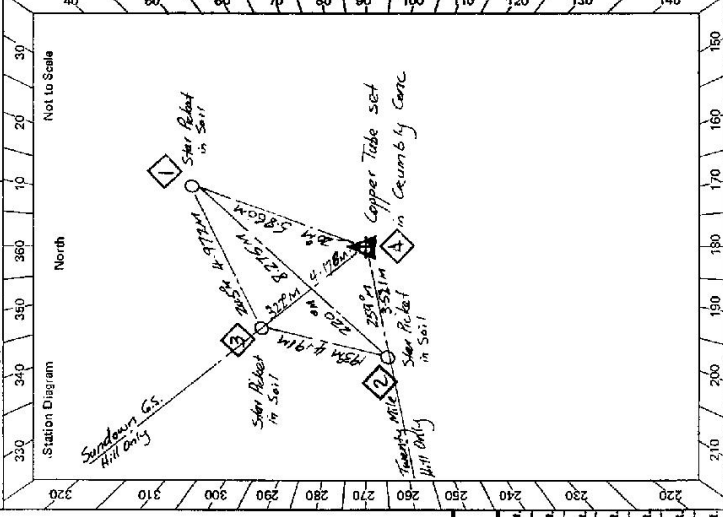

- Description:
- Cleared by lanes bearing  $178^{\circ} 25' 30''$  -  $325^{\circ} 35' 57''$   $18^{\circ} 31' 36''$  -  $65^{\circ}$  from Trig. Mast tower compound  $65^{\circ} 17'$  -  $126^{\circ}$ ;  $148^{\circ}$  -  $150^{\circ}$  TOWER ELEVATION  $50$ . Vanes have been painted ~~white~~ black ~~recessed~~.
  - The station/ ~~marker~~ was unpiled/ ~~recessed~~ on ~~top~~ ~~of~~ ~~the~~ ~~ground~~ ~~at~~ ~~1989~~, dimensions now being: Description of mark *Copper Tube* should be explicit, e.g., S/Steel Pillar Plate, Steel plug, Brass plug, Bolt, G.I. Pipe
  - Height of mark  $2.030$  m. above ~~rock~~ ~~concrete~~; Mark is ~~above~~ ~~below~~ G.L.
  - Height of Top Vanes to Top Mark ~~3.252~~ m. Diameter of Vanes (vertical)  $0.977$  m.
  - Height of Cairn  $1.500$  m. Diameter of Cairn  $0.900$  m. Name Plate found/not found/placed.
  - Length of Mast  $3.280$  m. (approximate if not unpiled)
  - A. *Star Picket* set in ~~conc~~ ~~mark~~ has been ~~placed~~ ~~found~~, bearing  $252.3^{\circ}$  M from ~~Mast/Plug/Pillar~~  $3.518$  m
  - A. *Star Picket* set in ~~conc~~ ~~mark~~ has been ~~placed~~ ~~found~~, bearing  $222^{\circ}$  M from ~~Mast/Plug/Pillar~~  $4.175$  m
  - A. *Star Picket* set in ~~conc~~ ~~mark~~ has been ~~placed~~ ~~found~~, bearing  $20^{\circ}$  M from ~~Mast/Plug/Pillar~~  $5.858$  m
  - A. ~~set in conc/rock has been placed/~~ found, bearing  $20^{\circ}$  M from ~~Mast/Plug/Pillar~~
- Action required: *Place new satellite marks. Connection and while cairn steel posts comes in good would be possible to place a concrete pillar at this station.*

STANDPOINT: *Star Picket (2)*

Mark	Direction	Horiz. Distance	Height Difference	Mark	Direction	Horiz. Distance	Height Difference
<i>Rd. G.I. Vanes</i>	<i>0 00 00</i>		above standpt.				above standpt.
<i>Star Picket (3)</i>	<i>41 11 35</i>	<i>4.191</i>	above standpt.				above standpt.
<i>Star Picket (1)</i>	<i>69 06 20</i>	<i>8.272</i>	below standpt.				below standpt.
<i>1/2" Copper Tube 7816 Rev</i>	<i>66 08 40</i>	<i>3.522</i>	below standpt.				below standpt.
<i>G.I. Nail (2)</i>	<i>106 08 30</i>	<i>1.159</i>	below standpt.				below standpt.

Prepared by: *P.B.P.* ~~20/12/1989~~ *22/11/89* Checked: *P.B.P.* ~~20/12/1989~~ *22/11/89* Noted on U.T.M. Card

GS 24

STATION DARLING G.S. TS-1785

Owner's Name: Mr. C. Reiger  
 Address: "Thorndale Station"  
1/4 Broken Hill  
 Phone: 88 1403

LEASER  
 Address: "Thorndale Station"  
1/4 Broken Hill  
 Phone: 88 1403

ACCESS  
 Access Report of 11/10/88 was found suitable/unavailable.

4ms Access  
Feature  
 1.1 Best office Broken Hill head up hill towards railway station  
 0.15 Turn right Copral Street.  
 2.20 Road bridge over railway line  
 2.60 Bus road to railway turn on right  
 3.10 Straight ahead through roundabout  
 4.55 Straight ahead  
 4.63 Under Broken Hill Airport sign  
 5.46 Turn left onto dirt road just before Airport  
 5.61 Bus track on left  
 6.15 Bus track on right  
 6.72 Bus track on left  
 9.24 Gully Crossing  
 9.42 Iron gate - "Thorndale" on gate  
 9.57 Turn right onto track; go straight ahead to gate, owner lives in house up hill on left.  
 9.70 Iron gate - follow track  
 11.07 Take track on left between trees old rubbish on right  
 11.17 longer - follow faint track - Gal tank on right.  
 11.29 Gully Crossing  
 11.34 Through old gateway - 100' left on faint track.  
 11.85 Gully crossing head 162' to foot of rocky knob  
 11.99 Faint track crosses over saddle at left end of rocky knob  
 12.00 At saddle head no rocky knob - line of steel post  
 12.65 At top of rocky knob - head down to gully  
 12.81 Gully Crossing - from here go slightly left around steel post - pick way to top  
 B. de Darling G.S.

ACCESS TIME  
 35 MINUTES  
 FROM BROKEN HILL

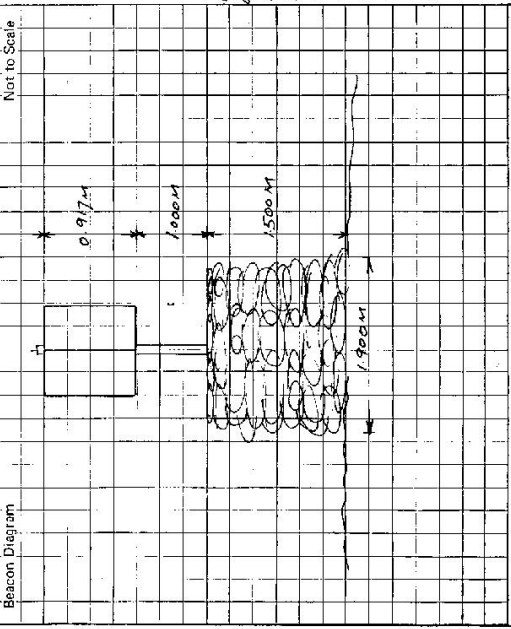

This section to be completed by officer constructing pillar.

Original station mark found/~~not found~~.

Description of mark: Copper Tube

Original beacon found/~~not found~~.

Description of beacon: Chain Rod & Disc

Height Top of Vanes to Top Mark: 3.252 m above G.L.

Height of mark: 2.056 m above 1.196 m below G.L.

Diameter of Vanes: 0.917 m. Height of Cairn: 1.500 m.

Original Beacon ~~has~~ been destroyed by me.

200 of 2 CARDS

GEODETTIC SURVEY OF NSW

CENTRAL MAPPING AUTHORITY

GEODETTIC STATION RECONNAISSANCE and MAINTENANCE REPORT

STATION: DARLING G.S. No.: 1785

MAP SHEETS SCALE 1:250 000

Description: Note: Cross out word or words which do not apply

INSPECTED BY: P. Potts DATE: 23/3/90

1. Cleared by lanes bearing..... from Trig. Mast

AUTHORITY: LAND INFORMATION CENTRE FIELD BOOK: C 605

2. Mast & Vanes have been painted white & black respectively.

Station Diagram

3. The station/pillar was unpiled/not unpiled/constructed on.....19....., dimensions now being:

Station Diagram

Description of mark..... should be explicit, e.g., S/Steel Pillar Plate, Steel plug, Brass plug, Bolt, G.I. Pipe

Station Diagram

Height of mark.....m..... above below rock/concrete; Mark is.....m..... above below G.L.

Station Diagram

Height of Top Vanes to Top Mark/Pillar plate.....m..... Diameter of Vanes (vertical).....m.

Station Diagram

Height of Cairn.....m..... Diameter of Cairn.....m..... Name Plate found/not found/placed.

Station Diagram

Length of Mast.....m..... (approximate if not unpiled)

Station Diagram

4. A..... set in conc/rock has been placed/found, bearing.....°M from Mast/Plug/Pillar

Station Diagram

5. A..... set in conc/rock has been placed/found, bearing.....°M from Mast/Plug/Pillar

Station Diagram

6. A..... set in conc/rock has been placed/found, bearing.....°M from Mast/Plug/Pillar

Station Diagram

7. A..... set in conc/rock has been placed/found, bearing.....°M from Mast/Plug/Pillar

Station Diagram

8. Action required.....

Station Diagram

STANDPOINT: 1/2 CONCRETE TRIG PLUG

Station Diagram

STANDPOINT: STAR PICKET (1)

Station Diagram

Table with columns: Mark, Direction, Horiz. Distance, Height Difference, Mark, Direction, Horiz. Distance, Height Difference

Station Diagram

Prepared by: P. Potts 28/3/90

Station Diagram

Checked by: Noted on U.I.M. Card

Station Diagram

Checked by:

Station Diagram

Checked by:

Station Diagram

Checked by:

Station Diagram

Checked by:

Station Diagram

Checked by:

Station Diagram

Checked by:

Station Diagram

Checked by:

Station Diagram

Checked by:

Station Diagram

Checked by:

Station Diagram

Checked by:

Station Diagram

Checked by:

Station Diagram

Checked by:

Station Diagram

Checked by:

Station Diagram

Checked by:

Station Diagram

Checked by:

Station Diagram

Checked by:

Station Diagram

Checked by:

Station Diagram

Checked by:

Station Diagram

Checked by:

Station Diagram

Checked by:

Station Diagram

Checked by:

Station Diagram

Checked by:

Station Diagram

Checked by:

Station Diagram

Checked by:

ST of 1785

GEODETTIC SURVEY OF ALSW.

CENTRAL MAPPING AUTHORITY

GEODETTIC STATION RECONNAISSANCE and MAINTENANCE REPORT

STATION: DARLING G.S.P. No.: 1785

MAP SHEETS SCALE 1:250 000

INSPECTED BY: P.BYTE DATE: 28/3/90

AUTHORITY: LAND INFORMATION CENTRE FIELD BOOK: 605

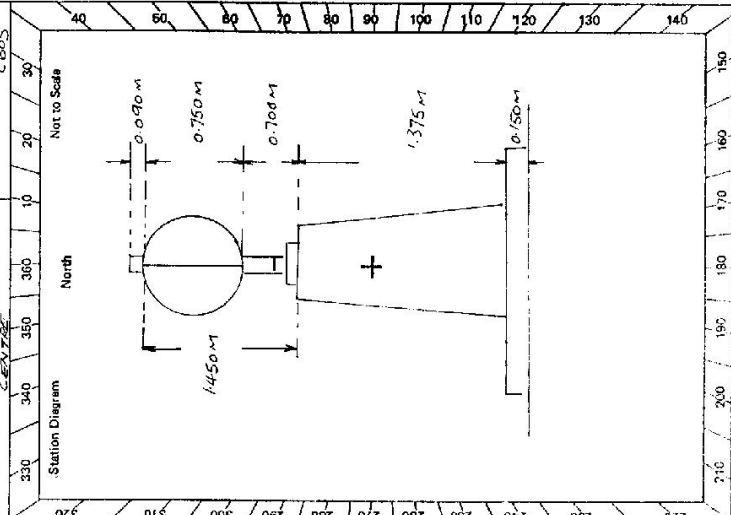

- Description:
- Cleared by lanes bearing  $117^{\circ} 26'$ ,  $220^{\circ} 25'$ ,  $357^{\circ} 43'$ ,  $60^{\circ} 57'$ ,  $77^{\circ} 12'$ ,  $148^{\circ} 15'$  from Trig. Mast tower & Vanes have been painted white & black respectively. 70-100 ELEVATION 50°
  - The station/pillar was ~~replaced~~ constructed on ~~27.4m~~  $19.9\%$  m., dimensions now being:  $54$   $1.375$  m. above ~~below~~ rock/concrete; Mark is  $1.575$  m. above below G.L.
  - Description of mark: ~~should be explicit, e.g., S/Steel Pillar Plate, Steel plug, Brass plug, Bolt, G.I. Pipe~~
  - Height of mark:  $1.375$  m. above ~~below~~ rock/concrete; Mark is  $1.575$  m. above below G.L.
  - Height of Top Vanes to Top Mark/Pillar plate  $1.450$  m. Diameter of Vanes (vertical)  $2.750$  m.
  - Height of Cairn:  $1.375$  m. Diameter of Cairn  $1.450$  m. Name Plate ~~found~~/not ~~found~~/placed.
  - Length of Mast:  $1.375$  m. (approximate if not unpiled)
  - A. ~~STAR PEG (S)~~ set in ~~conc/rock~~ <sup>Soil</sup> has been ~~placed~~/found, bearing  $18^{\circ}$  M from Mast/Plug/Pillar
  - A. ~~STAR PEG (S)~~ set in ~~conc/rock~~ <sup>Soil</sup> has been ~~placed~~/found, bearing  $258^{\circ}$  M from Mast/Plug/Pillar
  - A. ~~STAR PEG (S)~~ set in ~~conc/rock~~ <sup>Soil</sup> has been ~~placed~~/found, bearing  $327^{\circ}$  M from Mast/Plug/Pillar
  - A. ~~STAR PEG (S)~~ set in ~~conc/rock~~ has been ~~placed~~/found, bearing  $327^{\circ}$  M from Mast/Plug/Pillar
  - Action required: ~~REPLACEMENT OF NAME PLATE~~

STANDPOINT:		STANDPOINT:		STANDPOINT:	
Mark	Direction	Horiz. Distance	Height Difference	Mark	Direction
			above standpt.		above standpt.
			below standpt.		below standpt.
			above standpt.		above standpt.
			below standpt.		below standpt.
			above standpt.		above standpt.
			below standpt.		below standpt.
			above standpt.		above standpt.
			below standpt.		below standpt.
			above standpt.		above standpt.
			below standpt.		below standpt.

Prepared by: P.BYTE 28/3/90  
 Checked: *[Signature]*  
 Noted on U.T.M. Card

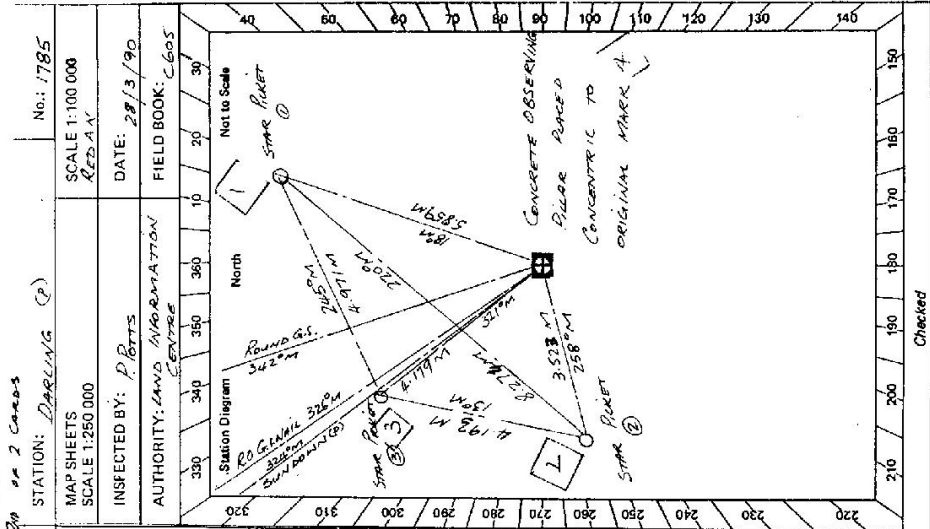

**STATION: DARLING (P)**  
**MAP SHEETS SCALE 1:250 000**  
**INSPECTED BY: P. BRITS**  
**DATE: 28/3/90**  
**AUTHORITY: LAND INFORMATION CENTRE**  
**FIELD BOOK: C605**  
**No.: 1785**

**STATION: DARLING (P)**  
**MAP SHEETS SCALE 1:250 000**  
**INSPECTED BY: P. BRITS**  
**DATE: 28/3/90**  
**AUTHORITY: LAND INFORMATION CENTRE**  
**FIELD BOOK: C605**

**STATION: DARLING (P)**  
**MAP SHEETS SCALE 1:250 000**  
**INSPECTED BY: P. BRITS**  
**DATE: 28/3/90**  
**AUTHORITY: LAND INFORMATION CENTRE**  
**FIELD BOOK: C605**

STANDPOINT: CONCRETE OBSERVING PILLAR			
Mark	Direction	Horiz. Distance	Height Difference
RO G.N. NAIL IN TREE	0 00 00		above standpt.
STAR PICKET 1	51 01 50	5.859	below standpt.
G.N. NAIL 1	51 01 20	3.790	above standpt.
STAR PICKET 2	289 17 00	3.523	above standpt.
G.N. NAIL 2	289 17 00	2.263	above standpt.
STAR PICKET 3	354 34 50	4.179	below standpt.
SUNDDOWN (P)	354 32 40		above standpt.
ROUND G.S.	12 33 30		below standpt.
STANDPOINT: STAR PICKET 1			
Mark	Direction	Horiz. Distance	Height Difference
RO G.N. NAIL IN TREE	0 00 00		above standpt.
CONCRETE OBS. PILLAR	235 32 20	5.859	below standpt.
G.N. NAIL 1	235 32 20	2.067	above standpt.
STAR PICKET 2	256 46 10	8.272	above standpt.
STAR PICKET 3	280 00 20	4.971	above standpt.
SUNDDOWN (P)	359 02 20		below standpt.
ROUND G.S.			below standpt.
STANDPOINT: STAR PICKET 2			
Mark	Direction	Horiz. Distance	Height Difference
RO G.N. NAIL IN TREE	0 00 00		above standpt.
STAR PICKET 1	41 11 20	4.193	above standpt.
STAR PICKET 3	69 05 20	8.277	below standpt.
CONCRETE OBS. PILLAR	106 08 20	3.523	below standpt.
G.N. NAIL 2	186 03 20	2.260	above standpt.
SUNDDOWN (P)	357 23 20		below standpt.

Prepared by: P. BRITS 28/3/90  
 Checked: P. BRITS 28/3/90  
 Noted on U.T.M. Card



Department of Lands

Central Mapping Authority

Trigonometrical Survey of N.S.W.

RECONNAISSANCE and MAINTENANCE REPORT on DARLING TS 1785 TRIG. STATION

Parish BOLINGRA County YANCESSA Map Sheet MEUNDEE No. 51443

Inspected by D.A.K. Minced Date of Inspection 25th October 1960

This Trig. Station has been:-

Note: Cross out word or words which do not apply

1. ~~Completely cleared to permit 360° vision to surrounding Trigs.~~
2. Cleared by lanes bearing ..... from Trig. Mast
3. The Trig. was ~~unpiled~~/not unpiled. dimensions now being:
 

Original Trig. Plug was <del>found</del> / <sup>not</sup> found ✓	Mast (Round ..... feet diameter Square ..... feet (Metric))
Length of Mast ..... 10.7 ..... feet (approximate if not unpiled)	Diameter of Vanes (vertical) <u>3.2</u> feet
Height of Trig. Plug ..... feet (above rock/concrete)	Diameter of Cairn ..... 6.6 ..... feet
Height of Top Vanes to Top Trig. Plug ..... feet	
Height of Cairn ..... 5.0 ..... feet	
- (If other type Trig. beacon is erected - Diagram is required below in Remarks)
4. Trig. Mast & Vanes have been painted white & black respectively.
5. An S.S.M. set in conc/rock has been placed ..... feet bearing ..... M to Trig. Mast/Plug
6. A G.I. Pipe set in conc/soil has been placed ..... feet bearing ..... M to Trig. Mast/Plug
7. Connection S.S.M. to G.I. Pipe ..... feet bearing ..... M

REMARKS:- (To include diagram of marks placed)

See Station Summary (National Mapping) for connection to all Reference Marks

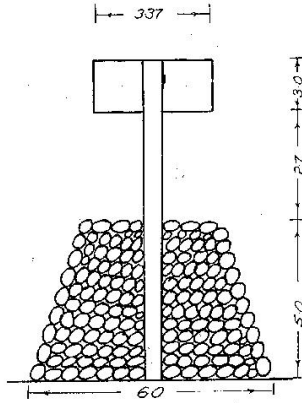

*Handwritten note:*  
Cairn metal  
still in  
9/7/70  
UTM checked

Signature David Minced  
TRIG. SURVEYOR  
12-1-70

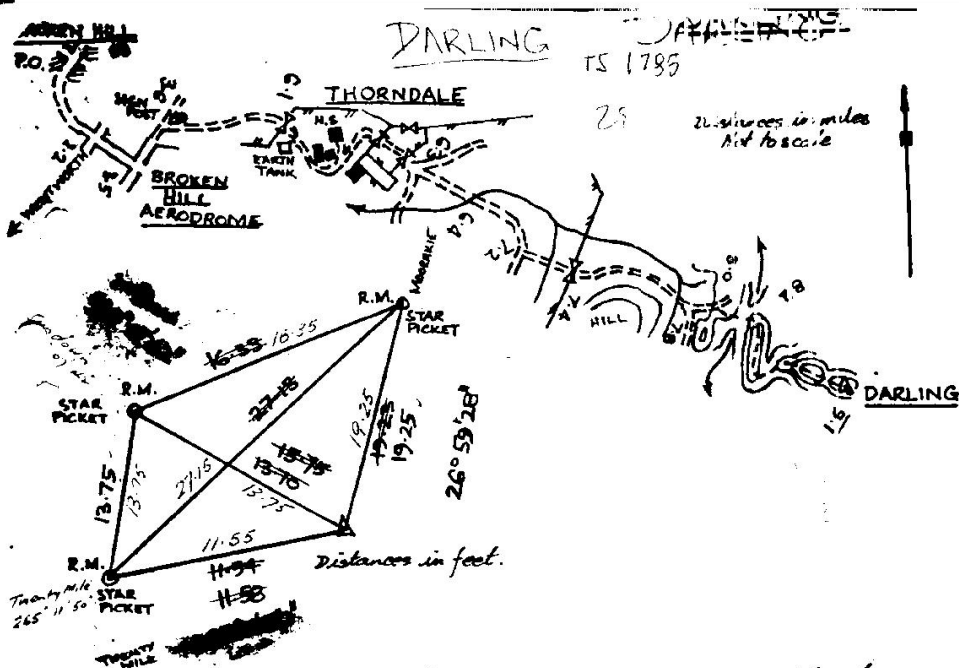

- STATION MARK:** 1/2" copper tube set in concrete at ground level.
- CAIRN:** A rock cairn 3'diam. 4' high, without pole or vanes, erected above the station mark.
- REFERENCE MARKS:** Three steel star pickets set in concrete.
- ACCESS DIAGRAM NOTES:** (November 1959.)

Commencing at the Post Office in Argent Street, Broken Hill travel through South Broken Hill, past the Wentworth turnoff at 2.2 miles and reach the main entrance to the aerodrome at 3.5 miles. Do not enter the aerodrome but turn to the left where there is a road junction at 3.6 in the middle of a rubbish dump. A sign post THORNDALE indicates the right hand branch which turns to follow one fence of the aerodrome. After 4.0 miles the track turns more easterly and at 6.1 miles enters the gate at the homestead. The track passes an earth tank on the right, then a building on the left and curves to the left to pass between the garage and the main house. Pass through a gate ~~in~~ in a fencing running at 30°M from the garage and cross a small field to a gate in the opposite side at 6.3 miles. There is a three way split in the tracks here. Follow the middle track at an approximate bearing of 110° crossing a sandy gutter at 6.4 and curving almost south west to a track junction at 7.2 miles. This brings the track within the foothills. Take the left hand branch, at 110°M, through a green painted iron gate at 7.4 curve slightly to the left round the base of a rocky hill and at 7.8 cross a sandy gutter and come to an ill defined junction, the right hand branch of which runs at 190°M. Continue straight ahead on

DATA FILE  
REF: 3815

DRAWING Locusts' ~~Notes~~ TS 1785  
Notes (cont)

the left hand branch, up a short steep rocky climb to 8.0 where the track fades out. From here proceed on a bearing of  $120^{\circ}M$  to a saddle at 8.2 miles. The heads of the gullies run at  $30^{\circ}M$  and  $230^{\circ}M$  from this saddle. Continue at ~~120~~ up the end of a steep rocky ridge which turns to  $295^{\circ}M$ . While climbing the end of this ridge just after the saddle pass through a line of widely spaced star pickets which are not wired. The ridge ends at 8.6 miles. Turn to  $70^{\circ}M$  across a rocky saddle and start climbing up a long ridge running at  $120^{\circ}M$ . From 8.2 until the trip point is reached at 9.1 the ridges are rough and rocky and covered with light scrub and timber. The summit has been cleared but the timber still obscures the view in some directions. The small cairn is not visible until the party is within two hundred yards of the summit.



TS 1785

DIVISION OF NATIONAL MAPPING  
**TRIGONOMETRICAL STATION SUMMAR**

Station Established by **DIVISION OF NATIONAL MAPPING**  
 Station Re-established by

Date **1954**  
 Date

Map Name  
 State  
 Parish / Hundreds  
 Latitude **32°**

Particulars of Station Marking and Beacon, } (see below)  
 Reference Marks, Situation, Access Etc.  
 Map Reference      Map Name      Scale      Edition      Date

**GROUND MARK:** 1/2" copper tube set in concrete at ground level.

**BEACON:** No beacon was erected, but a small cairn 2'.5 diameter x 4' high covers the station mark.

**REFERENCE MARKS:** Three steel star pickets set in concrete, two of which are on line to Sundown and Twenty Mile.

**ACCESS:** From Broken Hill take the road leading past the aerodrome, and thence to Thorndale homestead. At 6.3 miles take centre of three tracks on approximate bearing of 110° Magnetic. At 7.8 the track crosses a sandy gutter, and comes to an ill-defined junction. Continue straight ahead on left hand branch up a short rocky climb to 8.0, where track fades out. Proceed on a bearing of 120° Magnetic to a saddle at 8.2, then up a steep rocky ridge on bearing of 200° Magnetic, passing through a line of widely spaced star pickets. At 8.6 where ridge ends, turn to 70° across a rocky saddle, and then up another rocky ridge running 120° Magnetic to trig site. A four wheel drive vehicle can be driven to the summit.

Ea

455 18

Convergence (

Origin of Surv  
 Datum for Hei

Title  
 Film held by

Reference Box

Sta

**SUNDOWN**  
**MOORKAIE**  
**FELSPAR**  
**TWENTY M.**

**FOU**

**TANK**  
**SENTINEL**  
**SOUTH PI**  
**SADDLE**  
**NORTH PI**

(\*) Observed  
 and object

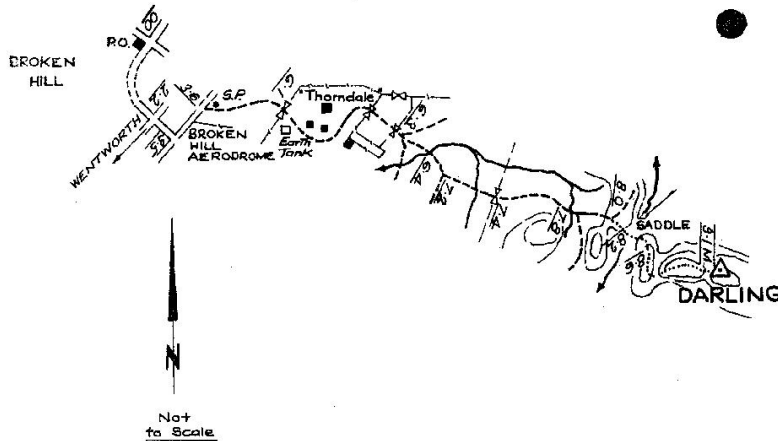

References to previous work

Station Revisited by

