

STATION Dagwo h TS. 1764

Owners Name.....
 Current Occupant.....
 Address.....
 Address.....

21-7-1976
 Access Conventional Vehicle

Kms 0.00 Kurri P.O. continue towards Maitland
 through Heddon Greta and Cliftonleigh
 5.7kms Testers Hollow.
 7.4kms thru Gillieson Heights
 9.1kms Turn right over grid Property Silverview
 9.4kms Turn left off track
 9.5kms Trig.

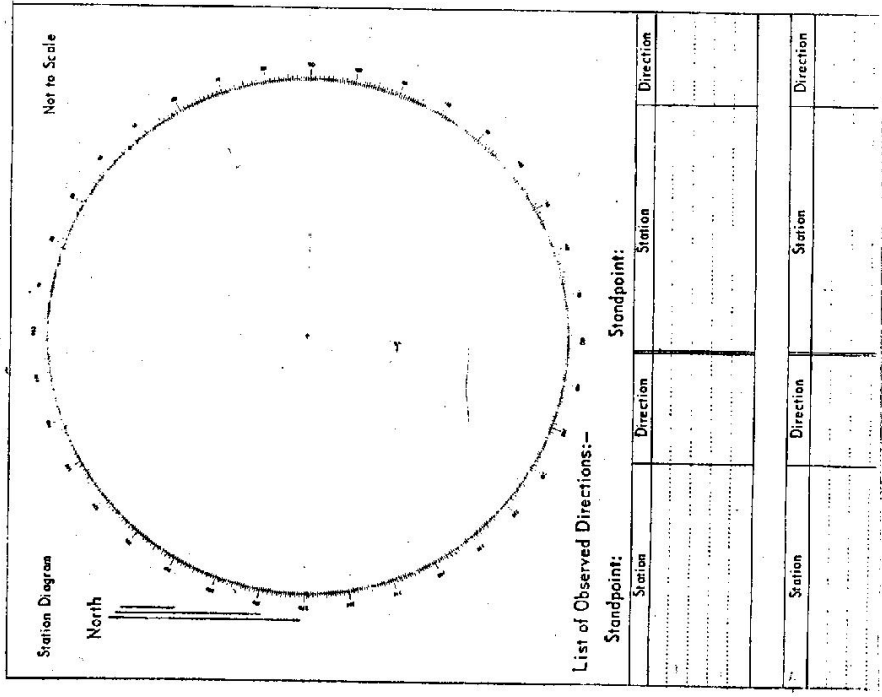

CENTRAL MAPPING AUTHORITY

GEODETIC SURVEY OF N.S.W.

GEODETIC STATION RECONNAISSANCE and MAINTENANCE REPORT

STATION: **DARGLEIGH (Pillars)** No.: **1764**
 MAP SHEET SCALE 1:250 000
 INSPECTED BY: **D. J. Kain** DATE: **16 April 19**
 AUTHORITY: **C.M.A.** FIELD BOOK: **1673**

Station Diagram

- Description:
1. Cleared by lanes bearing **175° - 141° M**. *Note: Cross out word or words which do not apply* from Trig. **Mast Pillar**
 2. Mast & Vanes have been painted white & black respectively. **Inspected Mast or Vanes repainted, Pillar Re-Grouted**
 3. The station/pillar was **re-located on 19 April 1972**. **19.7.72** dimensions now being: **Steel cap screws fitted to pillar plate**.
 Description of mark: **St. Steel Pillar Plate, Steel plug, Brass plug, Bolt, G.I. Pipe**
 Height of mark: **3.82 m** above **rock/concrete**; Mark is **1.380 m** above **G.L.**
 4. A **S.I. P.** set in conc/rock has been placed/found, bearing **147.1° M** from **Mast/Plug/Pillar** 1972
 Note: **Original Mast found broken (was replaced) those are now missing from Dargleigh T.S.**
 5. A **C.I. P.** set in conc/rock has been placed/found, bearing **145.5° M** from **Mast/Plug/Pillar**
 6. A **S.I. P.** set in conc/rock has been placed/found, bearing **145.5° M** from **Mast/Plug/Pillar**
 7. A **S.I. P.** set in conc/rock has been placed/found, bearing **145.5° M** from **Mast/Plug/Pillar**
 8. Action required:

STANDPOINT:

Mark	Direction	Horiz. Distance	Height Difference	Direction	Horiz. Distance	Height Difference
			above standpt.			above standpt.
			below standpt.			below standpt.
			above standpt.			above standpt.
			below standpt.			below standpt.
			above standpt.			above standpt.
			below standpt.			below standpt.
			above standpt.			above standpt.
			below standpt.			below standpt.
			above standpt.			above standpt.
			below standpt.			below standpt.

Prepared by: **D. J. Kain** Checked: **D. J. Kain** Noted on U.T.M. Card

Sr 2793-2 D. West, Government Printer

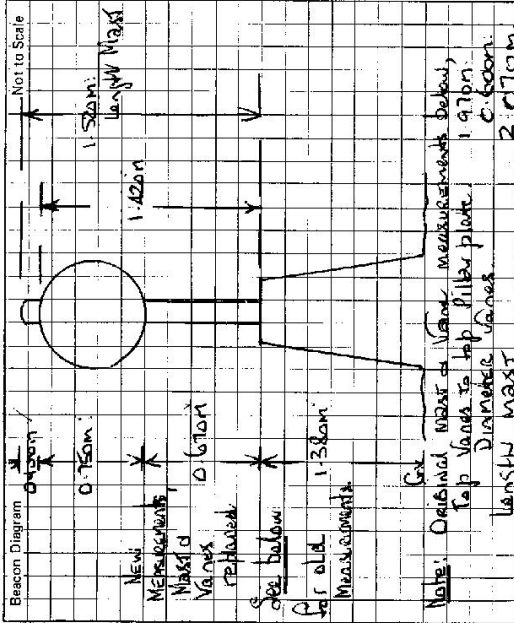

STATION Dunbarth (Pillar) TS 1764

Owner's Name:
 Address:
 Phone:

Current Occupant:
 Address:
 Phone:

ACCESS
 Access Report of/19.....was found suitable/unsuitable.

This section to be completed by officer constructing pillar.

Original station mark found/not found.

Description of mark:

Original beacon found/not found.

Description of beacon:

Height Top of Vanes to Top Mark.....m.

Height of mark.....m. above G.L. / below rock/cont

Diameter of Vanes.....m.

Original Beacon has/has not been destroyed by me.

Date	Record of Station

Department of Lands
 This Trig. Station has been:-

Integrity: study of N S W
 RECONNAISSANCE and MAINTENANCE REPORT 1764 STATION Dagworth TS 1764
 No: _____
 Date: 27th July 1976
 Field Book: _____
 Authority: Dept Lands
 Beacons Diagram: Not to Scale

Note: Cross out word or words which do not apply

1. Completely cleared to permit 360° vision to surrounding Trigs.
2. Cleared by lanes bearing from Trig. Mast
3. Trig. Mast & Vanes have been painted white & black respectively.
4. The Trig. was unpiled/not unpiled, dimensions now being:

Description of mark: **Concrete Pillar** should be explicit, e.g. Steel plug, Brass plug, Bolt, Concrete Pillar
 Height of mark: m above rock/concrete m below G.L.
 Height of Top Vanes to Top Mark/Top pillar plate m Diameter of Vanes (vertical): m.
 Height of Cairn: m. Diameter of Cairn: m.

- Length of Mast: m. (approximate if not unpiled)
5. A set in conc/rock has been placed/fd m. bearing°M from Trig. Mast/pillar
 6. A set in conc/soil has been placed/fd m. bearing°M from Trig. Mast/pillar
 7. A set in conc/soil has been placed/fd m. bearing°M from Trig. Mast/pillar
 8. A set in conc/rock has been placed/fd m. bearing°M from Trig. Mast/pillar

9. Connection: to m. bearing°M
10. Connection: to m. bearing°M
11. Connection: to m. bearing°M
12. Connection: to m. bearing°M
13. Diff. Ht. is m. ^{above}/_{below}
14. Diff. Ht. is m. ^{above}/_{below}
15. Diff. Ht. is m. ^{above}/_{below}
16. Diff. Ht. is m. ^{above}/_{below}

Prepared by: **L.M Hayes**

Checked: _____

Beacon Diagram

Date	Record of Station

STATION Dagwo 1 TS. 1764

Current Occupant.....

Address.....

Owners Name.....

Address.....

21-7-1976
Access Conventional Vehicle

Kms 0.00 Kumri P.O. continue towards Maitland
 through Heddon Greta and Cliftonleigh
 5.7kms Testers Hollow.
 7.4kms thru Gillieston Heights
 9.1kms Turn right over grid Property "Silverview"
 9.4kms Turn left off track
 9.5kms Triq.

Station Diagram

North

Not to Scale

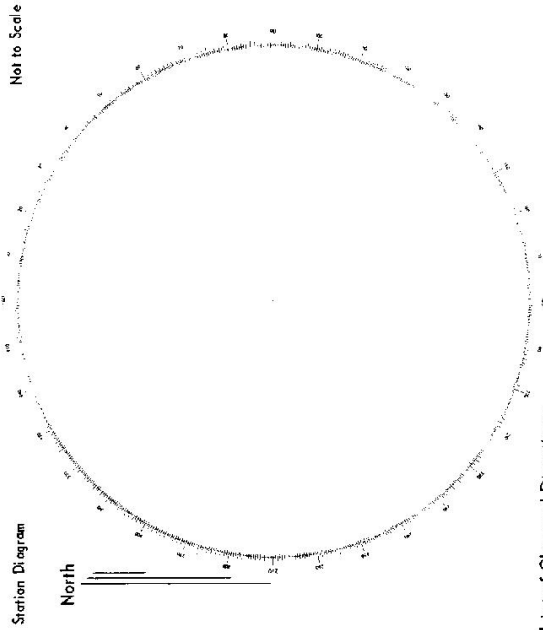

List of Observed Directions:-

Standpoint:		Standpoint:	
Station	Direction	Station	Direction

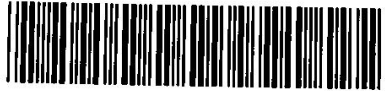

TS1764

LAND INFORMATION CENTRE

GEODETIC SURVEY OF A.S.W.

GEODETIC STATION RECONNAISSANCE and MAINTENANCE REPORT

Description: **Cleared by lanes bearing**
 Note: *Cross out word or words which do not apply*
 Mast & Vanes have been painted white & black respectively. from Trig. Mast

The station/pillar was unplugged/not unplugged/constructed on..... 19..... dimensions now being:
 Description of mark: **S/S Pillar Plate** should be explicit, e.g. S/Steel Pillar Plate, Steel plug, Brass plug, Bolt, G.I. Pipe

Height of mark: m. above rock/concrete; Mark is m. above G.L. **0.600**

Height of Top Vanes to Top Mast/Pillar plate: **1.150** m. Diameter of Vanes (vertical): **0.260** m.

Height of Cairn: m. Diameter of Cairn: m. Name Plate found/~~not found~~.

Length of Mast: m. (approximate if not unplugged)

4. A. **DRILL HOLE (-5)** set in conc/~~rock~~ has been placed/~~found~~; bearing: **324** °M from ~~North~~/~~Trig~~/Pillar
5. A. **DRILL HOLE (-6)** set in conc/~~rock~~ has been placed/~~found~~; bearing: **38** °M from ~~North~~/~~Trig~~/Pillar
6. A. **SSM135701** set in conc/~~rock~~ has been placed/~~found~~; bearing: **157** °M from ~~North~~/~~Trig~~/Pillar
7. A. **SSM144271** set in conc/~~rock~~ has been placed/~~found~~; bearing: **3** °M from ~~North~~/~~Trig~~/Pillar
8. Action required: **DRILL MARKS -1, -2, -3, -4 GONE WITH NEW BRADPOLES**

STANDPOINT: **PILLAR PLATE (-0)** STANDPOINT: **SS/35701**

Mark	Direction	Horiz. Distance	Height Difference	Mark	Direction	Horiz. Distance	Height Difference
TS 10058	0 00 00		above standpt	TS 10058	0 00 00		above standpt
TS 1764-S(Drill)	156 25 10	4.228	below standpt	TS 1764-S (Drill)	167 06 48	7.584	0.340
SS/144271	194 18 05	72.478	below standpt	TS 1764 (P)	170 27 32	13.453	1.803
TS 1764-6 (Drill)	229 25 04	4.608	below standpt	TS 1764-6 (Drill)	184 27 33	16.315	0.196
SS/135701	350 27 51	13.453	below standpt	SS/144271	190 42 30	86.948	1.505

Prepared by: Checked: Noted on U.T.M. Card

SI 2733-1

STATION: **DAGWERTU** No: **1764**

MAP SHEET SCALE 1:250 000

INSPECTED BY: **M MORRISON** DATE: **28/5/2008**

AUTHORITY: **LANDS** FIELD BOOK:

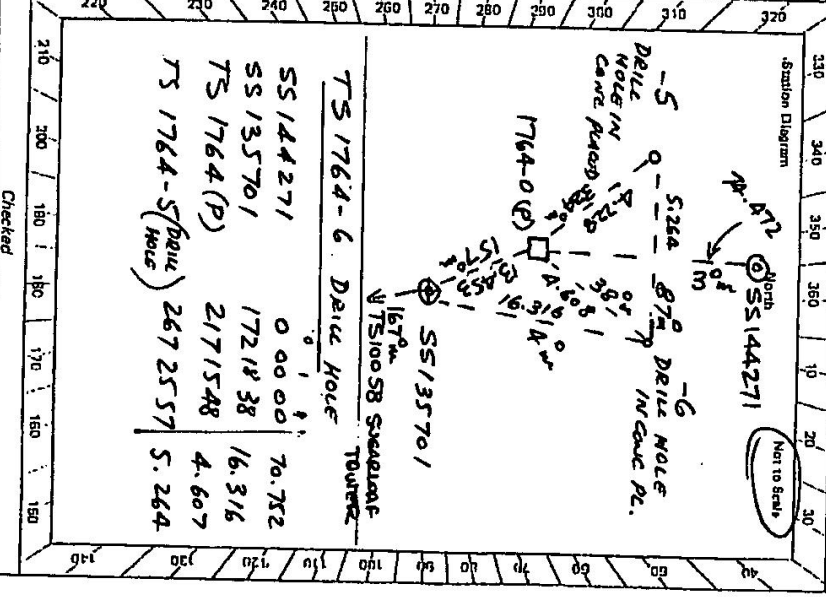

SI 2733-2 D. Vast, Government Printer

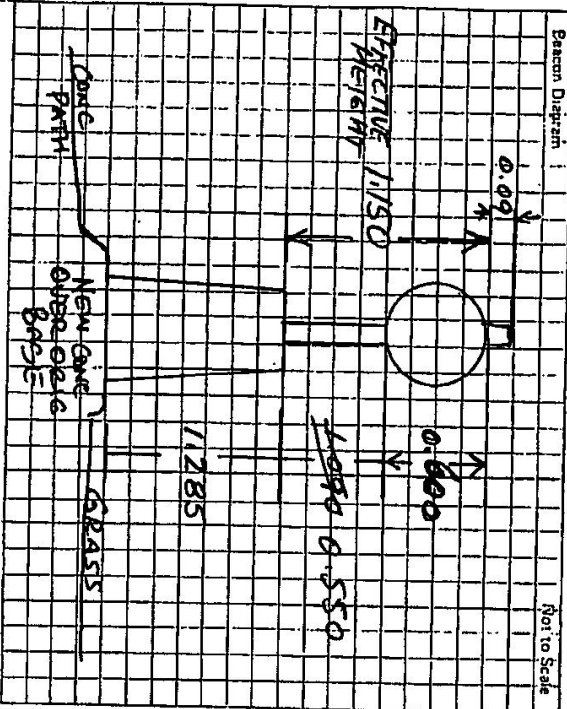

This section to be completed by officer constructing pillar.

Original station mark: found/not found.

Description of mark:

Original beacon found/not found.

Description of beacon:

Height Top of Vane to Top Mark:m.

Height of mark:m, above rock/cont.m, below

Diameter of Vane:m, Height of Collm:m.

Original Beacon has/has not been destroyed by ma.

STATION **Dagworth 1764**

Owner's Name:

Address:

Phone:

Access Report of:/19..... was found suitable/unsuitable.

Current Occupant:

Address:

Phone:

ACCESS

LOCATED AT THE INTERSECTION OF
DARCY'S CCT AND HERO WAY,
DARCY'S PEAK SUBDIVISION AT
GILLIESTON HEIGHTS

Date

Record of Station

TS 1764 DAGWORTH 28 MAY 2008

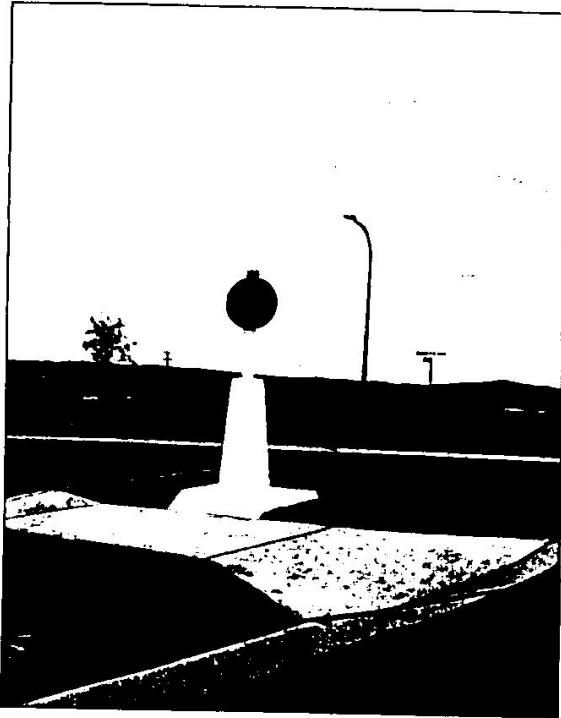

SSM135701

TS1764-5
DRILL HOLE
IN CONC
PLACED

TS1764-6
DRILL HOLE
IN CONC
PLACED

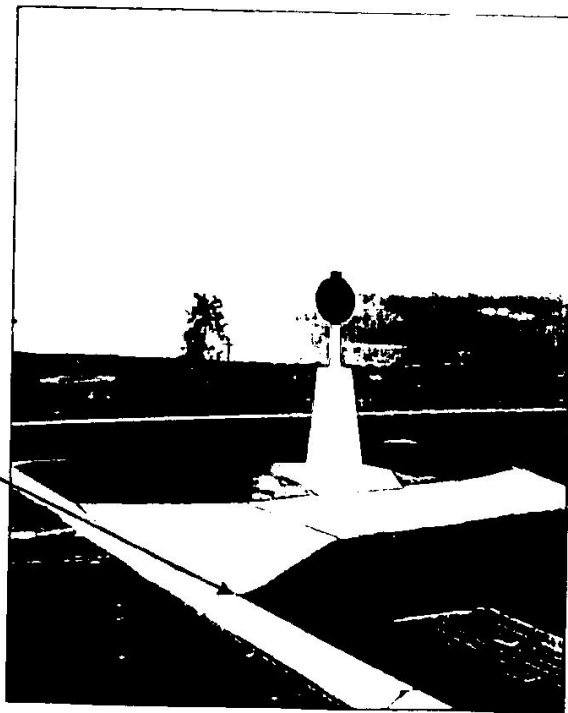

CENTRAL MAPPING AUTHORITY

GEODETIC SURVEY OF N.S.W.

GEODETIC STATION RECONNAISSANCE and MAINTENANCE REPORT

Description:

Note: Cross out word or words which do not apply

1. Cleared by lances bearing..... 175° 14' 11" M. from Trig. Mast Pillar

2. Mast & Vanes have been painted white & black respectively. *Ke-Glance*

3. The station/pillar was *replaced on 10 April 1979*, dimensions now being:

Description of mark: *Steel Plug* should be explicit, e.g., Steel Plug, Brass Plug, Bolt, G.I. Pipe

Height of mark: *3.86 m* above *level/concrete* Mark is: *1.380 m* above G.L.

Height of Top Vanes to Top Mast/Pillar plate: *4.76 m* Diameter of Vanes (vertical): *75 mm*

Height of Cairn: *0 m* Diameter of Cairn: *0 m* Name Plate found/ *Geodetic Station*

Length of Mast: *5.24 m* (approximate if not supplied)

Note: *Original Mast found (1.554 m) these are now marked. Dawicath T.S.*

4. A. *1.554 m* set in conc./rock has been placed/round, bearing: *167° 0' M* from Mast/Plug/Pillar

5. A. *1.554 m* set in conc./rock has been placed/round, bearing: *144° 0' M* from Mast/Plug/Pillar

6. A. *1.554 m* set in conc./rock has been placed/round, bearing: *0° M* from Mast/Plug/Pillar

7. A. *1.554 m* set in conc./rock has been placed/round, bearing: *0° M* from Mast/Plug/Pillar

8. Action required:

STANDPOINT:

STANDPOINT:

Mark	Direction	Horiz. Distance	Height Difference	Mark	Direction	Horiz. Distance	Height Difference
			above standpt				above standpt
			below				below
			above standpt				above standpt
			below				below
			above standpt				above standpt
			below				below
			above standpt				above standpt
			below				below
			above standpt				above standpt
			below				below
			above standpt				above standpt
			below				below

Prepared by:

Checked:

D. I. Kain *17/1/79* *Noted on U.T.M. Card*

Checked:

STATION: *Dawicath (Pillar)* No.: *1764*

MAP SHEET SCALE 1:250 000 *SINGLETON*

INSPECTED BY: *D. I. Kain* DATE: *10 April 79*

AUTHORITY: *C. M. A.* FIELD BOOK: *1673*

Station Diagram North Not to Scale

SSM is 9232-1764-1

From Newcastle North 1:4000 Revision.

SSM is 1.554 below pillar plate labelled by I. Edwins 17/1/86 + Field Book 1496

01 2733-2 O. West, Government Printer

STATION **DASMARIN (Pillar) 75 1764**

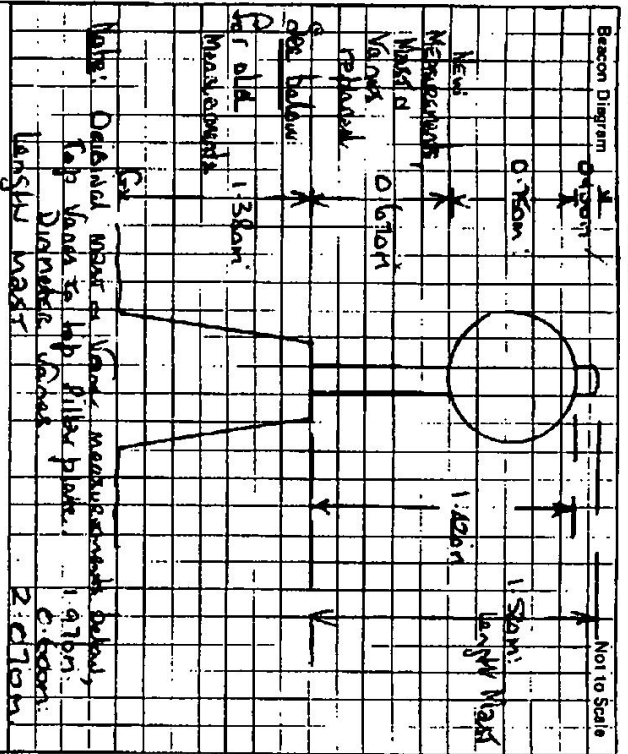

This section to be completed by officer constructing pillar.

Original station mark found/not found:

Description of mark:

Original beacon found/not found:

Description of beacon:

Detail of Beacon:

Height of Top of Vanes to Top Mark:m.

Height of mark:m. above rock/conc.m. below below

Diameter of Vanes:m. Height of Cairn:m.

Original Beacon has/has not been destroyed by me.

Owner's Name:	Current Occupant:
Address:	Address:
Phone:	Phone:
Access Report of/...../19.... was found suitable/unsuitable.	ACCESS
Date	Record of Station

Department of Lands

RECONNAISSANCE and MAINTENANCE REPORT

STATION Dagworth TS TS 1764

This Trig. Station has been:

Note: Cross out word or words which do not apply

1. Completely cleared to permit 360° vision to surrounding Trigs.
2. Cleared by limes bearing from Trig. Mast
3. Trig. Mast & Vanes have been painted white & black respectively.
4. The Trig. was unpiled/not unpiled, dimensions now being:
 - Description of mark: Concrete Pillar should be explicit, e.g. Steel plug, Brass plug, Bolt, Concrete Pillar
 - Height of mark: m above rock/concrete m above G.L.
 - Height of Top Vanes to Top Mark/Top pillar plate m Diameter of Vanes (vertical) m
 - Height of Cairn: m Diameter of Cairn m
 - Length of Mast m. (approximate if not unpiled)
5. A. set in conc./rock has been placed/ld m. bearing °M from Trig. Mast/pillar
6. A. set in conc./soil has been placed/ld m. bearing °M from Trig. Mast/pillar
7. A. set in conc./soil has been placed/ld m. bearing °M from Trig. Mast/pillar
8. A. set in conc./rock has been placed/ld m. bearing °M from Trig. Mast/pillar
9. Connection: to m. bearing °M
10. Connection: to m. bearing °M
11. Connection: to m. bearing °M
12. Connection: to m. bearing °M
13. Diff. Ht. is m. above below
14. Diff. Ht. is m. above below
15. Diff. Ht. is m. above below

Co:	Ph:	No:
Map Sheet:	Inspected by: <u>L.M. Hayes</u>	Date: <u>21st July 1976</u>
Authority: <u>Dept Lands.</u>	Field Book:	
Beacon Diagram	Not to Scale	

Date	Record of Station

