

Department of Lands

Central Mapping Authority

Trigonometrical Survey of N.S.W.

RECONNAISSANCE and MAINTENANCE REPORT on CROZA TS 1709 TRIG. STATION
 Parish MROQTA County CUMBERLAND Map Sheet CATTAL 1:4000 No. 9182
 Inspected by R. G. HANNA Date of Inspection 22ND JUNE 1972

This Trig. Station has been:- Note: Cross out word or words which do not apply

1. Completely cleared to permit 360° vision to surrounding Trigs.
2. Cleared by lanes bearing from Trig. Mast
3. The Trig. was unpiled/~~not unpiled~~. dimensions now being:
 Original Trig. Plug was found/~~not found~~.
 Length of Mast feet (approximate if not unpiled) Mast (Round feet diam
 (Square feet)
 Height of Trig. Plug feet (above rock/concrete) Diameter of Vanes (vertical)
 Height of Top Vanes to Top Trig. Plug feet Diameter of Cairn
 Height of Cairn feet
 (If other type Trig. beacon is erected - Diagram is required below in Remarks)
4. Trig. Mast & Vanes have been painted white & black respectively.
5. An S.S.M. set in conc/rock has been placed feet bearing° M to Trig. Mast/Plug
6. A G.I. Pipe set in conc/soil has been placed feet bearing° M to Trig. Mast/Plug
7. Connection S.S.M. to G.I. Pipe feet bearing° M

REMARKS:- (To include diagram of marks placed)

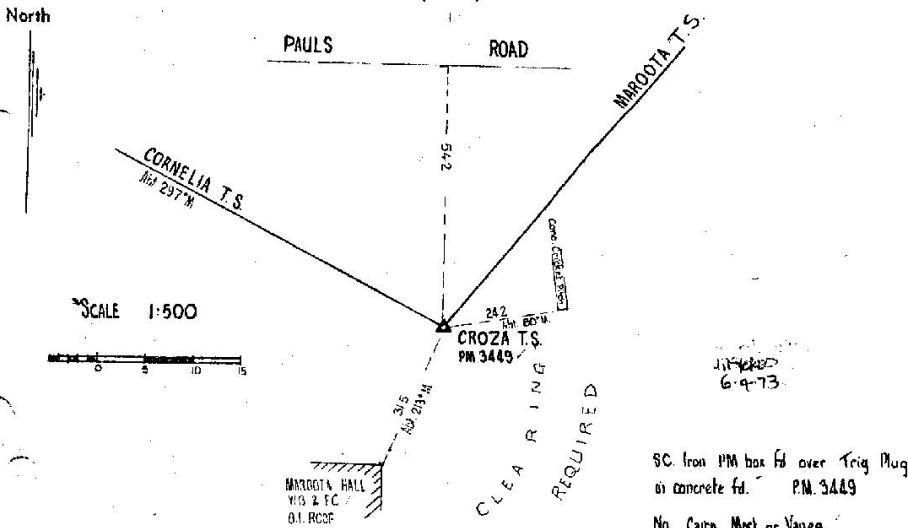

David Stewart
 SURVEYOR GENERAL SURVEYOR
 28 MAR 1973

Signature R. G. Hanna T.S. 6-1-72

ACCESS TO CROZA T.S.

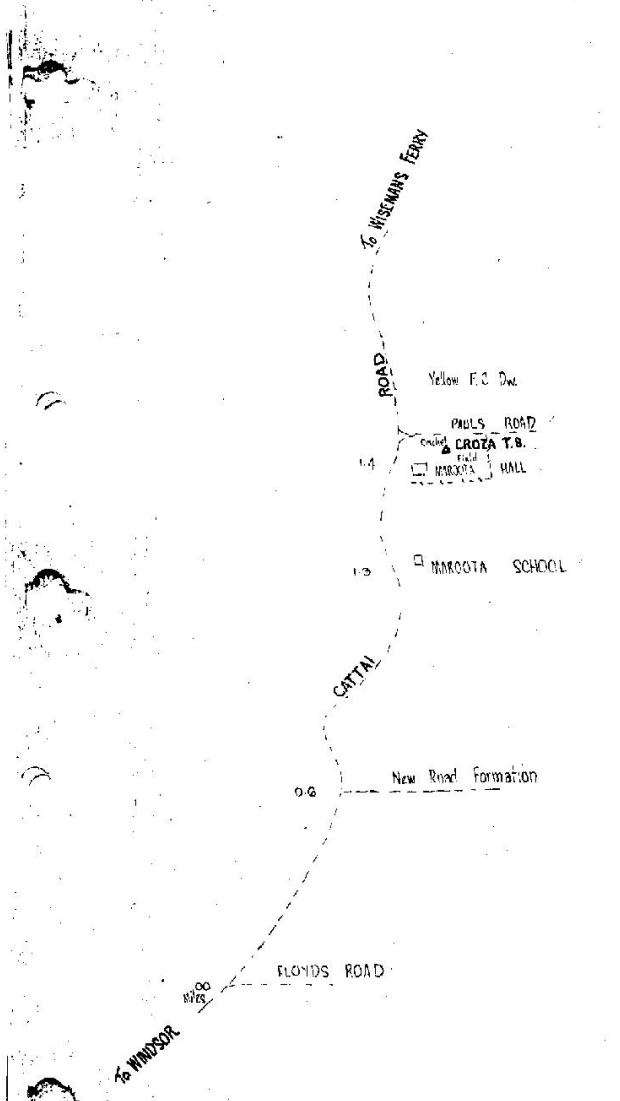

David Minicatt
PUBLIC LAND SURVEYOR
28 MAR 1973

R. Hanna 6-7-72.