

CENTRAL MAPPING AUTHORITY
Department of Lands

Trigonometrical Survey of N.S.W.

RECONNAISSANCE and MAINTENANCE REPORT

STATION COPPERHANNA TS 1638

This Trig. Station has been:-

Note: Cross out word or words which do not apply

1. Completely cleared to permit 360° vision to surrounding Trigs.
2. Cleared by lanes bearing from Trig. Mast
3. Trig. Mast & Vanes have been painted white & black respectively.
4. The Trig. was unpiled/not unpiled, dimensions now being: ~~Original Station No.~~

Description of mark..... should be explicit, e.g. Steel plug, Brass plug, Bolt, G.I. Pipe

Height of mark..... m above rock/concrete m below G.L.

Height of Top Vanes to Top Mark..... m. Diameter of Vanes (vertical)..... m.

Height of Cairn..... m. Diameter of Cairn. See Diagram..... m.

Length of Mast..... m. (approximate if not unpiled)

5. A..... set in conc/rock has been placed..... m. bearing.....°M from Trig. Mast
6. A..... set in conc/soil has been placed..... m. bearing.....°M from Trig. Mast
7. A..... set in conc/soil has been placed..... m. bearing.....°M from Trig. Mast
8. A..... set in conc/rock has been placed..... m. bearing.....°M from Trig. Mast

9. Connection..... to..... m. bearing.....°M

10. Connection..... to..... m. bearing.....°M

11. Connection..... to..... m. bearing.....°M

12. Connection..... to..... m. bearing.....°M

13. Diff. Ht. is..... m. above below

14. Diff. Ht. is..... m. above below

15. Diff. Ht. is..... m. above below

16. Diff. Ht. is..... m. above below

Prepared by: *[Signature]* 23/1/76 Checked: *[Signature]*

Noted on U.T.M. Card

Co: GEORGIANA
Map Sheet: 488RC241816
Inspected by: N MORRISON
Authority:
No: 6732-11 & 111
Date: NOVEMBER 1974
Field Book:
Not to Scale

Beacon Diagram

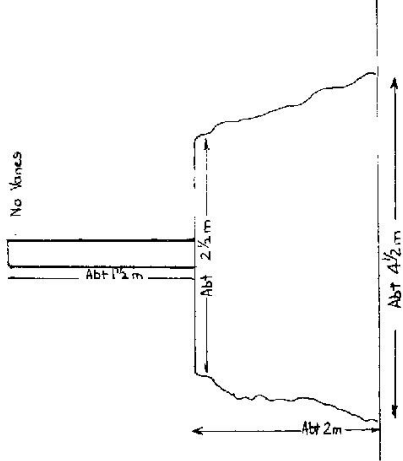

Date _____ Record of Station _____

Checked

7498

Trigonometrical Survey of N.S.W.

RECONNAISSANCE and MAINTENANCE REPORT

Department of Lands

STATION COPPERHANA TS 1638

Co: CROSBY
 Map Sheet: EAST WAST 1250 000
 Inspected by: K HADGON
 Authority: C.M.A.
 No: [blank]
 Date: 18-5-78
 Field Book: [blank]

Note: Cross out word or words which do not apply

This Trig. Station has been:-

1. Completely cleared to permit 360° vision to surrounding Trigs.
2. Cleared by lanes bearing..... from Trig. Mast
3. Trig. Mast & Vanes have been painted white & black respectively.
4. The Trig. was unpiled/~~not unpiled~~, dimensions ~~now~~ being: Original Station Mark found/~~not found~~

Description of mark..... should be explicit, e.g. Steel plug, Brass plug, Bolt, G.I. Pipe

Height of mark..... m ^{above} / _{below} rock/concrete m above / below G.L.

Height of Top Vanes to Top Mark..... m. Diameter of Vanes (vertical)..... m.

Height of Cairn..... m. Diameter of Cairn..... m.

Length of Mast..... m. (approximate if not unpiled)

5. A..... set in conc/rock has been placed..... m. bearing.....°M from Trig. Mast
6. A..... set in conc/soil has been placed..... m. bearing.....°M from Trig. Mast
7. A..... set in conc/soil has been placed..... m. bearing.....°M from Trig. Mast
8. A..... set in conc/rock has been placed..... m. bearing.....°M from Trig. Mast

9. Connection..... to..... m. bearing.....°M
10. Connection..... to..... m. bearing.....°M
11. Connection..... to..... m. bearing.....°M
12. Connection..... to..... m. bearing.....°M
13. Diff. Ht. is..... m. ^{above} / _{below}
14. Diff. Ht. is..... m. ^{above} / _{below}
15. Diff. Ht. is..... m. ^{above} / _{below}
16. Diff. Ht. is..... m. ^{above} / _{below}

Prepared by: K.HADGON

Checked:

Noted on U.T.M. Card

Checked

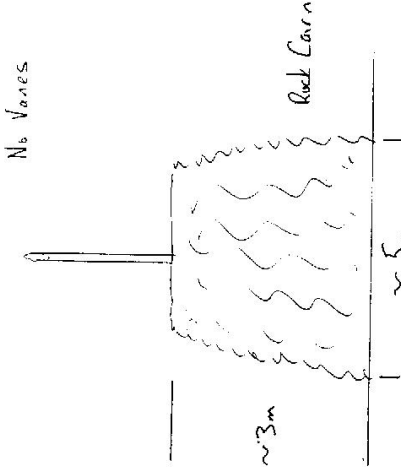

GEODETTIC SURVEY OF M.S.W.

CENTRAL MAPPING AUTHORITY

GEODETTIC STATION RECONNAISSANCE and MAINTENANCE REPORT

- Description: *Note: Cross out word or words which do not apply*
1. Cleared by lanes bearing..... from Trig. Mast
 2. Mast & Vanes have been painted white & black respectively.
 3. The station/pillar was unpiled/not unpiled/constructed on.....19....., dimensions now being: Description of mark.....should be explicit, e.g., S/Steel Pillar Plate, Steel plug, Brass plug, Bolt, G.I. Pipe Height of mark.....m. above rock/concrete; Mark is.....m. above G.L. Height of Top Vanes to Top Mark/Pillar platem. Diameter of Vanes (vertical).....m. Height of Cairn.....m. Diameter of Cairn.....m. Name Plate found/not found/placed. Length of Mastm. (approximate if not unpiled)
 4. A.....set in conc/rock has been placed/found, bearing.....°M from Mast/Plug/Pillar
 5. A.....set in conc/rock has been placed/found, bearing.....°M from Mast/Plug/Pillar
 6. A.....set in conc/rock has been placed/found, bearing.....°M from Mast/Plug/Pillar
 7. A.....set in conc/rock has been placed/found, bearing.....°M from Mast/Plug/Pillar
 8. Action required:.....

Mark	Direction	Horiz. Distance	Height Difference	Mark	Direction	Horiz. Distance	Height Difference	STANDPOINT: BRONZE ROD 1 3	
								above standpt.	below standpt.
CROCKER GS	0 00 00			CROCKER GS	0 00 00			above standpt.	
BRASS PLUG	5 15 0 15	11.753	132.6	110 16	50 11 753		4.952	above standpt.	
BRASS NAIL	4 18 0 12	11.121	10.046	100 15	20 4 122		0.495	above standpt.	
BRASS NAIL	2 27 0 21	15.240	6.566	220 12	20 15 244		0.565	above standpt.	
BRASS NAIL	2 1 229 29	17.818	6.123	229 29	00 17 850		0.121	above standpt.	
RYAN GS (P)	207 06 38			207 06 20				below standpt.	

Prepared by: Ryan GS (P)

Checked:

Noted on U.T.M. Card

Checked

STATION: BRASS NAIL 19 (P) No: 1638

MAP SHEET SCALE 1:250 000 BRASS

INSPECTED BY: RYAN GS DATE: 22.9.78

AUTHORITY: M.S.W. FIELD BOOK: 1167

Station Diagram

Net to Scale

GEODETTIC SURVEY OF N.S.W.

CENTRAL MAPPING AUTHORITY

GEODETTIC STATION RECONNAISSANCE and MAINTENANCE REPORT

- Description: 360° M *Note: Cross out word or words which do not apply*
1. Cleared by lanes bearing 360° M from Trig. Mast
 2. Mast & Vanes have been painted white & black respectively.
 3. The ~~concentric~~ pillar was ~~constructed~~ / constructed on 2x4x8x19.78..., dimensions now being: Description of mark Steel Pillar Plate, Steel plug, Brass plug, Bolt, G.I. Pipe should be explicit, e.g., S/Steel Pillar Plate, Steel plug, Brass plug, Bolt, G.I. Pipe
 - Height of mark 3.75 m. above ~~concrete~~ / concrete; Mark is 3.75 m. above G.L.
 - Height of Top Vanes to Top ~~concentric~~ / Pillar plate 1.68 m. Diameter of Vanes (vertical) 75 mm.
 - Height of Cairn 0 m. Diameter of Cairn 0 m. Name Plate ~~is placed~~ / placed.
 - Length of Mast 0 m. (approximate if not unplied)
 4. ~~ABOVE~~ 360° M 1 3 set in conc ~~concrete~~ / ~~concrete~~ has been placed / ~~concrete~~ bearing 87° M from ~~Mark~~ / ~~Trig~~ / Pillar
 5. ~~ABOVE~~ 360° M 1 4 set in conc ~~concrete~~ / ~~concrete~~ has been placed / ~~concrete~~ bearing 87° M from ~~Mark~~ / ~~Trig~~ / Pillar
 6. ~~ABOVE~~ 360° M 2 1 set in conc ~~concrete~~ / ~~concrete~~ has been placed / ~~concrete~~ bearing 358° M from ~~Mark~~ / ~~Trig~~ / Pillar
 7. ~~ABOVE~~ 360° M 2 2 set in conc ~~concrete~~ / ~~concrete~~ has been placed / ~~concrete~~ bearing 358° M from ~~Mark~~ / ~~Trig~~ / Pillar

8. Action required: None

STANDPOINT: Backs River 5 STANDPOINT: Top Line 1

Mark	Direction	Horiz. Distance	Height Difference	Mark	Direction	Horiz. Distance	Height Difference
<u>360° M</u>	<u>0</u>	<u>00</u>	<u>0</u> above standpt.	<u>360° M</u>	<u>0</u>	<u>00</u>	<u>0</u> above standpt.
<u>360° M</u>	<u>1</u>	<u>11766</u>	<u>-132</u> below standpt.	<u>360° M</u>	<u>16</u>	<u>11752</u>	<u>-1453</u> below standpt.
<u>360° M</u>	<u>4</u>	<u>1633</u>	<u>2828</u> above standpt.	<u>360° M</u>	<u>17</u>	<u>11632</u>	<u>-1458</u> below standpt.
<u>360° M</u>	<u>2</u>	<u>2813</u>	<u>-521</u> below standpt.	<u>360° M</u>	<u>39</u>	<u>12516</u>	<u>-1832</u> below standpt.
<u>360° M</u>	<u>2</u>	<u>28190</u>	<u>-758</u> below standpt.	<u>360° M</u>	<u>38</u>	<u>11786</u>	<u>-1389</u> below standpt.
<u>360° M</u>	<u>3</u>	<u>0712</u>	<u>0</u> above standpt.	<u>360° M</u>	<u>07</u>	<u>0726</u>	<u>0</u> above standpt.

Prepared by: P. Jones Checked: 6/11/2018 Noted on U.T.M. Card

ST 2738 - 1

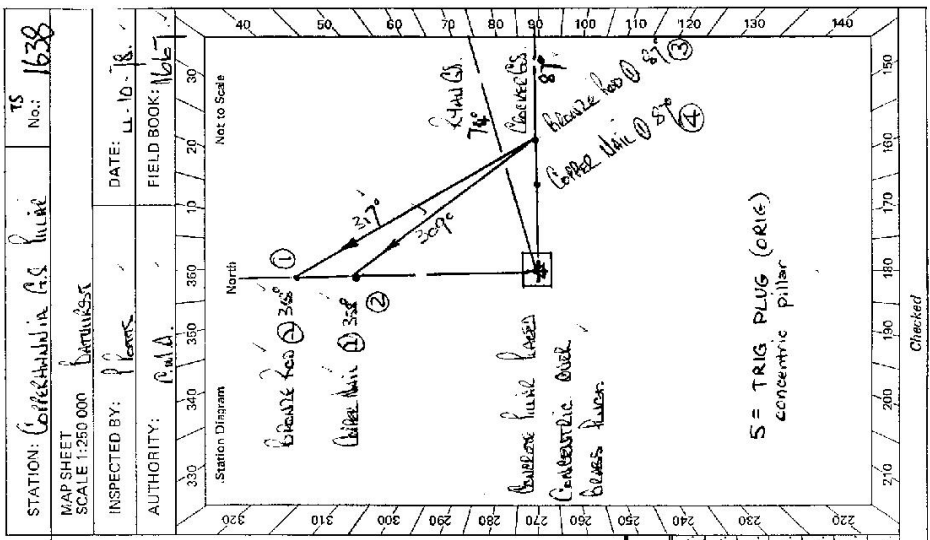

Checked

STATION: Coffeenahulla G.S. Hill No. 15 No. 1638

MAP SHEET SCALE 1:250 000 INSPECTED BY: P. Jones DATE: 11-10-18

AUTHORITY: P.M.A. FIELD BOOK: 1166

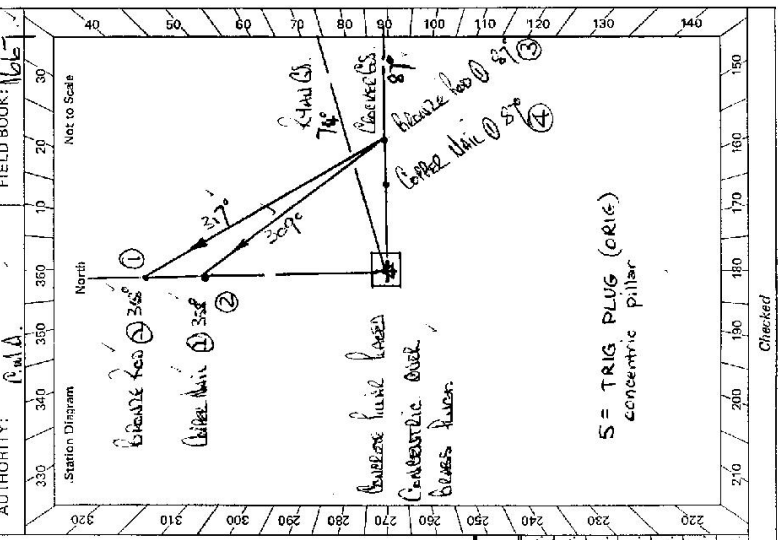

GS 24

STATION Carrehanville Co. Road 75 1638

Owner's Name: Nature Reserve
 Address: NATIONAL PARKS
FAHLE INDUSTRIAL SECTOR
 Phone:

Current Occupant:

Address:

Phone:

ACCESS

Access Report of 10/10/1878 was found suitable/unsuitable.
 0.00 10. TULLYVAH ROAD SOUTH TOWNLANDS CARREHANVILLE
 0.20 END SCALES ROAD
 1.30 TULLYVAH ROAD SOUTH TOWNLANDS CARREHANVILLE
 2.25 ROAD INTO GARDEN - FOLLYS WIND ROAD
 10.95 GRAVE
 10.30 GRAVE
 10.50 CONCRETE BRIDGE
 10.60 CONCRETE BRIDGE
 10.70 CONCRETE BRIDGE
 12.00 GRAVE
 13.20 GRAVE
 14.05 PASS ROAD TO HOMESTEAD ON RIGHT FOLLYS WIND ROAD
 16.20 WHITE IRON BRIDGE - THEN TULLYVAH ROAD AT THE GARDEN DOWN WIND ROAD
 16.85 GRAVE
 17.10 ALONG BRIDGE - THEN TULLYVAH ROAD
 17.50 IRON BRIDGE
 18.35 IRON BRIDGE
 19.55 IRON BRIDGE
 20.05 IRON BRIDGE
 20.80 IRON BRIDGE
 21.80 IRON BRIDGE - TURN ON LEFT JUST BEFORE GARDEN
 22.55 PASS TRUCK ON LEFT
 25.50 PASS SIGN NATURE RESERVE NATIONAL PARKS AND WILDLIFE SERVICE TRUCK
 27.30 ACADEMIC STATION CARREHANVILLE ON RIGHT

Note: POSSIBLE TO DRIVE STATION SIGNAL TYPE VEHICLE IN DAY WEATHER ONLY.

SR 2733-2 D. West, Government Printer

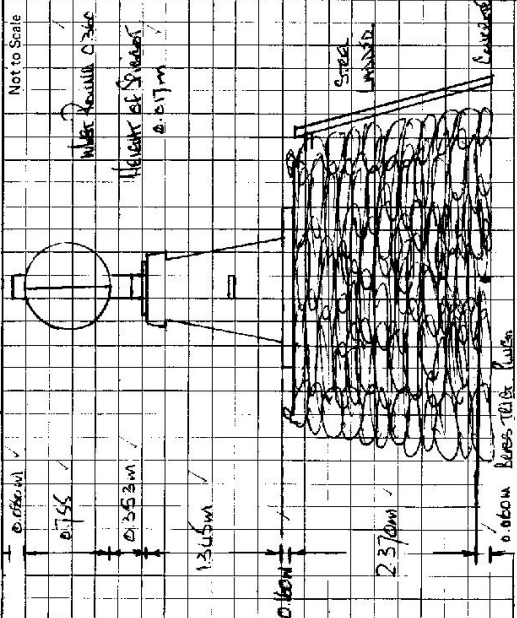

This section to be completed by officer constructing pillar.

Original station mark found/~~not~~ found. Base Tills used

Description of mark:

Original beacon ~~found~~/not found.

Description of beacon:

Height Top of Vanes to Top Mark.....m.

Height of mark 0.155 m. above level/conc.....m. below G.L.

Diameter of Vanes 0.160 m. Height of Cairn 2.120 m.

Original Beacon has/~~has not~~ been destroyed by me.

CENTRAL MAPPING AUTHORITY

GEODETIC STATION RECONNAISSANCE and MAINTENANCE REPORT

- Description:
- Note: Cross out word or words which do not apply
- Cleared by lanes bearing..... from Trig. Mast
 - Mast & Vanes have been painted white & black respectively.
 - The station/pillar was unpiled/not unpiled/constructed on..... 19....., dimensions now being: Description of mark..... should be explicit, e.g., S/Steel Pillar/Plate, Steel plug, Brass plug, Bolt, G.I. Pipe
 Height of mark.....m, above rock/concrete; Mark is.....m, above G.L.
 Height of Top Vanes to Top Mark/Pillar plate.....m. Diameter of Vanes (vertical).....m.
 Height of Cairn.....m. Diameter of Cairn.....m. Name Plate found/not found/placed.
 Length of Mast.....m. Approximate if not unpiled)
 - A.....set in conc/rock has been placed/found, bearing.....° M from Mast/Plug/Pillar
 - A.....set in conc/rock has been placed/found, bearing.....° M from Mast/Plug/Pillar
 - A.....set in conc/rock has been placed/found, bearing.....° M from Mast/Plug/Pillar
 - A.....set in conc/rock has been placed/found, bearing.....° M from Mast/Plug/Pillar

Action required:.....

STANDPOINT: BRONZE ROD 1 v 3

Mark	Direction	Horiz. Distance	Height Difference	Mark	Direction	Horiz. Distance	Height Difference
			above standpt. below				above standpt. below
<u>BRONZE ROD 1</u>	<u>0 00 00</u>	<u>0 00 00</u>	<u>0 00 00</u>	<u>BRONZE ROD 1</u>	<u>0 00 00</u>	<u>0 00 00</u>	<u>0 00 00</u>
<u>BRONZE ROD 2</u>	<u>16 16 16</u>	<u>11 75 1</u>	<u>4 453</u>	<u>BRONZE ROD 2</u>	<u>16 16 16</u>	<u>11 75 1</u>	<u>4 453</u>
<u>BRONZE ROD 3</u>	<u>18 18 18</u>	<u>7 62 9</u>	<u>4 453</u>	<u>BRONZE ROD 3</u>	<u>18 18 18</u>	<u>7 62 9</u>	<u>4 453</u>
<u>BRONZE ROD 4</u>	<u>39 39 39</u>	<u>13 51 2</u>	<u>4 453</u>	<u>BRONZE ROD 4</u>	<u>39 39 39</u>	<u>13 51 2</u>	<u>4 453</u>
<u>BRONZE ROD 5</u>	<u>39 39 39</u>	<u>9 78 2</u>	<u>4 453</u>	<u>BRONZE ROD 5</u>	<u>39 39 39</u>	<u>9 78 2</u>	<u>4 453</u>
<u>BRONZE ROD 6</u>	<u>07 07 07</u>	<u>MISIDENTIFIED</u>	<u>MISIDENTIFIED</u>	<u>BRONZE ROD 6</u>	<u>07 07 07</u>	<u>MISIDENTIFIED</u>	<u>MISIDENTIFIED</u>

Prepared by: Boys / AL MURK 1979 / Checked: Boys

Note: on U.T.M. Cart

STATION: BRONZE ROD 1 (S.P.) No.: 1638

MAP SHEET SCALE 1:250 000

INSPECTED BY: BATHURST DATE: 7th March 79

AUTHORITY: Boys FIELD BOOK: 1607

Station Diagram

North

Not to Scale

S = TRIG PLUG (ORIG) congeneric pillar

Checked

STATION: Copperhanna G.I. (P) No.: 1638
 MAP SHEET
 SCALE 1:250 000
 INSPECTED BY: P.B.P.
 AUTHORITY: C.M.A.
 DATE: 21 May 1981
 FIELD BOOK: 1825

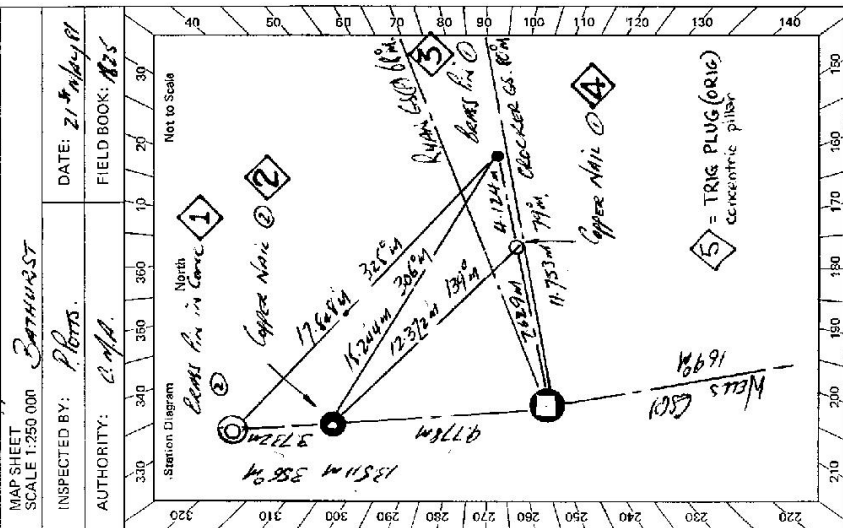

CENTRAL MAPPING AUTHORITY
 GEODETIC SURVEY OF NSW.
 GEODETIC STATION RECONNAISSANCE and MAINTENANCE REPORT

- Description:
 Note: Cross out word or words which do not apply
- Cleared by lanes bearing 360° from Trig. Mast
 - Mast & Vanes have been painted white & black respectively. ✓
 - The ~~marker~~ pillar was unpiled/~~replaced~~/~~reinstated~~ on 21st May 1981, dimensions now being:
 Description of mark: St. Anne's should be explicit, e.g., S/Steel Pillar Plate, Steel plug, Brass plug, Bolt, G.I. Pipe
 Height of mark: 1.5 m. above rock/concrete; Mark is above G.L.
 Height of Top Vanes to Top Mark/Pillar plate 1.9 m. Diameter of Vanes (vertical) 1.9 m.
 Height of Cairn: 1.9 m. Diameter of Cairn 1.9 m. Name Plate found/not found/placed.
 Length of Mast: 1.9 m. (approximate if not unpiled)
 - A Copper Nail set in conc./~~rock~~ has been placed/found, bearing 79° M from ~~Mast/Trig~~/Pillar
 - A Copper Nail set in conc./~~rock~~ has been placed/found, bearing 79° M from ~~Mast/Trig~~/Pillar
 - A Copper Nail set in conc./~~rock~~ has been placed/found, bearing 336° M from ~~Mast/Trig~~/Pillar
 - A Copper Nail set in conc./~~rock~~ has been placed/found, bearing 336° M from ~~Mast/Trig~~/Pillar
 - Action required: See notes

STANDPOINT: Conc obs here STANDPOINT: Copper Nail 1

Mark	Direction	Horiz. Distance	Height Difference	Mark	Direction	Horiz. Distance	Height Difference
<u>Copper Nail 1</u>	<u>12 50 50</u>	<u>MISIDENT</u>	<u>above standpt.</u>	<u>Copper Nail 2</u>	<u>12 50 30</u>	<u>MISIDENT</u>	<u>above standpt.</u>
<u>Copper Nail 2</u>	<u>13 09 00</u>	<u>11.73</u>	<u>above standpt.</u>	<u>Copper Nail 3</u>	<u>98 41 40</u>	<u>12.50</u>	<u>below standpt.</u>
<u>Copper Nail 3</u>	<u>13 11 00</u>	<u>7.629</u>	<u>above standpt.</u>	<u>Copper Nail 4</u>	<u>143 06 00</u>	<u>4.124</u>	<u>above standpt.</u>
<u>Copper Nail 4</u>	<u>98 07 30</u>	<u>13.51</u>	<u>above standpt.</u>	<u>Copper Nail 5</u>	<u>143 09 10</u>	<u>11.75</u>	<u>above standpt.</u>
<u>Copper Nail 5</u>	<u>1283 30 00</u>	<u>13.51</u>	<u>above standpt.</u>	<u>Copper Nail 6</u>	<u>233 03 10</u>	<u>11.24</u>	<u>above standpt.</u>
<u>Copper Nail 6</u>	<u>243 29 30</u>	<u>9.77</u>	<u>above standpt.</u>	<u>Copper Nail 7</u>	<u>282 19 10</u>	<u>17.60</u>	<u>above standpt.</u>

Prepared by: P.B.P. 2240 May 1981 Checked: P.B.P.
 Noted on U.T.M. Card
 S1 2753-1

CENTRAL MAPPING AUTHORITY

GEODETIC SURVEY OF NSW

GEODETIC STATION RECONNAISSANCE and MAINTENANCE REPORT

STATION: *Copper Hill in C100* No.: *1638*
 MAP SHEET SCALE 1:250 000
 INSPECTED BY: *P. Harts* DATE: *21st May 1981*
 AUTHORITY: *C.M.A.* FIELD BOOK: *1825*

Station Diagram

- Description:
- Note: Cross out word or words which do not apply
- Cleared by lanes bearing..... from Trig. Mast
 - Mast & Vanes have been painted white & black respectively.
 - The station/pillar was unpiled/not unpiled/constructed on..... 19....., dimensions now being: Description of mark..... should be explicit, e.g., S/Steel Pillar Plate, Steel plug, Brass plug, Bolt, G.I. Pipe
- Height of mark..... m. ^{above} rock/concrete; Mark is..... m. ^{above} G.L.
- Height of Top Vanes to Top Mark/Pillar plate..... m. Diameter of Vanes (vertical)..... m.
- Height of Cairn..... m. Diameter of Cairn..... m. Name Plate found/not found/placed.
- Length of Mast..... m. (approximate if not unpiled)
- A..... set in conc./rock has been placed/found, bearing..... °M from Mast/Plug/Pillar
 - A..... set in conc./rock has been placed/found, bearing..... °M from Mast/Plug/Pillar
 - A..... set in conc./rock has been placed/found, bearing..... °M from Mast/Plug/Pillar
 - A..... set in conc./rock has been placed/found, bearing..... °M from Mast/Plug/Pillar
8. Action required:.....

STANDPOINT: *Copper Hill* ✓ 2

Mark	Direction	Horiz. Distance	Height Difference	Mark	Direction	Horiz. Distance	Height Difference
<i>Spent Bolt</i>	<i>0 00 00</i>	<i>MISIDENT</i>	<i>above standpt.</i>				<i>above standpt.</i>
<i>CRACKER</i>	<i>12 56 16</i>		<i>above standpt.</i>				<i>above standpt.</i>
<i>Steel Pi</i>	<i>0 53 01</i>	<i>00 15 44</i>	<i>0.56</i>				<i>above standpt.</i>
<i>Copper Nail</i>	<i>0 4 65</i>	<i>22 28 12 37</i>	<i>0.07</i>				<i>above standpt.</i>
<i>Conc. old Point</i>	<i>103 28 00</i>	<i>9 77 9</i>	<i>2.36</i>				<i>above standpt.</i>
<i>Steel Pi</i>	<i>0 26 30</i>	<i>3 73 2</i>	<i>0.443</i>				<i>above standpt.</i>

Prepared by: *P. Harts* 22nd May 1981 Checked: *P. Harts* Noted on U.T.M. Card

S1 2738-1

Checked

GS 24

ST 2733 2 D. West, Government Printer Beacon Diagram	STATION <i>Copper Mountain GCP 13</i> 1638	Owner's Name: <i>NORFOLK RESERVE</i> Address: <i>Norfolk Reserve</i> Phone: <i>Nightlife Service</i> Current Occupant: Address: Phone: ACCESS Access Report of <i>19/10/1971</i> was found suitable/unsuitable.
Not to Scale 		Date Record of Station
This section to be completed by officer constructing pillar. Original station mark found/not found. Description of mark: Original beacon found/not found. Description of beacon: Height Top of Vanes to Top Markm. Height of markm. above G.L. below Diameter of Vanesm. Height of Cairnm. Original Beacon has/has not been destroyed by me.		