

CENTRAL MAPPING AUTHORITY

GEODETIC SURVEY OF M.S.W.

GEODETIC STATION RECONNAISSANCE and MAINTENANCE REPORT

STATION: CONROY No.: 1573

MAP SHEET SCALE 1:250 000 CARGELLIGO

INSPECTED BY: C. C. HANNA DATE: 15/5/79

AUTHORITY: C.M.A. FIELD BOOK:

- Description:
1. Cleared by lanes bearing..... *Note: Cross out word or words which do not apply*..... from Trig. Mast
 2. Mast & Vanes have been painted white & black respectively.
 3. The station/pillar was unpiled/not unpiled/constructed on..... 19..... dimensions now being:
Description of mark..... should be explicit, e.g., S/Steel Pillar Plate, Steel plug, Brass plug, Bolt, G.I. Pipe
Height of mark..... m. above rock/concrete; Mark is..... m. above G.L.
 - Height of Top Vanes to Top Mark/Pillar plate..... m. Diameter of Vanes (vertical)..... m.
 - Height of Cairn..... m. Diameter of Cairn..... m. Name Plate found/not found/placed.
 - Length of Mast..... m. (approximate if not unpiled)
 4. A..... set in conc/rock has been placed/found, bearing..... ° M from Mast/Plug/Pillar
 5. A..... set in conc/rock has been placed/found, bearing..... ° M from Mast/Plug/Pillar
 6. A..... set in conc/rock has been placed/found, bearing..... ° M from Mast/Plug/Pillar
 7. A..... set in conc/rock has been placed/found, bearing..... ° M from Mast/Plug/Pillar
 8. Action required:.....

STANDPOINT:

Mark	Direction	Horiz. Distance	Height Difference	Mark	Direction	Horiz. Distance	Height Difference
			above standpt				above standpt
			below standpt				below standpt
			above standpt				above standpt
			below standpt				below standpt
			above standpt				above standpt
			below standpt				below standpt
			above standpt				above standpt
			below standpt				below standpt
			above standpt				above standpt
			below standpt				below standpt

Prepared by: C. C. Hanna 15/5/79

Checked: J. P. [Signature] 15.3.85

Noted on U.T.M. Card

St 2733-1

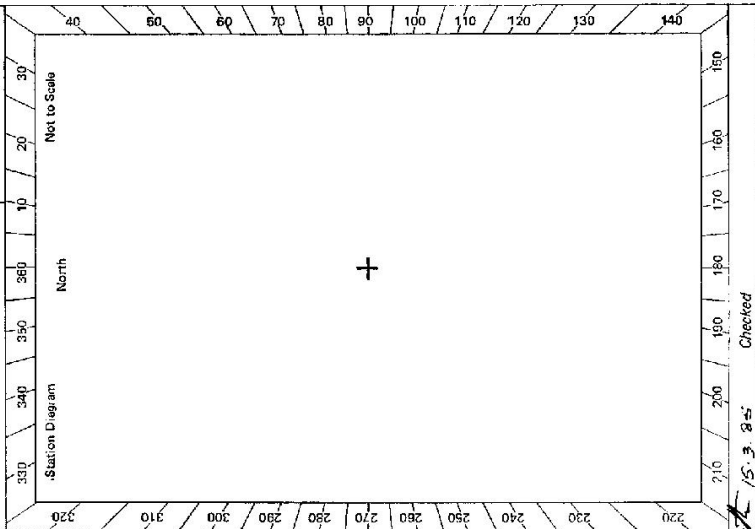

GS 24

STATION CONROY	TS 1573	Owner's Name: Address: Phone: Current Occupant: Address: Phone: ACCESS See Rankine Springs 8130-S Access Report of 15.2.1977 was found suitable/unsuitable.
Not to Scale <p style="text-align: center;">Distances are in Kilometres Diagram not to scale</p>		O-O Erigolia towards Yenda 11-6 R.H. turn up property track 12-9 Gate. Park truck & walk up slight hill to trig Cairn found, mast & vanes in disrepair 5 minute walk to trig Light clearing required
This section to be completed by officer constructing pillar. Original station mark found/not found.		Description of mark: Original beacon found/not found.
Description of beacon: Height Top of Vanes to Top Markm. Height of markm. above rock/conem. below G.L. Diameter of Vanesm. Height of Cairnm. Original Beacon has/has not been destroyed by me.		Date Record of Station

St 2733-2 D. West, Government Printer