

75-193

Department of Lands  
 Integrative Reconnaissance and Maintenance Report  
 Station: **CHICK (P)** TS **1469**  
 Co: **Northumberland** Ph: **Roxburgh**  
 Map Sheet: **Branxton 1:50 000** No:  
 Inspected by: **P. McBeath** Date: **6.7.76**  
 Authority: **I.S.D. N.C.L.E.** Field Book: **PPP328**  
 Beacon Diagram

Date	Record of Station

This Trig. Station has been:-  
 Note: Cross out word or words which do not apply

1. Completely cleared to permit 360° vision to surrounding Trigs. ✓  
 2. Cleared by ~~tones-bearing~~ from Trig. Mast  
 3. Trig. Mast & Vanes have been painted white & black respectively. ✓  
 4. The Trig. was unpiled/~~not-emptied~~, dimensions now being:  
 Description of mark: Concrete Pillar should be explicit, e.g. Steel plug, Brass plug, Bolt, Concrete Pillar  
 Height of mark: 1.28 m <sup>above</sup> ~~below~~ concrete 1.28 m <sup>above</sup> ~~below~~ G.L.  
 Height of Top Vanes to ~~Top Plate~~ Top pillar plate 1.95 m Diameter of Vanes (vertical) 0.75 m.  
 Height of Cairn: 1.28 m. Diameter of Cairn: 33/55 m.  
 Length of Mast: 2.06 m. (~~approximately not emptied~~)  
 5. A. S.S. Pin set in conc/~~rock~~ has been placed/fd 2.388 m, bearing 269 °M from Trig. Mast/pillar  
 6. A. Rod set in conc./soil has been placed/fd 5.34 m, bearing 101 °M from Trig. Mast/pillar  
 7. A. G.I.P. set in conc./soil has been placed/fd 2.093 m, bearing 176 °M from Trig. Mast/pillar  
 8. A. set in conc./rock has been placed/fd ..... m, bearing ..... °M from Trig. Mast/pillar  
 9. Connection: S.S. Pin to Rod : 7.832 m, bearing 96 °M  
 10. Connection: S.S. Pin to G.I.P. : 3.355 m, bearing 126 °M  
 11. Connection: ..... to ..... : ..... m, bearing ..... °M  
 12. Connection: ..... to ..... : ..... m, bearing ..... °M  
 13. Diff. Ht. Pillar Mast is 1.209 m <sup>above</sup> S.S. Pin  
 14. Diff. Ht. Pillar Plate is 1.552 m <sup>above</sup> Rod  
 15. Diff. Ht. Pillar Plate is 1.321 m <sup>above</sup> G.I.P.  
 16. Diff. Ht. Pillar Plate is ..... m <sup>above</sup> G.I.P.  
 Prepared by: APB Checked: Alan Burrows

STATION **CHICK (P)** TS 1469

Owners Name **located on Public Road.** Current Occupant

Address

Access **6-7-76**

Km. **Feature.**

0-0 **Vincent St and Main St Cornock. (Truned towards Bellbird)**

0-1 **Turn right Sign "Singleton"**

7-1 **Turn left Sign "Potolbin, Broke"**

8-15 **Trig is on R.H.S of Road at top of High Bank. (It is possible to drive up slope to Trig)**

**keys: By Loked drive vehicle.**

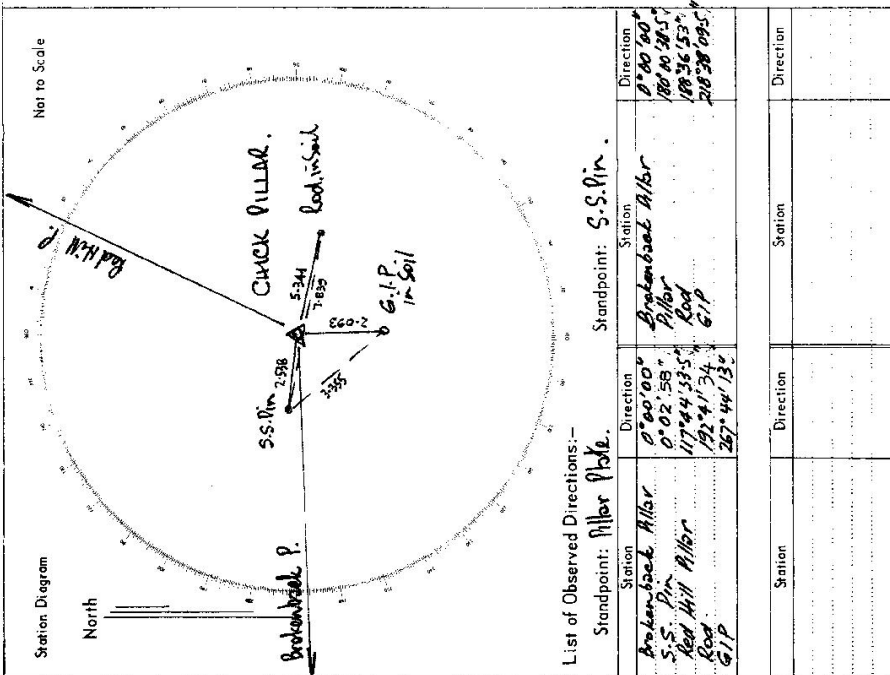

CENTRAL MAPPING AUTHORITY

GEODETIC SURVEY OF M.S.W.

GEODETIC STATION RECONNAISSANCE and MAINTENANCE REPORT

Description:

1. Cleared ~~by~~ 360 <sup>o</sup> ~~from~~ Trig. Mast Pillar.  
*Note: Cross out word or words which do not apply*
2. Mast & Vanes have been pairred white & black respectively.  Inspected, Mast & Vanes were repainted on 12 April 1979, dimensions now being: The station/pillar was 12 April 1979, dimensions now being: St. Steel Cap 310x300 were attached to pillar plate.  
Description of marks: St. Steel Cap should be explicit, e.g., S/Steel Pillar Plate, Steel plug, Brass plug, Bolt, G.I. Pipe
3. St. Steel Cap 310x300 were attached to pillar plate.  
Height of mark: 1.286 m. <sup>above</sup> concrete; <sup>below</sup> G.L.  
Height of Top Vanes to Top Mast/Pillar plate 1.958 m. Diameter of Vanes (vertical) 0.750 m.  
Height of Cairn: 2.060 m. Diameter of Cairn: 0.300 m. Name Plate found/replaced/placed,  
Length of Mast 2.060 m. (approximate if not measured) C.M.A. Geodetic Station,  
Chick T.S.
4. A set in conc/rock has been placed/found, bearing: 191.2 ° M from Mast/Plug/Pillar 1972
5. A set in conc/rock has been placed/found, bearing: 191.2 ° M from Mast/Plug/Pillar
6. A set in conc/rock has been placed/found, bearing: 191.2 ° M from Mast/Plug/Pillar
7. A set in conc/rock has been placed/found, bearing: 191.2 ° M from Mast/Plug/Pillar
8. Action required: None

STANDPOINT:

Mark	Direction	Horiz. Distance	Height Difference	Mark	Direction	Horiz. Distance	Height Difference
			above standpt				above standpt
			below				below
			above standpt				above standpt
			below				below
			above standpt				above standpt
			below				below
			above standpt				above standpt
			below				below
			above standpt				above standpt
			below				below

Prepared by: PKA Checked: PKA Noted on U.T.M. Card

SI 2738-1

STATION: CHICK (Pillar) No: 1469

MAP SHEET SCALE 1:250 000 SINGLETON

INSPECTED BY: D.F. Kain DATE: 12 April 1979

AUTHORITY: C.M.A. FIELD BOOK: 1673

Station Diagram
North
Not to Scale

STATION **CHICK (Pillar) TS 1469**

Owner's Name: .....  
 Address: .....  
 Phone: .....

Current Occupant: .....  
 Address: .....  
 Phone: .....

ACCESS  
 Access Report of **12.4.1978** was found suitable/unsuitable.

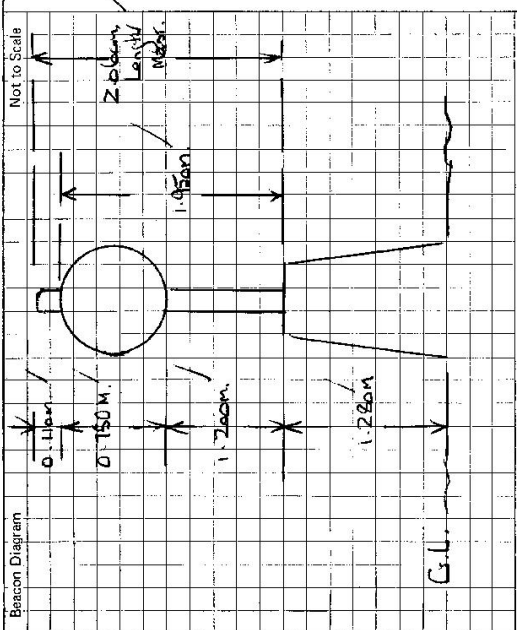

This section to be completed by officer constructing pillar.

Original station mark found/not found.

Description of mark: .....

Original beacon found/not found.

Description of beacon: .....

Height Top of Vane to Top Mark .....m.

Height of mark .....m. above rock/core .....m. below G.L.

Diameter of Vane .....m.

Original Beacon has/has not been destroyed by me.

Date	Record of Station

CENTRAL MAPPING AUTHORITY

GEODETTIC SURVEY OF N.S.W.

GEODETTIC STATION RECONNAISSANCE and MAINTENANCE REPORT

Description:

Note: Cross out word or words which do not apply

1. Cleared by lanes bearing..... from Trig. Mast
2. Mast & Vanes have been painted white & black respectively. **NEW MAST & VANES only**
3. The station/pillar was unpiled/not unpiled/constructed on.....<sup>above</sup>.....<sup>below</sup>.....<sup>19</sup>....., dimensions now being: Description of mark..... should be explicit, e.g., S/Steel Pillar Plate. Steel plug, Brass plug, Bolt, G.I. Pipe  
 Height of mark.....<sup>above</sup>.....<sup>below</sup>..... m. rock/concrete; Mark is.....<sup>above</sup>.....<sup>below</sup>..... m. G.L.  
 Height of Top Vanes to Top ~~Mast~~/Pillar plate **1.48**..... m. Diameter of Vanes (vertical) **0.75**..... m.  
 Height of Cairn..... m. Diameter of Cairn..... m. Name Plate found/not found/placed.  
 Length of Mast..... m. (approximate if not unpiled)
4. A..... set in conc./rock has been placed/found, bearing.....°M from Mast/Plug/Pillar
5. A..... set in conc./rock has been placed/found, bearing.....°M from Mast/Plug/Pillar
6. A..... set in conc./rock has been placed/found, bearing.....°M from Mast/Plug/Pillar
7. A..... set in conc./rock has been placed/found, bearing.....°M from Mast/Plug/Pillar
8. Action required:.....

STANDPOINT:

STANDPOINT:

Mark	Direction	Horiz. Distance	Height Difference	Mark	Direction	Horiz. Distance	Height Difference
			above standpt				above standpt
			below				below
			above standpt				above standpt
			below				below
			above standpt				above standpt
			below				below
			above standpt				above standpt
			below				below
			above standpt				above standpt
			below				below
			above standpt				above standpt
			below				below

Prepared by: **KJ**

Checked: **3-5-85**

Noted on U.T.M. Card **KJ**

STATION: **CHICK** No.: **169**

MAP SHEETS SCALE 1:250 000 **NEWCASTLE** SCALE 1:100 000 **CESSENDEN**

INSPECTED BY: **SCB (NEWCASTLE)** DATE: **28-3-85**

AUTHORITY: **CMA** FIELD BOOK:

Checked: **14/1 3/85**