

LOCALITY SKETCH PLAN



Local Government Area Eurobodalla Shire

Town/Suburb/Locality TURROSS HEADS CORS

Office Use - Barcode Including Number Inserted Here

Approx MGA Coordinate: Zone 56

Description of Mark Reference Mark 1#

E: 240717.8 By Bearings + Dist

240717.446

N: 6008332.6 From CORS GDA94

By Survey: 6008332.663

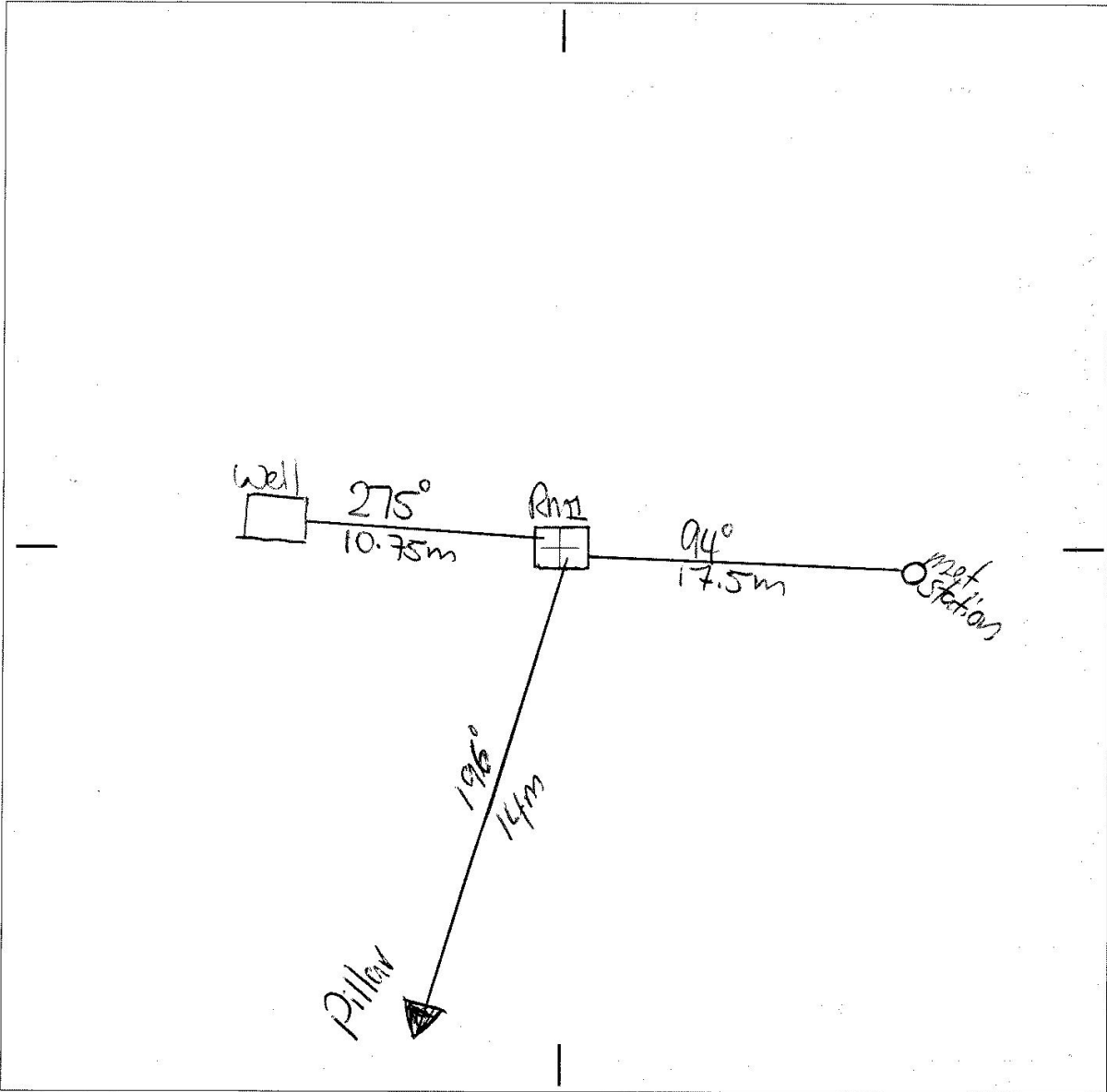

Please use black ink only

SURVEYING REGULATION			
MARK	AHD	SOURCE	DATE
		2344/61	
HEIGHT DETERMINED BY (Specify)		- DIFF. LEVELLING	
		- TRIG HEIGHTING	
ADOPTED MARKS		- GPS	

Measurements are in metres

~~PM~~ TS 12137-1

~~SS~~

PM

Replaces

SS

I certify that the mark has been placed/found and numbered as detailed hereon.

Signed: Tom Grinter

Name: Joel Haasdyk

Organisation placing mark: LPMA/LPI

Date mark placed/found: 11 14/11

Ref: _____

LOCALITY SKETCH PLAN



Local Government Area Eurobodalla Shire

Town/Suburb/Locality Turross Heads COPS

Office Use - Barcode Including Number Inserted Here

Approx MGA Coordinate: Zone 56

Description of Mark Reference Mark 2#

E: 240718.7 By Bearings Dist

240719.301

N: 6008305.7 From COPS GDA94 // By Survey: 6008306.165

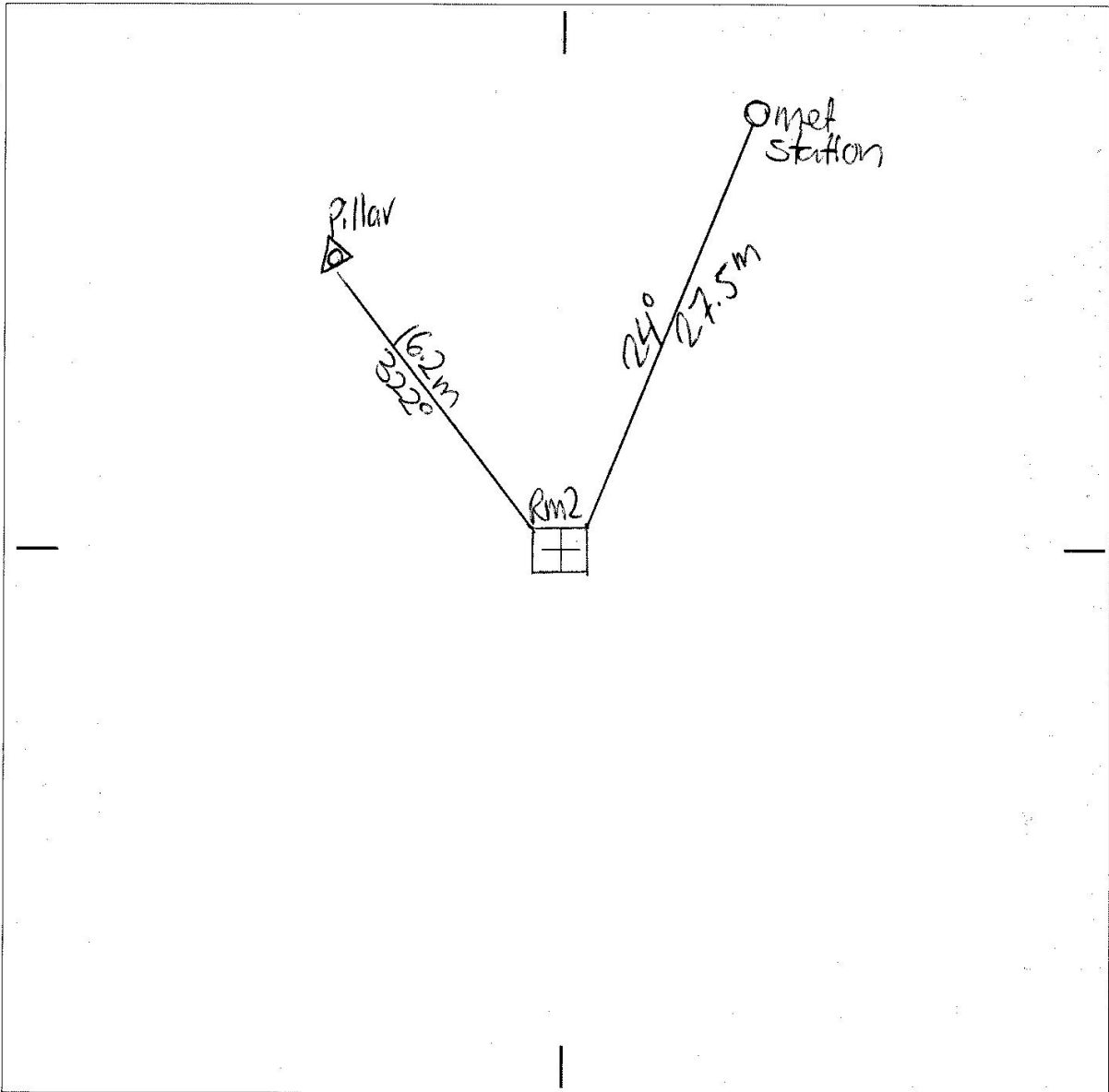

Please use black ink only

SURVEYING REGULATION			
MARK	AHD	SOURCE	DATE
		234461	
HEIGHT DETERMINED BY (Specify)		- DIFF. LEVELLING	
		- TRIG HEIGHTING	
ADOPTED MARKS		- GPS	

Measurements are in metres

~~PM~~ TS 12137-2

~~SS~~

PM
Replaces
SS

I certify that the mark has been placed/found and numbered as detailed hereon.

Signed: Tom Grinker +

Name: Joel Haasdyk

Organisation placing mark: LPMA / LPI

Date mark placed/found: 11 14 11

Ref:

LOCALITY SKETCH PLAN



Local Government Area Eurobodalla Shire

Town/Suburb/Locality TUVROSS HEADS CORRS

Office Use - Barcode Including Number Inserted Here

Approx MGA Coordinate: Zone 56

Description of Mark

Reference mark 3#

E: 240696.0 By Bearings + Dist

240696.079

N: 6008318.6 from CORRS ADA94

By Survey: 6008319.580

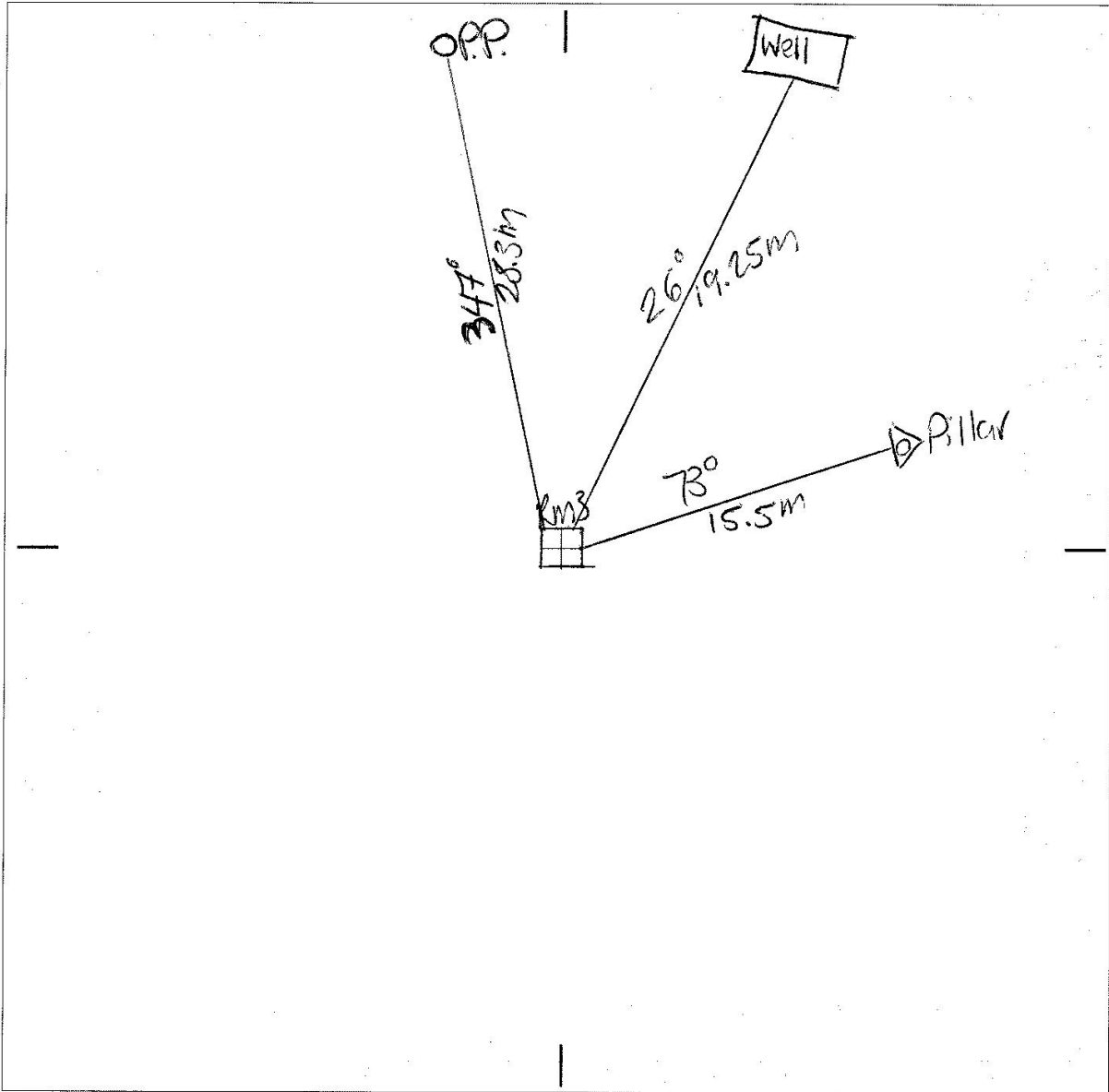

Please use black ink only

SURVEYING REGULATION			
MARK	AHD	SOURCE	DATE
		234461	
HEIGHT DETERMINED BY (Specify)		- DIFF. LEVELLING	
		- TRIG HEIGHTING	
ADOPTED MARKS		- GPS	

Measurements are in metres

~~PM~~ TS 12137-3

~~SS~~

PM

Replaces

SS

I certify that the mark has been placed/found and numbered as detailed hereon.

Signed: Tom Grinter + Joel Haasdyk

Name: Joel Haasdyk

Organisation placing mark: LPMA/LPI

Date mark placed/found: 11/4/11

Ref: _____