

CENTRAL MAPPING AUTHORITY

GEODETIC SURVEY OF N.S.W.

GEODETIC STATION RECONNAISSANCE and MAINTENANCE REPORT

Description:

1. Cleared by lanes bearing 3.9° 192° 2.20° 2.43° 307° 337° from Trig. Mast
Note: Cross out word or words which do not apply
2. Mast & Vanes have been painted white & black respectively.
3. The station/pillar was ~~unfilled~~/not unpiled/constructed on 19 dimensions now being:

Description of mark should be explicit, e.g., S/Steel Pillar Plate, Steel plug, Brass plug, Bolt, G.I. Pipe

Height of mark m. ^{above} _{below} rock/concrete; Mark is m. ^{above} _{below} G.L.

Height of Top Vanes to Top Mark/Pillar plate m. Diameter of Vanes (vertical) m.

Height of Cairn m. Diameter of Cairn m. Name Plate found/not found/placed.

Length of Mast m. (approximate if not unpiled)

4. A set in conc/rock has been placed/found, bearing M from Mast/Plug/Pillar
5. A set in conc/rock has been placed/found, bearing M from Mast/Plug/Pillar
6. A set in conc/rock has been placed/found, bearing M from Mast/Plug/Pillar
7. A set in conc/rock has been placed/found, bearing M from Mast/Plug/Pillar
8. Action required:

STANDPOINT:

Mark	Direction	Horiz. Distance	Height Difference	Mark	Direction	Horiz. Distance	Height Difference
			above standpt.				above standpt.
			below				below
			above standpt.				above standpt.
			below				below
			above standpt.				above standpt.
			below				below
			above standpt.				above standpt.
			below				below
			above standpt.				above standpt.
			below				below
			above standpt.				above standpt.
			below				below

Prepared by: *W. Miller* 201178

Checked: *W. Miller*

Noted on U.T.M. Card

SF 2733-1

Checked

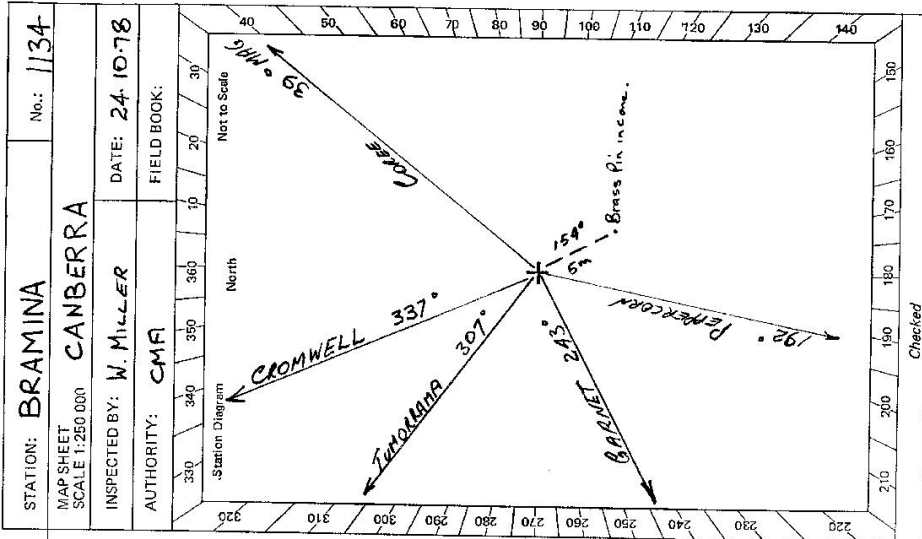

STATION: BRAMINA No.: 1134

MAP SHEET SCALE 1:250 000 CANBERRA

INSPECTED BY: W. MILLER DATE: 24.10.78

AUTHORITY: CMA FIELD BOOK:

STATION **BRAMINA** 1134

Owner's Name:
 Address:
 Phone:

Current Occupant:
 Address:
 Phone:

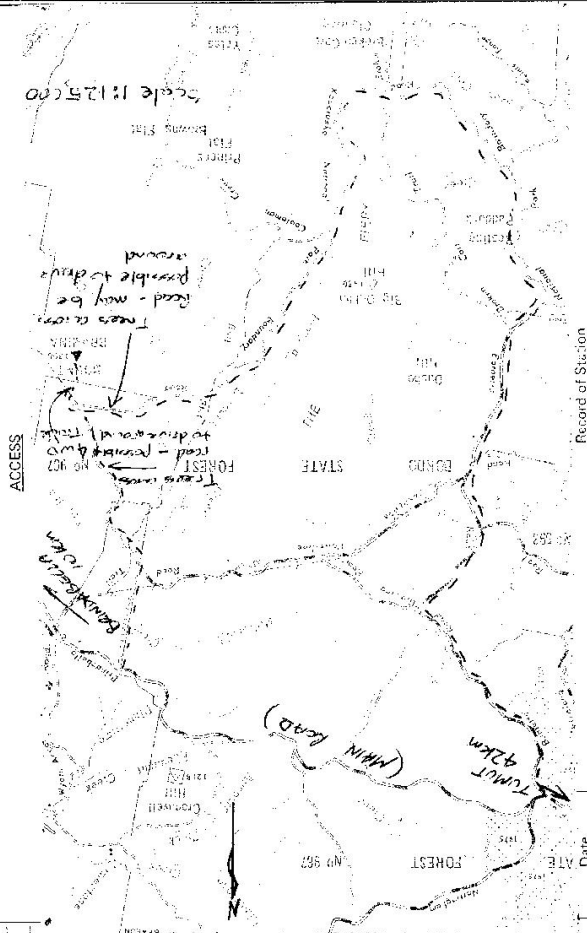

Date:
 Record of Station: 24.10.78 Digital station - extensive clearing has been done.

Sr. 2739-2 D. West. Government Printer

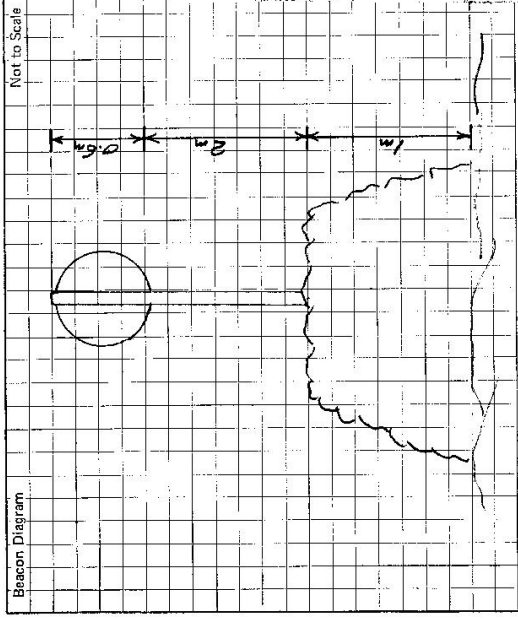

This section to be completed by officer constructing pillar.

Original station mark found/not found.

Description of mark:

Original beacon found/not found.

Description of beacon:

Height Top of Vanes to Top Mark.....m.

Height of mark.....m. above G.L. below

Diameter of Vanes.....m. Height of Cairn.....m.

Original Beacon has/not been destroyed by me.