

CENTRAL MAPPING AUTHORITY

GEODETIC SURVEY OF N.S.W.

GEODETIC STATION RECONNAISSANCE and MAINTENANCE REPORT

STATION: BOURKE No.: 1103

MAP SHEET SCALE 1:250 000 BOURKE

INSPECTED BY: I.W. Robins DATE: 23/2/81

AUTHORITY: C.M.A. FIELD BOOK: C00064

Description: *Note: Cross out word or words which do not apply*

1. Cleared by lanes bearing through natural breaks in trees *only* from Trig-Meet
2. Mast & Vanes have been painted white & black respectively No mast or vanes
3. The station/pillar was unspiled/not unspiled/constructed on 10 dimensions now being
- Description of mark should be explicit, e.g., S/Steel-Pillar-Plate; Steel plug; Bolt; G.I. Pipe
- Height of mark m above feet/centimetres Mark is above below G.L.
- Height of Top Vanes to Top Mark/Pillar-plate m Diameter of Vanes (vertical) m
- Height of Centre Not O.A.M. Diameter of Centre Brick ring Appt. 0.7m Other Name/Plate found/ret found/plate
- Length of Mast m (approximate if not unspiled)
4. A. ~~Brick~~ plug set in conc/rock has been placed/ found, bearing m from Mast/Plug/Pillar
5. A. set in conc/rock has been placed/ found, bearing m from Mast/Plug/Pillar
6. A. set in conc/rock has been placed/ found, bearing m from Mast/Plug/Pillar
7. A. set in conc/rock has been placed/ found, bearing m from Mast/Plug/Pillar

8. Action required: As station has historical value, it is on edge of ploughed paddock  
Some form of substantial cover should be provided for protection

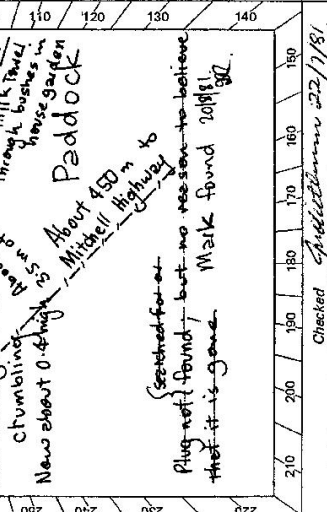

Mark	Direction	Horiz. Distance	Height Difference	Mark	Direction	Horiz. Distance	Height Difference
			above standpt.				above standpt.
			below standpt.				below standpt.
			above standpt.				above standpt.
			below standpt.				below standpt.
			above standpt.				above standpt.
			below standpt.				below standpt.
			above standpt.				above standpt.
			below standpt.				below standpt.
			above standpt.				above standpt.
			below standpt.				below standpt.

Prepared by: I.W. Robins 4/3/81 Checked: *[Signature]* 22/2/81  
 Noted on U.T.M. Card

St 2735 - 2 D. West. Government Printer

STATION **BOURKE 1103**

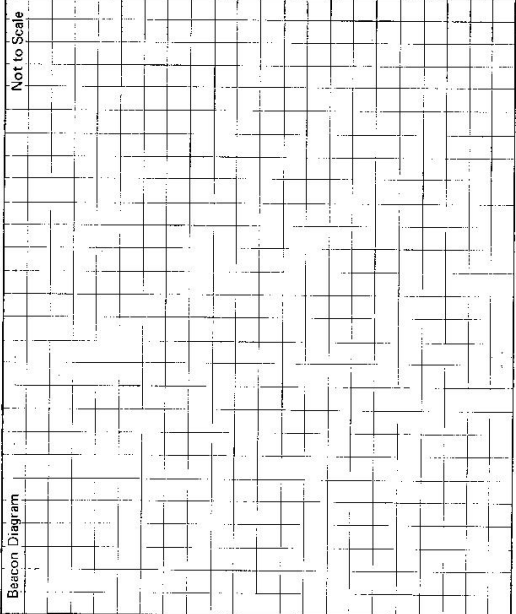

Owner's Name: **Mr. Venn Williams**  
 Address: **"River View"**  
**P.O. Box 156 Bourke**  
 (lites 100 m from station)  
 Phone: **Not on telephone**

Current Occupant:  
 Address:  
 Phone:

**ACCESS**

- km Access Report of 11/5/1983 was found ~~unsuitable~~ unsuitable.
- 00 Bourke P.O. head east along Oxley St
- 0.1 Turn left into Mitchell Highway & follow towards Connamulla
- 2.3 Just after crossing town levee bank turn left into gravel lane
- 2.6 Pass access to burners house on right. - see owner.
- 2.75 Turn right through gate into gravel & sand washing plant head northwards towards fence
- 2.9 BOURKE GS 3.5 m N side of fence in ploughed paddock

This section to be completed by officer constructing pillar.

Original station mark found/not found.

Description of mark: .....

Original beacon found/not found.

Description of beacon: .....

Height Top of Vanes to Top Mark ..... m.

Height of mark ..... m. above G.L. below

Diameter of Vanes ..... m.

Height of Cairn ..... m.

Original Beacon has/has not been destroyed by me.

Date	Record of Station
Jan 87	See also Control Diagram in BOURKE 8037
20 Aug 81	Visited. Mark found & connected to 1:4000 Control. W. Robins CMA

Bourke

LAND INFORMATION CENTRE

GEODETIC SURVEY OF N.S.W.

GEODETIC STATION RECONNAISSANCE and MAINTENANCE REPORT

STATION: **BOURKE** No.: **1103**

MAP SHEET SCALE 1:250 000 **BOURKE**

INSPECTED BY: **G. FORD** DATE: **4/12/91**

AUTHORITY: **L.I.C.** FIELD BOOK: **C609**

- Description: *Note: Cross out word or words which do not apply*
- Cleared by lines bearing... **THROUGH NATURAL BREAKS IN TREES ONLY** from Trig-Mast
  - Mast & Vanes have been painted white & black respectively. **NO MAST OR VANES**
  - The station/pillar was unpiled/not unpiled/constructed on... **19**....., dimensions now being: **BRONZE PLUG AT BOTTOM OF WELL UNDER COVER BOX**  
Description of mark.....should be explicit, e.g., S/Steel-Pillar-Plate, Steel-plug, Brass plug, Bolt, G.I. Pipe  
Height of mark.....m. above rock/concrete; Mark is **0.35**.....m. ~~above~~ below G.L.  
Height of Top Vanes to Top Mark/Pillar-plate .....m. Diameter of Vanes (vertical).....m.  
Height of Centre **BRICK RING ABT 0.2**.....m. Diameter of Centre **BRICK RING ABT 0.9**.....m. ~~Dim.~~ Name-Plate found/not-found/placed.  
Length of Mast .....m. (approximate if not-unpiled)
  - A. BRONZE PLUG**.....set in conc/rock has been placed/round, bearing.....°M from Mast/Plug/Pillar
  - A. STAR PICKET (1) (UNDER COVER BOX)**.....set in conc/rock has been placed/round, bearing **128**°M from Mast/Plug/Pillar
  - A. STAR PICKET (2) (UNDER COVER BOX)**.....set in conc/rock has been placed/round, bearing **212**°M from Mast/Plug/Pillar
  - A.....set in conc/rock has been placed/round, bearing.....°M from Mast/Plug/Pillar
  - Action required:.....

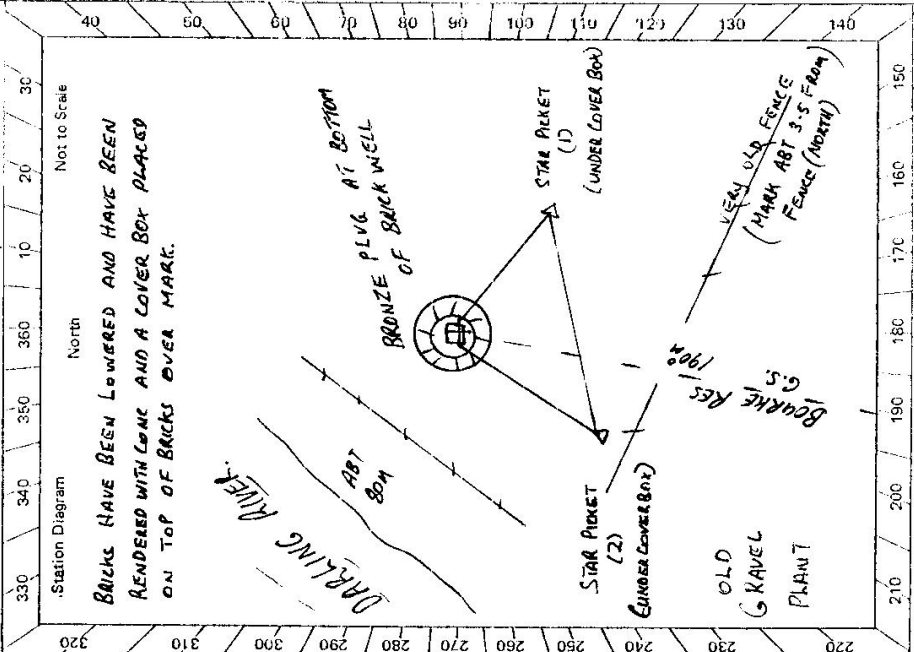

STANDPOINT: TRIG PLUG.		STANDPOINT: STAR PICKET (1)					
Mark	Direction	Horiz. Distance	Height Difference	Mark	Direction	Horiz. Distance	Height Difference
BOURKE RES	0 00 00		above standpt.	BOURKE RES	0 00 00		above standpt.
STAR PICKET (2)	24 20 10	3.050	above standpt. 0.379	STAR PICKET (2)	64 20 50	3.645	above standpt. 0.137
STAR PICKET (1)	300 51 40	2.366	above standpt. 0.241	TRIG PLUG.	120 43 40	2.369	above standpt. 0.245
			below standpt.				below standpt.
			above standpt.				above standpt.
			below standpt.				below standpt.
			above standpt.				above standpt.
			below standpt.				below standpt.

Prepared by: **G Ford 11/12/91** Noted on U.T.M. Card  
Checked: \_\_\_\_\_

5: 2733-2 D, West, Government Printer

STATION **BOURKE** 1103

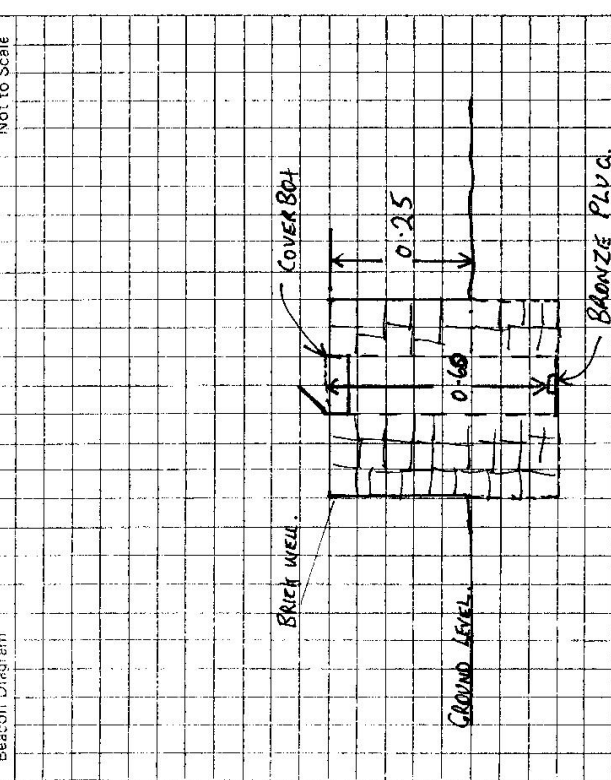

Owner's Name: **Mr. Venn Williams**  
 Address: **"Riverview"**  
**P.O. Box 156 Bourke**  
 Phone: **MO. ON PLANE**  
**(LIVES 100m FROM STATION)**  
 ACCESS  
 Access Report of **4.12.1991** was found suitable/unsuitable.

- MM**
- 0-0 BOURKE P.O. HEAD EAST ALONG OXLEY ST
  - 0-1 TURN LEFT INTO MITCHELL HIGHWAY & FOLLOW TOWARDS CUNNAMULLA
  - 2-3 JUST AFTER CROSSING TOWN LEVEE BANK TURN LEFT INTO GRAVEL LAKE
  - 2-6 PASS ACCESS TO OWNERS HOUSE ON RIGHT - SEE OWNER.
  - 2-75 TURN RIGHT THROUGH GATE INTO GRAVEL x SAND WASHING PLANT  
 HEAD NORTHWARDS TOWARDS FENCE
  - 2-9 BOURKE C.S. 3.5m N SIDE OF FENCE IN LUCEANE/ PLOUGHED  
 Paddock.

This section to be completed by officer constructing pillar.

Original station mark found/not found. ....

Description of mark: .....

Original beacon found/not found. ....

Description of beacon: .....

Height Top of Vanes to Top Mark .....m.

Height of mark .....m. above G.L., below

Diameter of Vanes .....m. Height of Cairn .....m.

Original Beacon has/has not been destroyed by me.

Date	Record of Station