

76 of 9

Department of Lands	Integration Survey of N.S.W.	RECONNAISSANCE and MAINTENANCE REPORT 2851	STATION <b>LINDEN (P)</b>	TS <b>2891</b>
This Trig. Station has been:-	Co: <b>C&amp;OK</b> Ph: <b>MAGDALA</b>			
1. Completely cleared to permit 360° vision to surrounding Trigs.	Map Sheet:			
2. <del>Cleared by James bearing</del>	Inspected by: <b>C. NI STARKEY</b> Date: <b>13/6/75</b>			
3. Trig. Mast & Vanes have been painted white & black respectively.	Authority Dept <b>Lands</b> Field Book: <b>Central 280</b>			

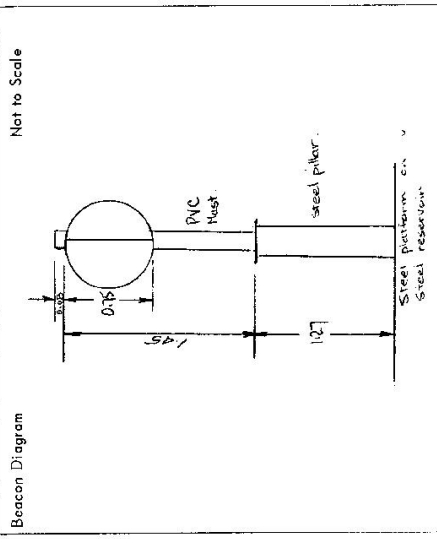

Note: Cross out word or words which do not apply

1. Completely cleared to permit 360° vision to surrounding Trigs.
2. ~~Cleared by James bearing~~ ..... from Trig. Mast
3. Trig. Mast & Vanes have been painted white & black respectively.
4. The Trig. was unpiled/~~not emptied~~, dimensions now being:  
Description of mark: **Steel pillar on steel reservoir** ..... should be explicit, e.g. Steel plug, Brass plug, Bolt, Concrete Pillar  
Height of mark: ~~1.27~~ m <sup>above platform</sup> / ~~rock/concrete~~ <sub>below</sub> ..... m above/below G.L.
- Height of Top Vanes to ~~Top Mark~~/**Top pillar plate** ..... **1.45** m Diameter of Vanes (vertical) **0.15** m.  
Height of ~~Centre~~ ..... m. Diameter of ~~Centre~~ ..... m.
- Length of Mast ..... **1.53** m. (approximate if not unpiled)
5. A ..... set in conc./rock has been placed/~~fd~~ ..... m. bearing ..... °M from Trig. Mast/pillar
6. A ..... set in conc./soil has been placed/~~fd~~ ..... m. bearing ..... °M from Trig. Mast/pillar
7. A ..... set in conc./soil has been placed/~~fd~~ ..... m. bearing ..... °M from Trig. Mast/pillar
8. A ..... set in conc./rock has been placed/~~fd~~ ..... m. bearing ..... °M from Trig. Mast/pillar
9. Connection ..... to ..... m. bearing ..... °M
10. Connection ..... to ..... m. bearing ..... °M
11. Connection ..... to ..... m. bearing ..... °M
12. Connection ..... to ..... m. bearing ..... °M
13. Diff. Ht. .... is ..... m. <sup>above</sup>/<sub>below</sub> .....
14. Diff. Ht. .... is ..... m. <sup>above</sup>/<sub>below</sub> .....
15. Diff. Ht. .... is ..... m. <sup>above</sup>/<sub>below</sub> .....
16. Diff. Ht. .... is ..... m. <sup>above</sup>/<sub>below</sub> .....

Date	Record of Station

Prepared by: **STARKEY** Checked: **S**

STATION LINDEN (P) TS 2851

Owners Name..... Current Occupant.....

Address..... Address.....

Access  
 On steel reservoir.  
 On Great Western Highway just east of Linden railway station.

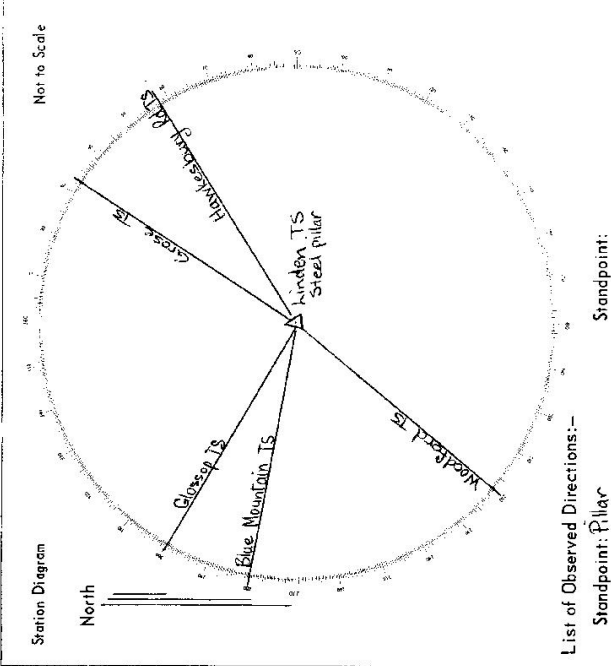

List of Observed Directions:-

Standpoint: Pillar		Standpoint:	
Station	Direction	Station	Direction
Blue Mt TS	0° 00' 00"		
Grosse TS	21° 58' 28.5"		
Grosse TS	113° 49' 11.5"		
Hankesbury Rd TS	137° 44' 43.2"		
Woodford TS	303° 03' 18.3"		
Station	Direction	Station	Direction

RECONNAISSANCE and MAINTENANCE REPORT

74-98

STATION **LINDEN RES O.P. 2851**

Co: **COOK** Ph: **MAGDALA**

Map Sheet: **SPRINGWOOD** No: **9030-IV-S**

Inspected by: **ALAN DICKSON** Date: **2nd AUGUST 1971**

Authority: **C.M.H.** Field Book: **AB 1586**

Beacon Diagram Not to Scale

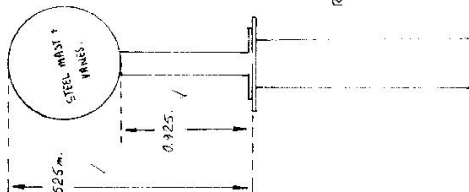

Note: Cross out word or words which do not apply

This Trig. Station has been:-

1. Completely cleared to permit 360° vision to surrounding Trigs.
2. Cleared by lanes bearing ..... from Trig. Mast
3. Trig. Mast & Vanes have been painted white & black respectively.
4. The Trig. was unpiled/not unpiled, dimensions now being: Original Station Mark found in .....

Description of mark..... should be explicit, e.g. Steel plug, Brass plug, Bolt, G.I. Pipe

Height of mark..... m above rock/concrete m below G.L.  
 Height of Top Vanes to Top Mark..... m. Diameter of Vanes (vertical)..... m.  
 Height of Cairn..... m. Diameter of Cairn..... m.

5. A..... set in conc/rock has been placed..... m. bearing.....°M from Trig. Mast
6. A..... set in conc/soil has been placed..... m. bearing.....°M from Trig. Mast
7. A..... set in conc/soil has been placed..... m. bearing.....°M from Trig. Mast
8. A..... set in conc/rock has been placed..... m. bearing.....°M from Trig. Mast

9. Connection..... to..... m. bearing.....°M
10. Connection..... to..... m. bearing.....°M
11. Connection..... to..... m. bearing.....°M
12. Connection..... to..... m. bearing.....°M
13. Diff. Ht. .... is..... m. above below
14. Diff. Ht. .... is..... m. above below
15. Diff. Ht. .... is..... m. above below
16. Diff. Ht. .... is..... m. above below

Prepared by: **ALAN DICKSON 11-8-77** Checked: **[Signature]** Noted on U.T.M. Card

Date	Record of Station

Checked

GEODETIC SURVEY OF N.S.W.

CENTRAL MAPPING AUTHORITY

GEODETIC STATION RECONNAISSANCE and MAINTENANCE REPORT

STATION: **LINDEN** No: **2857**  
 MAP SHEETS SCALE 1:250 000 **SYDNEY** SCALE 1:100 000 **PENRITH**  
 INSPECTED BY: **K HADDOON** DATE: **12-12-84**  
 AUTHORITY: **CMA** FIELD BOOK: **C 376**

- Description: *Note: Cross out word or words which do not apply*
- Cleared by lanes bearing..... from Trig. Mast
  - Mast & Vanes have been painted white & black respectively.
  - The station/pillar was unpiled/not unpiled/constructed on.....<sup>19</sup>....., dimensions now being: Description of mark.....should be explicit, e.g., S/Steel Pillar Plate, Steel plug, Brass plug, Bolt, G.I. Pipe  
 Height of mark.....m. above below rock/concrete; Mark is.....m. above G.L.  
 Height of Top Vanes to Top Mark/Pillar plate.....m. Diameter of Vanes (vertical).....m.  
 Height of Cairn.....m. Diameter of Cairn.....m. Name Plate found/~~not found~~/placed.
  - Length of Mast.....m. (approximate if not unpiled)
  - A. **PM 54488**.....set in ~~concrete~~ <sup>rock</sup> has been placed/~~found~~, bearing.....<sup>323</sup>°M from ~~Mast/Pillar~~ Pillar
  - A. **Cu Nail**.....set in ~~conc~~ <sup>rock</sup> has been placed/~~found~~, bearing.....<sup>13</sup>°M from ~~Mast/Pillar~~ Pillar
  - A.....set in conc/rock has been placed/~~found~~, bearing.....°M from Mast/Plug/Pillar
  - A.....set in conc/rock has been placed/~~found~~, bearing.....°M from Mast/Plug/Pillar

Action required:.....

STANDPOINT: **Pillar Plate**

Mark	Direction	Horiz. Distance	Height Difference	Mark	Direction	Horiz. Distance	Height Difference
Falcon bridge (P)	0° 0' 00"		above standpt.	Falcon bridge (P)	69° 33' 47"		above standpt.
Howkesby Road (P)	23° 22' 21.2"		above standpt.	Linden (P)	227° 29' 19"	28.694	172.85
PM 54488	29° 14' 43.0"	33.748	below standpt.	PM 54488	303° 51' 53"	25.768	c. 0.03
Cu Nail in rock	338° 08' 16.0"	28.700	below standpt.	STANDPOINT: PM 54488			
			above standpt.	Cu Nail in rock	140° 26' 38"	25.762	0.002
			below standpt.	Linden (P)	19° 10' 01"	33.747	172.84

Prepared by: **K HADDOON**

Checked: **1/8/85**

Notes on U.T.M. Card **1/8/85**

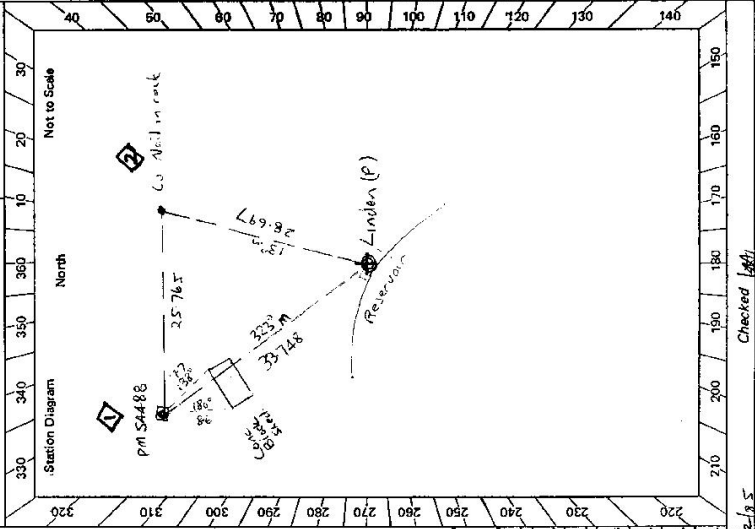

Checked: **1/8/85**

SR 2133-2 D. West, Government Printer

STATION LINDEN TS 2851

Beacon Diagram Not to Scale

Owner's Name: M. W. S. D.B.  
 Address: .....  
 Phone: .....  
 Current Occupant: .....  
 Address: .....  
 Phone: .....

**ACCESS**

Access Report of ~~1961/62~~ 1988 was found suitable/unsuitable.

- 0.0 Pedestrian crossing on Great Western Highway at Faulconbridge Railway Station. Head west along G.W.Hwy.
- 1.3 Electricity Sub-station on left.
- 2.4 Cross railway
- 3.2 Turn left off highway, head up hill towards Reservoir.
- 3.3 G.S on reservoir.

This section to be completed by officer constructing pillar.

Original station mark found/not found.

Description of mark: .....

Original beacon found/not found.

Description of beacon: .....

Height Top of Vanes to Top Mark.....m.  
 above rock/conc.....m. above G.L.  
 below .....m. below .....m.

Diameter of Vanes .....m. Height of Cairn .....m.

Original Beacon has/has not been destroyed by me.

Date	Record of Station

CENTRAL MAPPING AUTHORITY

Trigonometrical Survey of N.S.W.

Department of Lands

RECON: ISSANCE and MAINTENANCE REPORT

This Trig. Station has been:

Note: Cross out word or words which do not apply

1. Completely cleared to permit 360° vision to surrounding Trigs.
  2. Cleared by lanes bearing..... from Trig. Mast
  3. Trig. Mast & Vanes have been painted white & black respectively.
  4. The Trig. was unpiled/not unpiled, dimensions now being: **NEW STATION**  
Original Station Mark found not in place
- Description of mark: **Steel Pile** should be explicit, e.g. Steel plug, Brass plug, Bolt, G. I. Pipe
- Height of mark: **1.34** m above ~~ground~~ **concrete platform** m above ~~below~~ G.L.
- Height of Top Vanes to Top Mark: **1.53** m. Diameter of Vanes (vertical)..... m.
- Height of Cairn..... m. Diameter of Cairn..... m.

5. A..... set in conc/rock has been placed..... m. bearing.....°M from Trig. Mast
6. A..... set in conc/soil has been placed..... m. bearing.....°M from Trig. Mast
7. A..... set in conc/soil has been placed..... m. bearing.....°M from Trig. Mast
8. A..... set in conc/rock has been placed..... m. bearing.....°M from Trig. Mast
9. Connection..... to..... m. bearing.....°M
10. Connection..... to..... m. bearing.....°M
11. Connection..... to..... m. bearing.....°M
12. Connection..... to..... m. bearing.....°M
13. Diff. Ht. **Top of pile** is **35.53** m. ~~above~~ **SSM 383**
14. Diff. Ht. is..... m. ~~above~~ ~~below~~
15. Diff. Ht. is..... m. ~~above~~ ~~below~~
16. Diff. Ht. is..... m. ~~above~~ ~~below~~

Prepared by:

Checked:

Noted on U.T.M. Card

Checked

STATION: **15 10912** **383** **RET 383**

Co: **COOK** | Map Sheet: **10912** | No: **383**  
 Inspected by: **W. PITTENDEN** | Authority: **WATER BOARD** | Date: **June 89**  
 Field Book: **86 7104**

Bacon Diagram Not to Scale

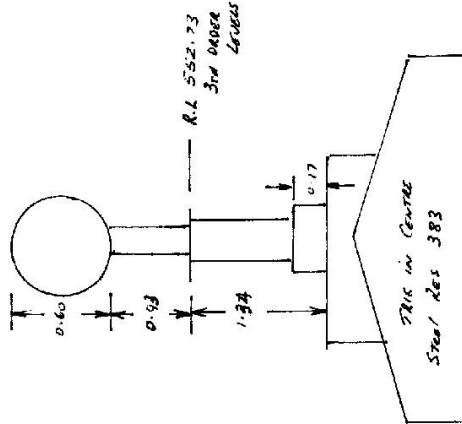

Date

Record of Station

T 2851 10912 STATION LINDEN (P) 1600 Centre RES 213

Owners Name: M.I.S.E.P. S Current Occupant: M.I.S.E.P.S

Address: .....

Access June 1989  
Adjacent Great Western HWY AT Linden.  
Key required for access to top of Fibre.

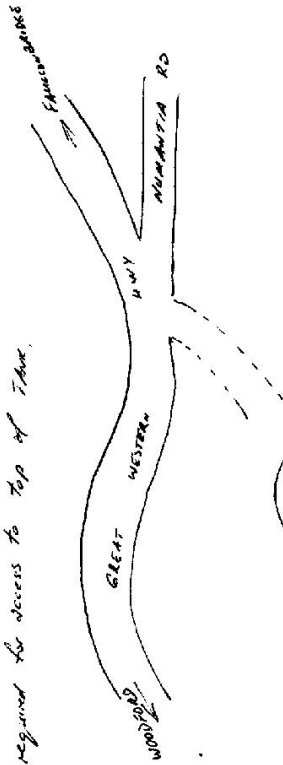

Replaces TS on side of reservoir

Station Diagram Not to Scale

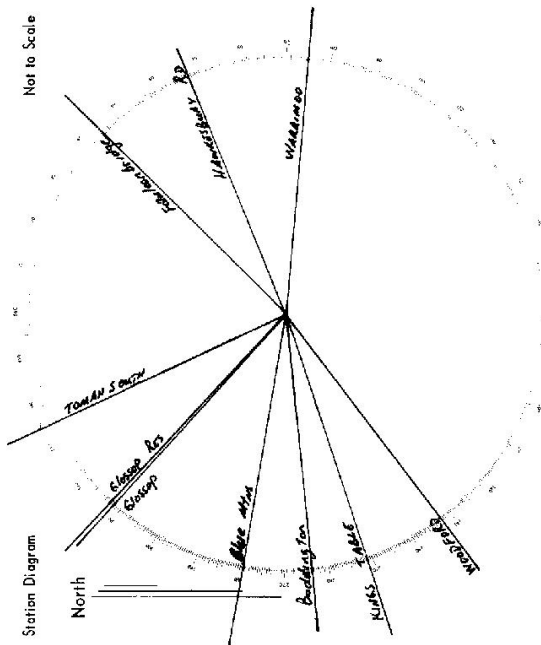

List of Observed Directions:-

Station	Direction	Station	Direction
TS 581	258.17.00	TS 495	324.25.07
TS 578	263.59.04	TS 205	44.01.05
TS 998	289.33.22	TS 246	67.10.19
TS 10407	311.21.57	TS 463	94.51.38
TS 10892	312.33.29	TS 4818	232.31.08

Station	Direction	Station	Direction

CENTRAL MAPPING AUTHORITY

Trigonometrical Survey of N.S.W.

Department of Lands

RECON, ISSANCE and MAINTENANCE REPORT

STATION

2851 *TS 10912*  
*London* *RET 383*

7-4-98

This Trig. Station has been:-

Note: Cross out word or words which do not apply

1. Completely cleared to permit 360° vision to surrounding Trigs.

2. Cleared by lanes bearing..... from Trig. Mast

3. Trig. Mast & Vanes have been painted white & black respectively.

4. The Trig. was unplied/~~not unplied~~, dimensions now being: *NEW STATION*

Description of mark: *Steel Pillar* should be explicit, e.g. Steel plug; Brass plug; Bolt, G.I. Pipe

Height of mark: *1.34* m above ~~1.53~~ m below *concrete platform* G.L.

Height of Top Vanes to Top Mark: *1.53* m. Diameter of Vanes (vertical)..... m.

Height of Cairn..... m. Diameter of Cairn..... m.

Length of Mast..... m. (approximate if not unplied)

5. A..... set in conc/rock has been placed..... m. bearing..... °M from Trig. Mast
6. A..... set in conc/soil has been placed..... m. bearing..... °M from Trig. Mast
7. A..... set in conc/soil has been placed..... m. bearing..... °M from Trig. Mast
8. A..... set in conc/rock has been placed..... m. bearing..... °M from Trig. Mast
9. Connection..... to..... m. bearing..... °M
10. Connection..... to..... m. bearing..... °M
11. Connection..... to..... m. bearing..... °M
12. Connection..... to..... m. bearing..... °M
13. Diff. Ht. *Top of Pillar*..... m. above *55.91* m. above *53.3* m. above *53.3* m. above
14. Diff. Ht. .... m. above below
15. Diff. Ht. .... m. above below
16. Diff. Ht. .... m. above below

Prepared by:

Checked:

Noted on U.T.M. Card

Co: *GOX*

Map Sheet:

Inspected by: *V. PITTENDRICH*

Authority: *Water & Gas*

Date: *24 Nov 89*

Field Book: *No 7002*

Beacon Diagram

Not to Scale

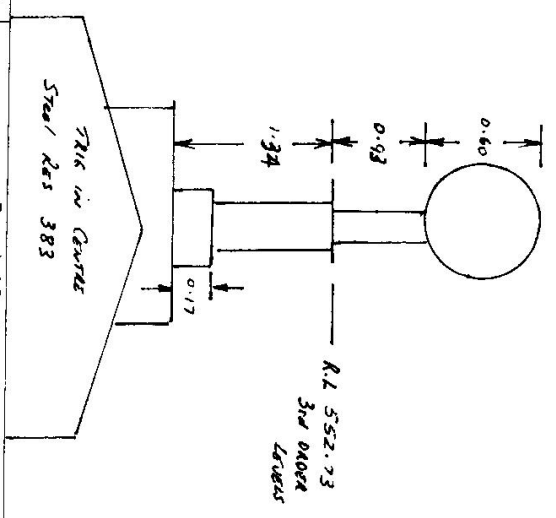

Date

Record of Station

Date	Record of Station

Checked



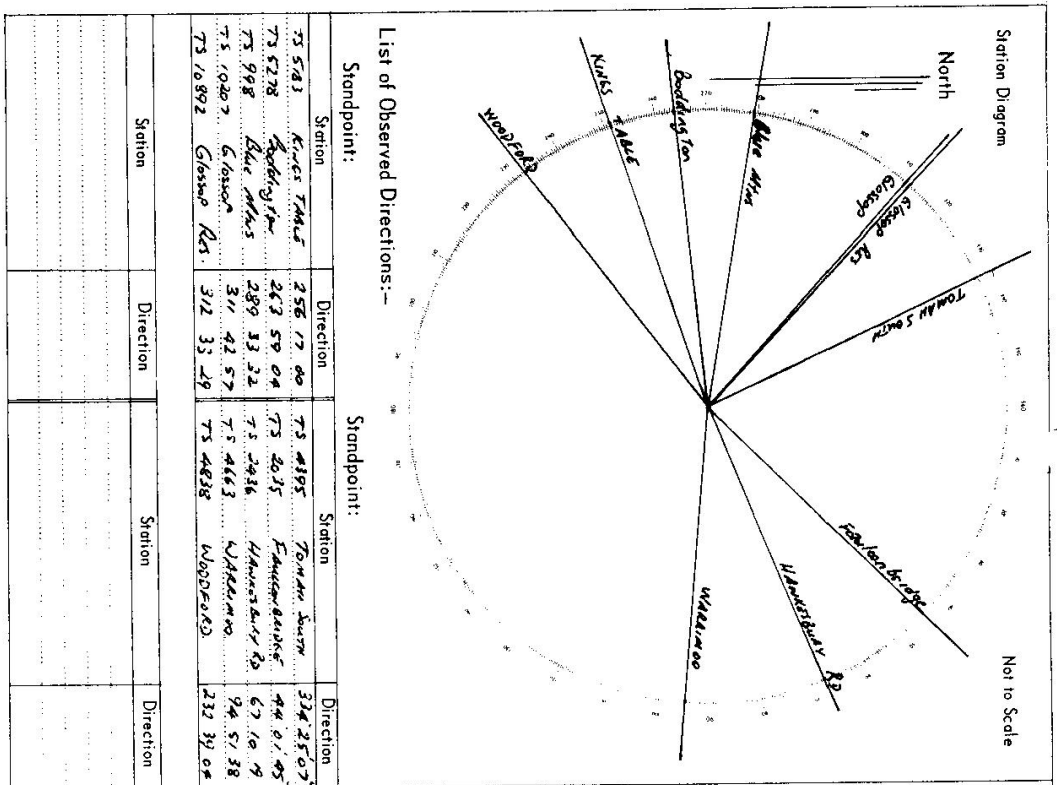

STATION 285/10912 LINDEN (P) No. Corner Res 383

Owners Name: MUSEL D Current Occupant: MUSEL D

Address: \_\_\_\_\_ Address: \_\_\_\_\_

Access: June 1989  
Adjacent Great Western Hwy at Linden.  
Key required for access to top of tank.

WOODBARK

GREAT WESTERN

Hwy

MUMFORD RD

STATION

Linden Res #383

Replaces TS on side of reservoir

CENTRAL MAPPING AUTHORITY

Trigonometrical Survey of N.S.W.

Department of Lands

RECON, ISSANCE and MAINTENANCE REPORT

STATION

TS 10912  
2851 Linden  
RET 383

7-4-98

This Trig. Station has been:-

Note: Cross out word or words which do not apply

1. Completely cleared to permit 360° vision to surrounding Trigs.

2. Cleared by lanes bearing..... from Trig. Mast

3. Trig. Mast & Vanes have been painted white & black respectively.

4. The Trig. was unplied/~~not unplied~~, dimensions now being: **NEW STATION** should be explicit, e.g. Steel plug, Brass plug, Bolt, G.I. Pipe

Description of mark: **Steel Pillar**

Height of mark: 1.34 m above ~~reference~~ **concrete platform** m above G.L.

Height of Top Vanes to Top Mark: 1.53 m. Diameter of Vanes (vertical)..... m.

Height of Cairn..... m. Diameter of Cairn..... m.

Length of Mast..... m. (approximate if not unplied)

- 5. A. set in conc/rock has been placed..... m. bearing..... °M from Trig. Mast
- 6. A. set in conc/soil has been placed..... m. bearing..... °M from Trig. Mast
- 7. A. set in conc/soil has been placed..... m. bearing..... °M from Trig. Mast
- 8. A. set in conc/rock has been placed..... m. bearing..... °M from Trig. Mast
- 9. Connection..... to..... m. bearing..... °M
- 10. Connection..... to..... m. bearing..... °M
- 11. Connection..... to..... m. bearing..... °M
- 12. Connection..... to..... m. bearing..... °M
- 13. Diff. Ht. **Top of Pillar**..... m. above **55.91 m 383**
- 14. Diff. Ht. .... m. above/below
- 15. Diff. Ht. .... m. above/below
- 16. Diff. Ht. .... m. above/below

Prepared by:

Checked:

Noted on U.T.M. Card

Co:	GOK	Ph:	MacRae
Map Sheet:		No:	
Inspected by:	V. PITTENDRICH	Date:	24 Nov 89
Authority:	Water & Land	Field Book:	AG 7002
Beacon Diagram	Not to Scale		

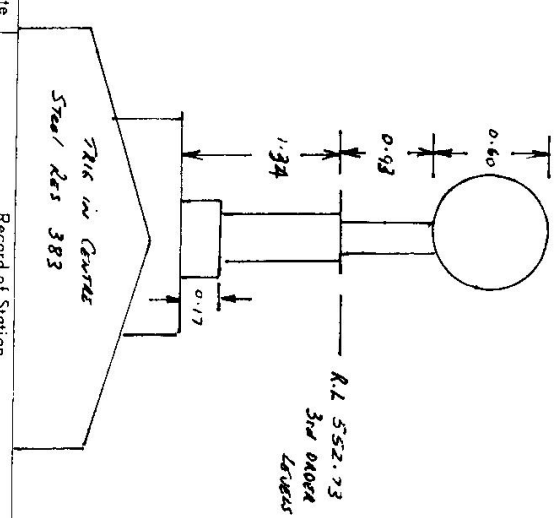

Date	Record of Station

Checked

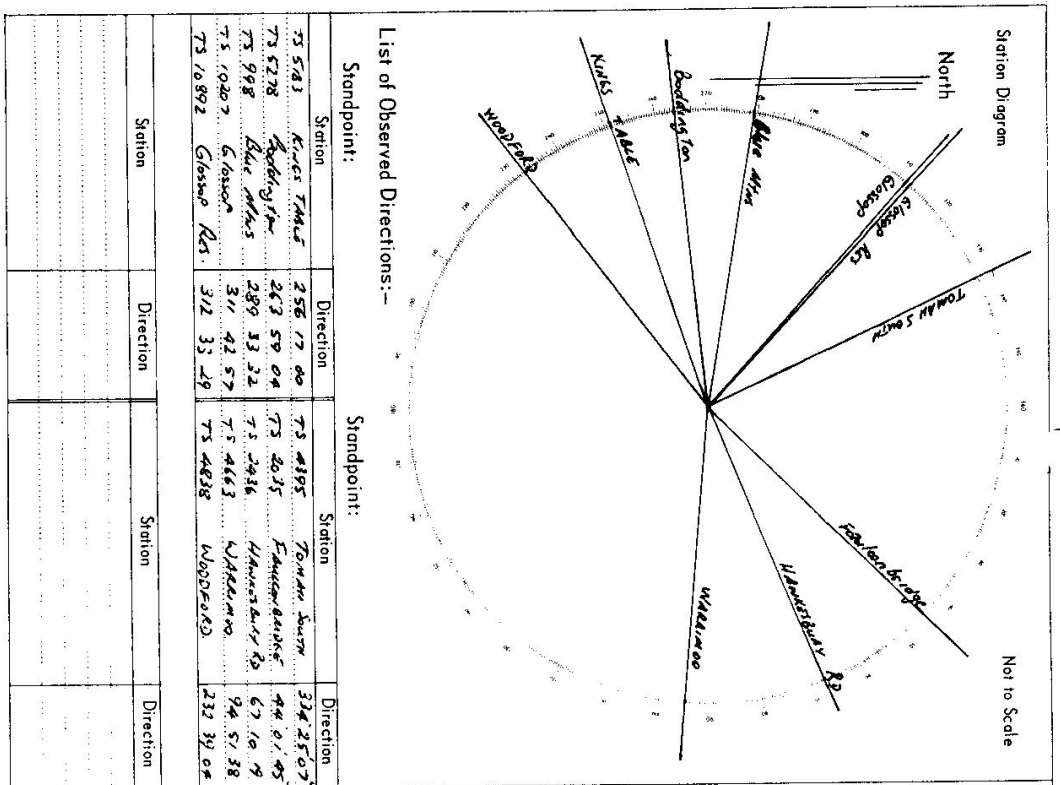

STATION 285/10912 LINDEN (P) No. Corner Res 383

Owners Name: MUSEL D Current Occupant: MUSEL D

Address: ..... Address: .....

Access: June 1989  
Adjacent Great Western Hwy at Linden.  
Key required for access to top of tank.

Great Western Hwy  
Linden Res #383  
Numbata Rd  
Woodpark

Replaces TS on side of reservoir