

CAS 7236

CENTRAL MAPING AUTHORITY

GEODETTIC SURVEY OF N.S.W.

GEODETTIC STATION RECONNAISSANCE and MAINTENANCE REPORT

Description:

1. Cleared by lanes bearing 350° Note: Cross out word or words which do not apply from Trig. Mast

2. Mast & Vanes have been painted white & black respectively.

3. The station/pillar was ~~re-erected~~ ~~re-constructed~~ on 20 MAX. 19.85, dimensions now being: Steel Plate

Description of mark/s TS Henry Werner should be explicit, e.g., S/Steel Pillar Plate, Steel plug, Brass plug, Bolt, G.I. Pipe

Height of mark 1.40 m. above ~~below~~ rock/concrete Mark is 1.50 m. above G.L.

Height of Top Vanes to Top Mark/Pillar plate 1.41 m. Diameter of Vanes (vertical) 0.00 m.

Height of Cairn 0.00 m. Diameter of Cairn 0.00 m. Name Plate found/lost/formed/placed.

Length of Mast 1.50 m. (approximate if not supplied)

4. A Brass Rod set in concrete has been placed/found, bearing 170° from Horizontal/Pillar

5. A Copper Spike set in concrete has been placed/found, bearing 283° from Horizontal/Pillar

6. A TS APsley set in concrete has been placed/found, bearing 170° from Mast/Plug/Pillar

7. A TS WELLESLEY set in concrete has been placed/found, bearing 283° from Mast/Plug/Pillar

8. Action required: See Form SAAG/01 for station summary

STANDPOINT: CONC PILLAR Copper Spike found

Mark	Direction	Horiz. Distance	Height Difference	Mark	Direction	Horiz. Distance	Height Difference
TS WELLESLEY (P)	30 00 00		above standpt.	Wellington Plug	0 00 00		below standpt.
TS APsley (P)	170 09 23		above standpt.	Brass Rod SA	30 15 00	4.4300 09	below standpt.
TS WELLESLEY (P)	283 07 18		above standpt.	Henry Werner Plate	13 03 53	3.0421 66	below standpt.
Copper Spike	283 07 18		above standpt.	TS Henry Werner Plate	13 03 53	3.0421 66	below standpt.
Brass Rod	17 09 23		above standpt.	TS APsley	170 09 23		above standpt.
			below				below

Prepared by: H.C. BORDER Checked: H.C. BORDER Noted on U.T.M. Card

407

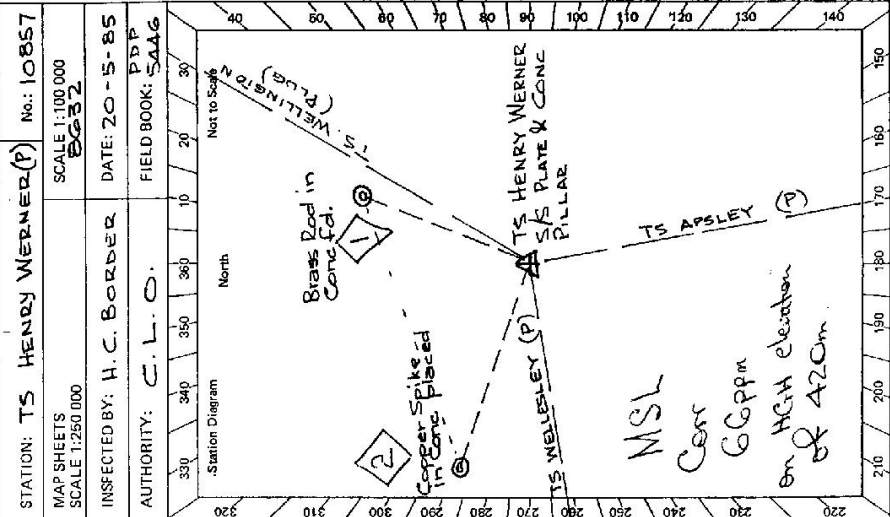

STATION: TS HENRY WERNER (P) No.: 10857  
 MAP SHEETS SCALE 1:100,000  
 SCALE 1:250,000  
 INSPECTED BY: H.C. BORDER DATE: 20-5-85  
 AUTHORITY: C.L.O. FIELD BOOK: SAAG

TS  
STATION TS HENRY W. ZNER 10857

Current Occupant: AS BERRERE  
Address: .....  
Phone: .....

Owner's Name: UNIVERSITY OF NSW  
Address: P.O. Box 1  
KENSINGTON 2033  
Phone: 697-4193

ACCESS

Access Report of 27/5/1985 was found suitable/unsuitable.  
Pierce & Maxwell Streets (0.0 km)  
Travel south along Pierce St. Road  
Swings SE. past Rubbish Tip at 1.5 km.  
Cross Grid at 2.0 km. Turn in through  
locked gate at 2.4 km. Travel round  
hill on left to gate at 2.75 km. Through  
gate before yards at 2.8 km. Through  
gate on W. side of yards at 2.9 km.  
Follow track to top of ridge and water  
tanks at 13.2 km. NE along fence to  
gate at 13.3 km and on to TS, near  
radio mast at 13.4 km.  
Conventional Vehicle access

Key to locked gate can be obtained  
from Mr M. Johnson Manager Uni/NSW  
research station located on extension  
of Warne Street towards River (East)

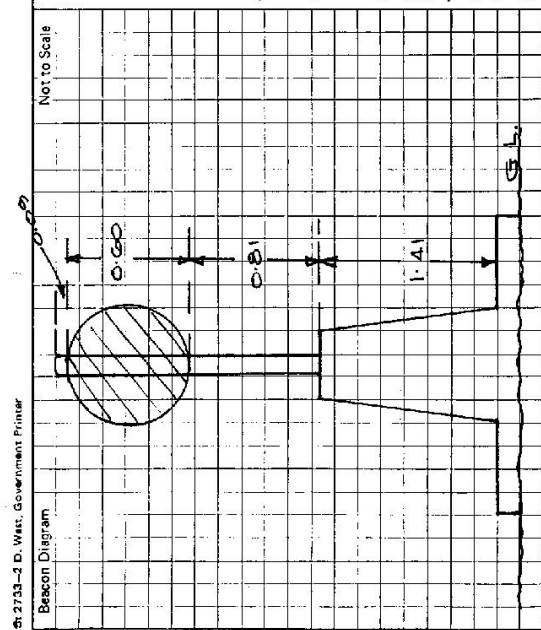
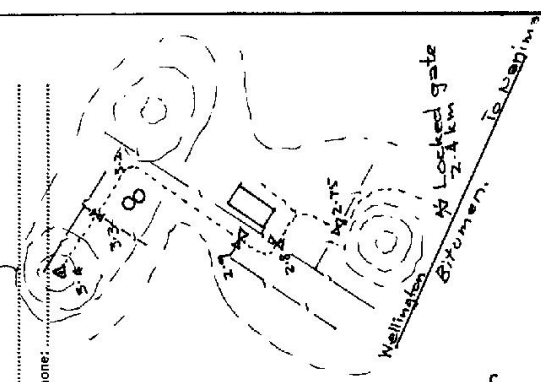

This section to be completed by officer constructing pillar.

Original station mark found/not found.

NEW STATION.

Description of mark: .....

Original beacon found/not found.

Description of beacon: .....

Height Top of Vanes to Top Mark: .....m.

Height of mark: .....m. above below rock/conc .....m. above below G.L.

Diameter of Vanes: .....m. Height of Cairn: .....m.

Original Beacon has/had not been destroyed by me.

Date	Record of Station