

Department of Lands
 STATION TS10829 MILTON RES. [P]

Co: ST. VINCENT
 Ph: ULLADULLA
 Map Sheet: MILTON
 No: W4687-IV
 Inspected by: R. CUBIS
 Date: 4. 4. 1984
 Authority: CROWN LANDS OFFICE Field Book: 5245/G

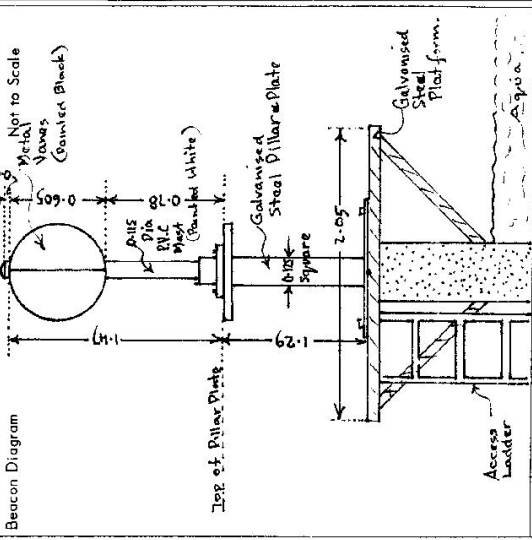

Department of Lands
 Integrative Survey of N.S.W.
 RECONNAISSANCE and MAINTENANCE REPORT

This Trig. Station has been: Note: Cross out word or words which do not apply

1. Completely cleared to permit 360° vision to surrounding Trigs. (excluding a section in SW direction)

2. Cleared by ~~lines bearing~~ from Trig-Mast

3. Trig. Mast & Vanes have been painted white & black respectively.

4. The Trig. was unpiled/~~not unpiled~~, dimensions now being: Description of mark: STEEL Pillar should be explicit, e.g. Steel plug, Brass plug, Bolt, Concrete Pillar

Height of mark: 1.79 m above Steel Plate form concrete m above G.L.

Height of Top Vanes to ~~Top Mast~~ Top pillar plate: 1.47 m Diameter of Vanes (vertical): 0.605 m.

Height of ~~Centre~~ Pillar: 1.79 m. Diameter of ~~Centre~~ Pillar: 0.175 m. Sq. base

Length of Mast: 1.55 m. (approximate if not unpiled)

5. A. set in conc/rock has been placed/fd m. bearing°M from Trig. Mast/pillar

6. A. set in conc/soil has been placed/fd m. bearing°M from Trig. Mast/pillar

7. A. set in conc/soil has been placed/fd m. bearing°M from Trig. Mast/pillar

8. A. set in conc/rock has been placed/fd m. bearing°M from Trig. Mast/pillar

9. Connection: to m. bearing°M

10. Connection: to m. bearing°M

11. Connection: to m. bearing°M

12. Connection: to m. bearing°M

13. Diff. Ht. is m. above/below

14. Diff. Ht. is m. above/below

15. Diff. Ht. is m. above/below

16. Diff. Ht. is m. above/below

Prepared by: R. Cubis Checked: Ben Bryan

STATION TS 10829 MILTON RES. (P)

Owners Name: SHOALHASEN SHIRE COUNCIL

Current Occupant: (Water Reservoir)

Address (Local): Deering Street, ULLADULLA

- ① 0.0 ULLADULLA POST OFFICE
- ② 0.1 MILTON (0.0 km)
- ③ 0.1 Corner of Myrtle Street. Turn Left into and proceed along Myrtle Street to T-Intersection.
- ④ 0.6 Croobyan Rd. Turn Right
- ⑤ 1.15 Corner of Corkeshane. Turn Right.
- ⑥ 1.60 Proceed along Corkeshane to Gate of dairy property on left. Proceed through gate into property and continue on a generally straight dead end to 1.85 a gate at western side of residence waterbowl.
- ⑦ 2.05 Proceed along track to Reservoir.

Station Diagram Not to Scale

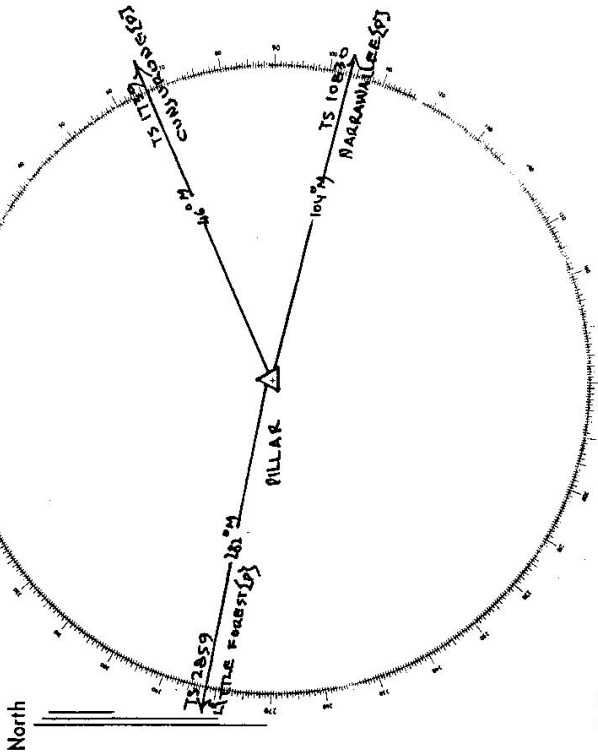

List of Observed Directions:-

Standpoint: PILLAR		Station		Direction	
Station	Direction	Station	Direction	Station	Direction
TS 10829: SHOALHASEN (P)	104° 00' 00.0"	TS 2859: LITTLE FOREST (P)	281° 57' 24.2"	TS 1739: CONJUGENS (P)	45° 11' 51.7"



PM's and SSM's placed under Survey Practice Regulations 12 and 55b are required to have a Locality Sketch Plan lodged with the Deposited Plan at The Land Titles Office.

D.P.



TS 10829
PM RECOVERIES
SSM

Description G. I. PIPES

LOCALITY SKETCH PLAN

Parish ULLADULLA County ST. VINCENT Town/Suburb/Locality MILTON
 Municipality or Shire SHOALHAVEN C.M.A. Map Sheet MILTON W4687-1V
 Measurements are in metres Zone 56/1

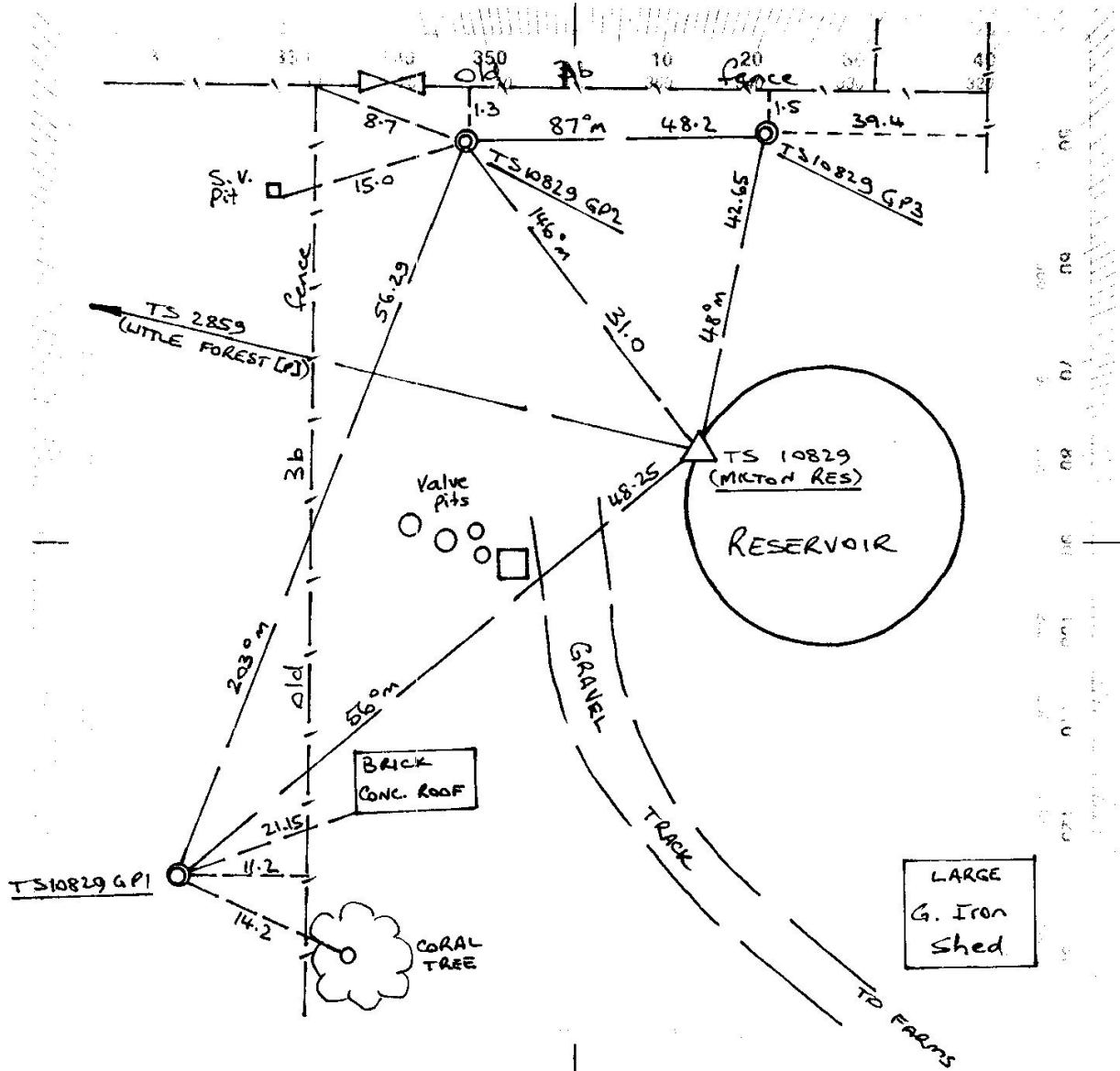

(FOR I.S.G. CO-ORDINATES SEE HAVOC 89197 - REFIX T.S. MILTON)

Organization placing Marks NOUVA LANDS OFFICE
 Ref. NA814450

I certify that the Mark or Marks have been placed and numbered as detailed hereon.

The Surveyor General is to be notified of ISG/AMG Co-Ordinates and/or AHD Levels determined by survey for mark placed.

TS 10829
PM RECOVERIES.
SSM

Pek Jim
 Mark placed 8 / 12 / 1987