

7.4.28

Department of Lands
 Trigonometrical Survey of N.S.W.
 RECONNAISSANCE and MAINTENANCE REPORT

STATION TS 10821 PALM BEACH RESERVE (E)

This Trig. Station has been:

Note: Cross out word or words which do not apply

1. Completely cleared to permit 360° vision to surrounding Trigs. /
2. Cleared by lances bearing from Trig. Mast
3. Trig. Mast & Vanes have been painted ~~white & black~~ respectively. New Station
4. The Trig. was unpiled/not unpiled, dimensions now being: STEEL PILLAR should be explicit, e.g. Steel plug, Brass plug, Bolt, G.I. Pipe
 Description of mark..... PLAIN m above CONCRETE m below G.L.
 Height of mark..... 1.34 m above rock/concrete m below
 Height of Top Vanes to Top Mark 1.44 m. Diameter of Vanes (vertical) 0.6 m.
 Height of Cairn..... m. Diameter of Cairn..... m.

5. RESERVE Mast set in concrete has been placed. 4.755 m. bearing 257° 30' 156 from Trig. Mast
6. RESERVE Mast set in concrete has been placed. 4.745 m. bearing 4° 15' 156 from Trig. Mast
7. RESERVE Mast set in concrete has been placed. 4.755 m. bearing 76° 15' 156 from Trig. Mast
8. RESERVE Mast set in concrete has been placed. 4.760 m. bearing 137° 30' 156 from Trig. Mast

9. Connection..... to..... m. bearing.....°M
10. Connection..... to..... m. bearing.....°M
11. Connection..... to..... m. bearing.....°M
12. Connection..... to..... m. bearing.....°M
13. Diff. Ht. TOP OF MAST is 30.555 m. above PM 16457
14. Diff. Ht. is m. above below
15. Diff. Ht. is m. above below
16. Diff. Ht. is m. above below

Prepared by: MWS & DB Checked: DB Noted on U.T.M. Card

Co: CUMBERLAND | Ph: NARRABEEN
 Map Sheet: PALM BEACH | No: 2775-2
 Inspected by: MWS & DB | Date: _____
 Authority: MWS & DB | Field Book: _____
 Beacon Diagram: Not to Scale

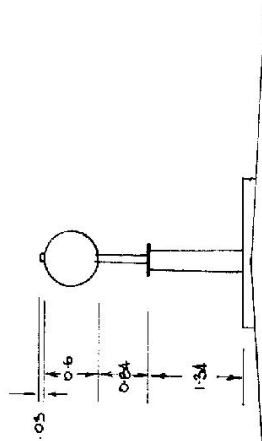

Date _____ Record of Station _____

Checked

TS 1082 TS 1082H
PALM BLUCH RES

~~APPROXIMATE~~
PROVISIONAL

HAVE BEEN OBTAINED BY CAREWEG OUT
A RESECTION OFF FOUR CO-ORDINATED RECOVERIES (PUNCH MARKS IN THE
RIM OF THE RESEVOIR) PLACED BY FB 5926 RE, PRIOR TO THE CONSTRUCTION
OF THE OBSERVATION PILLAR.

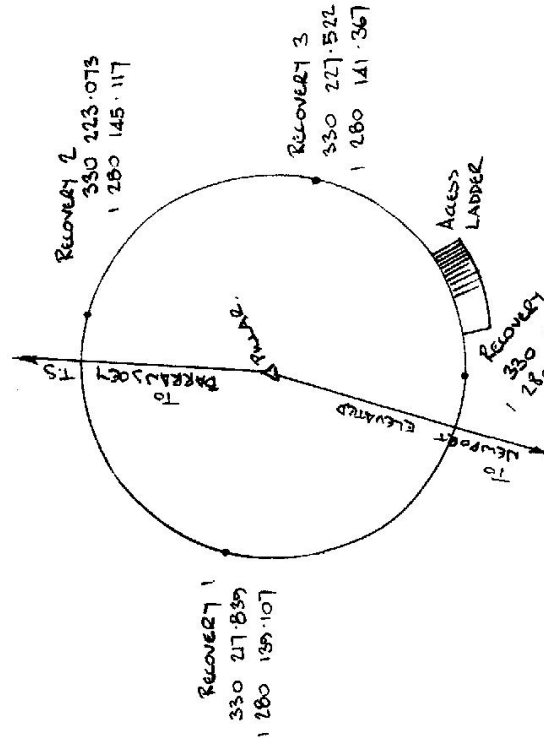

OBSERVATIONS TO FIX CO-ORDS FOR
NEW OBSERVATION PILLAR

BARRENJOSETT TS	0	00	00
RECOVERY 1	254	04	56
RECOVERY 2	0	49	29
RECOVERY 3	332	48	59
RECOVERY 4	163	29	33
NEWPORT ELEVATED	167	50	55

INITIAL OBSERVATIONS TO FIX
CO-ORDINATES WERE TAKEN FROM
AN INVERTED SCREEN IN THE TOP
OF THE AIR JENT. POINT TO 2154
(PALM BLUCH) CO-ORDS 330 222.697
1 280 140.170

~~APPROXIMATE~~
PROVISIONAL

CO-ORDINATES 330 222.707
1 280 140.183

STATION TS 10821 PA BEACH RESERVOIR (P)

Owners Name: M.V.S.E.D.B. Current Occupant:

Address: Address:

Access: SEE USD MAP 21A (PALM BEACH)

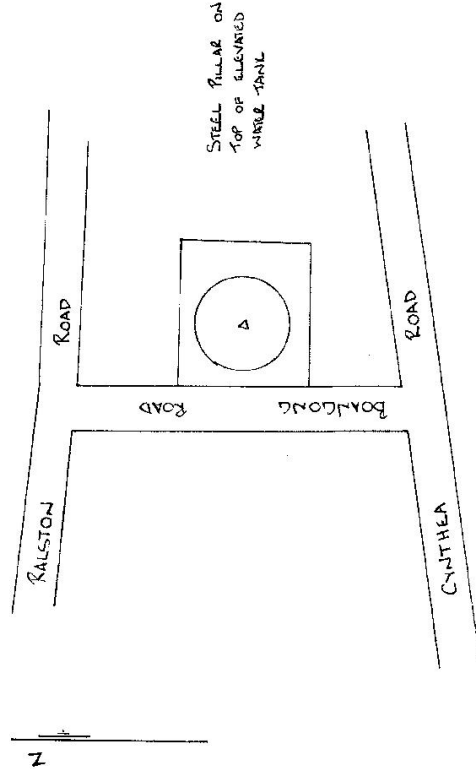

Not to Scale

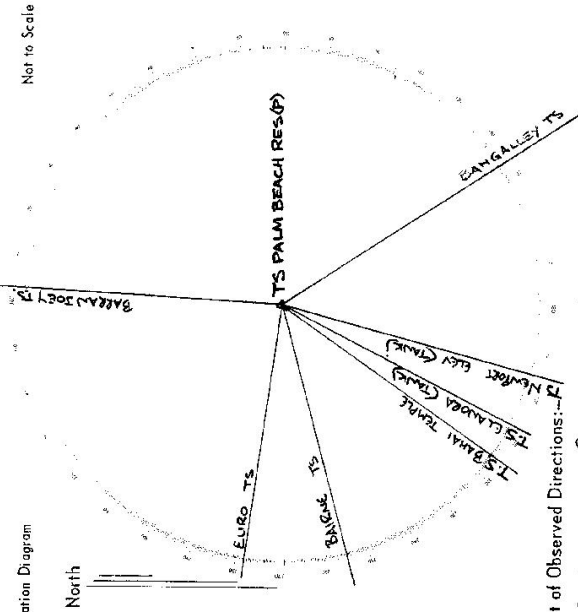

List of Observed Directions: -
 Standpoint: TZIC PILLAR

Station	Direction	Station	Direction
BANGALAY TS	0 00	EURO TS	131 48 214
EURO TS	48 30 148	BANGALAY TS	216 21 193
BANGUE TS	60 41 194		
BANGALAY TS	68 19 076		
BANGUE TS	108 05 042		