

Department of Lands
 RECONNAISSANCE and MAINTENANCE REPORT

Integration Sr of N.S.W.

This Trig. Station has been:-

Note: Cross out word or words which do not apply

1. Completely cleared to permit 360° vision to surrounding Trigs.
2. Cleared by lanes bearing..... from Trig. Mast
3. Trig. Mast & Vanes have been painted white & black respectively. **NEW MARK**
4. The Trig. was unpiled/not unpiled, dimensions now being: **NEW MARK**
 Description of mark..... **STEEL PILLAR** should be explicit, e.g. Steel plug, Brass plug, Bolt, Concrete Pillar
 Height of mark..... 2.79 m above ~~steel~~ concrete 34.5 m above G.L.
 Height of Top Vanes to Top Mast/Top pillar plate 1.435 m Diameter of Vanes (vertical) 0.60 m.
 Height of Cairn..... m. Diameter of Cairn..... m.
 Length of Mast 0.835 m. (approximate if not unpiled)

5. A. SSM ~~set~~ in conc/rock has been placed/fd 30.1 m. bearing 123°M from Trig. Mast/pillar
6. A. set in conc/soil has been placed/fd..... m. bearing.....°M from Trig. Mast/pillar
7. A. set in conc/soil has been placed/fd..... m. bearing.....°M from Trig. Mast/pillar
8. A. set in conc/rock has been placed/fd..... m. bearing.....°M from Trig. Mast/pillar
9. Connection..... to..... m. bearing.....°M
10. Connection..... to..... m. bearing.....°M
11. Connection..... to..... m. bearing.....°M
12. Connection..... to..... m. bearing.....°M
13. Diff. Ht. SSM ~~is~~ is 3.82 m. ~~above~~ **PILLAR PLATE**
 below above below
 14. Diff. Ht. is..... m. above below
 15. Diff. Ht. is..... m. above below
 16. Diff. Ht. is..... m. above below

Prepared by: *Awadna* Checked: *7*

STATION TS 10805 WARWICK FARM (P)
 Co: CUMBERLAND | Ph: ST. LUKE
 Map Sheet: FAIRFIELD 9145 1/10000 | No: 9145
 Inspected by: J. KWASNKA | Date: 28/6/82
 Authority: SURVEY CONTROL BRANCH | Field Book: PDP 1962/4
 Beacon Diagram Not to Scale

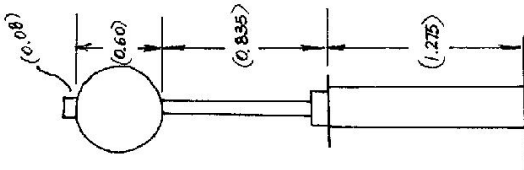

Date 23/6/82
 Record of Station
PILLAR ERECTED

