

25-10-9

Department of Lands Integrati Survey of N.S.W. RECONNAISSANCE and MAINTENANCE REPORT

STATION TS 10536 MOUNT BUCKLE (T)

This Trig. Station has been:- Note: Cross out word or words which do not apply

Co: AUCKLAND Ph: WAALIMMA

Map Sheet: TIMBALICA - 1:25000 No: 8223-III-N

Inspected by: D. VINCENT Date: 13.3.78

Authority Investigation Services Branch Field Book PD058/15

Beacon Diagram Not to Scale

1. Completely cleared to permit 360° vision to surrounding Trigs.
2. Cleared by lones bearing 58.10.33. 278. 283. 324. from Trig. Mast
3. Trig. Mast & Vanes have been painted white & black respectively.
4. The Trig. was unpiled/net supplied, dimensions now being:
 - Description of mark: ~~BRASS PLUG~~ should be explicit, e.g. Steel plug, Brass plug, Bolt, Concrete Pillar
 - Height of mark: m above rock, concrete m below G.L.
 - Height of Top Vanes to Top Mark/Top pillar plate: m Diameter of Vanes (vertical): m.
 - Height of Cairn: 1. D m. Diameter of Cairn: 2. 5 m.
 - Length of Mast: m. (approximate if not supplied)
5. ASSM 24961 set in conc/rock has been placed at 15.300m bearing 7.00M from Trig. Mast/pillar ^{PLUG}
6. ASSM 24962 set in conc/rock has been placed at 10.836m bearing 252.00M from Trig. Mast/pillar ^{PLUG}
7. A. BRASS A. set in conc/rock has been placed at 56.229m bearing 324.00M from Trig. Mast/pillar ^{PLUG}
8. A. set in conc/rock has been placed at m bearing M from Trig. Mast/pillar
9. Connections 24961 to 50024962: 16.332 m bearing 226.00M
10. Connection: to: m bearing M
11. Connection: to: m bearing M
12. Connection: to: m bearing M
13. Diff. Ht. 55M 24961 is 3.220 m above Trig. PLUG
14. Diff. Ht. 55M 24962 is 1.047 m above Trig. PLUG
15. Diff. Ht. BRASS A is 8.452 m above Trig. PLUG
16. Diff. Ht. is m above/below



See Maintenance Report for TS MOUNT BUCKLE (P)

| Date | Record of Station |
|------|-------------------|
| | |
| | |
| | |
| | |
| | |
| | |

Prepared by: David Vincent Checked: Waalimma

STATION'S 10536 MOUNT BUCKLE

Owners Name: S. Beattie
 Address On Trig. Reserve:
 Access: 13-3-70

Current Occupant:
 Address:

Area: 1:25,000 FIMBILICA

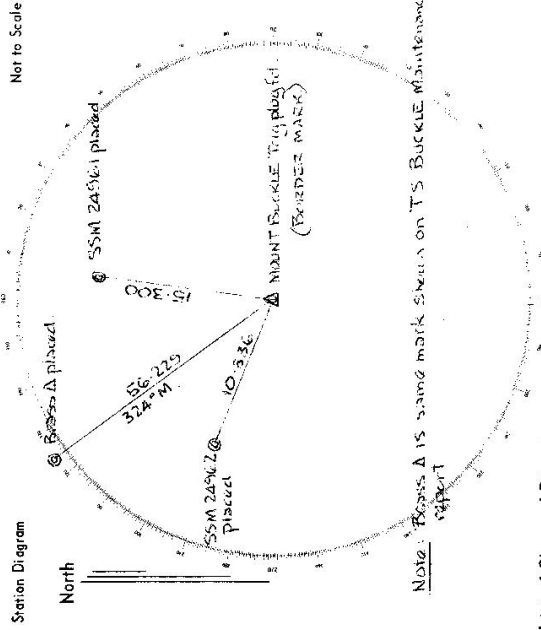

List of Observed Directions:-

| Standpoint: Trig. Point | | Standpoint: Beattie's Δ | |
|-------------------------|------------|-------------------------|------------|
| Station | Direction | Station | Direction |
| Beattie's Δ | 324°00'00" | T'S BUCKLE | 325°04'18" |
| S.S.M 24961 | 7°21'16" | T'S MOUNT BUCKLE | 146°04'18" |
| S.S.M 24962 | 202°00'33" | | |
| Station | Direction | Station | Direction |
| | | | |

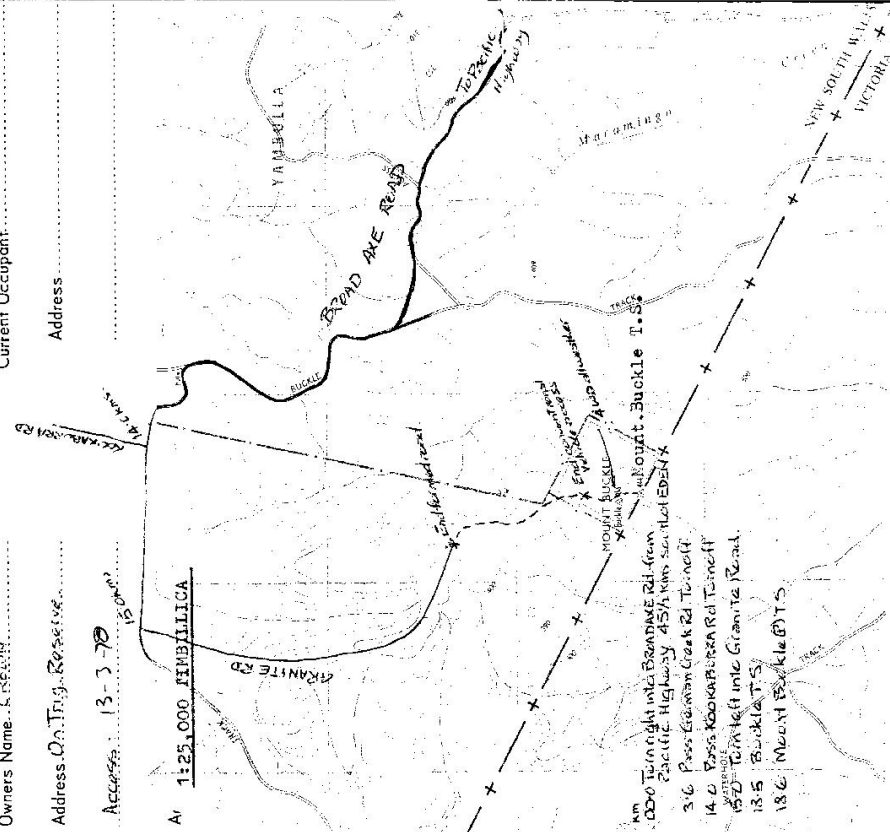

75.102

Department of Lands Integrati Survey of N.S.W.
RECONNAISSANCE and MAINTENANCE REPORT

STATION TS 10536 MOUNT BUCKLE (P)
 Co: AUCKLAND Ph: WAALIMMA
 Map Sheet: T1M5L1L1CA 1 250000 No: 88 23-111-N
 Inspected by: D. VINCENT Date: 27-4-78
 Authority: *[Signature]* (Field Book: *[Signature]*)

This Trig. Station has been:- *[Blank]*
 Note: Cross out word or words which do not apply

1. Completely cleared to permit 360° vision to surrounding Trig.
2. Cleared by lances bearing *28° 10' 3"* *275° 28' 3"* *324°* from Trig. Mast
3. Trig. Mast & Vanes have been painted white & black respectively. ✓
4. The Trig. was unpiled/not unpiled, dimensions now being:
 Description of mark: Concrete Pillar placed over plug should be explicit, e.g. Steel plug, Brass plug, Bolt, Concrete Pillar
 Height of mark *1.26* m ^{above} ~~below~~ rock/concrete *2.16* m ^{above} ~~below~~ G.L.
 Height of Top Vanes to Top Mast/Top pillar plate *1.46* m Diameter of Vanes (vertical) *0.60* m.
 Height of Cairn *1.2* m. Diameter of Cairn *2.5* m.
 Length of Mast *1.54* m. (approximate-if not unpiled)
5. *AS 2496.1* set in conc/rock has been placed/fd *15.29* m. bearing *7°* from Trig. Mast/pillar
6. *AS 2496.2* set in conc/~~soil~~ has been placed/fd *10.84* m. bearing *252°* from Trig. Mast/pillar
7. A *AS 2496.1* set in conc/soil has been placed/fd *10.84* m. bearing *252°* from Trig. Mast/pillar
8. A *AS 2496.1* set in conc/rock has been placed/fd *16.34* m. bearing *226°* from Trig. Mast/pillar
9. Connection *AS 2496.1* to *AS 2496.2* : *16.34* m. bearing *226°*
10. Connection *AS 2496.1* to *AS 2496.2* : *16.34* m. bearing *226°*
11. Connection *AS 2496.1* to *AS 2496.2* : *16.34* m. bearing *226°*
12. Connection *AS 2496.1* to *AS 2496.2* : *16.34* m. bearing *226°*
13. Diff. Ht. *AS 2496.1* is *1.06* m. ^{above} ~~below~~ Pillar Plate
14. Diff. Ht. *AS 2496.2* is *1.11* m. ^{above} ~~below~~ Pillar Plate
15. Diff. Ht. Trig. Plug is *2.15* m. ^{above} ~~below~~ Pillar Plate
16. Diff. Ht. *AS 2496.1* is *2.15* m. ^{above} ~~below~~ Pillar Plate

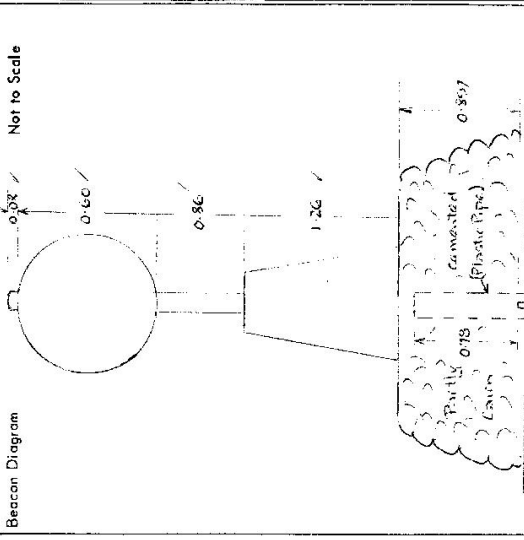

Date *27-4-78* Record of Station *✓*

| | |
|----------|-----------------------|
| <i>1</i> | <i>Pillar erected</i> |
| | |
| | |
| | |

Prepared by *David Thomas* Checked: *Shadrach*

STATION TS 10536 MOUNT BUCKLE (P)

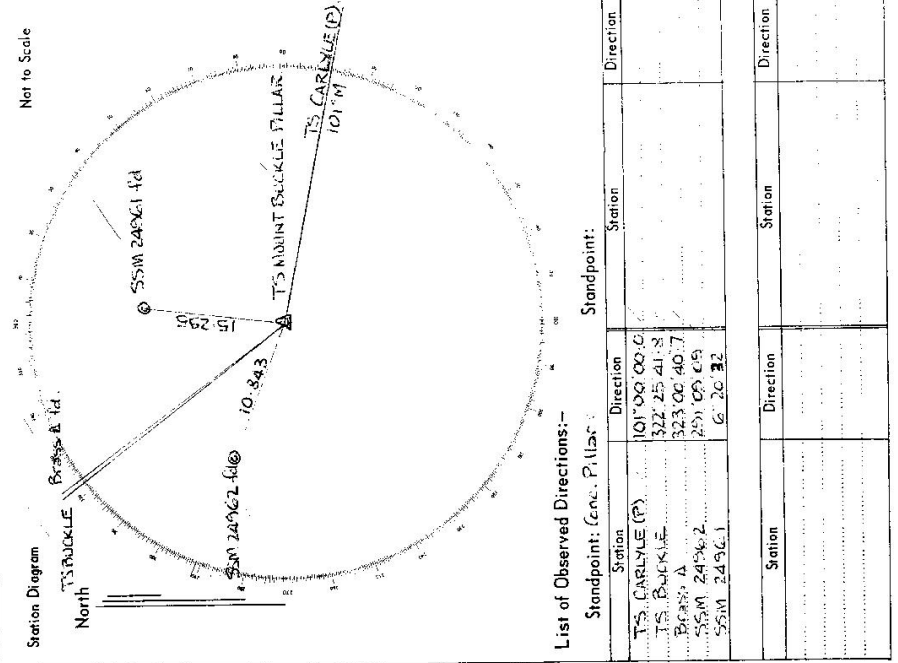
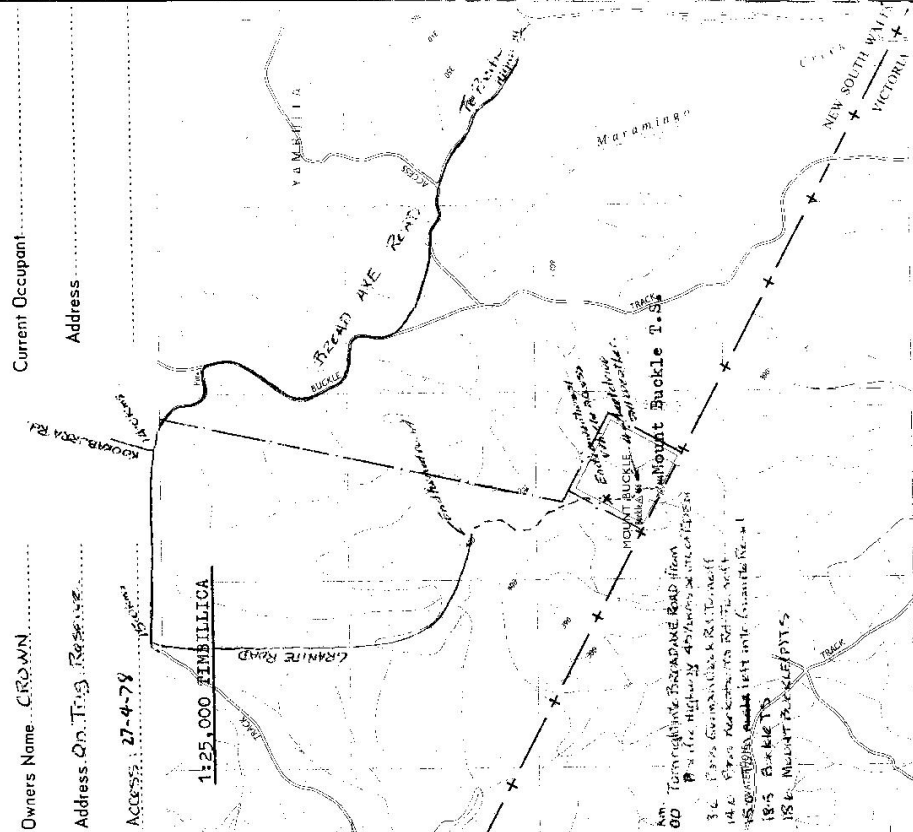

Owners Name: CROWN
 Address: On Title Register
 Access: 27-4-78
 1:25,000 TIMBLICA

Current Occupant:
 Address:

List of Observed Directions:-

| Standpoint: (Cont. P. 1) of: | | Standpoint: | |
|------------------------------|-------------|-------------|-----------|
| Station | Direction | Station | Direction |
| TS CARLYLE (P) | 101°00'00.0 | | |
| TS BUCKLE | 322°25'41.8 | | |
| BESS A | 323°00'40.7 | | |
| SSM 24961.2 | 251°09'09 | | |
| SSM 24961.1 | 6°20'32 | | |
| Station | Direction | Station | Direction |
| | | | |
| | | | |
| | | | |
| | | | |

Am: Turnrighting Bizard Ave Road from
 OD to Highway 47/48/49 at intersection
 3.6. From Mount Buckle T.S. to
 14.6. From Mount Buckle T.S. to
 18.5. From Mount Buckle T.S. to
 18.5 BUCKLE TS
 18.5 MOUNT BUCKLE PTS