

75-103

Department of Lands

Integral survey of N.S.W.

RECONNAISSANCE and MAINTENANCE REPORT

This Trig. Station has been:-

Note: Cross out word or words which do not apply

1. Completely cleared to permit 360° vision to surrounding Trigs. ✓
2. Cleared by lanes bearing..... from Trig. Mast
3. Trig. Mast & Vanes have been painted white & black respectively.
4. The Trig. was unpiled/not unpiled, dimensions now being:

Description of mark... STEEL ROOFTOP PILLAR ... should be explicit, e.g. Steel plug, Brass plug, Bolt, Concrete PillarHeight of mark... 1.76 m ^{above} ~~below~~ rock concrete ABOUT 21 m ^{above} ~~below~~ G.L.Height of Top Vanes to ~~Top Mast~~ Top pillar plate 1.46 m Diameter of Vanes (vertical) 0.76 m.~~Height of Mast~~ Diameter of Cap 0.08 m.Length of Mast 1.76 m. (approximate if not unpiled)

5. A..... set in conc/rock has been placed/fd..... m. bearing.....°M from Trig. Mast/pillar
6. A..... set in conc/soil has been placed/fd..... m. bearing.....°M from Trig. Mast/pillar
7. A..... set in conc/soil has been placed/fd..... m. bearing.....°M from Trig. Mast/pillar
8. A..... set in conc/rock has been placed/fd..... m. bearing.....°M from Trig. Mast/pillar

9. Connection..... to..... m. bearing.....°M

10. Connection..... to..... m. bearing.....°M

11. Connection..... to..... m. bearing.....°M

12. Connection..... to..... m. bearing.....°M

13. Diff. Ht. is..... m. ^{above} ~~below~~14. Diff. Ht. is..... m. ^{above} ~~below~~15. Diff. Ht. is..... m. ^{above} ~~below~~16. Diff. Ht. is..... m. ^{above} ~~below~~Prepared by: D. VINEY Checked:

STATION TS 10533 BLACKTOWN COUNCIL

Co: CUMBERLAND Ph: PROSPECT

Map Sheet: BLACKTOWN No: 4-9160

Inspected by: E. J. GARVIN Date: 29.3.78

Authority: INTEGRATION SURVEYS Field Book: PD? 0556

Beacon Diagram

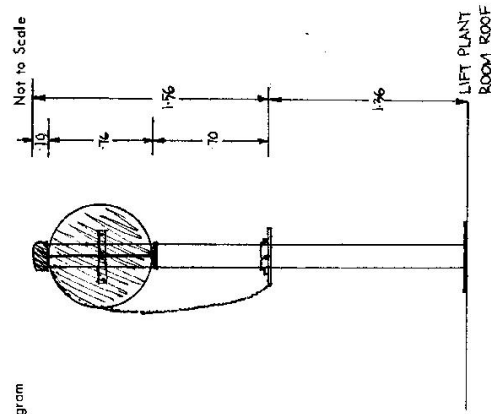

Date	Record of Station
29.3.78	PILLAR & BEACON ERECTED - R. HAMMILL (15.5.77)

Address.

Address.....FLUSHCOMBE ROAD..

BLACKTOWN.

102

about 250m
to Blacktown
Railway St:

LIBD MAP 50 REF. C1

TAKE LIFT TO 5TH FLOOR &
UP FIRE STAIRS TO ROOF (KEYS
AVAILABLE AT ENQUIRIES
COUNTER ON 4TH FLOOR - RING
FIRST).

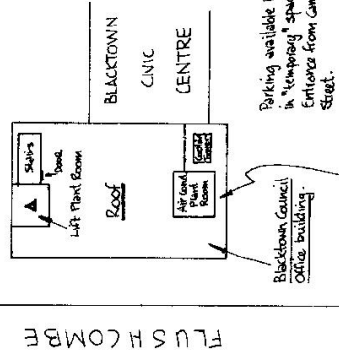

Parking available here
in "temporary" spaces.
Entrance from Campbell
Street.

Ladder for climb to
Lift Plant Room roof
usually left here.

D. West, Government Printer, New South Wales - 1976

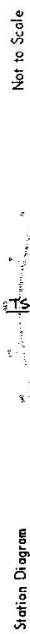

North

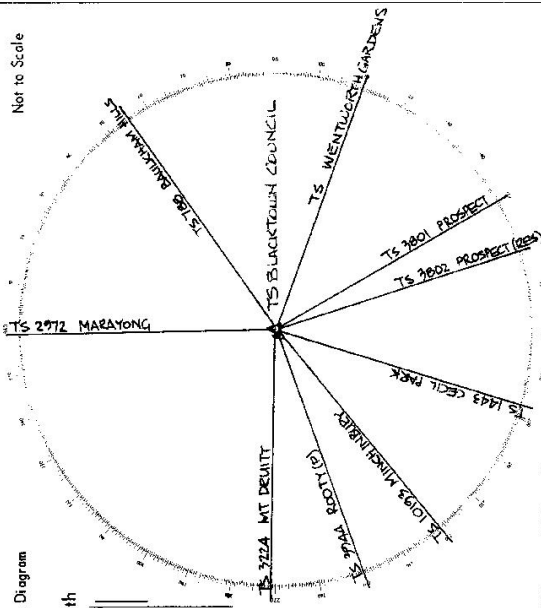

List of Observed Directions:—

Standpoint:

Standpoint:

Station	Direction	Station	Direction
1	2	3	4
5	6	7	8
9	10	11	12
13	14	15	16
17	18	19	20
21	22	23	24
25	26	27	28
29	30	31	32
33	34	35	36
37	38	39	40
41	42	43	44
45	46	47	48
49	50	51	52
53	54	55	56
57	58	59	60
61	62	63	64
65	66	67	68
69	70	71	72
73	74	75	76
77	78	79	80
81	82	83	84
85	86	87	88
89	90	91	92
93	94	95	96
97	98	99	100