

75 (03)

Department of Lands Integrat. survey of N.S.W.
RECONNAISSANCE and MAINTENANCE REPORT

STATION **TS 10360 LEPPINGTON (P)**
 Co: **CUMBERLAND** Ph: **Coastal**
 Map Sheet: **BRINGELLY 1:10000** No: **1337**
 Inspected by: **C. STARKEY** Date: **21-9-77**
 Authority: **DEPT LANDS** Field Book: **618, 619**

This Trig. Station has been: Note: Cross out word or words which do not apply

1. Completely cleared to permit 360° vision to surrounding Trigs.
2. Cleared by lanes bearing from Trig. Mast
3. Trig. Mast & Vanes have been painted white & black respectively.
4. The Trig. was unpiled/~~not unpiled~~, dimensions now being:

Description of mark: **STEEL PILLAR ON CONCRETE** should be explicit, e.g. Steel plug, Brass plug, Bolt, Concrete Pillar
 Height of mark: m above rock/concrete m below G.L.
 Height of Top Vanes to Top Mark: **2.48** m Diameter of Vanes (vertical) **0.60** m.
 Height of Cairn: Diameter of Cairn m.

- Length of Mast: m. (approximate if not unpiled)
5. A. set in conc/rock has been placed/fd m. bearing °M from Trig. Mast/pillar
 6. A. set in conc/soil has been placed/fd m. bearing °M from Trig. Mast/pillar
 7. A. set in conc/soil has been placed/fd m. bearing °M from Trig. Mast/pillar
 8. A. set in conc/rock has been placed/fd m. bearing °M from Trig. Mast/pillar

9. Connection: to m. bearing °M
10. Connection: to m. bearing °M
11. Connection: to m. bearing °M
12. Connection: to m. bearing °M
13. Diff. Ht. is m. above/below
14. Diff. Ht. is m. above/below
15. Diff. Ht. is m. above/below
16. Diff. Ht. is m. above/below

Prepared by: C. Starkey Checked by: C. Starkey Date: 30/5/75

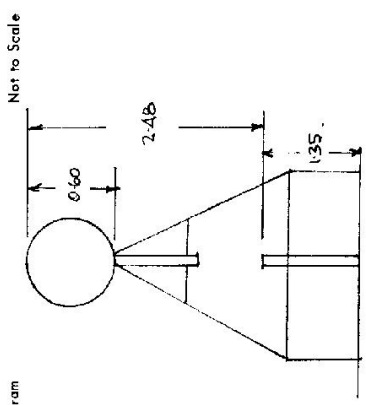

Date	Record of Station
1977	INITIAL VISIT

STATION **TS 10360 LEPPINGTON**

Owners Name: **M.W.S.P.D.B.**
 Current Occupant:
 Address: **511 GARDNER RD**
 Address:

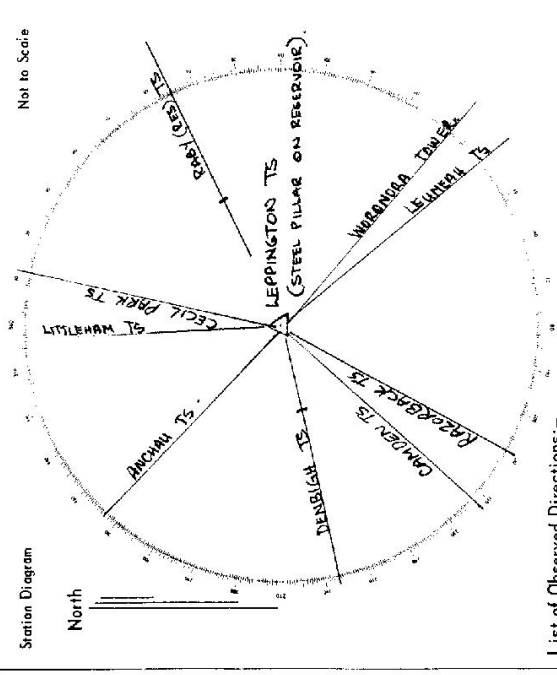
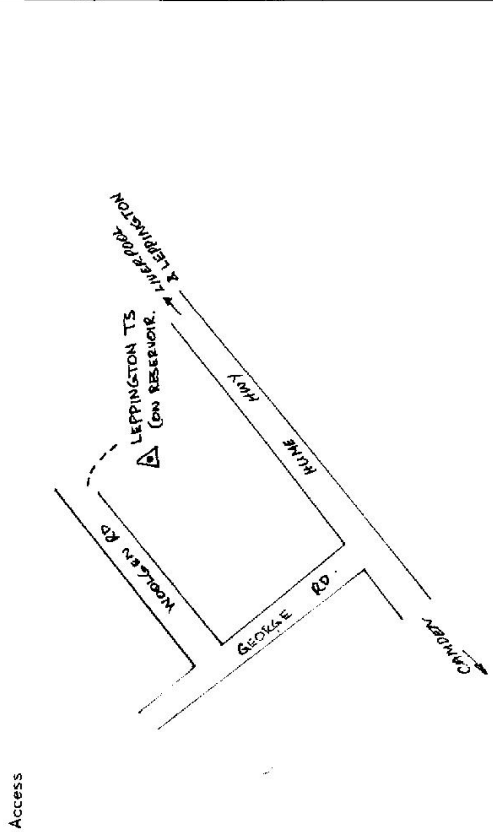

List of Observed Directions:-

Station	Direction	Station	Direction
RABY (BEE) TS	65°00'00"	LEUNGER TS	140°10'06"
CECIL PARK TS	172°54'11"	RAZORBACK TS	209°55'54"
PENBISH TS	257°38'34"	CAMDEN TS	222°52'23"
LITTLEHAM TS	351°20'08"	ANCIALL TS	313°24'46"
NOBONORA TOWER	131°19'25"		

Station	Direction	Station	Direction

D. West, Government Printer, New South Wales - 1976